



AUGLAIZE COUNTY

Engineering Department

P.O. Box 59
1014 S. Blackhoof Street
Wapakoneta, Ohio 45895

TELEPHONE 419-739-6520
FAX 419-739-6521
Email: doug@augcoeng.com



Douglas Reinhart
COUNTY ENGINEER

Mike Meckstroh

March 19, 2020

In re: Middletown property on North Side of Canning Factory Road
West of Pusheta Creek; Flood Plain development

The flood elevations that I am referencing are based upon the May 16th, 2019 flooding event and high water elevations documented at this site. I am also referencing to the topo map provided by Binkley Land Surveying plat dated 2/16/2020.

Based upon the May 16, 2019 flood, the elevation of that even at this site was 884.5 (1929 datum)

Western Parcel "A" (2.7 acres): The centerline of Canning Factory Road at the middle of this parcel has an elevation of 890 (marked "1" on the map) which is 5.5 feet above the flood elevation. The "hill" (marked "2") located just north of the road right-of-way is 893. However, the ground higher than the centerline of the roadway amount to just 0.1 of an acre out of the 1.4 acre proposed disturbed portion of the parcel. Just 30' north of the road right-of-way exists the edge of an escarpment (marked "3") that is the same elevation as the center of the road and then drops 11 feet over the next 30' to the north (marked "4").

The building setback for Duchouquet Township is 50' from the road right-of-way line which makes the location of a structure being placed on 11 feet of fill and then the location of the sewage system also being placed in an area with a minimum of 5 feet of fill to get above the 884.5 flood elevation.

Eastern Parcel "B" (2.66 Acres and 1.478 Acres disturbed): The centerline of the road in the middle of this lot is 884 which is 0.5 feet lower than the flood elevation recorded during the May, 2019 flood. To fill the area disturbed are marked on the map would take 5 feet of fill to bring the parcel up to road elevation and above the flood elevation. A structure on this parcel would be built on 5' of fill.

As stated to you over the telephone, the designated flood plain is a storage area for flood waters during a major event. Over the past 31 years, I have allowed "minor" fill along the fringe of a proposed development to bring it into compliance, which did not affect the storage area of the flood plain. Leveling the "hill" on the western parcel equates to removing 3' of dirt over 0.1 acre in order to fill up to 11 feet over the majority of the acre plus area to be disturbed. The eastern parcel will require will require 5+ feet of fill in order to bring the parcel up to road elevation and above the May 2019 flood elevation.

Neither of these proposed lots would require "minor" fill of the floodplain and therefore I will not issue a permit for work in the floodplain on either parcel.

Douglas Reinhart, P.E., P.S.
Auglaize County Engineer
Auglaize County Flood Plain Coordinator

Cc: Middleton

Survey of Parcel #B05-311-009-01 and being a part of the SE $\frac{1}{4}$ & SW $\frac{1}{4}$ of Section 31, Town 5 South, Range 6 East, Duchouquet Township, Auglaize County, Ohio.
(Deed Referenced in O.R. 641, Pg. 915)

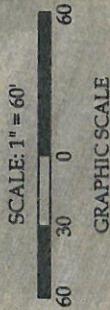

Parcel "B"
2.663 acres of which 0.147
acres are Road R/W

Parcel "A"
2.273 acres of which 0.210
acres are Road R/W

Parcel "C"
5.283 acres of which 0.483
acres are Road R/W

Area to be disturbed
(1.478 acres)

Area to be disturbed
(0.774 acres)

N 89° 42' 01" W ~ 2583.66'
S line, SW $\frac{1}{4}$ Section 31
Canning Factory Road

N 89° 38' 24" W ~ 1309.70'
S line, SE $\frac{1}{4}$ Section 31
Canning Factory Road



This plat represents an actual boundary
survey completed under my direct
supervision on February 16, 2020.

NOTE: All distances on this plat are
measured unless otherwise noted.

BASIS OF BEARINGS: The system of bearings for
this plat and legal description is based on the Ohio
State Plane - North Coordinate System NAD83 (2011).

Draft
Kyle J. Binkley, P.S. #8587

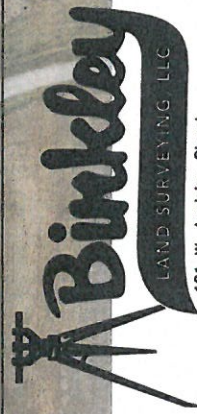

121 W. Auglaize Street
Wapakoneta, Ohio 45895
(419) 236-3768

CLIENT:		Mike Meckstroh			
SURVEYED BY:		DATE:	02-16-2020	DRAWN BY:	CHECKED BY:
T.J.S./T.E.W.				K.J.B.	K.J.B.
SCALE:		1" = 60'	PAGE	OF	PAGES
			1	1	1