

# Altstaetter Survey

62.432 Acres of Land Situated in the East Half of Section 7,  
Clay Township, Town-6-South, Range-7-East,  
Auglaize County, Ohio

## LOCATION PLAN

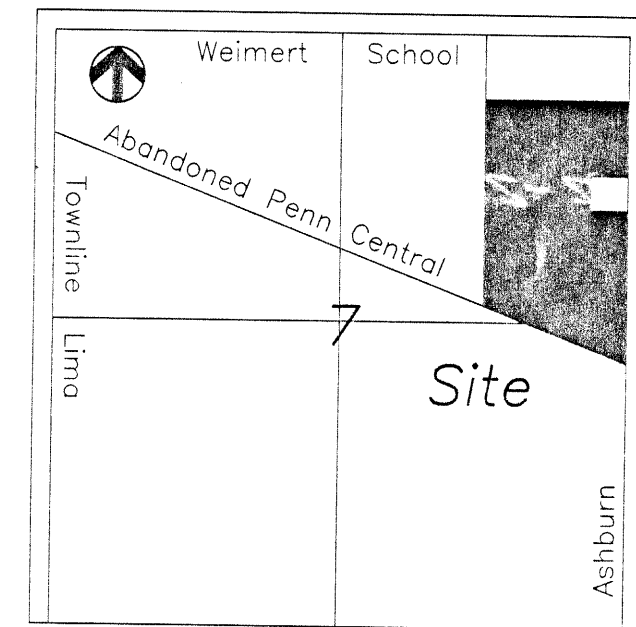

Section 7  
Clay Township  
Auglaize County, Ohio

## LEGEND

- Iron Pin (set)
- Iron Pin (found)
- ⊙ Railroad Iron (found)
- ▲ Railroad Spike (found)
- △ P.K. Nail/Shiner (set)
- Concrete Post
- Monument Box

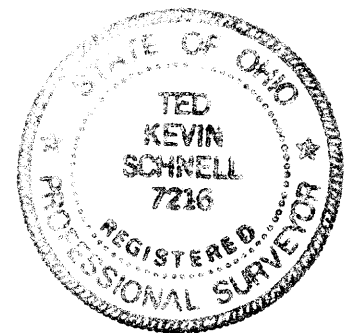
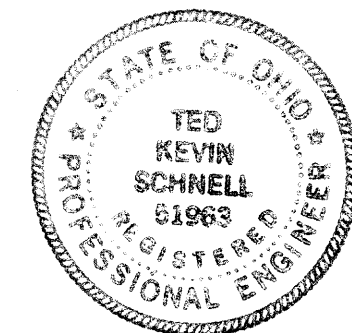

ATTEST

*Ted K. Schnell*  
Ted K. Schnell  
Professional Engineer  
Professional Surveyor

2-26-97  
date

H & S Civil Engineers and Land Surveyors

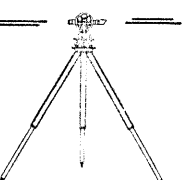

Myron Altstaetter Client	7 Section	6-South Town	7-East Range
Auglaize County	Clay Township	02/97 Date	1/1 Page

CLA-7-1

Northwest Corner,  
Northeast Quarter,  
Section 7, Clay Twp.

Weimert School Road (T.R. 130) and the  
North line of the Northeast Quarter of Section 7, Clay Twp.

Northeast Corner,  
Northeast Quarter,  
Section 7, Clay Twp.

SCALE  
0 200 400 600

Center of 12" dia  
Concrete Post is  
N. 77°-43'-15" E.  
and 1.57' from  
actual corner

OR 47  
170

## DEED REFERENCES

Previous Deed References  
Volume OR 117  
Page 562

62.432  
Acres

Railroad Iron found  
at Sta 2253+45.3

Abandoned Penn Central Railroad  
N. 68°-13'-13" W.

3,446.36'

N. 68°-13'-13" W.

1,429.19'

Southeast Corner,  
Northeast Quarter,  
Section 7, Clay Twp.  
PLACE OF BEGINNING

Southeast Corner,  
Southeast Quarter,  
Section 7, Clay Twp.

## ACREAGE NOTE

60.774 Acres located in the Northeast Quarter of Section 7  
1.658 Acres located in the Southeast Quarter of Section 7

TOTAL OF 62.432 ACRES OF LAND IN ALL

## BASIS OF BEARINGS

The bearings for this survey were based upon the Auglaize  
County Engineer's Global Positioning Survey, whereas the  
bearing for Ashburn Road is S. 00°-33'-37" W.