

SURVEY FOR ADK PARTNERSHIP

Situated in the Southwest Quarter of Section 3, the Southeast Quarter of Section 4,
and the Northeast Quarter of Section 9, Clay Township,
Town-6-South, Range-7-East, Auglaize County, Ohio

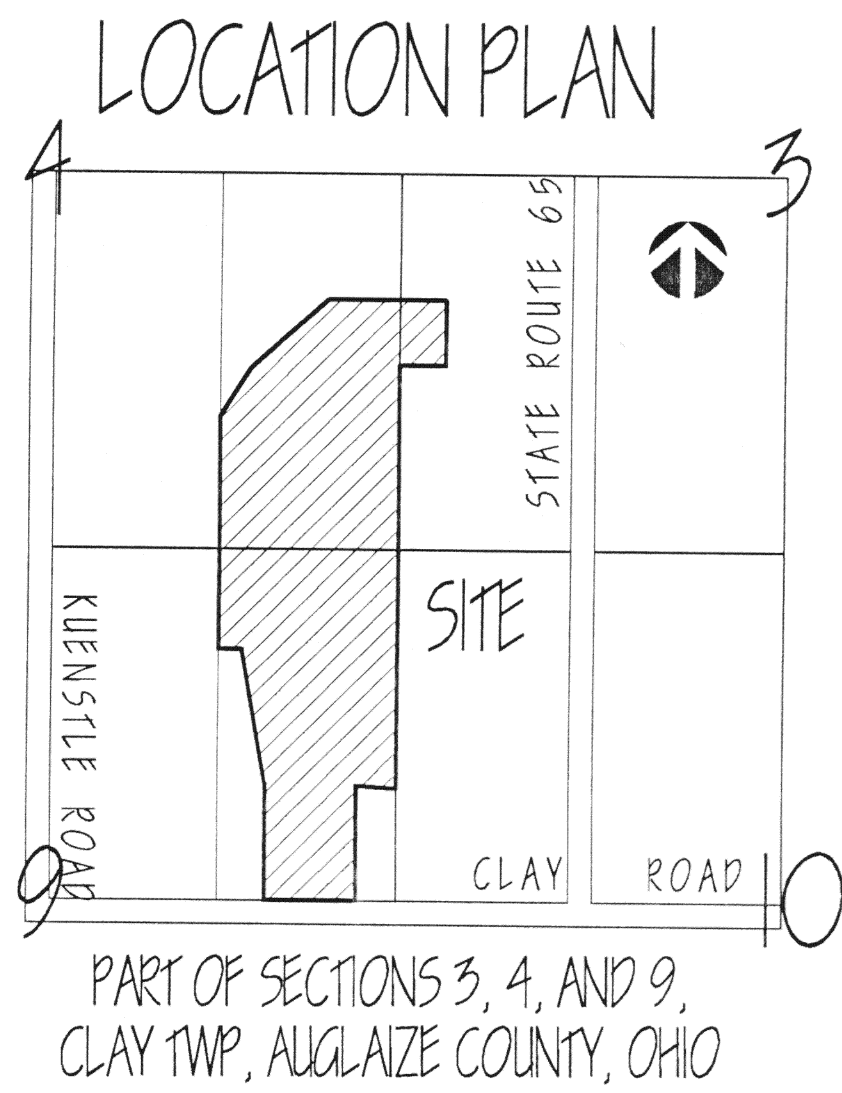

95.277 TOTAL ACRES

AREA IN NE 1/4 SECTION 9 = 50.713 Ac.

AREA IN SE 1/4 SECTION 4 = 43.255 Ac.

AREA IN SW 1/4 SECTION 3 = 1.309 Ac.

AREA IN R/W CLAY ROAD = 0.023 Ac.

LEGEND

- IRON PIN (set)
- IRON PIN (found)
- △ MAGNAIL & SHINER (set)
- ▲ P.K. Nail (found)
- ⊙ IRON PIPE (found)
- ⊗ GIN SPINDLE (found)
- ⊙ WOODEN END POST (obliterated)
- STEEL POST (found)
- MONUMENT BOX (found)

ATTEST

Ted K. Schnell

Ted K. Schnell
Professional Engineer
Professional Surveyor

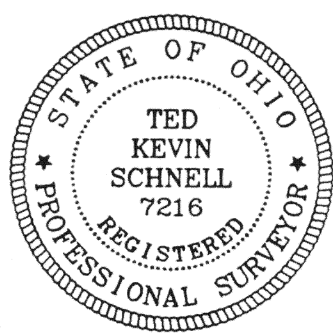
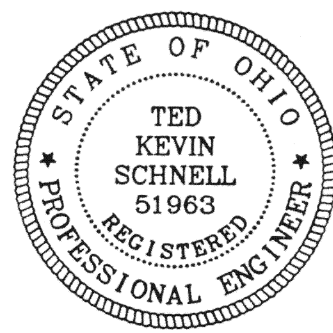

NOTE: THIS SURVEY HAS BEEN RECORDED WITH THE AUGLAIZE COUNTY ENGINEER'S TAX MAP OFFICE, IN THE CLAY TOWNSHIP DRAWER OF BOUNDARY SURVEYS.

SOUTH LINE OF THE NORTHEAST QUARTER OF SECTION 9, CLAY TWP.
AND CENTERLINE OF CLAY ROAD (T.R. 126)

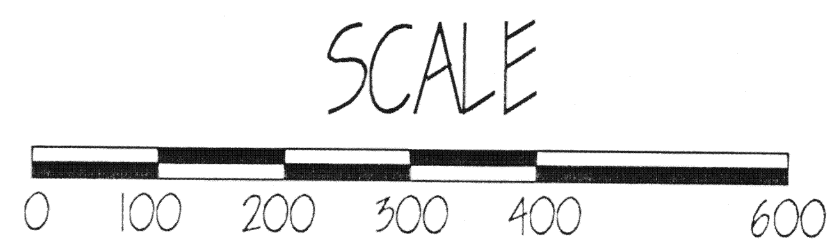

ADK PARTNERSHIP
VOL. OR 258
PAGE 0109

PARCEL #4
(SEE SHEET 2/2)

PARCEL #1
(SEE SHEET 2/2)

PARCEL #2
(SEE SHEET 2/2)

PARCEL #3
(SEE SHEET 2/2)

SOUTHEAST CORNER,
NORTHEAST QUARTER,
SECTION 9, CLAY TWP.

TITLE

SURVEY FOR ADK PARTNERSHIP

H & S Civil Engineers and Land Surveyors
913 Fieldstone Court Wapakoneta, Ohio 45895
Voice: (419) 738-4758 Fax: (419) 739-7631
E-Mail: hscivil@bright.net



SURVEY FOR ADK PARTNERSHIP

Situated in the Northeast Quarter of Section 9,
Clay Township, Town-6-South, Range-7-East,
Auglaize County, Ohio

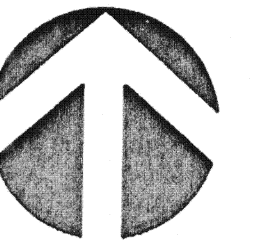

LOCATION PLAN

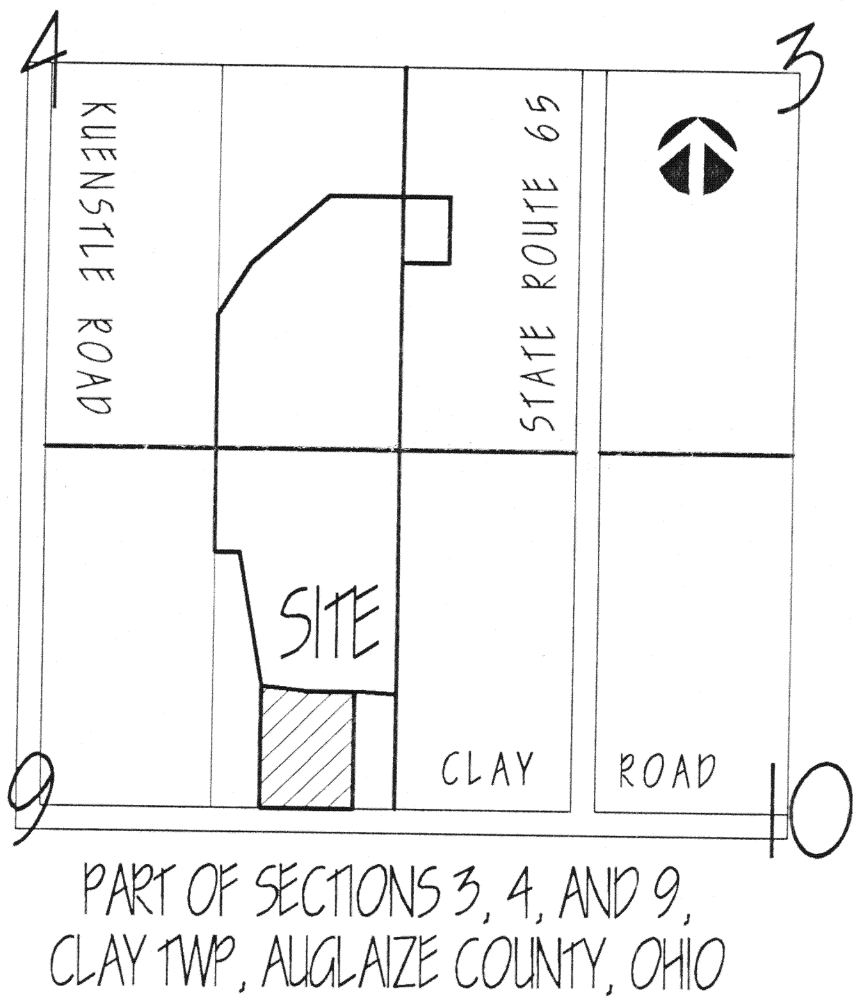

ATTEST

Ted K. Schnell

Ted K. Schnell
Professional Engineer
Professional Surveyor

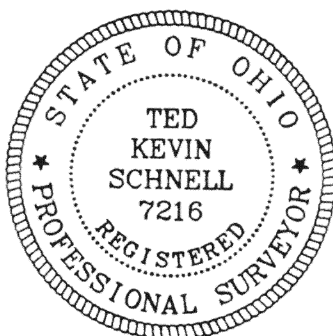
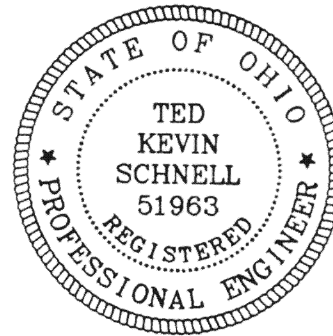

LEGEND

- IRON PIN (set)
- IRON PIN (found)
- △ MAG NAIL & SHINER (set)
- ▲ P.K. Nail (found)
- ⊙ IRON PIPE (found)
- ⊗ GIN SPINDLE (found)
- ⊕ WOODEN END POST (obliterated)
- STEEL "T" POST (found)
- MONUMENT BOX (found)

NORTHEAST CORNER,
NORTHEAST QUARTER,
SECTION 9, CLAY TWP.

VOL. OR 256, PAGE 053

NOTE: SEE SURVEY BY JAMES KENT, P.S. DATED 12/6/96, SURVEY BOOK 1, PAGE 158, AUGLAIZE COUNTY ENGINEER'S TAX MAP OFFICE

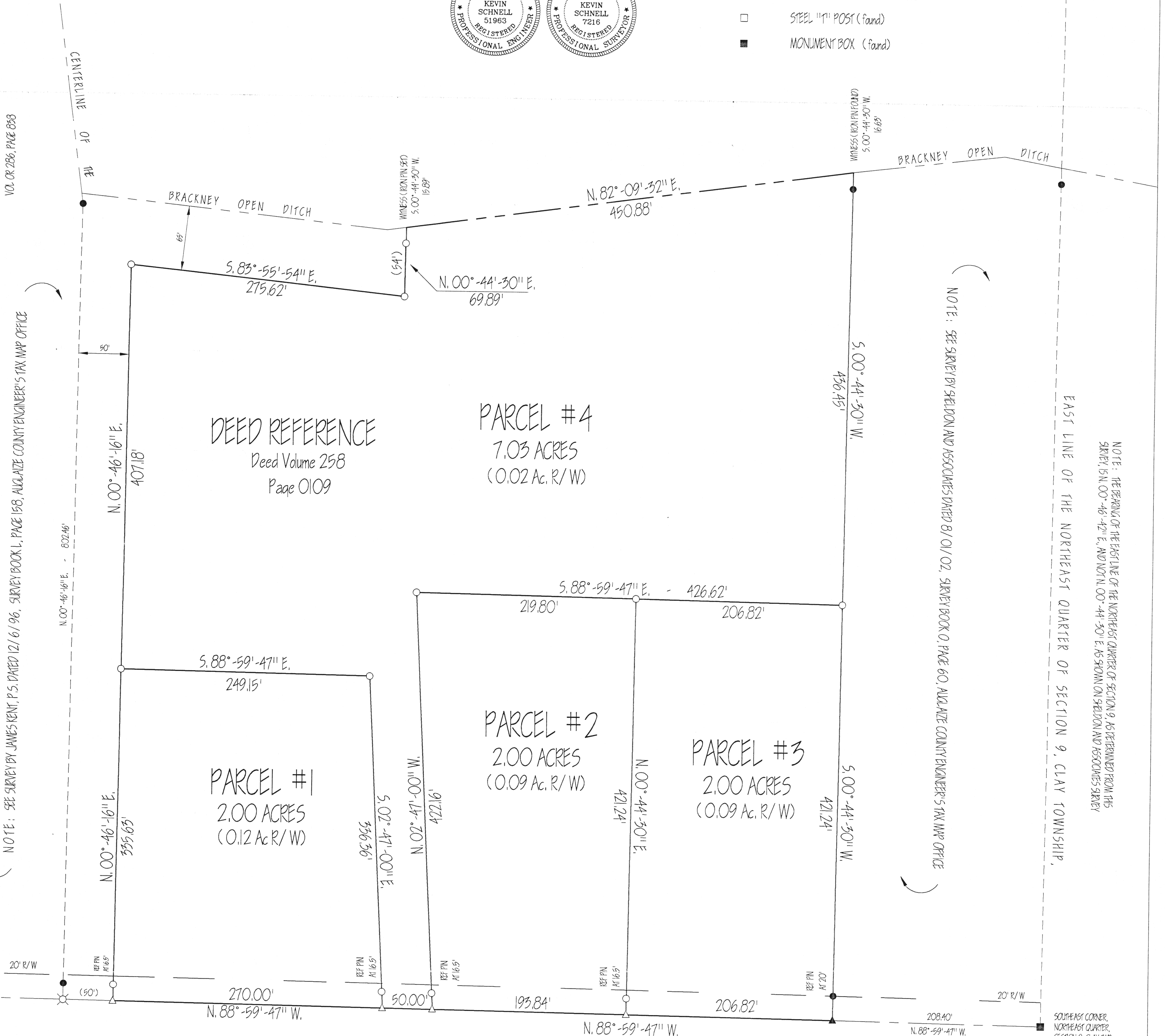

NOTE: SEE SURVEY BY SELDON AND ASSOCIATES DATED 8/01/02, SURVEY BOOK 0, PAGE 60, AUGLAIZE COUNTY ENGINEER'S TAX MAP OFFICE

NOTE: THE BEARING OF THE EAST LINE OF THE NORTHEAST QUARTER OF SECTION 9, AS DETERMINED FROM THIS SURVEY, IS N. 00°-46'-42" E. AND NORTH 00°-44'-30" E. AS SHOWN ON SELDON AND ASSOCIATES SURVEY

EAST LINE OF THE NORTHEAST QUARTER OF SECTION 9, CLAY TOWNSHIP,

SOUTHEAST CORNER,
NORTHEAST QUARTER,
SECTION 9, CLAY TWP.

SCALE

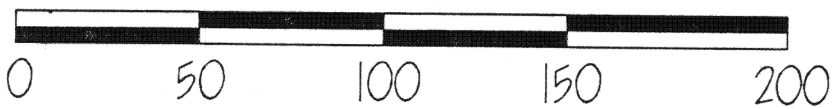

NOTE: THIS SURVEY HAS BEEN RECORDED WITH THE AUGLAIZE COUNTY ENGINEER'S TAX MAP OFFICE, IN THE CLAY TOWNSHIP DRAWER OF BOUNDARY SURVEYS.

SURVEY FOR ADK PARTNERSHIP

H & S Civil Engineers and Land Surveyors

913 Fieldstone Court Wapakoneta, Ohio 45895
Voice: (419) 738-4758 Fax: (419) 739-7631
E-Mail: hscivil@bright.net



TITLE

Project	CLAY-ADK
Date	09/10/02
Scale	AS SHOWN
Sheet	2

Project Location
SECTIONS 3, 4, AND 9
CLAY TOWNSHIP
TOWN-6-SOUTH, RANGE-7-EAST
AUGLAIZE COUNTY

Project Name
SURVEY FOR
ADK PARTNERSHIP
PARCELS 1, 2, AND 3
FROM SURVEY

No.	
Revision/Issue	
Date	

H & S Civil Engineers and Land Surveyors

913 Fieldstone Court
Wapakoneta, Ohio 45895
Phone (419) 738-4758
Fax (419) 739-7631
E-Mail hscivil@bright.net

Ted K. Schnell P.E., P.S.
Gregory B. Huber P.E.



09/17/02

SURVEYORS DESCRIPTION FOR 95.277 ACRE PARCEL

The following described tract of land is situated in the Southwest Quarter of Section 3, the Southeast Quarter of Section 4, and the Northeast Quarter of Section 9, Clay Township, Town-6-South, Range-7-East, Auglaize County, Ohio, and is more particularly described as follows:

Commencing for reference at a Monument Box located at the Southeast Corner of the Northeast Quarter of said Section 9, Clay Township;

Thence with a bearing of N. 88°-59'-47" W. along the South Line of the Northeast Quarter of said Section 9, Clay Township, and the centerline of Clay Road, (Township Road #126), for a distance of 929.06 feet to a Mag Nail/Shiner (set) and the PLACE OF BEGINNING;

Thence continuing with a bearing of N. 88°-59'-47" W. along the South Line of the Northeast Quarter of said Section 9, Clay Township, and the centerline of Clay Road, (Township Road #126), for a distance of 50.00 feet to a Gin Spindle (found);

Thence with a bearing of N. 00°-46'-16" E. for a distance of 802.46 feet to an Iron Pin (found), and passing thru an Iron Pin (found) for reference at a distance of 16.50 feet;

Thence with a bearing of N. 07°-15'-13" W. along the centerline of an open ditch for a distance of 894.63 feet to a point, said point being referenced by an Iron Pin (found) at S. 41°-52'-51" W. and a distance of 18.07 feet;

Thence with a bearing of N. 86°-32'-46" W. along the centerline of an open ditch for a distance of 216.75 feet to a point, said point being referenced by an Iron Pin (found) at S. 00°-46'-16" W. and a distance of 14.02 feet;

Thence with a bearing of N. 00°-46'-16" E. along the West Line of the East Half of the Northeast Quarter of said Section 9, for a distance of 933.85 feet to a Steel Post (found);

Thence with a bearing of N. 00°-48'-41" E. along the West Line of the East Half of the Southeast Quarter of said Section 4, for a distance of 780.79 feet to a point in the centerline of an open ditch, said point being referenced by an Iron Pin (found) at N. 00°-48'-41" E. and a distance of 50.00 feet;

Thence with a bearing of N. 26°-52'-36" E. along the centerline of an open ditch for a distance of 330.09 feet to a point, said point being referenced by an Iron Pin (found) at N. 39°-57'-23" W. and a distance of 15.56 feet;

Thence with a bearing of N. 49°-42'-23" E. along the centerline of an open ditch for a distance of 867.74 feet to an Iron Pin (found) at the upper terminus of said open ditch;

Thence with a bearing of N. 89°-46'-05" E. for a distance of 703.55 feet to an Iron Pin (found);

Thence with a bearing of S. 00°-22'-54" W. for a distance of 312.11 feet to a Steel Post (found);

Thence with a bearing of N. 88°-54'-06" W. for a distance of 185.24 feet to a Steel Post (found);

Thence with a bearing of S. 00°-45'-11" W. along the East Line of the Southeast Quarter of said Section 4, Clay Township, for a distance of 1,345.41 feet to the center of an obliterated Wooden End Post;

Thence with a bearing of S. 00°-46'-42" W. along the East Line of the Northeast Quarter of said Section 9, Clay Township, for a distance of 1,770.29 feet to a point in the center of an open ditch, said point being referenced by an Iron Pin (found) at S. 02°-40'-52" W. at a distance of 16.48 feet;

Thence with a bearing of N. 79°-52'-12" W. along the centerline of an open ditch for a distance of 58.27 feet to a point;

Thence with a bearing of S. 83°-13'-49" W. along the centerline of an open ditch for a distance of 152.78 feet to a point, said point being referenced by an Iron Pin (found) at S. 00°-44'-30" W. at a distance of 16.63 feet;

Thence with a bearing of S. 82°-09'-32" W. along the centerline of an open ditch for a distance of 450.88 feet to a point;

Thence with a bearing of S. 00°-44'-30" W. for a distance of 69.89 feet to an Iron Pin (set), and passing thru an Iron Pin (set) for reference at the top of the Southerly bank of said open ditch at a distance of 15.89 feet;

Thence with a bearing of N. 83°-55'-54" W. for a distance of 275.62 feet to an Iron Pin (set);

Thence with a bearing of S. 00°-46'-16" W. for a distance of 742.81 feet to a Mag Nail/Shiner (set), and passing thru an Iron Pin (set) for reference at a distance of 726.31 feet, said Mag Nail/Shiner being the original PLACE OF BEGINNING.

Containing in all 95.277 Acres of land, of which, 0.023 Acre being previously dedicated for highway purposes. The above described tract of land is also subject to all other legal easements, reservations, or restrictions, if any, upon said premises.

Previous Deed References: DEED VOLUME OR 258, PAGE 0109, and VOLUME OR 54 Page 73, Auglaize County Recorder's Office.

PREPARED BY:

A handwritten signature in black ink, appearing to read "Ted K. Schnell".

Ted K. Schnell
Professional Engineer
Professional Surveyor

H & S Civil Engineers and Land Surveyors

913 Fieldstone Court
Wapakoneta, Ohio 45895
Phone (419) 738-4758
Fax (419) 739-7631
E-Mail hscivil@bright.net

Ted K. Schnell P.E., P.S.
Gregory B. Huber P.E.

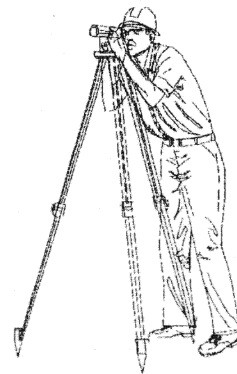

09/17/02

SURVEYORS DESCRIPTION FOR PARCEL #1

The following described tract of land is situated in the Northeast Quarter of Section 9, Clay Township, Town-6-South, Range-7-East, Auglaize County, Ohio, and is more particularly described as follows:

Commencing for reference at a Monument Box located at the Southeast Corner of the Northeast Quarter of said Section 9, Clay Township;

Thence with a bearing of N. 88°-59'-47" W. along the South Line of the Northeast Quarter of said Section 9, Clay Township, and the centerline of Clay Road, (Township Road #126), for a distance of 659.06 feet to a Mag Nail/Shiner (set) and the PLACE OF BEGINNING;

Thence continuing with a bearing of N. 88°-59'-47" W. along the South Line of the Northeast Quarter of said Section 9, Clay Township, and the centerline of Clay Road, (Township Road #126), for a distance of 270.00 feet to a Mag Nail/Shiner (set);

Thence with a bearing of N. 00°-46'-16" E. for a distance of 335.63 feet to an Iron Pin (set), and passing thru an Iron Pin (set) for reference at a distance of 16.50 feet;

Thence with a bearing of S. 88°-59'-47" E. for a distance of 249.15 feet to an Iron Pin (set);

Thence with a bearing of S. 02°-47'-00" E. for a distance of 336.36 feet to a Mag Nail/Shiner (set), and passing thru an Iron Pin (set) for reference at a distance of 319.86 feet, said Mag Nail/Shiner (set) being the original PLACE OF BEGINNING.

Containing in all 2.00 Acres of land, of which, 0.12 Acre being previously dedicated for highway purposes. The above described tract of land is also subject to all other legal easements, reservations, or restrictions, if any, upon said premises.

Previous Deed References: DEED VOLUME OR 258, PAGE 0109, Auglaize County Recorder's Office.

PREPARED BY:

Ted K. Schnell
Professional Engineer
Professional Surveyor

H & S Civil Engineers and Land Surveyors

913 Fieldstone Court
Wapakoneta, Ohio 45895
Phone (419) 738-4758
Fax (419) 739-7631
E-Mail hscivil@bright.net

Ted K. Schnell P.E., P.S.
Gregory B. Huber P.E.



09/17/02

SURVEYORS DESCRIPTION FOR PARCEL #2

The following described tract of land is situated in the Northeast Quarter of Section 9, Clay Township, Town-6-South, Range-7-East, Auglaize County, Ohio, and is more particularly described as follows:

Commencing for reference at a Monument Box located at the Southeast Corner of the Northeast Quarter of said Section 9, Clay Township;

Thence with a bearing of N. 88°-59'-47" W. along the South Line of the Northeast Quarter of said Section 9, Clay Township, and the centerline of Clay Road, (Township Road #126), for a distance of 415.22 feet to a Mag Nail/Shiner (set) and the PLACE OF BEGINNING;

Thence continuing with a bearing of N. 88°-59'-47" W. along the South Line of the Northeast Quarter of said Section 9, Clay Township, and the centerline of Clay Road, (Township Road #126), for a distance of 193.84 feet to a Mag Nail/Shiner (set);

Thence with a bearing of N. 02°-47'-00" W. for a distance of 422.16 feet to an Iron Pin (set), and passing thru an Iron Pin (set) for reference at a distance of 16.50 feet;

Thence with a bearing of S. 88°-59'-47" E. for a distance of 219.80 feet to an Iron Pin (set);

Thence with a bearing of S. 00°-44'-30" W. for a distance of 421.24 feet to a Mag Nail/Shiner (set), and passing thru an Iron Pin (set) for reference at a distance of 404.74 feet, said Mag Nail/Shiner (set) being the original PLACE OF BEGINNING.

Containing in all 2.00 Acres of land, of which, 0.09 Acre being previously dedicated for highway purposes. The above described tract of land is also subject to all other legal easements, reservations, or restrictions, if any, upon said premises.

Previous Deed References: DEED VOLUME OR 258, PAGE 0109, Auglaize County Recorder's Office.

PREPARED BY:

Ted K. Schnell
Professional Engineer
Professional Surveyor

H & S Civil Engineers and Land Surveyors

913 Fieldstone Court
Wapakoneta, Ohio 45895
Phone (419) 738-4758
Fax (419) 739-7631
E-Mail hscivil@bright.net

Ted K. Schnell P.E., P.S.
Gregory B. Huber P.E.



09/17/02

SURVEYORS DESCRIPTION FOR PARCEL #3

The following described tract of land is situated in the Northeast Quarter of Section 9, Clay Township, Town-6-South, Range-7-East, Auglaize County, Ohio, and is more particularly described as follows:

Commencing for reference at a Monument Box located at the Southeast Corner of the Northeast Quarter of said Section 9, Clay Township;

Thence with a bearing of N. 88°-59'-47" W. along the South Line of the Northeast Quarter of said Section 9, Clay Township, and the centerline of Clay Road, (Township Road #126), for a distance of 208.40 feet to a P.K. Nail (found) and the PLACE OF BEGINNING;

Thence continuing with a bearing of N. 88°-59'-47" W. along the South Line of the Northeast Quarter of said Section 9, Clay Township, and the centerline of Clay Road, (Township Road #126), for a distance of 206.82 feet to a Mag Nail/Shiner (set);

Thence with a bearing of N. 00°-44'-30" E. for a distance of 421.24 feet to an Iron Pin (set), and passing thru an Iron Pin (set) for reference at a distance of 16.50 feet;

Thence with a bearing of S. 88°-59'-47" E. for a distance of 206.82 feet to an Iron Pin (set);

Thence with a bearing of S. 00°-44'-30" W. for a distance of 421.24 feet to a P.K. Nail (found), and passing thru an Iron Pin (found) for reference at a distance of 401.24 feet, said P.K. Nail (found) being the original PLACE OF BEGINNING.

Containing in all 2.00 Acres of land, of which, 0.09 Acre being previously dedicated for highway purposes. The above described tract of land is also subject to all other legal easements, reservations, or restrictions, if any, upon said premises.

Previous Deed References: DEED VOLUME OR 258, PAGE 0109, Auglaize County Recorder's Office.

PREPARED BY:

A handwritten signature in cursive script, appearing to read "Ted K. Schnell".

Ted K. Schnell
Professional Engineer
Professional Surveyor

H & S Civil Engineers and Land Surveyors

913 Fieldstone Court
Wapakoneta, Ohio 45895
Phone (419) 738-4758
Fax (419) 739-7631
E-Mail hscivil@bright.net

Ted K. Schnell P.E., P.S.
Gregory B. Huber P.E.



09/17/02

SURVEYORS DESCRIPTION FOR PARCEL #4

The following described tract of land is situated in the Northeast Quarter of Section 9, Clay Township, Town-6-South, Range-7-East, Auglaize County, Ohio, and is more particularly described as follows:

Commencing for reference at a Monument Box located at the Southeast Corner of the Northeast Quarter of said Section 9, Clay Township;

Thence with a bearing of N. 88°-59'-47" W. along the South Line of the Northeast Quarter of said Section 9, Clay Township, and the centerline of Clay Road, (Township Road #126), for a distance of 609.06 feet to a Mag Nail/Shiner (set) and the PLACE OF BEGINNING;

Thence continuing with a bearing of N. 88°-59'-47" W. along the South Line of the Northeast Quarter of said Section 9, Clay Township, and the centerline of Clay Road, (Township Road #126), for a distance of 50.00 feet to a Mag Nail/Shiner (set);

Thence with a bearing of N. 02°-47'-00" W. for a distance of 336.36 feet to an Iron Pin (set), and passing thru an Iron Pin (set) for reference at a distance of 16.50 feet;

Thence with a bearing of N. 88°-59'-47" W. for a distance of 249.15 feet to an Iron Pin (set);

Thence with a bearing of N. 00°-46'-16" E. for a distance of 407.18 feet to an Iron Pin (set);

Thence with a bearing of S. 83°-55'-54" E. for a distance of 275.62 feet to an Iron Pin (set);

Thence with a bearing of N. 00°-44'-30" E. for a distance of 69.89 feet to a point in the centerline of an open ditch, and passing thru an Iron Pin (set) for reference at the top of the Southerly bank of said open ditch at a distance of 54.00 feet;

Thence with a bearing of N. 82°-09'-32" E. along the centerline of an open ditch for a distance of 450.88 feet to a point;

Thence with a bearing of S. 00°-44'-30" W. for a distance of 436.45 feet to an Iron Pin (set), and passing thru an Iron Pin (found) for reference at the top of the Southerly bank of the previously mentioned open ditch at a distance of 16.63 feet;

Thence with a bearing of N. 88°-59'-47" W. for a distance of 426.62 feet to an Iron Pin (set);

Thence with a bearing of S. 02°-47'-00" E. for a distance of 422.16 feet to a Mag Nail/Shiner (set), and passing thru an Iron Pin (set) for reference at a distance of 405.66, said Mag Nail/Shiner (set) being the original PLACE OF BEGINNING.

Containing in all 7.03 Acres of land, of which, 0.02 Acre being previously dedicated for highway purposes. The above described tract of land is also subject to all other legal easements, reservations, or restrictions, if any, upon said premises.

Previous Deed References: DEED VOLUME OR 258, PAGE 0109, Auglaize County Recorder's Office.

PREPARED BY:

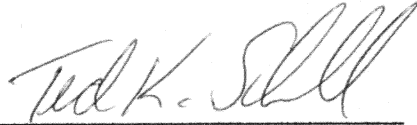
A handwritten signature in cursive script, appearing to read "Ted K. Schnell", written over a horizontal line.

Ted K. Schnell
Professional Engineer
Professional Surveyor