

# Kaverman Survey

5.010 and 1.129 Acres of Land Situated in the East Half of Section 21,  
Clay Township, Town-6-South, Range-7-East,  
Auglaize County, Ohio

## LOCATION PLAN

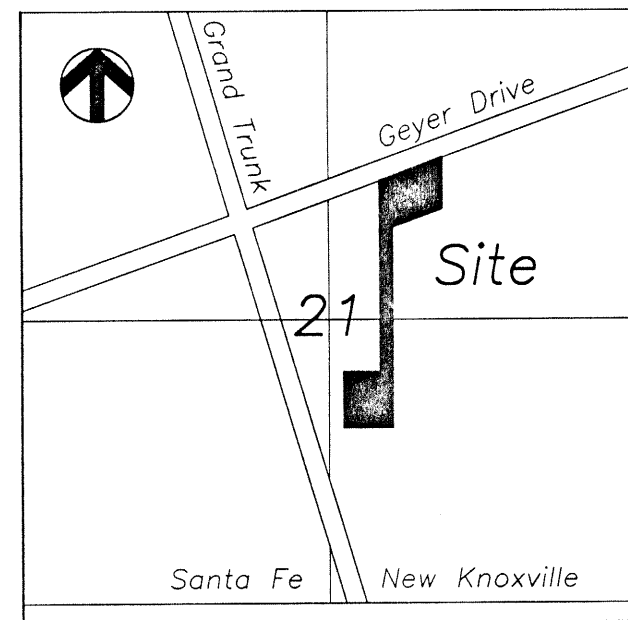

Section 21  
Clay Township  
Auglaize County, Ohio

## LEGEND

- Iron Pin (set)
- Iron Pin (found)
- ⬤ Corner Stone (found)
- ▲ Railroad Spike
- △ P.K. Nail/Shiner (set)
- Concrete Post
- Monument Box

## ACREAGE NOTE

The 5.01 Acre Parcel of land shown contains 1.371 Acres situated in the Northeast Quarter of Section 21, and 3.639 Acres situated in the Southeast Quarter of Section 21.

## TRAVERSE TABLE

segment	bearing	distance
"A"	S. 03°-30'-37" E.	226.64'
"B"	S. 71°-11'-00" W.	225.00'
"C"	N. 03°-30'-37" W.	226.64'
"D"	N. 71°-11'-00" E.	225.00'
"E"	N. 71°-11'-00" E.	50.00'
"F"	N. 86°-29'-23" E.	221.00'

## BASE BEARING

Bearings were based upon previous surveys. Centerline of Pike Street as shown bears N. 71° E.

## SURVEY REFERENCES

1902 Survey by Samuel Craig  
Auglaize County Surveyor  
Survey Book 3, Page 151  
Auglaize County Engineer's Office

1912 Survey by F.A. Runkle  
Auglaize County Surveyor  
Survey Book 3, Page 219  
Auglaize County Engineer's Office

Survey by Thomas Steinke  
1.00 Acre Survey

Survey by James Kent  
1.152 Acre Survey  
for Neil Shroyer

Survey by Ted K. Schnell  
6.384 Acre Survey  
for Evelyn Minnich

ATTEST

*Ted K. Schnell*  
Ted K. Schnell  
Professional Engineer  
Professional Surveyor

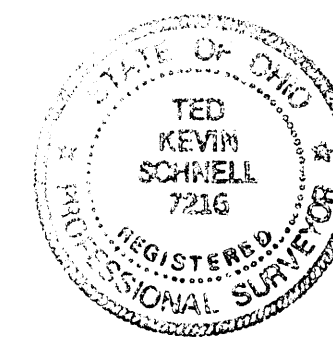
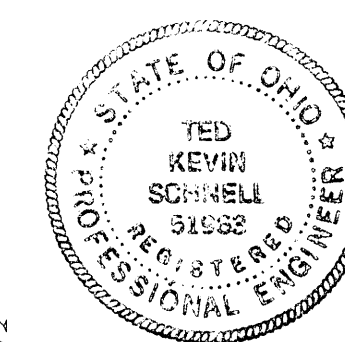

## DEED REFERENCES

Previous Deed References  
Volume 189  
Page 772

## SCALE

0 200 400 600

H & S Civil Engineers and Land Surveyors

Tom Kaverman client	21 section	6 town	7 range
Auglaize county	Clay township	11/96 date	1/1 page

CLA-21-1

## H & S Civil Engineers and Land Surveyors

913 Fieldstone Court  
Wapakoneta, Ohio 45895  
(419) 738-4758

Ted K. Schnell P.E., P.S.  
Greg B. Huber P.E.

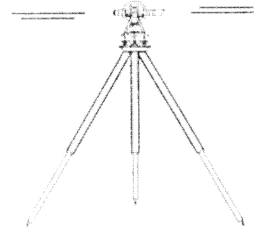

### SURVEYOR'S DESCRIPTION 1.129 ACRE PARCEL

THE FOLLOWING DESCRIBED PARCEL OF LAND IS SITUATED IN THE NORTHEAST FRACTIONAL QUARTER OF SECTION 21, CLAY TOWNSHIP, TOWN-6-SOUTH, RANGE-7-EAST, AUGLAIZE COUNTY, OHIO, AND IS MORE PARTICULARLY DESCRIBED AS FOLLOWS:

COMMENCING FOR REFERENCE AT A RAILROAD SPIKE SITUATED AT THE INTERSECTION OF THE CENTERLINE OF GEYER DRIVE (COUNTY ROAD #108A) WITH THE EAST LINE OF THE NORTHEAST FRACTIONAL QUARTER OF SAID SECTION 21, CLAY TOWNSHIP;

THENCE WITH A BEARING OF S. 71°-11' W. ALONG THE CENTERLINE OF GEYER DRIVE FOR A DISTANCE OF 2,136.51 FEET TO A P.K. NAIL/SHINER AND THE PLACE OF BEGINNING;

THENCE WITH A BEARING OF S. 03°-30'-37" E. FOR A DISTANCE OF 226.64 FEET TO AN IRON PIN, AND PASSING THRU AN IRON PIN FOR REFERENCE ON THE SOUTHERLY RIGHT-OF-WAY LINE OF GEYER DRIVE AT 25.92 FEET;

THENCE WITH A BEARING OF S. 71°-11' W. FOR A DISTANCE OF 225.00 FEET TO AN IRON PIN;

THENCE WITH A BEARING OF N. 03°-30'-37" W. FOR A DISTANCE OF 226.64 FEET TO A P.K. NAIL/SHINER, AND PASSING THRU AN IRON PIN FOR REFERENCE ON THE SOUTHERLY RIGHT-OF-WAY LINE OF GEYER DRIVE AT 200.72 FEET;

THENCE WITH A BEARING OF N. 71°-11" E. ALONG THE CENTERLINE OF GEYER DRIVE FOR A DISTANCE OF 225.00 FEET TO A P.K. NAIL/SHINER AND THE PLACE OF BEGINNING.

CONTAINING IN ALL 1.129 ACRES OF LAND, OF WHICH 0.129 ACRE BEING PREVIOUSLY DEDICATED FOR HIGHWAY PURPOSES. THE ABOVE DESCRIBED PARCEL OF LAND IS ALSO SUBJECT TO ALL OTHER LEGAL EASEMENTS, RESERVATIONS, OR RESTRICTIONS, IF ANY, UPON SAID PREMISES. PREVIOUS DEED REFERENCES: DEED VOLUME 189, PAGE 772, AUGLAIZE COUNTY RECORDER'S OFFICE.

BEARINGS WERE BASED UPON PREVIOUS SURVEYS ON FILE WITH THE AUGLAIZE COUNTY ENGINEER'S TAX MAP OFFICE.

PREPARED BY:

*Ted K. Schnell*

TED K. SCHNELL  
PROFESSIONAL ENGINEER  
PROFESSIONAL SURVEYOR

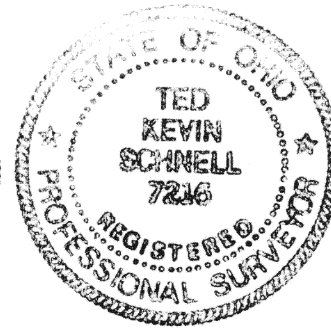

subdivision developments • construction staking • topographic surveys • drainage analysis  
lot surveys • on-site septic systems • farm surveys • ohio epa SWPP plans

## H & S Civil Engineers and Land Surveyors

913 Fieldstone Court  
Wapakoneta, Ohio 45895  
(419) 738-4758

Ted K. Schnell P.E., P.S.  
Greg B. Huber P.E.

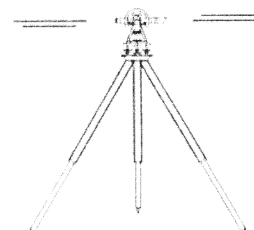

### SURVEYOR'S DESCRIPTION 5.010 ACRE PARCEL

THE FOLLOWING DESCRIBED PARCEL OF LAND IS SITUATED IN THE NORTHEAST AND SOUTHEAST FRACTIONAL QUARTERS OF SECTION 21, CLAY TOWNSHIP, TOWN-6-SOUTH, RANGE-7-EAST, AUGLAIZE COUNTY, OHIO, AND IS MORE PARTICULARLY DESCRIBED AS FOLLOWS:

COMMENCING FOR REFERENCE AT A RAILROAD SPIKE SITUATED AT THE INTERSECTION OF THE CENTERLINE OF GEYER DRIVE (COUNTY ROAD #108A) WITH THE EAST LINE OF THE NORTHEAST FRACTIONAL QUARTER OF SAID SECTION 21, CLAY TOWNSHIP;

THENCE WITH A BEARING OF S. 71°-11' W. ALONG THE CENTERLINE OF GEYER DRIVE FOR A DISTANCE OF 2,361.51 FEET TO A P.K. NAIL/SHINER AND THE PLACE OF BEGINNING;

THENCE WITH A BEARING OF S. 03°-30'-37" E. FOR A DISTANCE OF 2,172.95 FEET TO AN IRON PIN, AND PASSING THRU AN IRON PIN FOR REFERENCE ON THE SOUTHERLY RIGHT-OF-WAY LINE OF GEYER DRIVE AT 25.92 FEET;

THENCE WITH A BEARING OF S. 86°-29'-23" W. FOR A DISTANCE OF 269.23 FEET TO AN IRON PIN;

THENCE WITH A BEARING OF N. 03°-30'-37" W. FOR A DISTANCE OF 514.75 FEET TO AN IRON PIN;

THENCE WITH A BEARING OF N. 86°-29'-23" E. FOR A DISTANCE OF 221.00 FEET;

THENCE WITH A BEARING OF N. 03°-30'-37" W. FOR A DISTANCE OF 1,645.00 FEET TO A P.K. NAIL/SHINER, AND PASSING THRU AN IRON PIN FOR REFERENCE ON THE SOUTHERLY RIGHT-OF-WAY LINE OF GEYER DRIVE AT 1,619.08 FEET;

THENCE WITH A BEARING OF N. 71°-11" E. ALONG THE CENTERLINE OF GEYER DRIVE FOR A DISTANCE OF 50.00 FEET TO A P.K. NAIL/SHINER AND THE PLACE OF BEGINNING.

CONTAINING IN ALL 5.010 ACRES OF LAND, OF WHICH 0.029 ACRE BEING PREVIOUSLY DEDICATED FOR HIGHWAY PURPOSES. THE ABOVE DESCRIBED PARCEL OF LAND IS ALSO SUBJECT TO ALL OTHER LEGAL EASEMENTS, RESERVATIONS, OR RESTRICTIONS, IF ANY, UPON SAID PREMISES. PREVIOUS DEED REFERENCES: DEED VOLUME 189, PAGE 772, AUGLAIZE COUNTY RECORDER'S OFFICE.

BEARINGS WERE BASED UPON PREVIOUS SURVEYS ON FILE WITH THE AUGLAIZE COUNTY ENGINEER'S TAX MAP OFFICE.

PREPARED BY:

*Ted K. Schnell*

TED K. SCHNELL  
PROFESSIONAL ENGINEER  
PROFESSIONAL SURVEYOR

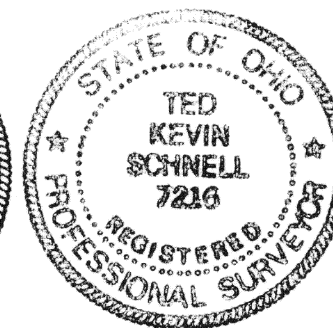

subdivision developments • construction staking • topographic surveys • drainage analysis  
lot surveys • on-site septic systems • farm surveys • ohio epa SWPP plans