

*PLAT OF SURVEY
FOR
CRAFT ESTATE*

NORTH AND BEARING
SYSTEM BASED ON
OHIO NORTH STATE
PLANE GRID, NAD 83
ADJ. 2011.

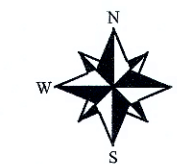

CURVE	RADIUS	ARC LENGTH	CHORD LENGTH	CHORD BEARING	DELTA ANGLE
C1	160.00'	169.71'	161.86'	S23°03'46"E	60°46'21"

LEGEND:

- ◐ MAG NAIL FOUND
- ◑ PK NAIL FOUND
- ◊ WOOD POST FOUND
- ◻ MONUMENT BOX FOUND
- 5/8" IRON PIN FOUND
- MAG NAIL SET
- 5/8" IRON PIN W/ CAP SET

NOTES:
FOUND MONUMENTATION IN GOOD CONDITION
UNLESS OTHERWISE NOTED.
DATA SOURCES INCLUDE DOCUMENTS CITED.
A TITLE SEARCH IS RECOMMENDED TO DETERMINE
EASEMENTS, RESTRICTIONS, AND/OR OTHER
ENCUMBRANCES AFFECTING THE PROPERTY
SHOWN HEREON.

THIS PLAT IS BASED ON AN ACTUAL FIELD SURVEY.

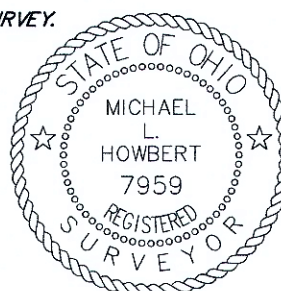

MICHAEL L. HOWBERT
REGISTERED PROFESSIONAL
SURVEYOR NO. 7959 IN OHIO
MAY 18, 2022



DATE: 5/18/22	REV.:
CLIENT: CRAFT	SCALE: 1" = 250'
JOB #: 205-05-22	CHK:

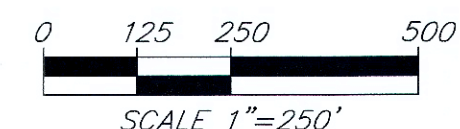



Description
35.063 Acres

Situated in the Southeast quarter of Section 7, Town 5 South, Range 6 East, Duchouquet Township, Auglaize County, Ohio, being part of the southeast quarter of the southeast quarter as described deed recorded in Official Record Volume 697, Page 5408 of said County Deed Records and being more particularly described as follows;

Beginning at the southeast corner of the southeast quarter of said Section 7, being a monument box found;

Thence along the south line of said southeast quarter, S.89°49'19"W., a distance of 921.23 feet to a mag nail found at the southeast corner of a 4.002 acre tract as described in Official Record Volume 713, Page 1954;

Thence running along said 4.002 acre tract on the following three (3) courses and distances:

1. N.00°10'39"W., a distance of 591.00 feet to a 5/8" iron pin found, passing a 5/8" iron pin found at 25.00 feet;
2. S.89°49'21"W., a distance of 295.00 feet to a 5/8" iron pin found;
3. S.00°10'39"E., a distance of 591.00 feet to a mag nail found in the south line of said southeast quarter, passing a 5/8" iron pin found at 566.00 feet;

Thence on said south line, S.89°49'19"W., a distance of 113.38 feet to a mag nail set at the southwest corner of the southeast quarter of said southeast quarter;

Thence along the west line of said southeast quarter of the southeast quarter, N.00°36'40"E., a distance of 1279.93 feet to a 5/8" iron pin set;

Thence on a new division line, N.89°47'52"E., a distance of 1329.13 feet to a mag nail set in the east line of said southeast quarter, passing a 5/8" iron pin set at 1289.13 feet;

Thence along the east line of said southeast quarter of the southeast quarter, S.00°35'22"W., a distance of 1280.49 feet to the **Point of Beginning**;

Containing 35.063 acres, more or less, and being subject to all legal highways, rights-of-way, easements, restrictions, covenants, and/or conditions of record.

Part of Parcel Number: B0500701301

The above description based on a survey prepared by Michael L. Howbert, Registered Professional Surveyor No. 7959, in January of 2023. The basis of bearing is based on Ohio North State Plane Grid, NAD 83, Adjustment 2011.



Michael L. Howbert, P.S.



Description
18.750 Acres

Situated in the Southeast quarter of Section 7, Town 5 South, Range 6 East, Duchouquet Township, Auglaize County, Ohio, being all of the south 18.75 acres of the northwest quarter of the southeast quarter as described deed recorded in Official Record Volume 697, Page 5408 of said County Deed Records and being more particularly described as follows;

Commencing at the southeast corner of the southeast quarter of said Section 7, being a monument box found;

Thence along the south line of said southeast quarter, S.89°49'19"W., a distance of 1329.61 feet to a mag nail set at the southwest corner of the southeast quarter of the southeast quarter;

Thence along the west line of said southeast quarter of the southeast quarter, N.00°36'40"E., a distance of 1379.10 feet to a 5/8" iron pin set at the northeast corner of the south 1.5 acres off the south side of the northwest quarter of the southeast quarter as originally described in Official Record Volume 635, Page 1520, being the **Principal Point of Beginning**;

Thence on the north line of said south 1.5 acres, S.89°47'52"W., a distance of 1329.10 feet to a 5/8" iron pin set;

Thence along the west line of said northwest quarter of the southeast quarter, N.00°37'58"E., a distance of 614.63 feet to a 5/8" iron pin set at the northwest corner of the south 18.75 acres of the northwest quarter of the southeast quarter;

Thence on the north line of the south 18.75 acres of the northwest quarter of the southeast quarter, N.89°47'52"E., a distance of 1328.87 feet to a 5/8" iron pin set at the northeast corner of the south 18.75 acres of the northwest quarter of the southeast quarter;

Thence on the east line of said northwest quarter of the southeast quarter, S.00°36'40"W., a distance of 614.63 feet to the **Point of Beginning**;

Containing 18.750 acres, more or less, and being subject to all legal highways, rights-of-way, easements, restrictions, covenants, and/or conditions of record.

Part of Parcel Number: B0500701301

The above description based on a survey prepared by Michael L. Howbert, Registered Professional Surveyor No. 7959, in January of 2023. The basis of bearing is based on Ohio North State Plane Grid, NAD 83, Adjustment 2011.



Michael L. Howbert, P.S.



Description
0.167 Acre

Situated in the Southeast quarter of Section 7, Town 5 South, Range 6 East, Duchouquet Township, Auglaize County, Ohio, being part of the northeast quarter of the southeast quarter as described deed recorded in Official Record Volume 305, Page 902 of said County Deed Records and being more particularly described as follows;

Commencing at the southeast corner of the southeast quarter of said Section 7, being a monument box found;

Thence along the south line of said southeast quarter, S.89°49'19"W., a distance of 1329.61 feet to a mag nail set at the southwest corner of the southeast quarter of the southeast quarter;

Thence along the west line of said southeast quarter of the southeast quarter, N.00°36'40"E., a distance of 1329.93 feet to a 5/8" iron pin set at the southwest corner of the northeast quarter of said southeast quarter, being the **Principal Point of Beginning**;

Thence on the west line of the northeast quarter of the southeast quarter, N.00°36'40"E., a distance of 149.17 feet to a 5/8' iron pin set;

Thence on a new division line along a curve the right having a radius of 160.00 feet (chord bearing, S.23°03'46"E., a chord distance of 161.86 feet having a delta angle of 60°46'21") an arc length of 169.71 feet to a 5/8" iron pin set at in the south line of the northeast quarter of the southeast quarter;

Thence along said south line, S.89°47'52"W., a distance of 65.00 feet the **Point of Beginning**;

Containing 0.167 acre, more or less, and being subject to all legal highways, rights-of-way, easements, restrictions, covenants, and/or conditions of record.

Part of Parcel Number: B0500701201

The above description based on a survey prepared by Michael L. Howbert, Registered Professional Surveyor No. 7959, in January of 2023. The basis of bearing is based on Ohio North State Plane Grid, NAD 83, Adjustment 2011.



Michael L. Howbert, P.S.



Description 1.526 Acres

Situated in the Southeast quarter of Section 7, Town 5 South, Range 6 East, Duchouquet Township, Auglaize County, Ohio, being part of the southeast quarter of the southeast quarter as described deed recorded in Official Record Volume 697, Page 5408 of said County Deed Records and being more particularly described as follows;

Commencing at the southeast corner of the southeast quarter of said Section 7, being a monument box found;

Thence along the east line of said southeast quarter, N.00°35'22"E., a distance of 1280.49 feet to a mag nail set, being the *Principal Point of Beginning*;

Thence on a new division line, S.89°47'52"W., a distance of 1329.13 feet to a 5/8' iron pin set;

Thence on the west line of the southeast quarter of the southeast quarter, N.00°36'40"E., a distance of 50.01 feet to a 5/8' iron pin set at the northwest corner of the southeast quarter of said southeast quarter;

Thence on the north line of said southeast quarter of the southeast quarter, N.89°47'52"E., a distance of 1329.12 feet to a mag nail set at the northeast corner of the southeast quarter of said southeast quarter, passing a 5/8' iron pin set at 1289.12 feet;

Thence along the east line of said southeast quarter of the southeast quarter, S.00°35'22"W., a distance of 50.00 feet to the **Point of Beginning**;

Containing 1.526 acres, more or less, and being subject to all legal highways, rights-of-way, easements, restrictions, covenants, and/or conditions of record.

Part of Parcel Number: B0500701201

The above description based on a survey prepared by Michael L. Howbert, Registered Professional Surveyor No. 7959, in January of 2023. The basis of bearing is based on Ohio North State Plane Grid, NAD 83, Adjustment 2011.



Michael L. Howbert, P.S.



Description
0.400 Acre

Situated in the Southeast quarter of Section 7, Town 5 South, Range 6 East, Duchouquet Township, Auglaize County, Ohio, being all of the northwest quarter of the southeast quarter as described deed recorded in Official Record Volume 697, Page 5408 of said County Deed Records and being more particularly described as follows;

Commencing at the southeast corner of the southeast quarter of said Section 7, being a monument box found;

Thence along the south line of said southeast quarter, S.89°49'19"W., a distance of 1329.61 feet to a mag nail set at the southwest corner of the southeast quarter of the southeast quarter;

Thence along the west line of said southeast quarter of the southeast quarter, N.00°36'40"E., a distance of 1379.10 feet to a 5/8" iron pin set at the northeast corner of the south 1.5 acres off the south side of the northwest quarter of the southeast quarter as originally described in Official Record Volume 635, Page 1520;

Thence along the east line of the south 18.750 acres as described in Official Record Volume 697, Page 5408, N.00°36'40"E., a distance of 614.63 feet to a 5/8" iron pin set at the northeast corner of said 18.750 acre tract, being the **Principal Point of Beginning**;

Thence on the north line of said south 18.750 acres, S.89°47'52"W., a distance of 1328.87 feet to a 5/8" iron pin set;

Thence along the west line of said northwest quarter of the southeast quarter, N.00°37'58"E., a distance of 11.10 feet to the southwest corner of the north 19.75 acres of the northwest quarter of the southeast quarter;

Thence on the south line of the north 19.75 acres of the northwest quarter of the southeast quarter, N.89°37'26"E., a distance of 1328.93 feet to the southeast corner of said north 19.75 acre tract;

Thence on the east line of said northwest quarter of the southeast quarter, S.00°36'40"W., a distance of 15.14 feet to the **Point of Beginning**;

Containing 0.400 acre, more or less, and being subject to all legal highways, rights-of-way, easements, restrictions, covenants, and/or conditions of record.

Part of Parcel Number: B0500701301

The above description based on a survey prepared by Michael L. Howbert, Registered Professional Surveyor No. 7959, in January of 2023. The basis of bearing is based on Ohio North State Plane Grid, NAD 83, Adjustment 2011.



Michael L. Howbert, P.S.