

KEMP ROAD

West 1/4 Corner, Section 30

## MERSCHMAN BOUNDARY SURVEY

Being a part of the NE & NW 1/4 of Section 30, Town-4-South, Range-6-East, Shawnee Township, Allen County, Ohio as evidenced by Deed Volume 729, Page 210 and a part of the north one half of the north half of Section 31, Town-4-South, Range-6-East, Duchouquet Township, Auglaize County, Ohio as evidenced by Official Record Volume 428, Page 781 and being Parcel No. B0503100401.

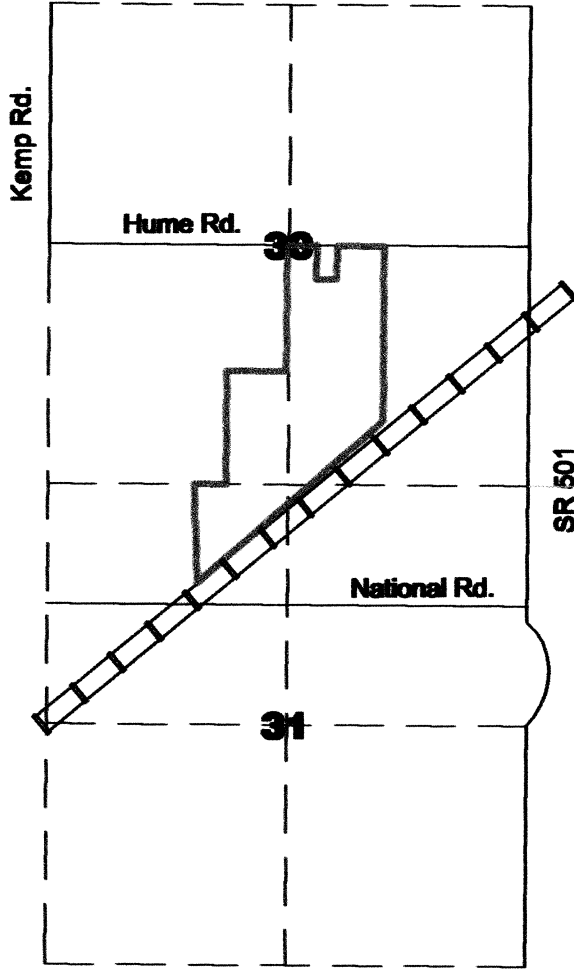

VICINITY MAP  
SECTION 30, SHAWNEE TWP. ALLEN CO.  
SECTION 31, DUCHOUQUET TWP.  
AUGLAIZE COUNTY

### LEGEND

- Monument Box (found) □ Wood end post (found)
- 1/2" re-rod (found) ○ 4" dia. steel post (found)
- 5/8" re-rod w/cap (set)
- ⊙ mag-nail (set)
- ⊙ mag-nail (found)

### SURVEY REFERENCES

- "Hixenbaugh Plat" by Christopher S. Harmon  
P.S. No. 7988 dated January 3, 2001
- "Dennis Coby Survey" by John W. Jauert,  
P.S. No. 6920 dated June, 2007
- "John Mueller Boundary Survey" by James  
M. Kent, P.S. No. 6792 dated December 21,  
2005
- "Donna J. Core" survey by Richard D.  
Morrissey, P.S. No. 6470 dated December 30,  
1995

WOODED

**Tract Two**  
14.249 acres

Dennis Coby  
OR 573, Page 1643

Paul E. Neff  
Volume 948, Page 191

**Tract One**  
74.905 acres

(55.055 acres in NE 1/4, 19.850 acres in NW 1/4)  
0.387 acres road right-of-way

SHAWNEE TWP., ALLEN COUNTY  
DUCHOUQUET TWP., AUGLAIZE COUNTY

John E. Hixenbaugh  
Volume 2010,  
Page 10495

STATE ROUTE 501

HUME ROAD (40' RW)

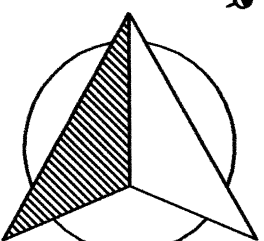

NORTH

GRAPHIC SCALE



( IN FEET )  
1 inch = 200 ft.

I hereby certify that this plat is representative  
of a field survey conducted under my direct  
supervision.

*James M. Kent*  
James M. Kent, Professional Surveyor No. 6792

**kent surveying, inc.**

AutoCAD ~ Merschman 1750 Bellefontaine St.  
Drawing #5557 Wapakoneta, OH 45895  
September, 2015 419.738.7948

DUC-31-35

Merschman Boundary Survey  
Tract Two



**SURVEYOR'S DESCRIPTION**

scale:

Being a part of the north half of the north half of Section 31, Town-4-South, Range-6-East, Duchouquet Township, Auglaize County, Ohio as evidenced by Official Record Volume 428, Page 781 and more particularly described as follows:

Commencing for reference at a monument box (found) at the southeast corner of the north half of the north half of Section 31 and the centerline intersection of State Route 501 and National Road; thence, N 89° 09' 52" W along the south line of the north half of the north half and the centerline of National Road for a distance of 3775.84 feet to a mag-nail (found) the north line of the R.J. Corman Railroad Co. Western Ohio line; thence, N 49° 57' 47" E along the aforesaid north line for a distance of 505.01 feet to a 1/2" re-rod (found), said re-rod being the **POINT OF BEGINNING** for the tract herein described;

thence, N 01° 24' 41" W for a distance of 1020.32 feet to a 1/2" re-rod (found) on the Auglaize/Allen County line;

thence, S 89° 08' 38" E along the aforesaid line for a distance of 1217.62 feet to a 5/8" re-rod w/cap (set) on the north line of the R.J. Corman Railroad Co. Western Ohio line;

thence, S 49° 57' 47" W along the aforesaid line for a distance of 1557.35 feet to the **POINT OF BEGINNING** containing therein 14.249 acres. Subject to all easements and right-of-way of record at the time of the recording of this instrument. Basis of bearings is per Auglaize County GPS of the south line of the north half of the north half of Section 31, T-4-S, R-6-E, Duchouquet Township, Auglaize County and the centerline of National Road as N 89° 09' 52" W. Prepared by James M. Kent, Professional Surveyor No. 6792 with reference herein made to a plat of survey; Kent Surveying, Inc. drawing #5557 dated September, 2015.

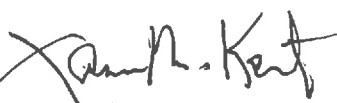
  
James M. Kent, PS 6792



CLIENT MERSCHMAN DATE 9-18-15  
COUNTY AUGLAIZE TOWNSHIP DUCHOUQUET  
SECTION 31 T-4-S; R-6-E DRAWN BY JMK  
SHEET 2 OF 2 DWG. # 5557

 **kent surveying, inc.**  
P.O. Box 96 - 1750 Bellefontaine Street  
Wapakoneta, OH 45895  
419-738-5677 fax 419-738-7894

DVC-31-35A