

NW Corner,
NE 1/4, Section 33

S89°39'14"E

2651.86'

MIDDLE PIKE

1325.93'

NE Corner,
NE 1/4, Section 33

Charles Kantner Survey

Part of the North Half of the Southeast Quarter,
of the Northeast Quarter of Section 33,

Town-5-South, Range-6-East,

Duchouquet Township,

Auglaize County, Ohio.

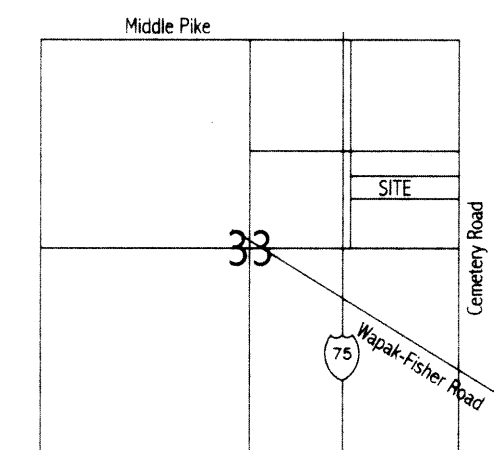

VICINITY MAP - SECTION 33

NE Corner,
SE 1/4, NE 1/4,
Section 33
(Point of Commencement)

LEGEND

- Monument Box (found)
- 1-1/2" Iron Bar (found)
- 5/8" re-rod w/cap (set)
- Cotton Gin Spindle (set)
- Cotton Gin Spindle (found)

Basis of bearings per Auglaize County
GPS of the west line of the northwest
quarter @ N 01°15'24" E

I hereby certify that this plat represents an
accurate survey, performed under my direct
supervision during January, 2002.

James M. Kent
James M. Kent, PS 6792 OH

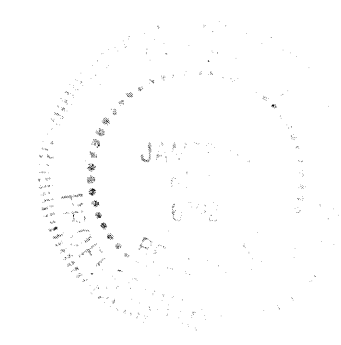

kent surveying
acad - kantner
drawing # 3869
March 5, 2002

2670.16'

N01°14'36"E

1335.08'

CITY OF WAPAKONETA

Quaker Run Farms, Ltd.
OR Volume 256, Page 260

INTERSTATE ROUTE 75

S01°15'00"W

332.38'

N01°15'00"E

333.52'

Wapak KOA Partnership
OR Volume 436, Page 608

S89°47'45"E
1325.79'

Charles L. & Joyce E. Kantner, (Trustees)
Volume 169, Page 929
10.124 Acres
(0.190 acres right-of-way)

1325.79'
N89°52'01"W

Quaker Run

Noel & Alice Gonterman
OR Volume 363, Page 519

1325.74'

2651.48'

N89°56'16"W

1328.51'
S01°15'24"W

332.38'
S01°15'24"W

331.88'
S01°15'24"W

664.26'
S01°15'24"W

CEMETERY ROAD (50' RW)

SE Corner,
NE 1/4, Section 33

BELLEFONTAINE STREET

SW Corner,
NE 1/4, Section 33

GRAPHIC SCALE



(IN FEET)
1 inch = 200 ft.

Auglaize County GPS

DUC-33-11

Charles Kantner



scale:

LEGAL DESCRIPTION

Being a part of the north half of the southeast quarter of the northeast quarter of Section 33, Town-5-South, Range-6-East, Duchouquet Township, Auglaize County, Ohio, as evidenced by Deed Volume 169, Page 929 and more particularly described as follows:

Commencing for reference at a monument box (found) at the southeast corner of the northeast quarter of Section 33 and the centerline of Cemetery Road; thence, N 01 degree 15' 24" E along the east line of the northeast quarter of Section 33 and the centerline of Cemetery Road, for a distance of 664.26 feet to a cotton gin spindle (set) at the southeast corner of the north half of the southeast quarter of the northeast quarter of Section 33, said spindle being the **POINT OF BEGINNING** for the tract herein described;

thence, N 89 degrees 52' 01" W along the south line of the north half of the southeast quarter of the northeast quarter of Section 33 (passing through a 5/8" re-rod w/cap set on the west right-of-way line of Cemetery Road at a distance 25.00 feet) for a total distance of 1325.79 feet to a 5/8" re-rod w/cap (set) at the southwest corner of the north half of the southeast quarter of the northeast quarter of Section 33;

thence, N 01 degree 15' 00" E along the west line of the southeast quarter of the northeast quarter of Section 33, for a distance of 333.52 feet to a 5/8" re-rod w/cap (set);

thence, S 89 degrees 47' 45" E (passing through a 5/8" re-rod w/cap set on the west right-of-line of Cemetery Road at a distance of 1300.79 feet) for a total distance of 1325.79 feet to a cotton gin spindle (set) on the east line of the southeast quarter of the northeast quarter of Section 33 and the centerline of Cemetery Road;

thence, S 01 degree 15' 24" W along the aforesaid east line and centerline, for a distance of 331.88 feet to the **POINT OF BEGINNING**, containing therein 10.124 acres, of which 0.190 acres is road right-of-way. Subject to all easements and right-of-way of record at the time of the recording of this instrument. Prepared by James M. Kent, PS 6792 OH, with reference hereby made to a plat of survey; Kent Surveying drawing #3869 dated March 5, 2002. Basis of bearings per Auglaize County GPS depicting the east line of the northeast quarter of Section 33 as N 01 degree 15' 24" E.

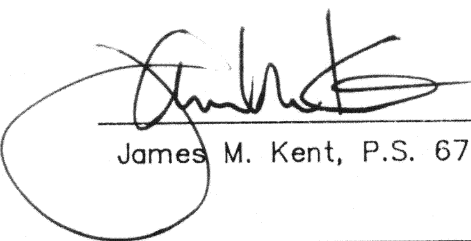
James M. Kent, P.S. 6792 OH

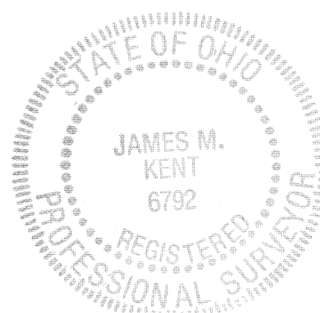

CLIENT CHARLES KANTNER DATE 3-5-02
COUNTY AUGLAIZE TOWNSHIP
SECTION 33 T-5-S; R-6-E
DRAWN BY JMK DRAWING NO. 3869
SHEET 1 OF 1

kent
surveying
p.o. box 96 • 419/738-5677
wapakoneta, ohio