

FEB 12 2003
KENT SURVEYING

Part of the N.W. Quarter of Section 34,
Town-4-South, Range-6-East,
Duchouquet Township, Auglaize County, Ohio
as evidenced by O.R. Volume 231, Page 937.

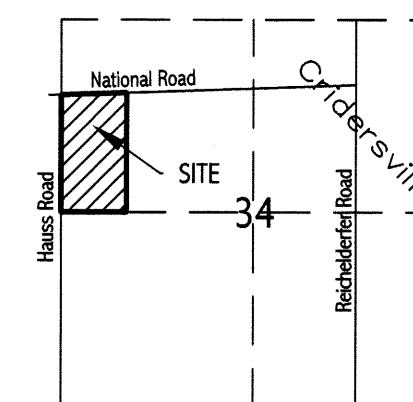

VICINITY MAP - SECTION 34

legend

- "A" □ Monument Box (found)
 "B" ● 5/8" re-rod (found)
 "C" ● 1" Iron Pipe {K&K} (found)
 "D" ∅ "mag" nail (set)
 "E" ☆ Cotton Gin Spindle (set)
 "F" ● 5/8" re-rod w/cap (set)

survey references

- "Otterbein Homes" Survey by Kohli & Kaliher Drawing "H" 551 dated 10-23-86.
- "Kissell Company" Survey by Thomas C. Hubbell, PS 5044 dated 12-14-84.
- Jauert Surveying - field notes determining location of West Quarter Corner. Sec. 34

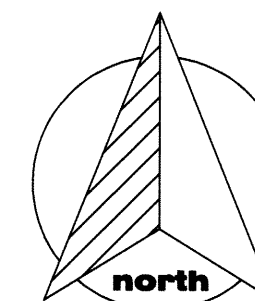

Basis of bearings per Auglaize County GPS depicting the centerline of National Road (box to box) as N 89°13'39"E

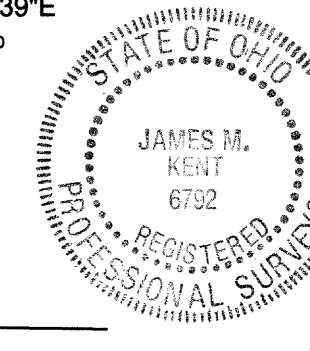
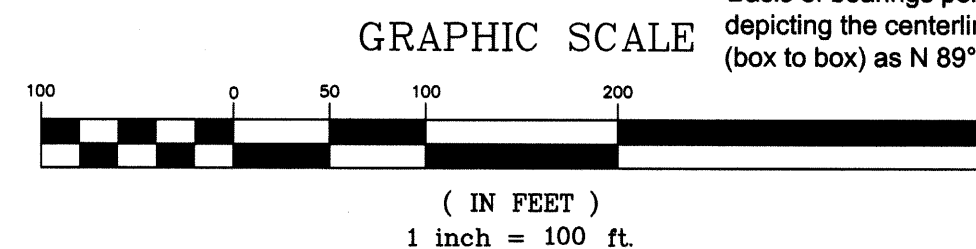

I hereby certify that this plat depicts a field survey,
performed under my direct supervision on the date
shown hereon.

JAMES M. KENT, PS 6792
1750 Bellefontaine Street
Wapakoneta, OH 45895

kent surveying, inc.

Myers Estate Survey
acad - myers estate
drawing #4063
February 12, 2003

DUC-34-9

Myers Estate Survey - Tract One

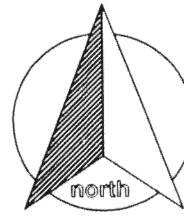

scale:

LEGAL DESCRIPTION

Being a part of the northwest quarter of Section 34, Town-4-South, Range-6-East, Duchouquet Township, Auglaize County, Ohio as evidenced by Official Record Volume 231, Page 937 and more particularly described as follows:

Commencing for reference at a monument box (found) at the northwest corner of the northwest quarter of Section 34, and the centerline of Hauss Road; thence, S 00 degrees 44' 50" W along the west line of the northwest quarter and the centerline of Hauss Road, for a distance of 1255.72 feet to a monument box (found) at the centerline intersection of the aforesaid west line and centerline of Hauss Road with the centerline of National Road; thence, N 89 degrees 13' 39" E along the centerline of National Road, for a distance of 482.81 feet to a cotton gin spindle (set), said spindle being the **POINT OF BEGINNING** for the tract herein described;

thence, continuing along the centerline of National Road, N 89 degrees 13' 39" E for a distance of 317.51 feet to a "mag" nail (set);

thence, S 00 degrees 06' 24" E (passing through a 5/8" re-rod w/cap set on the south right-of-way line of National Road at a distance of 25.00 feet) for a total distance of 470.01 feet to a 5/8" re-rod w/cap (set);

thence, N 89 degrees 16' 54" W (passing through an eight inch square concrete post at a distance of 10.65 feet) for a total distance of 315.01 feet to a 5/8" re-rod w/cap (set);

thence, N 00 degrees 25' 05" W (passing through a 5/8" re-rod w/cap set on the south right-of-way line of National Road at a distance of 436.79 feet) for a total distance of 461.79 feet to the **POINT OF BEGINNING**, containing therein 3.382 acres, of which 0.182 acres is road right-of-way. Subject to all easements and right-of-way of record at the time of the recording of this instrument. Prepared by James M. Kent, PS 6792, with reference hereby made to a plat of survey; Kent Surveying, Inc. drawing #4063 dated February 12, 2003. Basis of bearings is per Auglaize County GPS depiction of the centerline of National Road between the west line of the northwest quarter and the east line of the northwest quarter as N 89 degrees 13' 39" E.

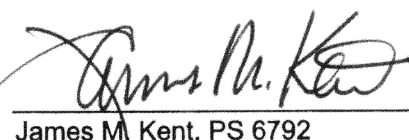

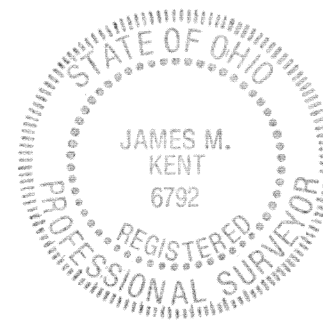
James M. Kent, PS 6792



CLIENT MYERS ESTATE DATE 2-13-03
COUNTY AUGLAIZE TOWNSHIP DUCHOUQUET
SECTION 34 T-4-S; R-6-E DRAWN BY JMK
SHEET 1 OF 2 DWG. # 4063

kent surveying, inc.
P.O. Box 96 - 1750 Bellefontaine Street
Wapakoneta, OH 45895
419-738-5677 fax 419-738-7894

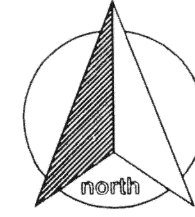
Myers Estate Survey - Tract Two



scale:

LEGAL DESCRIPTION

Being a part of the northwest quarter of Section 34, Town-4-South, Range-6-East, Duchouquet Township, Auglaize County, Ohio as evidenced by Official Record Volume 231, Page 937 and more particularly described as follows:

Commencing for reference at a monument box (found) at the northwest corner of the northwest quarter of Section 34, and the centerline of Hauss Road; thence, S 00 degrees 44' 50" W along the west line of the northwest quarter and the centerline of Hauss Road, for a distance of 1255.72 feet to a monument box (found) at the centerline intersection of the aforesaid west line and centerline of Hauss Road with the centerline of National Road, said box being the **POINT OF BEGINNING** for the tract herein described;

thence, along the centerline of National Road, N 89 degrees 13' 39" E for a distance of 428.81 feet to a cotton gin spindle (set);

thence, S 00 degrees 25' 05" E (passing through a 5/8" re-rod w/cap set on the south right-of-way line of National Road at a distance of 25.00 feet) for a total distance of 461.79 feet to a 5/8" re-rod w/cap (set);

thence, S 89 degrees 16' 54" E (passing through an eight inch square concrete post at a distance of 304.36 feet) for a total distance of 315.01 feet to a 5/8" re-rod w/cap (set);

thence, S 00 degrees 06' 24" E for a distance of 941.47 feet to a 5/8" re-rod w/cap (set) on the south line of the northwest quarter of Section 34;

thence, N 89 degrees 24' 11" W along the aforesaid south line, (passing through a 5/8" re-rod w/cap set on the east right-of-way line of Hauss Road at a distance of 801.07 feet) for a total distance of 821.07 feet to a "mag" nail (set) at the southwest corner of the northwest quarter of Section 34;

thence, N 00 degrees 44' 50" E along the west line of the northwest quarter and the centerline of Hauss Road, for a distance of 1392.25 feet to the **POINT OF BEGINNING**, containing therein 22.705 acres, of which 0.905 acres is road right-of-way. Subject to all easements and right-of-way of record at the time of the recording of this instrument. Prepared by James M. Kent, PS 6792, with reference hereby made to a plat of survey; Kent Surveying, Inc. drawing #4063 dated February 12, 2003. Basis of bearings is per Auglaize County GPS depiction of the centerline of National Road between the west line of the northwest quarter and the east line of the northwest quarter as N 89 degrees 13' 39" E.

James M. Kent, PS 6792

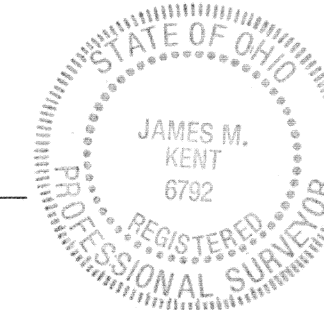

CLIENT MYERS ESTATE DATE 2-13-03
COUNTY AUGLAIZE TOWNSHIP DUCHOUQUET
SECTION 34 T-4-S; R-6-E DRAWN BY JMK
SHEET 2 OF 2 DWG. # 4063

kent surveying, inc.
P.O. Box 96 - 1750 Bellefontaine Street
Wapakoneta, OH 45895
419-738-5677 fax 419-738-7894