

**ANDREWS ESTATE SURVEY**  
PART OF THE EAST HALF OF THE N.E. 1/4 OF SECTION 4,  
TOWN-6-SOUTH, RANGE-8-EAST  
GOSHEN TOWNSHIP, AUGLAIZE COUNTY, OHIO.

Nancy & David  
Steiner (Trustees)  
O.R. Vol. 393, Page 808

**77.828 acres**  
(0.834 acres right-of-way)

J. & E. Andrews  
Deed Volume 231, Page 530

Joe & Jean  
Hprn  
O.R. Vol. 290, Page 230

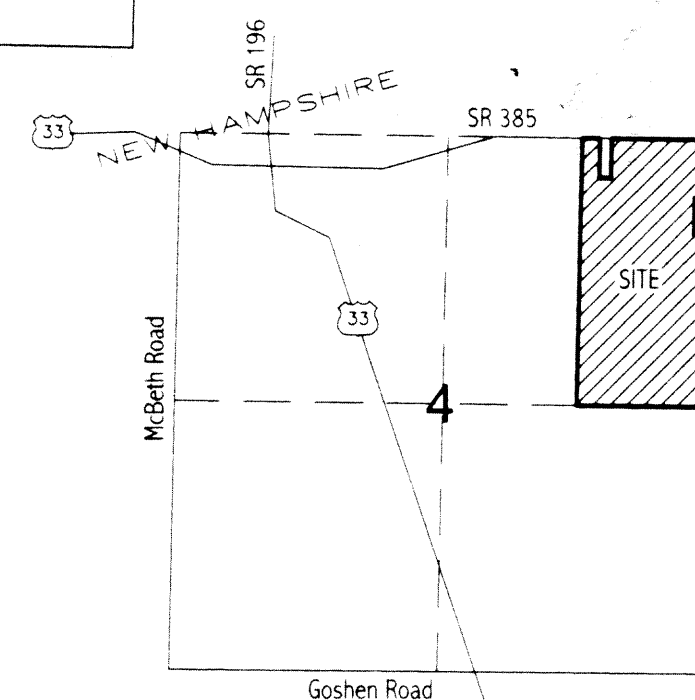

VICINITY MAP - SECTION 4

**LEGEND**

- "A" ✕ p-k nail (found)
- "B" ○ 1" iron pipe (found)
- "C" ○ 5/8" re-rod w/cap (found)
- "D" ○ 2" axel (found)
- "E" ● 5/8" re-rod w/cap (set)
- "F" ☆ cotton gin spindle (set)
- "G" ○ 1" iron pipe w/cap (found)
- "H" ○ 4" diameter steel fence post (found)

I hereby certify that this plat is based upon an accurate field survey conducted under my direct supervision during May & June of 2001.

*James M. Kent*  
James M. Kent, PS 6792 OH

**kent surveying**  
acad - andrews dwg #3742  
June 8, 2001

**4**

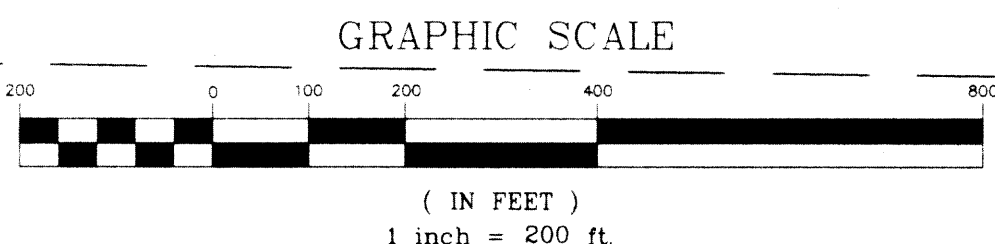

Woodrow  
Searfoss, etal.  
O.R. Vol. 114, Page 164

**GOS-4-2**



scale:

### LEGAL DESCRIPTION

Being a part of the east half of the northeast quarter of Section 4, Town-6-South, Range-8-East, Goshen Township, Auglaize County, Ohio as evidenced by Deed Volume 231, Page 530 and more particularly described as follows:

Commencing for reference at a p-k nail over a stone (found) at the intersection of the centerline of State Route 196 with the north line of Section 4; thence S 89 degrees 16' 49" E along the north line of Section 4 (passing through the calculated position of the north quarter corner of Section 4 at a distance of 1835.90 feet) for a total distance of 3161.20 feet to cotton gin spindle (set) in the centerline of State Route 385 at the northwest corner of the east half of the northeast quarter of Section 4, said spindle being the **POINT OF BEGINNING** for the tract herein described;

thence, continuing along the north line of Section 4 and the centerline of State Route 385, S 89 degrees 16' 49" E for a distance of 180.00 feet to a cotton gin spindle (set);

thence, S 01 degree 06' 12" W (passing through a 5/8" re-rod w/cap set on the south right-of-way line of State Route 385 at a distance of 30.00 feet) for a total distance of 384.00 feet to a 5/8" re-rod w/cap (set);

thence, S 89 degrees 16' 49" E for a distance of 113.00 feet to a 5/8" re-rod w/cap (set);

thence, N 01 degree 06' 12" E (passing through a 5/8" re-rod w/cap set on the south right-of-way line of State Route 385 at a distance of 354.00 feet) for a total distance of 384.00 feet to the centerline of State Route 385 and the north line of Section 4;

thence, along the aforesaid north line and centerline, S 89 degrees 16' 49" E for a distance of 1032.30 feet to a p-k nail (found) at the northeast corner of Section 4;

thence, S 01 degree 06' 12" W along the east line of the northeast quarter of Section 4 (passing through a 5/8" re-rod w/cap (set) on the south right-of-way line of State Route 385 at a distance of 30.00 feet) for a total distance of 567.11 feet to a 5/8" re-rod w/cap (set);

thence, N 88 degrees 53' 48" W for a distance of 200.00 feet to a 1" iron pipe w/cap (found);

thence, S 01 degree 06' 12" W for a distance of 369.49 feet to a 5/8" re-rod w/cap (set);

thence, S 88 degrees 53' 48" E for a distance of 200.00 feet to a 4" diameter steel fence post (found) on the east line of the northeast quarter of Section 4;

thence, S 01 degree 06' 12" W along the east line of the northeast quarter of Section 4 for a distance of 1709.88 feet to a 2" diameter axle (found) at the southeast corner of the northeast quarter of Section 4;

thence, N 89 degrees 18' 29" W along the south line of the northeast quarter of Section 4, for a distance of 1325.11 feet to a 5/8" re-rod w/cap (set) at the southwest corner of the east half of the northeast quarter of Section 4;

thence, N 01 degree 05' 57" E along the west line of the east half of the northeast quarter of Section 4, (passing through a 5/8" re-rod w/cap set on the south right-of-way line of State Route 385 at a distance of 2617.12) for a total distance of 2647.12 feet to the **POINT OF BEGINNING**, containing therein 77.828 acres, of which 0.834 acres is road right-of-way; Subject to all easements and right-of-way of record at the time of the recording of this instrument. Prepared by James M. Kent, PS 6792 OH with reference hereby made to a plat of survey; Kent Surveying drawing #3742 dated June 8, 2001. Basis of bearings per Auglaize County GPS of the south line of the southeast quarter of Section 4 as N 89 degrees 30' 52" W.

James M. Kent, P.S. 6792 OH

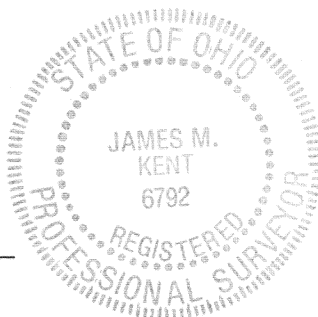

CLIENT ANDREWS DATE 6-08-01  
COUNTY AUGLAIZE TOWNSHIP GOSHEN  
SECTION 4 T-6-S; R-8-E  
DRAWN BY JMK DRAWING NO. 3742  
SHEET 1 OF 1

**kent**  
surveying  
p.o. box 96 • 419/738-5677  
wapakoneta, ohio