

State Route 196

S89°16'49"E  
1835.90'

WAYNE TWP.  
GOSHEN TWP.

S89°16'49"E  
1325.30'

State Route 385 (60' R/W)

30.00'

S89°16'49"E  
180.00'

S89°16'49"E  
502.30'

S89°16'49"E  
530.00'

SEC. 33  
SEC. 34

192.20'

1.44'

N.E. Corner  
Section 4

**ANDREWS' SURVEY**  
PART OF THE EAST HALF OF THE N.E. 1/4 OF SECTION 4,  
TOWN-8-SOUTH, RANGE-8-EAST  
GOSHEN TOWNSHIP, AUGLAIZE COUNTY, OHIO.

25' easement  
for ingress/egress  
19.69'

J. T. Farms, LTD.  
O.R. Vol. 318, Page 314

Joe & Jean  
Horn  
O.R. Vol. 290, Page 230

Nancy & David  
Steiner (Trustees)  
O.R. Vol. 393, Page 808

Crusie & Karen J. Andrews  
OR Volume 585, Page 195  
(Parcel No. D1200400100)

N01°05'57"E  
2647.12'

(N)S01°32'10"W(E)  
2646.95'

**TRACT ONE**  
46.716 acres  
(0.470 acres right-of-way)

**TRACT TWO**  
31.112 acres  
(0.365 acres right-of-way)

WOODED

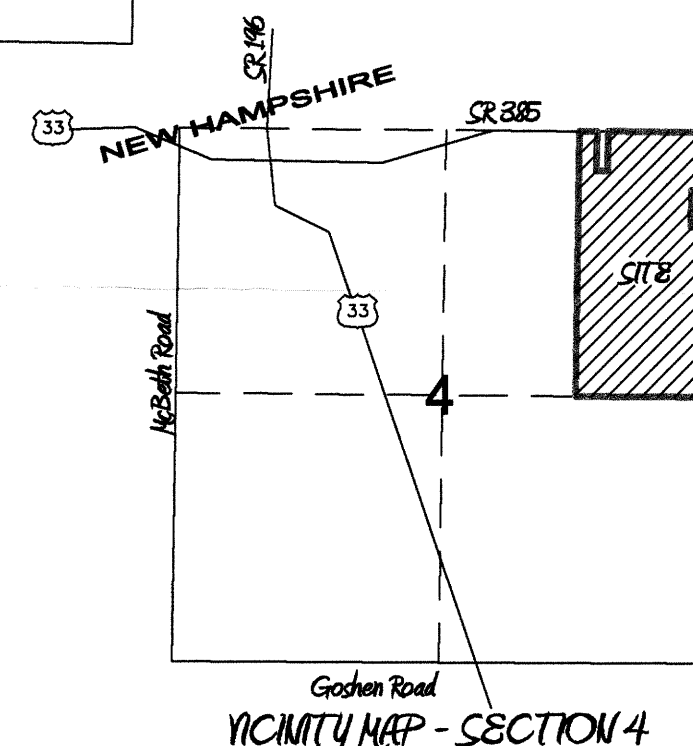

**LEGEND**

- "A" p-k nail (found)
  - "B" 1" iron pipe (found)
  - "C" 5/8" re-rod w/cap (found)
  - "D" 2" axel (found)
  - "E" 5/8" re-rod w/cap (found)
  - "F" cotton gin spindle (found)
  - "G" 1" iron pipe w/cap (found)
  - "H" 4" diameter steel fence post (found)
  - "I" mag-nail (set)
  - "J" 5/8" re-rod w/cap (set)
- Basis of bearings per Auglaize County GPS of the south line of the southeast quarter of Section 4 @ N 89°30'52"W.
- \*Reference to Steve Andrews survey by John Jauert, PS 6920 dated August, 1989 and filed in Book "H" page 467.
- \*Reference to Steve Andrews survey by Tom Steinka, PS 6177 dated April 1977 and filed in Book "C" page 32.
- I hereby certify that this plat is based upon an accurate field survey conducted under my direct supervision.

James M. Kent, PS 6792 OH

**kent surveying, inc.**  
acad - andrews dwg #3742-A  
December 6, 2013

4

GRAPHIC SCALE

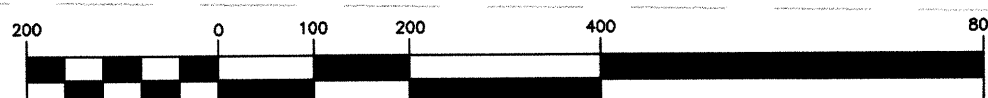

Jesse & Jessica Ritter  
O.R. Vol. 503, Page 781

Auglaize County GPS

Andrews Survey  
Tract One

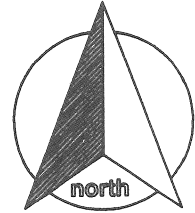

scale:

### SURVEYOR'S DESCRIPTION

Being a part of the east half of the northeast quarter of Section 4, Town-6-South, Range-8-East, Goshen Township, Auglaize County, Ohio as evidenced by Deed Volume 585, Page 195 (Parcel No. D 1200400100) and more particularly described as follows:

Commencing for reference at a p-k nail over a stone (found) at the intersection of the centerline of State Route 196 with the north line of Section 4; thence S 89 degrees 16' 49" E along the north line of Section 4 (passing through the calculated position of the north quarter corner of Section 4 at a distance of 1835.90 feet) for a total distance of 3161.20 feet to cotton gin spindle (found) in the centerline of State Route 385 at the northwest corner of the east half of the northeast quarter of Section 4, said spindle being the **POINT OF BEGINNING** for the tract herein described;

thence, continuing along the north line of Section 4 and the centerline of State Route 385, S 89 degrees 16' 49" E for a distance of 180.00 feet to a cotton gin spindle (set);

thence, S 01 degree 06' 12" W (passing through a 5/8" re-rod w/cap set on the south right-of-way line of State Route 385 at a distance of 30.00 feet) for a total distance of 384.00 feet to a 5/8" re-rod w/cap (set);

thence, S 89 degrees 16' 49" E for a distance of 113.00 feet to a 5/8" re-rod w/cap (set);

thence, N 01 degree 06' 12" E (passing through a 5/8" re-rod w/cap set on the south right-of-way line of State Route 385 at a distance of 354.00 feet) for a total distance of 384.00 feet to the centerline of State Route 385 and the north line of Section 4;

thence, along the aforesaid north line and centerline, S 89 degrees 16' 49" E for a distance of 502.30 feet to a mag-nail (set);

thence, S 01 degree 32' 10" W for a distance of 2647.12 feet to a 5/8" re-rod w/cap (set) on the south line of the northeast quarter of Section 4;

thence, N 89 degrees 18' 29" W along the aforesaid south line for a distance of 775.11 feet to a 5/8" re-rod w/cap (found);

thence, N 01 degree 05' 57" E (passing through a 5/8" re-rod w/cap found on the south right-of-way line of State Route 385 at a distance of 2617.12 feet) for a total distance of 2647.12 feet to the **POINT OF BEGINNING**, containing therein 46.716 acres, of which 0.470 acres is road right-of-way; Subject to all easements and right-of-way of record at the time of the recording of this instrument. Prepared by James M. Kent, PS 6792 OH with reference hereby made to a plat of survey; Kent Surveying drawing #3742-A dated December 8, 2013. Basis of bearings per Auglaize County GPS of the south line of the southeast quarter of Section 4 as N 89 degrees 30' 52" W.

  
James M. Kent, PS 6792

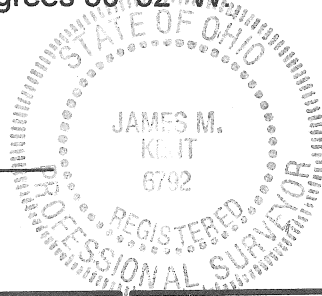

CLIENT ANDREWS DATE 12-8-2013  
COUNTY AUGLAIZE TOWNSHIP GOSHEN  
SECTION 4 T-6-S; R-8-E DRAWN BY JMK  
SHEET 1 OF 2 DWG. # 3742-A

 **kent surveying, inc.**  
P.O. Box 96 - 1750 Bellefontaine Street  
Wapakoneta, OH 45895  
419-738-5677 fax 419-738-7894

GOS-4-7a

Andrews Survey  
Tract Two

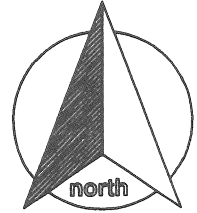

scale:

### SURVEYOR'S DESCRIPTION

Being a part of the east half of the northeast quarter of Section 4, Town-6-South, Range-8-East, Goshen Township, Auglaize County, Ohio as evidenced by Deed Volume 231, Page 530 (Parcel No. D 1200400100) and more particularly described as follows:

Commencing for reference at a p-k nail over a stone (found) at the intersection of the centerline of State Route 196 with the north line of Section 4; thence S 89 degrees 16' 49" E along the north line of Section 4 (passing through the calculated position of the north quarter corner of Section 4 at a distance of 1835.90 feet) for a total distance of 3956.50 feet to a mag-nail (set), said nail being the **POINT OF BEGINNING** for the tract herein described;

thence, continuing along the north line of Section 4 and the centerline of State Route 385, S 89 degrees 16' 49" E for a distance of 530.00 feet to a cotton gin spindle (found) at the northeast corner of Section 4;

thence, S 01 degree 06' 12" W along the east line of the northeast quarter of Section 4 (passing through a 5/8" re-rod w/cap (found) on the south right-of-way line of State Route 385 at a distance of 30.00 feet) for a total distance of 567.11 feet to a 5/8" re-rod w/cap (found);

thence, N 88 degrees 53' 48" W for a distance of 200.00 feet to a 1" iron pipe w/cap (found);

thence, S 01 degree 06' 12" W for a distance of 369.49 feet to a 5/8" re-rod w/cap (found);

thence, S 88 degrees 53' 48" E for a distance of 200.00 feet to a 4" diameter steel fence post (found) on the east line of the northeast quarter of Section 4;

thence, S 01 degree 06' 12" W along the east line of the northeast quarter of Section 4 for a distance of 1709.88 feet to a 2" diameter axle (found) at the southeast corner of the northeast quarter of Section 4;

thence, N 89 degrees 18' 29" W along the south line of the northeast quarter of Section 4, for a distance of 550.00 feet to a 5/8" re-rod w/cap (set);

thence, N 01 degree 32' 10" E passing through a 5/8" re-rod w/cap set on the south right-of-way line of State Route 385 at a distance of 2616.95) for a total distance of 2646.95 feet to the **POINT OF BEGINNING**, containing therein 31.112 acres, of which 0.365 acres is road right-of-way; Subject to all easements and right-of-way of record at the time of the recording of this instrument. Prepared by James M. Kent, PS 6792 OH with reference hereby made to a plat of survey; Kent Surveying drawing #3742-A dated December 8, 2013. Basis of bearings per Auglaize County GPS of the south line of the southeast quarter of Section 4 as N 89 degrees 30' 52" W.

*Corrected distance to point of beginning ~ 12-11-2013*

  
James M. Kent, PS 6792

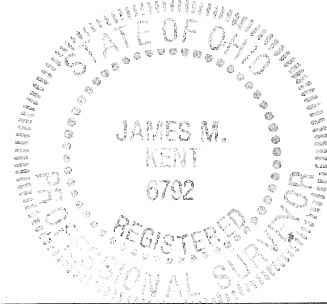

CLIENT ANDREWS DATE 12-11-2013  
COUNTY AUGLAIZE TOWNSHIP GOSHEN  
SECTION 4 T-6-S; R-8-E DRAWN BY JMK  
SHEET 2 OF 2 DWG. # 3742-A

 **kent surveying, inc.**  
P.O. Box 96 • 1750 Bellefontaine Street  
Wapakoneta, OH 45895  
419-738-5677 fax 419-738-7894

605-4-76