

ALBERS SURVEY  
N.E. 1/4 SEC. 29, T 75, R 4E  
JACKSON TWP., AUGLAIZE COUNTY, OH  
PARCEL #E1402900200

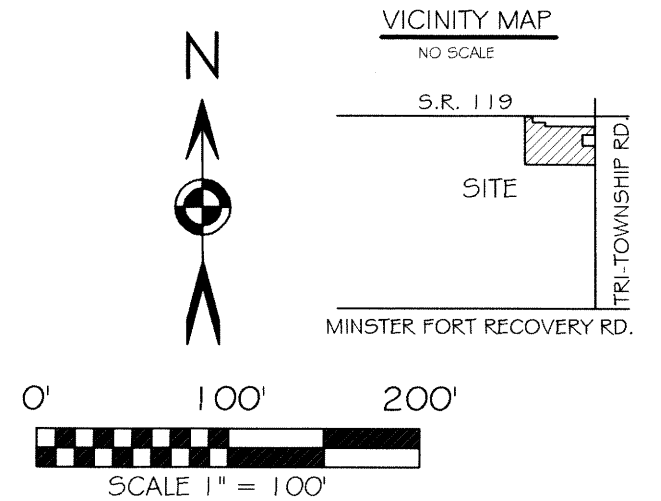
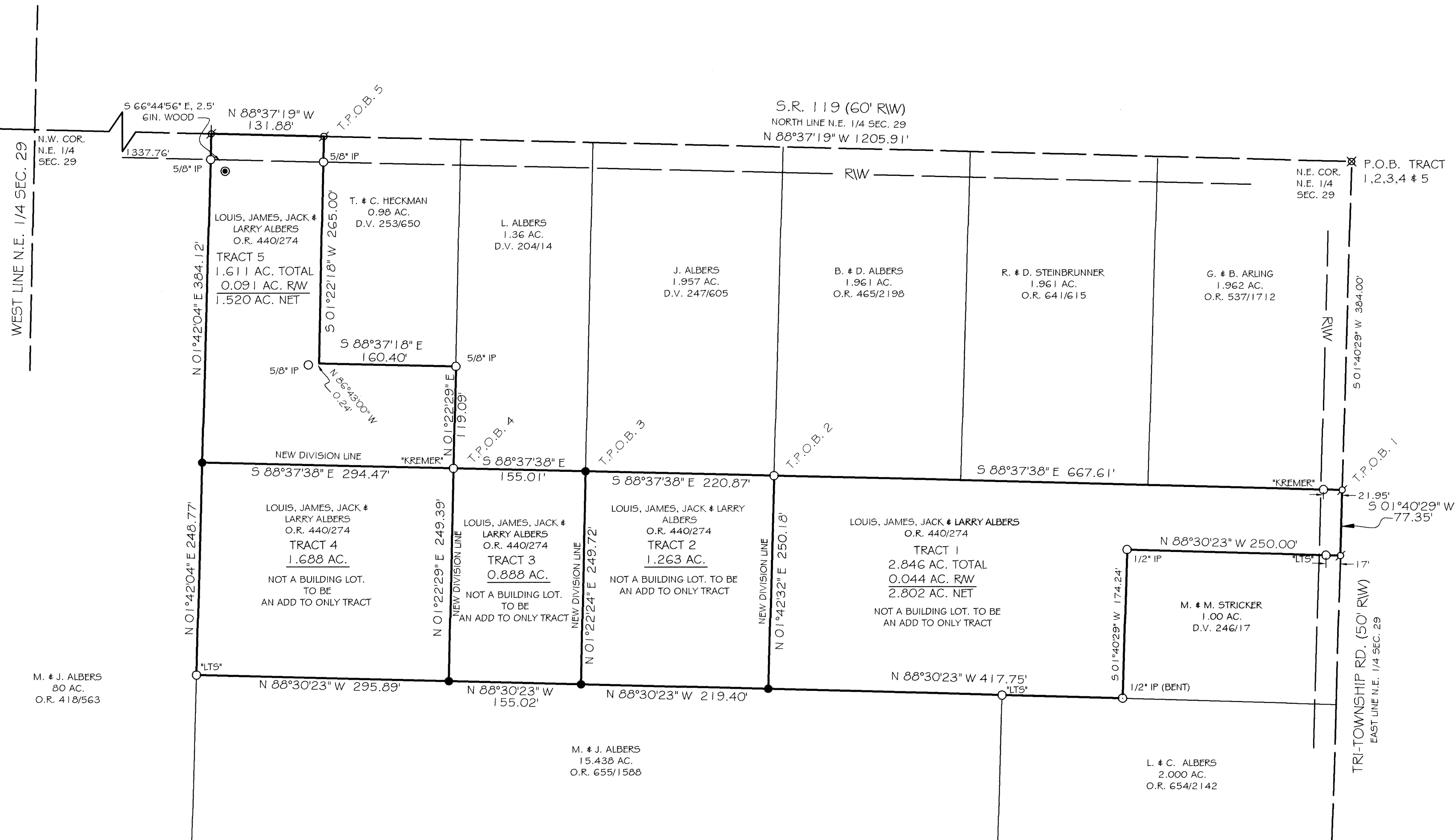

BASIS OF BEARING: BEARINGS ARE OHIO STATE PLANE  
NORTH ZONE, 3401, NAD 83 (2001 ADJ), GRID  
DISTANCES SHOWN ARE GROUND.

LEGEND

- IRON PIN (SET) W/ PINK PLASTIC CAP  
STAMPED "LOCK TWO 7988"
- IRON PIN (FOUND)
- ⊗ MAG NAIL (FOUND)
- ⊠ MONUMENT BOX (FOUND)
- WOOD POST (FOUND)

F.E.M.A.

FLOOD INSURANCE NOTE: BY GRAPHICS PLOTTING  
ONLY, THIS PROPERTY IS IN ZONE "X" OF THE FLOOD  
INSURANCE RATE MAP, COMMUNITY PANEL NO.  
3901100175C EFFECTIVE DATE OF SEPTEMBER 6,  
1989 EXACT DESIGNATIONS CAN ONLY BE  
DETERMINED BY AN ELEVATION CERTIFICATE. BASED ON  
THE ABOVE INFORMATION, THIS PROPERTY "IS NOT"  
IN A SPECIAL FLOOD HAZARD AREA.

M. & J. ALBERS  
80 AC.  
O.R. 418/563

M. & J. ALBERS  
15.438 AC.  
O.R. 655/1588

L. & C. ALBERS  
2.000 AC.  
O.R. 654/2142

Christopher S. Harmon  
CHRISTOPHER S. HARMON P.S. #7988

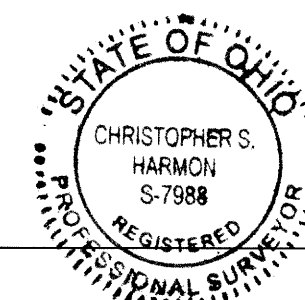

9/1/15  
DATE

SURVEY NOTE:  
I HEREBY STATE THAT THIS IS A TRUE AND ACCURATE SURVEY AS PERFORMED BY MYSELF. ALL ADJOINING  
OWNERS, MONUMENTS AND THERE CONDITION ARE CURRENT AS OF THE TIME THE FIELD WORK WAS  
PERFORMED IN AUGUST, 2015 AND DONE WITHOUT THE BENEFIT OF A TITLE SEARCH.

FILED AS SURVEY JAC-29-3 IN THE  
AUGLAIZE COUNTY TAX MAP OFFICE.

LOCK-TWO SURVEYING  
5166 LOCK TWO RD. NEW BREMEN, OH  
419-753-3332



Lock Two Surveying, LLP.

5166 Lock Two Rd.  
New Bremen, Oh 45869  
419-753-3332

Cell: Jenny Saintignon 419-733-9606  
Chris Harmon P.S. 419-733-9607



**ALBERS SURVEY  
PARCEL #E1402900200  
TRACT 1  
2.846 ACRES**

SITUATE IN THE NORTHEAST QUARTER OF SECTION 29 TOWN 7S RANGE 4E, JACKSON TOWNSHIP, AUGLAIZE COUNTY OHIO, AND BEING PART OF THOSE LANDS OWNED BY LOUIS ALBERS, JAMES ALBERS, JACK ALBERS AND LARRY ALBERS AS RECORDED IN OFFICIAL RECORD 440, PAGE 274 AND BEING MORE PARTICULARLY DESCRIBED AS FOLLOWS:

Beginning for reference at a railroad spike (found) at the northeast corner of the northeast quarter of Section 29 and being at the intersection of the centerlines of State Route 119 and Tri – Township Roads;

Thence, with the east line of the northeast quarter of Section 29 and the centerline of Tri – Township Road, South 01°40'29" West, 384.00 feet to a Mag Nail (found) at the **True Point of Beginning** of the tract herein described;

Thence, continuing with the east line of the northeast quarter of Section 29 and the centerline of Tri – Township Road, South 01°40'29" West, 77.35 feet to a Mag Nail (found);

Thence, with the north line of a 1.00 acre tract of land owned by M. & M. Stricker as recorded in Deed Volume 246 Page 17, North 88°30'23" West, 250.00 feet to a half inch iron pin (found), passing for reference at 17.00 feet an iron pin with "Lock Two" cap (found) and at 25.00 feet the west right of way line of Tri – Township Road;

Thence, with the west line of said 1.00 acre tract, South 01°40'29" West, 174.24 feet to a 1/2 inch iron pin (found) bent;

Thence, with the north line of a 2.000 acre tract owned by L. & C. Albers as recorded in Official Record 654, Page 2142 and the north line of a 15.438 acre tract of land owned by M. & J. Albers as recorded in Official Record 655, Page 1588, North 88°30'23" West, 417.75 feet to an iron pin (set);

Thence, with a new division line North 01°42'32" East, 250.18 feet to an iron pin (found);

Thence, with the south lines of a 1.961 acre tract of land owned by B. & D. Albers as recorded in Official Record 465 Page 2198, a 1.961 acre tract of land owned by R. & D. Steinbrunner as recorded in Official Record 641 Page 615 and a 1.962 acre tract of land owned by G. & B. Arling as recorded in Official Record 537 Page 1712, South 88°37'38" East, 667.61 feet to the **True Point of Beginning**, passing for reference at 642.61 feet the west right of way line of Tri – Township Road and at 645.66 feet an iron pin with "Kremer" cap (found) containing 2.846 acres more or less having 0.044 acre lie within the right of way line of Tri – Township Road and being subject to all legal rights of ways easements, agreements and restrictions of record;

Bearings listed above are based on Ohio State Plane North Zone 3401, NAD 83 (2011Adj), distances shown are ground. The deed records referenced are all recorded in the Auglaize County Recorder's Office. Pins noted as set are 5/8" x 30" rebar with pink plastic caps stamped "Lock-Two 7988".

The above description was prepared by Lock-Two Survey, LLP from a survey performed by Christopher S. Harmon, Professional Surveyor #7988 in August, 2015 and recorded in Survey JAC-29-3 in the Auglaize County Recorder's Office.

*Christopher S. Harmon*  
\_\_\_\_\_  
Christopher S. Harmon P.S. #7988



*9/1/15*

Date

Lock Two Surveying, LLP.

5166 Lock Two Rd.  
New Bremen, Oh 45869  
419-753-3332

Cell: Jenny Saintignon 419-733-9606  
Chris Harmon P.S. 419-733-9607

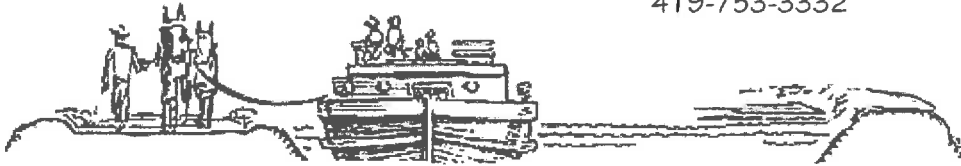

**ALBERS SURVEY  
PARCEL #E1402900200  
TRACT 2  
1.263 ACRES**

SITUATE IN THE NORTHEAST QUARTER OF SECTION 29 TOWN 7S RANGE 4E, JACKSON TOWNSHIP, AUGLAIZE COUNTY OHIO, AND BEING PART OF THOSE LANDS OWNED BY LOUIS ALBERS, JAMES ALBERS, JACK ALBERS AND LARRY ALBERS AS RECORDED IN OFFICIAL RECORD 440, PAGE 274 AND BEING MORE PARTICULARLY DESCRIBED AS FOLLOWS:

Beginning for reference at a railroad spike (found) at the northeast corner of the northeast quarter of Section 29 and being at the intersection of the centerlines of State Route 119 and Tri – Township Roads;

Thence, with the east line of the northeast quarter of Section 29 and the centerline of Tri – Township Road, South  $01^{\circ}40'29''$  West, 384.00 feet to a Mag Nail (found);

Thence, with the south line of a 1.962 acre tract of land owned by G. & B. Arling as recorded in Official Record 537, Page 1712, a 1.961 acre tract of land owned by R. & D. Steinbrunner as recorded in Official Record 641, Page 615 and a 1.961 acre tract of land owned B. & D. Albers as recorded in Official Record 465, Page 2198, North  $88^{\circ}37'38''$  West, 667.61 feet to an iron pin (found) at the **True Point of Beginning** of the tract herein described;

Thence, with a new division line, South  $01^{\circ}42'32''$  West, 250.18 feet to an iron pin (set);

Thence, with the north line of a 15.438 acre tract of land owned by M. & J. Albers as recorded in Official Record 655, Page 1588, North  $88^{\circ}30'23''$  West, 219.40 feet to an iron pin (set);

Thence, with a new division line, North  $01^{\circ}22'24''$  East, 249.72 feet to an iron pin (set);

Thence, with the south line of a 1.957 acre tract of land owned by J. Albers as recorded in Deed Volume 247, Page 605, South  $88^{\circ}37'38''$  East, 220.87 feet to the **True Point of Beginning**, containing 1.263 acres more or less and being subject to all legal rights of ways easements, agreements and restrictions of record;

Bearings listed above are based on Ohio State Plane North Zone 3401, NAD 83 (2011Adj), distances shown are ground. The deed records referenced are all recorded in the Auglaize County Recorder's Office. Pins noted as set are 5/8" x 30" rebar with pink plastic caps stamped "Lock-Two 7988".

The above description was prepared by Lock-Two Survey, LLP from a survey performed by Christopher S. Harmon, Professional Surveyor #7988 in August, 2015 and recorded in Survey JAC-29-3 in the Auglaize County Recorder's Office.

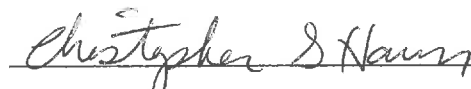
  
Christopher S. Harmon P.S. #7988

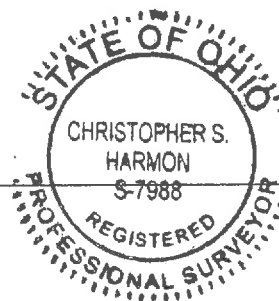

9/11/15  
Date

Lock Two Surveying, LLP.

5166 Lock Two Rd.  
New Bremen, Oh 45869

419-753-3332

Cell: Jenny Saintignon 419-733-9606  
Chris Harmon P.S. 419-733-9607

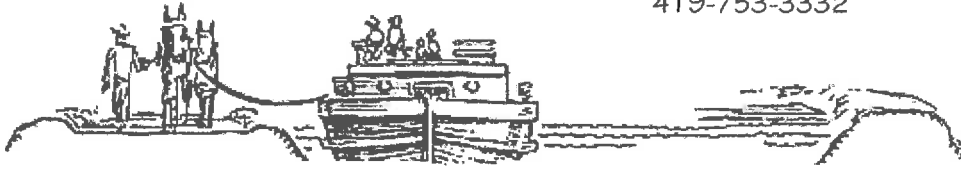

**ALBERS SURVEY  
PARCEL #E1402900200  
TRACT 3  
0.888 ACRES**

SITUATE IN THE NORTHEAST QUARTER OF SECTION 29 TOWN 7S RANGE 4E, JACKSON TOWNSHIP, AUGLAIZE COUNTY OHIO, AND BEING PART OF THOSE LANDS OWNED BY LOUIS ALBERS, JAMES ALBERS, JACK ALBERS AND LARRY ALBERS AS RECORDED IN OFFICIAL RECORD 440, PAGE 274 AND BEING MORE PARTICULARLY DESCRIBED AS FOLLOWS:

Beginning for reference at a railroad spike (found) at the northeast corner of the northeast quarter of Section 29 and being at the intersection of the centerlines of State Route 119 and Tri – Township Roads;

Thence, with the east line of the northeast quarter of Section 29 and the centerline of Tri – Township Road, South  $01^{\circ}40'29''$  West, 384.00 feet to a Mag Nail (found);

Thence, with the south line of a 1.962 acre tract of land owned by G. & B. Arling as recorded in Official Record 537, Page 1712, a 1.961 acre tract of land owned by R. & D. Steinbrunner as recorded in Official Record 641, Page 615 and a 1.961 acre tract of land owned B. & D. Albers as recorded in Official Record 465, Page 2198 and a 1.957 acre tract of land owned by J. Albers as recorded in Deed Volume 247, Page 605, North  $88^{\circ}37'38''$  West, 888.48 feet to an iron pin (set) at the **True Point of Beginning** of the tract herein described;

Thence, with a new division line, South  $01^{\circ}22'24''$  West, 249.72 feet to an iron pin (set);

Thence, with the north line of a 15.438 acre tract of land owned by M. & J. Albers as recorded in Official Record 655, Page 1588, North  $88^{\circ}30'23''$  West, 155.02 feet to an iron pin (set);

Thence, with a new division line, North  $01^{\circ}22'29''$  East, 249.39 feet to an iron pin with "Kremer" cap (found);

Thence, with the south line of a 1.36 acre tract of land owned by L. Albers as recorded in Deed Volume 204, Page 14, South  $88^{\circ}37'38''$  East, 155.01 feet to the **True Point of Beginning**, containing 0.888 acres more or less and being subject to all legal rights of ways easements, agreements and restrictions of record;

Bearings listed above are based on Ohio State Plane North Zone 3401, NAD 83 (2011Adj), distances shown are ground. The deed records referenced are all recorded in the Auglaize County Recorder's Office. Pins noted as set are 5/8" x 30" rebar with pink plastic caps stamped "Lock-Two 7988".

The above description was prepared by Lock-Two Survey, LLP from a survey performed by Christopher S. Harmon, Professional Surveyor #7988 in August, 2015 and recorded in Survey JAC-29-3 in the Auglaize County Recorder's Office.

*Christopher S Harmon*

Christopher S. Harmon P.S. #7988



*9/11/15*

Date

Lock Two Surveying, LLP.

5166 Lock Two Rd.  
New Bremen, Oh 45869  
419-753-3332

Cell: Jenny Santignon 419-733-9606  
Chris Harmon P.S. 419-733-9607

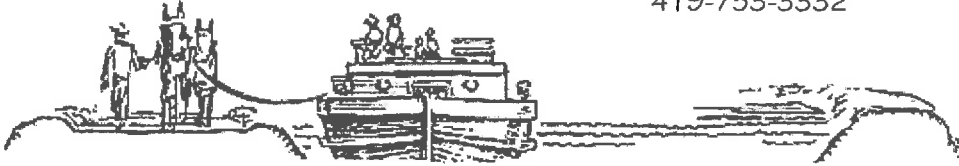

**ALBERS SURVEY  
PARCEL #E1402900200  
TRACT 4  
1.688 ACRES**

SITUATE IN THE NORTHEAST QUARTER OF SECTION 29 TOWN 7S RANGE 4E, JACKSON TOWNSHIP, AUGLAIZE COUNTY OHIO, AND BEING PART OF THOSE LANDS OWNED BY LOUIS ALBERS, JAMES ALBERS, JACK ALBERS AND LARRY ALBERS AS RECORDED IN OFFICIAL RECORD 440, PAGE 274 AND BEING MORE PARTICULARLY DESCRIBED AS FOLLOWS:

Beginning for reference at a railroad spike (found) at the northeast corner of the northeast quarter of Section 29 and being at the intersection of the centerlines of State Route 119 and Tri – Township Roads;

Thence, with the east line of the northeast quarter of Section 29 and the centerline of Tri – Township Road, South 01°40'29" West, 384.00 feet to a Mag Nail (found);

Thence, with the south line of a 1.962 acre tract of land owned by G. & B. Arling as recorded in Official Record 537, Page 1712, a 1.961 acre tract of land owned by R. & D. Steinbrunner as recorded in Official Record 641, Page 615 and a 1.961 acre tract of land owned B. & D. Albers as recorded in Official Record 465, Page 2198, a 1.957 acre tract of land owned by J. Albers as recorded in Deed Volume 247, Page 605 and a 1.36 acre tract of land owned by L. Albers as recorded in Deed Volume 204, Page 14, North 88°37'38" West, 1043.49 feet to an iron pin (found) with "Kremer" cap found at the **True Point of Beginning** of the tract herein described;

Thence, with a new division line, South 01°22'29" West, 249.39 feet to an iron pin (set);

Thence, with the north line of a 15.438 acre tract of land owned by M. & J. Albers as recorded in Official Record 655, Page 1588, North 88°30'23" West, 295.89 feet to an iron pin with "Lock Two" cap (found);

Thence, with the east line of a 80 acre tract owned by M. & J. Albers as recorded in Official Record 418, Page 563, North 01°42'04" East, 248.77 feet to an iron pin (set);

Thence, with a new division line, South 88°37'38" East, 294.47 feet to the **True Point of Beginning**, containing 1.688 acres more or less and being subject to all legal rights of ways easements, agreements and restrictions of record;

Bearings listed above are based on Ohio State Plane North Zone 3401, NAD 83 (2011Adj), distances shown are ground. The deed records referenced are all recorded in the Auglaize County Recorder's Office. Pins noted as set are 5/8" x 30" rebar with pink plastic caps stamped "Lock-Two 7988".

The above description was prepared by Lock-Two Survey, LLP from a survey performed by Christopher S. Harmon, Professional Surveyor #7988 in August, 2015 and recorded in Survey JAC-29-3 in the Auglaize County Recorder's Office.

  
Christopher S. Harmon P.S. #7988

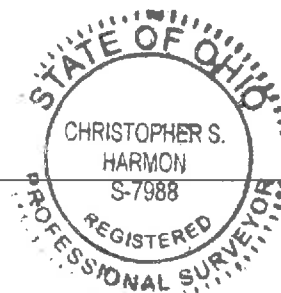

9/1/15

Date

Lock Two Surveying, LLP.

5166 Lock Two Rd.  
New Bremen, Oh 45869  
419-753-3332

Cell: Jenny Saintignon 419-733-9606  
Chris Harmon P.S. 419-733-9607

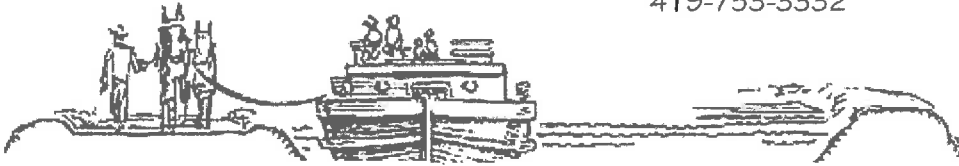

**ALBERS SURVEY**  
**PARCEL #E1402900200**  
**TRACT 5**  
**1.611 ACRES**

SITUATE IN THE NORTHEAST QUARTER OF SECTION 29 TOWN 7S RANGE 4E, JACKSON TOWNSHIP, AUGLAIZE COUNTY OHIO, AND BEING PART OF THOSE LANDS OWNED BY LOUIS ALBERS, JAMES ALBERS, JACK ALBERS AND LARRY ALBERS AS RECORDED IN OFFICIAL RECORD 440, PAGE 274 AND BEING MORE PARTICULARLY DESCRIBED AS FOLLOWS:

Beginning for reference at a railroad spike (found) at the northeast corner of the northeast quarter of Section 29 and being at the intersection of the centerlines of State Route 119 and Tri – Township Roads;

Thence, with the north line of the northeast quarter of Section 29 and the centerline of Tri – Township Road, North 88°37'19" West, 1205.91 feet to a Mag Nail (found) at the **True Point of Beginning** of the tract herein described;

Thence, with the west line of a 0.98 acre tract of land owned by T. & C. Heckman as recorded in Deed Volume 253, Page 650, South 01°22'18" West, 265.00 feet, witnessing at North 86°43'00" West. 0.24 feet to an iron pin (found), passing for reference at 30.00 feet an iron pin (found) in the south right of way line of State Route 119;

Thence, with the south line of said 0.98 acre tract, South 88°37'18" East, 160.40 feet to an iron pin (found);

Thence, with the west line of a 1.36 acre tract of land owned by L. Albers as recorded in Deed Volume 204, Page 14, South 01°22'29" West, 119.09 feet to an iron pin with "Kremer" cap (found);

Thence, with a new division line North 88°37'38" West, 294.47 feet to an iron pin set;

Thence, with the east line of a 80.00 acre tract of land owned by M. & J. Albers as recorded in Official Record 418, Page 563, North 01°42'04" East, 384.12 feet to the **True Point of Beginning**, passing for reference at 354.12 feet to an iron pin (found) at the south right of way line of State Route 119 and containing 1.611 acres more or less having 0.091 acre lie within the right of way of State Route 119 being subject to all legal rights of ways easements, agreements and restrictions of record;

Bearings listed above are based on Ohio State Plane North Zone 3401, NAD 83 (2011Adj), distances shown are ground. The deed records referenced are all recorded in the Auglaize County Recorder's Office. Pins noted as set are 5/8" x 30" rebar with pink plastic caps stamped "Lock-Two 7988".

The above description was prepared by Lock-Two Survey, LLP from a survey performed by Christopher S. Harmon, Professional Surveyor #7988 in August, 2015 and recorded in Survey JAC-29-3 in the Auglaize County Recorder's Office.

  
Christopher S. Harmon P.S. #7988



9/11/15  
Date