

# Doug Larger Survey

Part of the northeast quarter of Section 36,  
Town-7-South, Range-4-East,  
Jackson Township, Auglaize County, Ohio

NE Corner,  
NE 1/4, Section 36

State Route 119

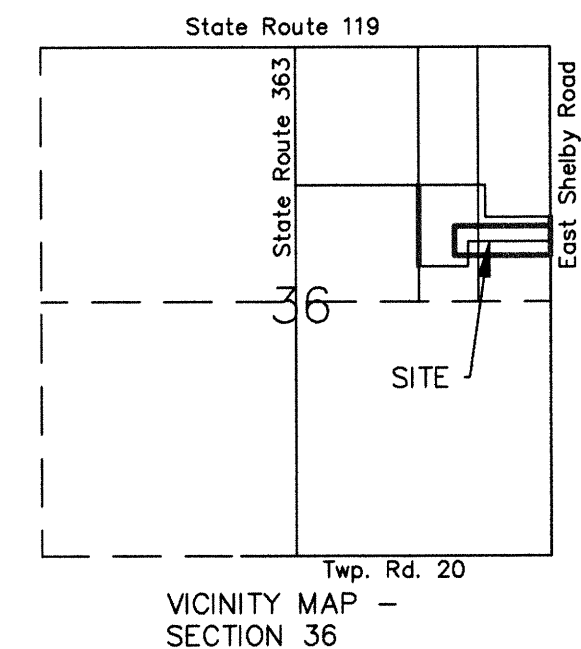

## Legend

- "A" ○ 1/2" re-rod w/cap (found) {Fultz}
- "B" ○ 5/8" re-rod (found) {Magoto}
- "C" ∅ p-k nail (found)
- "D" □ monument box (found)
- "E" ☆ cotton gin spindle (found)
- "F" ○ 5/8" re-rod w/cap (found) {Kent}
- "G" ⊙ 5/8" re-rod w/cap (set)
- "H" ⊙ mag-nail (set)

## Survey references

- ◆ "Schemmel Survey" by Norber J. Magoto, PS 5671 dated 9-18-82 and filed in Book F, Page 298.
- ◆ "Fischer Survey" by William G. Fultz, PS 5173 dated 1996.

I hereby certify that this plat represents a field survey,  
performed under my direct supervision.

JAMES M. KENT, PS 6792

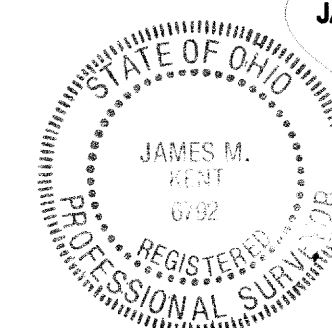

# Doug Larger Survey

Part of the northeast quarter of Section 36,  
Town-7-South, Range-4-East,  
Jackson Township, Auglaize County, Ohio

Douglas P.  
LARGER  
OR Volume 503, Page 1197

Douglas & Karla  
LARGER  
OR Volume 579, Page 1204

Edward J. & Cathy S.  
RICHARD  
OR Volume 277, Page 642

Steve & Debra  
ALBERS  
OR Volume 363, Page 304

Steve & Debra  
ALBERS  
OR Volume 443, Page 2585

0.41' west  
of line

West line, of the East half of the northeast quarter

West line of the East half, of the East half of the northeast quarter

EAST SHELBY ROAD (40' RW)

5.002  
(0.114 acres right-of-way)

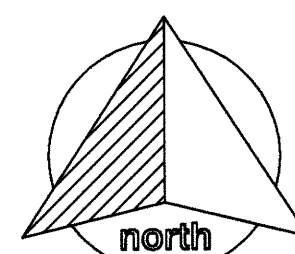

Basis of bearings is per Auglaize County GPS depicting the  
east line of the NE 1/4 of Section 36 as S 00°59' 44" W.

VAC-36-3

**kent surveying, inc.**

acad - larger/jackson  
drawing #4166-1  
July 14, 2009

Doug Larger Survey

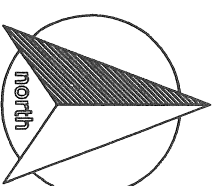

**SURVEYOR'S DESCRIPTION**

scale:

Being a part of the northeast quarter of Section 36, Town-7-South, Range-4-East, Jackson Township, Auglaize County, Ohio as evidenced by OR Volume 503, Page 1197 and OR Volume 579, Page 1204 and more particularly described as follows:

Commencing for reference at a monument box (found) at the southeast corner of the northeast quarter of Section 36, and the centerline of East Shelby Road; thence, N 00° 59' 44" E along the east line of the northeast quarter and the legal centerline of East Shelby Road for a distance of 477.64 feet to a mag nail (set), said nail being the **POINT OF BEGINNING** for the tract herein described;

thence, N 89° 28' 25" W (passing through a 5/8" re-rod w/cap set on the west right-of-way line of East Shelby Road at a distance of 20.00 feet) for a total distance of 870.97 feet to a 5/8" re-rod w/cap (set);

thence, N 01° 01' 17" E for a distance of 250.10 feet to a 5/8" re-rod w/cap (set);

thence, S 89° 28' 25" E (passing through a 5/8" re-rod w/cap set on the west right-of-way line of East Shelby Road at a distance of 850.86 feet) for a total distance of 870.86 feet to a mag nail (set) on the east line of the northeast quarter and the legal centerline of East Shelby Road;

thence, S 00° 59' 44" W along the aforesaid east line and legal centerline for a distance of 250.10 feet to the **POINT OF BEGINNING**, containing therein **5.002 acres** of which 4.128 acres is currently in the confines of that property described in OR Volume 503, Page 1197 and 0.874 acres is currently in the confines of that property described in OR Volume 579, Page 1204 and 0.114 acres is road right-of-way. Subject to all easements and right-of-way of record at the time of the recording of this instrument. Prepared by James M. Kent, Professional Surveyor No. 6792 with reference herein made to a plat of survey; Kent Surveying, Inc. drawing #4166-1 dated July 14, 2009. Basis of bearings is per Auglaize County GPS depicting the east line of the northeast quarter of Section 36 as S 00° 59' 44" W.

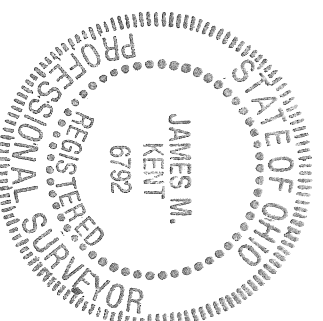

  
James M. Kent, PS 6792

CLIENT Doug Larger DATE 7-15-09  
COUNTY Auglaize TOWNSHIP Jackson  
SECTION 36 T-7-S; R-4-E DRAWN BY JMK  
SHEET 1 OF 1 DWG. # 4166-1

 **Kent Surveying, Inc.**

P.O. Box 96 - 1750 Bellefontaine Street  
Wapakoneta, OH 45895  
419-738-5677 fax 419-738-7894

*JMK-36-3a*