

Allen Boundary Survey

Part of the north fractional part of the north half of Section 36, Town-4-South, Range-5-East, Logan Township, Auglaize County, Ohio.

Theodore & Mary Allen
OR Volume 212, Page 606
Parcel No. F1903600200
39.448 ACRES
(0.595 acres right-of-way)

LEGEND

- ☐ Monument Box (found)
- 5/8" Re-rod w/cap (found)
- ⦿ Mag-Nail (found)
- Wooden End Post (found)
- ✓ Angle Iron Post (found)

"A" 5/8" re-rod w/cap set for reference S 73° 29' 54" W of and 25.00 feet from centerline of ditch

Basis of bearings is per Auglaize County GPS depicting the line between the northwest corner of the south half of the northwest fractional quarter of Section 36 and the northwest corner of fractional Section 25 as N 00° 43' 17" E.

This survey is an accurate representation of a field survey, conducted under my direct supervision.

JAMES M. KENT, PS 6792 OH

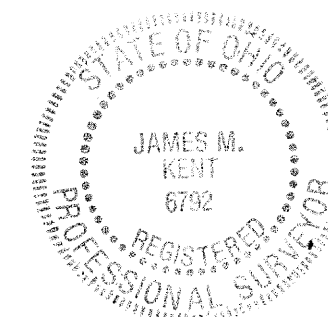

kent surveying, inc.

acad-allen, theodore 12 Dwg
#5466
November 6, 2013

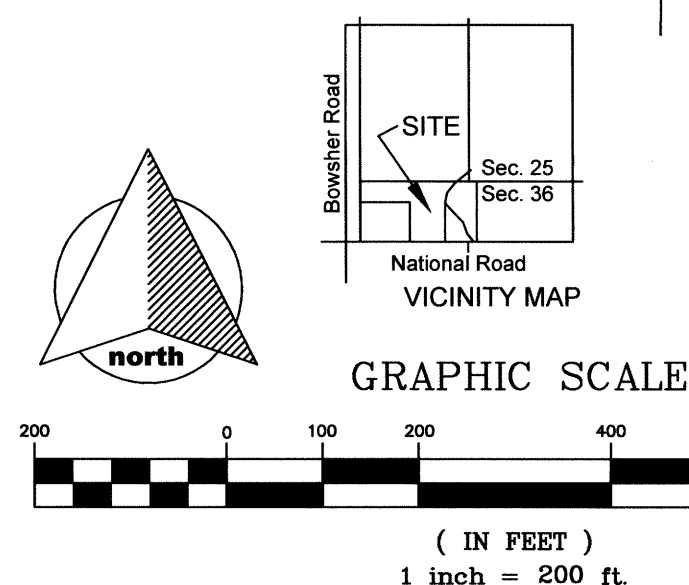

LOG-36-3

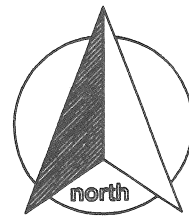

SURVEYOR'S DESCRIPTION

scale:

Being a part of the north fractional part of the north half of Section 36, Town-4-South, Range-5-East, Logan Township, Auglaize County, Ohio as evidenced by Official Record Volume 212, Page 606 (Parcel Number F1903600200) and more particularly described as follows:

Commencing for reference at a monument box (found) at the northeast corner of the south half of the northwest fractional quarter of Section 36 and the centerline intersection of National Road; thence, N 88° 54' 38" W along the north line of the aforesaid south half and the legal centerline of National Road, for a distance of 506.73 feet to a mag-nail (found), said nail being the **POINT OF BEGINNING** for the tract herein described;

Thence, continuing along the aforesaid north line and centerline of National Road, N 88° 54' 38" W for a distance of 864.59 feet to a mag-nail (found);

Thence, N 01° 03' 46" E (passing through a 5/8" re-rod w/cap set on the north right-of-way line of National Road at a distance of 30.00 feet) for a total distance of 755.75 feet to a 5/8" re-rod w/cap (found);

Thence, N 89° 19' 59" W for a distance of 1033.31 feet to a 5/8" re-rod w/cap (found) on the east line of Logan Heir's Section;

Thence, N 00° 42' 46" E along the aforesaid east line for a distance of 542.90 feet to a point;

Thence, S 89° 34' 52" E (passing through an angle iron post found at a distance of 13.27 feet, and a wooden post found at a distance of 2044.56 feet) for a total distance of 2069.36 feet to the centerline of a ditch;

Thence, along the aforesaid centerline S 28° 47' 22" W for a distance of 148.24' to a point; S 31° 24' 49" W for a distance of 123.09 feet to a point; S 24° 32' 57" W for a distance of 59.78 feet to a point, said point referenced by a 5/8" re-rod w/cap found bearing S 73° 29' 54" W of, and 25.00 feet from said point;

Thence, leaving said centerline S 11° 15' 24" W for a distance of 113.67 feet to a 5/8" re-rod w/cap (found);

Thence S 00° 37' 07" W (passing through a 5/8" re-rod w/cap found on the north right-of-way line of National Road at a distance of 881.08 feet) for a total distance of 911.08 feet to a mag-nail (found) at the **POINT OF BEGINNING**, containing therein **39.448 acres**, of which 0.595 acres is road right-of-way. Subject to all easements and right-of-way of record at the time of the recording of this instrument. Prepared by James M. Kent, PS 6792 with reference herein made to a plat of survey; Kent Surveying, Inc., drawing #5466 and dated November 6, 2013.

Basis of bearings is per Auglaize County GPS depicting the line between the northwest corner of the south half of the northwest fractional quarter of Section 36 and the northwest corner of fractional Section 25 as N 00° 43' 17" E.

James M. Kent, PS 6792

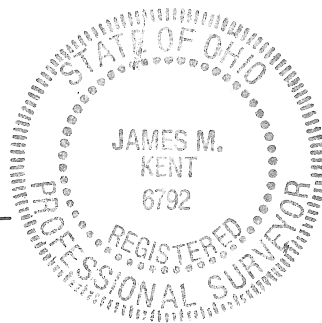

CLIENT ALLEN DATE 11-7-2013
COUNTY AUGLAIZE TOWNSHIP LOGAN
SECTION 36 T-4-S; R-5-E DRAWN BY JMK
SHEET 1 OF 1 DWG. # 5466

kent surveying, inc.
P.O. Box 96 - 1750 Bellefontaine Street
Wapakoneta, OH 45895
419-738-5677 fax 419-738-7894

LOC-36-3a