

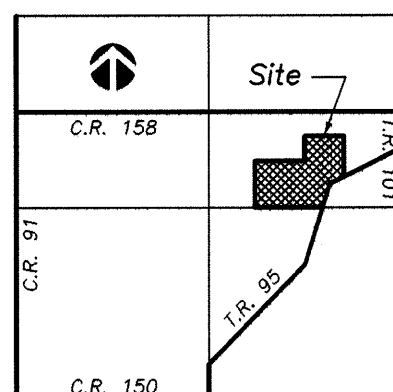

Roediger Survey 22.658 Acre Parcel

Situated in the South Half of the Northeast Quarter of Section 28,
Moulton Township, Town-5-South, Range-5-East,
Auglaize County, Ohio

Location Plan



Section 28
Moulton Township
Auglaize County, Ohio

Curve Data

Curve #1		Curve #2		Curve #3	
Delta (Δ) =	29°-49'-27"	Delta (Δ) =	32°-40'-42"	Delta (Δ) =	09°-32'-23"
Radius (R) =	450.61'	Radius (R) =	255.83'	Radius (R) =	719.06'
Tangent (T) =	120.00'	Tangent (T) =	75.00'	Tangent (T) =	60.00'

DEED VOLUME OR 349
PAGE 23

Previous Deed

DEED VOLUME OR221
PAGE 394

22.658
Acre
Parcel
(0.255 Ac R/W)

NOTE

Bearings were based upon several previous
surveys performed by me from January of 1993,
to January of 2000 for the Roedigers. Survey Plats
for all prior surveys are currently on file with the
Auglaize County Engineer's Tax Map Office.

Prepared by:

Ted K. Schnell

Ted K. Schnell
Professional Engineer
Professional Surveyor

1-14-02

date

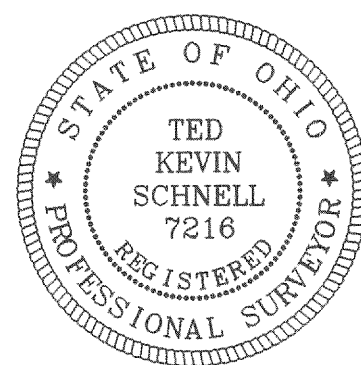
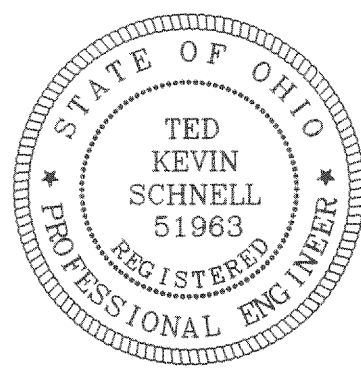

Legend

- Iron Pin (found)
- ▲ P.K. Nail/Shiner (found)
- Railroad Spike (found)
- Stone (found)
- ◆ Wood End Post (found)
- Monument Box (found)

Scale

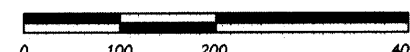

TITLE

SURVEY FOR DON ROEDIGER

H & S Civil Engineers and Land Surveyors

913 Fieldstone Court Wapakoneta, Ohio 45895
Voice: (419) 738-4758 Fax: (419) 739-7631
E-Mail: hscivil@bright.net

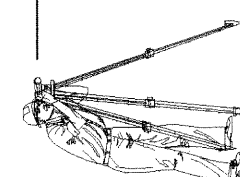

No.	Revision/Issue	Date

Project Name

DON ROEDIGER SURVEY
PARCEL SPLIT
KRUSE ROAD
22.658 ACRES

Project Location

SECTION 28
MOULTON TWP
AUGLAIZE COUNTY,
STATE OF OHIO

Project

Roediger
Date
01/14/02
Scale
SHOWN

Sheet

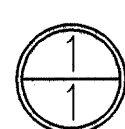

MOU-28-7

H & S Civil Engineers and Land Surveyors
913 Fieldstone Court
Wapakoneta, Ohio 45895
Phone (419) 738-4758
Fax (419) 739-7631
E-Mail hscivil@bright.net

Ted K. Schnell P.E., P.S.
Gregory B. Huber P.E.

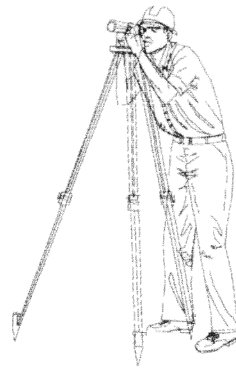

01/16/02

SURVEYOR'S DESCRIPTION 22.658 ACRE PARCEL

The following described parcel of land is situated in the South Half of the Northeast Quarter of Section 28, Moulton Township, Town-5-South, Range-5-East, Auglaize County, Ohio, and is more particularly described as follows:

COMMENCING for reference at a Wooden End Post (found) at the Northwest Corner of the Northeast Quarter of said Section 28, Moulton Township;

THENCE with a bearing of S. 02°-00'-41" E. along the West Line of the Northeast Quarter of said Section 28, Moulton Township for a distance of 2,637.16 feet to a Wooden End Post (found) at the Southwest Corner of the Northeast of said Section 28, Moulton Township;

THENCE with a bearing of N. 87°-40'-01" E. for a distance of 662.41 feet to an Iron Pin (found) and the PLACE OF BEGINNING;

THENCE with a bearing of N. 02°-02'-01" W. along the West Line of the East Half of the Southwest Quarter of the Northeast Quarter of said Section 28, Moulton Township for a distance of 659.34 feet to an Iron Pin (found);

THENCE with a bearing of N. 87°-39'-45" E. along the North Line of the South Half of the Southwest Quarter of the Northeast Quarter of said Section 28, Moulton Township, for a distance of 662.16 feet to an Iron Pin (found);

THENCE with a bearing of N. 02°-03'-20" W. along the East Line of the Southwest Quarter of the Northeast Quarter of said Section 28, Moulton Township, for a distance of 331.75 feet to an Iron Pin (found);

THENCE with a bearing of N. 87°-24'-00" E. and parallel with the centerline of County Road # 158, Glynwood Road, for a distance of 636.53 feet to Wooden End Post (found);

THENCE with a bearing of S. 02°-04'-00" E. for a distance of 567.16 feet to a point on the centerline of a curve on Township Road # 95, Kruse Road, and passing thru a Railroad Spike (found) on the Forward Tangent of said curve at a distance of 565.03 feet;

THENCE along the centerline of Township Road # 95, Kruse Road, with a curve to the left for an arc length of 49.01 feet to a P.K. Nail/Shiner (found) at the P.T. of the curve having the following curve data: Delta (Δ) = 09°-32'-23", Radius (R) = 719.06 feet, and Tangent (T) = 60.00 feet;

THENCE continuing along the centerline of Township Road # 95, Kruse Road, with a bearing of S. 49°-28'-37" W. for a distance of 127.10 feet to a P.K. Nail/Shiner (found) at the P.C. of a curve

THENCE continuing along the centerline of Township Road # 95, Kruse Road, with a curve to the left for an arc length of 145.91 feet to a P.K. Nail/Shiner (found) at the P.T. of the curve having the following curve data: Delta (Δ) = 32°-40'-42", Radius (R) = 255.83 feet, and Tangent (T) = 75.00 feet;

THENCE continuing along the centerline of Township Road # 95, Kruse Road, with a bearing of S. 16°-47'-55" W. for a distance of 213.98 feet to a P.K. Nail/Shiner (found);

THENCE with a bearing of S. 87°-40'-01" W. along the South Line of the Northeast Quarter of said Section 28, Moulton Township, for a distance of 1,008.01 feet to an iron pin (found) and the original PLACE OF BEGINNING.

Containing in all 22.658 Acres of land, of which, 0.255 Acre being previously dedicated for highway purposes. The above described parcel of land is also subject to all other legal easements, reservations, or restrictions, if any, upon said premises.

Prepared by:

Ted K. Schnell
Professional Engineer
Professional Surveyor