

DAMMEYER SURVEY
S.E. 1/4 & S.W. 1/4 SEC. 28, T 5S, R 4E
NOBLE TWP., AUGLAIZE CO. OH

VICINITY MAP
NO SCALE

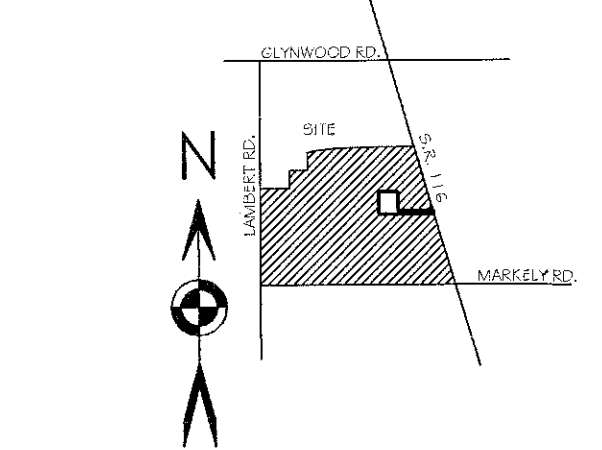

0' 200' 400'
SCALE 1" = 200'

BASIS OF BEARING: BEARINGS ARE BASED UPON THE
OHIO DEPARTMENT OF TRANSPORTATION V.R.S., NAD
83(2011 ADJ.). GROUND DISTANCES SHOWN.

LEGEND

- 5/8x30" IRON PIN (SET) W PINK PLASTIC CAP STAMPED "LOCK TWO 7988"
- ⊙ MAG SPIKE (SET)
- ⊙ GIN SPINDLE (FOUND)
- ⊙ IRON PIN (FOUND)
- ⊙ MAG NAIL (FOUND)
- ⊙ MON. BOX W/IRON PIN (FOUND)
- ⊙ CONC. RW MONUMENT (FOUND)
- ⊙ FENCE POST (FOUND)
- (R) RECORDED

REFERENCES

SURVEYS AS FILED IN THE AUGLAIZE COUNTY TAX MAP OFFICE:
G-747
M-247
M-686
M-690
M-694
P-494
R-6
NOB 33-13

OHIO DEPARTMENT OF TRANSPORTATION RECORDS:
CENTERLINE SURVEY PLAT OF STATE ROUTE 116 PG. 1 OF 3
STATIONING SHOWN BASED ON THAT RECORD.

FILED IN SURVEY NOB-28-6 IN THE AUGLAIZE
COUNTY TAX MAP OFFICE.

LOCK-TWO SURVEYING
5166 LOCK TWO RD. NEW BREMEN, OH
419-753-3332

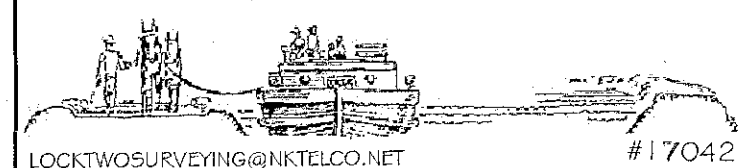

LOCKTWO SURVEYING@NKTLCO.NET

#17042

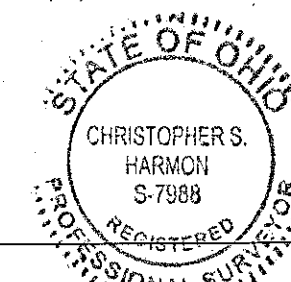

Christopher S. Harmon
CHRISTOPHER S. HARMON P.S. #7988

SURVEY NOTE:
I HEREBY STATE THAT THIS IS A TRUE AND ACCURATE SURVEY AS PERFORMED BY MYSELF, ALL ADJOINING OWNERS, FOUND MONUMENTS AND THEIR CONDITION ARE CURRENT AS OF THE TIME THE FIELD WORK WAS PERFORMED IN AUGUST, 2017 AND DONE WITHOUT THE BENEFIT OF A TITLE SEARCH.

NOB-28-6

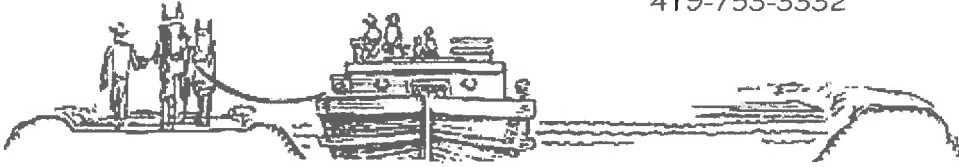

**DAMMEYER RETRACEMENT SURVEY
PARCEL #H2302800206
83.393 ACRES**

SITUATE IN THE SOUTHWEST & SOUTHEAST QUARTERS OF SECTION 28, TOWN 5S, RANGE 4E, NOBLE TOWNSHIP, AUGLAIZE COUNTY OHIO, PART OF THOSE LANDS OWNED BY KENNETH A. DAMMEYER AND SHIRLEY S. DAMMEYER AS RECORDED IN OFFICIAL RECORD 592 PAGE 1092 AND BEING MORE PARTICULARLY DESCRIBED AS FOLLOWS:

Beginning at a 1 inch iron pin found in a monument box at the southwest corner of the southwest quarter of Section 28 and being in the centerline of Lambert Road, said iron pin marking the **Point of Beginning** of the tract herein described;

Thence, with the west line of the southwest quarter of Section 28 and the centerline of Lambert Road, North $01^{\circ}07'12''$ East, 426.97 feet to the southwest corner of a 5.04 acre tract of land owned by G. & A. Lee as recorded in Official Record 641 Page 1918, witnessing at North $88^{\circ}54'31''$ West, 0.33 feet a gin spindle found;

Thence, with the south line of said 5.04 acre tract, South $88^{\circ}54'31''$ East, 513.96 feet to an iron pin with "Geeslin" cap found, passing for reference at 16.33 feet an iron pin with "Geeslin" cap found and at 16.50 feet the east right of way line of Lambert Road;

Thence, North $01^{\circ}05'45''$ East, 426.62 feet to an iron pin with "Geeslin" cap found in the south line of a 5.3 acre tract of land owned by P. & S. Schwartz as recorded in Official Record 646 Page 78;

Thence, with the south line of said 5.3 acre tract, South $88^{\circ}50'44''$ East, 145.74 feet to an iron pin with "Geeslin" cap found;

Thence, with the east line of said 5.3 acre tract, North $01^{\circ}06'52''$ East, 350.00 feet to an iron pin with "Geeslin" cap found at the southeast quarter of a 6.0 acre tract of land owned by K. Tischler as recorded in Official Record 433 Page 442;

Thence, with the east line of said 6.0 acre tract, North $01^{\circ}08'16''$ East, 469.77 feet to an iron pin with "Geeslin" cap found in the south line of a 27.459 acre tract of land owned by M. Dammeyer as recorded in Official Record 420 Page 434;

Thence, with the south line of said 27.459 acre tract, the following 4 courses:

1. South $87^{\circ}50'15''$ East, 251.24 feet to an iron pin with "Geeslin" cap found;
2. North $83^{\circ}21'55''$ East, 155.81 feet to an iron pin with "Geeslin" cap found;
3. North $87^{\circ}44'06''$ East, 424.88 feet to an iron pin with "Geeslin" cap found;
4. South $89^{\circ}21'40''$ East, 893.76 feet to a gin spindle found in the centerline of State Route 116, passing at 861.78 feet a 5/8 inch iron pin found bent in the east right of way line of State Route 116;

Thence, with the centerline of State Route 116, South $19^{\circ}35'49''$ East, 987.32 feet to a Mag Spike set at the northeast corner of a 5.001 acre tract of land owned by Kenneth A. Dammeyer and Shirley S. Dammeyer as recorded in Official Record 552 Page 1913;

Lock Two Surveying, LLP.

5166 Lock Two Rd.
New Bremen, Oh 45869
419-753-3332

Cell: Jenny Saintignon 419-733-9606
Chris Harmon P.S. 419-733-9607

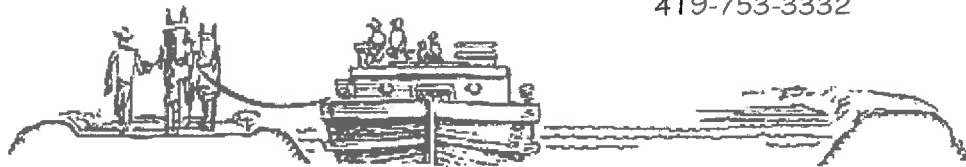

Thence, with the lines of said 5.001 acre tract the following 5 courses:

1. North 89°06'30" West, 1363.12 feet to a 5/8 inch iron pin found, passing for reference at 31.79 feet an iron pin set in the west right of way line of State Route 116 and at 68.93 feet the east line of the southwest quarter of Section 28;
2. North 01°06'51" East 396.16 feet to a 5/8 inch iron pin found;
3. North 89°03'57" West, 423.79 feet to a 5/8 inch iron pin found;
4. South 01°07'08" West, 423.95 feet to a 5/8 inch iron pin found;
5. South 89°05'48" East, 1797.45 feet to a Mag Spike set in the centerline of State Route 116, passing for reference at 1707.51 feet the east line of the southwest quarter of Section 28 and at 1765.43 feet an iron pin set in the west right of way line of State Route 116;

Thence, with the centerline of State Route 116, South 19°35'49" East, 828.94 feet to an iron pin found with "O.D.O.T." cap at Station 140+99.19 and being in the south line of the southeast quarter of said Section 28;

Thence, with the south line of the southeast quarter of Section 28 and the north line of an 80.2 acre tract of land owned by R. Imwalle & T. Cisco as recorded in Official Record 44 Page 771, North 88°57'18" West, 383.29 feet to an iron pin set at the southeast corner of the southwest quarter of Section 28;

Thence, with the south line of the southwest quarter of Section 28, the north line of said 80.2 acre tract, the north line of a 55.743 acre tract of land owned by R. & M. Hecht as recorded in Official Record 650 Page 658 and the north line of a 5.001 acre tract of land owned by R. & A. Stolzenburg as recorded in Official Record 30 Page 505, North 88°46'55" West, 2652.82 feet to the **Point of Beginning**, passing for reference at 2636.32 feet the east right of way line of Lambert Road, containing 83.393 acres more or less of which 0.162 acres lie within the right of way of Lambert Road and 1.251 acres lie within the right of way of State Route 116 and being subject to all legal rights of ways easements, agreements and restrictions of record.

Basis of bearings is based on the Ohio Department of Transportation V.R.S., NAD 83(2011ADJ). The Official Records and Deed Volumes are all recorded in Auglaize County Recorder's Office. Pins noted as set are 5/8" x 30" re-bar with pink plastic caps stamped "Lock-Two 7988".

The above description was prepared by Lock-Two Surveying, LLP from a survey performed by Christopher S. Harmon, Professional Surveyor #7988 in August of 2017 and filed as **Survey NOB 28-6** in the Auglaize County Tax Map Office.

Christopher S. Harmon P.S. #7988



8/25/17
Date