

GLYNWOOD ROAD (C.R. 160)

Northwest corner,  
Northwest Quarter,  
Section 28

#### LEGEND

- △ Mag Nail (set)
- ▲ Mag Nail (found)
- 5/8" Iron Pin (set)
- 5/8" Iron Pin (found)
- ⊗ 1" o.d. Iron Pipe (found)
- ⊠ 2" o.d. Iron Pipe (found)
- Monument Box (found)
- Corner Stone (found)
- calc Calculated from County Global Positioning Survey

#### ODOT CURVE DATA

DELTA Δ = 1°-00'-19" LT  
Radius (R) = 5,729.58'  
Tangent (T) = 50.27'  
Length (L) = 100.53'  
Chord Dist = 100.52'  
Chord Brng = N. 20°-05'-58" W.  
PC Sta 140+62.89  
PI Sta 141+13.16  
PT Sta 141+63.42

#### SCALE

0 200 400 600 800

#### SURVEYOR'S CERTIFICATION

I do hereby Attest that this Survey and Plat as Recorded is a true and accurate representation of the measurements taken under my direct supervision during the month of March 2022.

*Ted K. Schnell*

03 / 23 / 2022  
date

Ted K. Schnell  
Professional Engineer #51963 (Ohio)  
Professional Surveyor #7216 (Ohio)

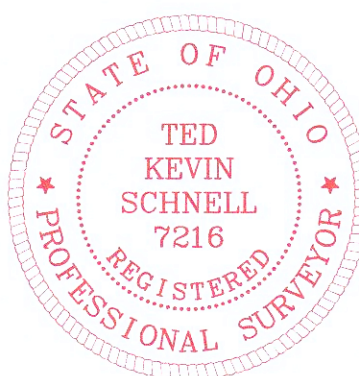
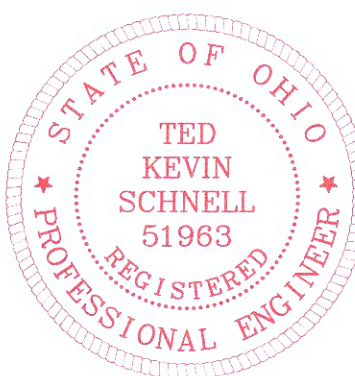

#### NOTES

- The prior survey performed by Gordon Geeslin (dated November 8, 1995 per survey NOB-28-1) established the South line of the Southwest and Southeast Quarters of Section 28, Noble Township. Said survey held a straight line projection from the Monument Box situated at the Southwest corner of the Southwest Quarter of said Section 28 to the Monument Box situated at the Southeast corner of the Southeast Quarter of said Section 28.
- The Basis of Bearings used for this Survey assumed the centerline of State Route 116 to bear N. 19°-35'-49" W. from centerline Station 110+40.99 (P.I.), to centerline Station 141+13.16 (P.I.). Stations derived from a centerline survey plot of the Ohio Department of Transportation (referenced as AUG-116-1.27) as recorded in Centerline Plat Volume 1, Page 74, Auglaize County Recorder's Office.
- This survey is on file with the Auglaize County Engineer's Map Office, filed at SURVEY NOB-28-9

Southwest corner,  
Southwest Quarter,  
Section 28

N. 88°-51'-56" W. - 2,652.81' (calc)

Southwest corner,  
Section 28  
(calc)

Sec Line is 3.76' North of  
Monument Box along the  
centerline of S.R. 116. Mon  
Box at P.I. Sta 110+40.99

Monument Box at P.I. Sta  
110+40.99 is used for the  
place of reference point for  
describing Parcels A and B

## SURVEY FOR THE CITY OF ST. MARYS, OHIO

Being a part of the Northwest Quarter, Southwest Quarter, and the  
Southeast Quarter of Section 28, Noble Township, Town-5-South,  
Range-4-East, Auglaize County, Ohio.

City of St. Marys - Parcel H23-028-004-00

Deed Vol OR 444, PG 192

TOTAL ACRES SURVEYED = 160.689

#### LOCATION

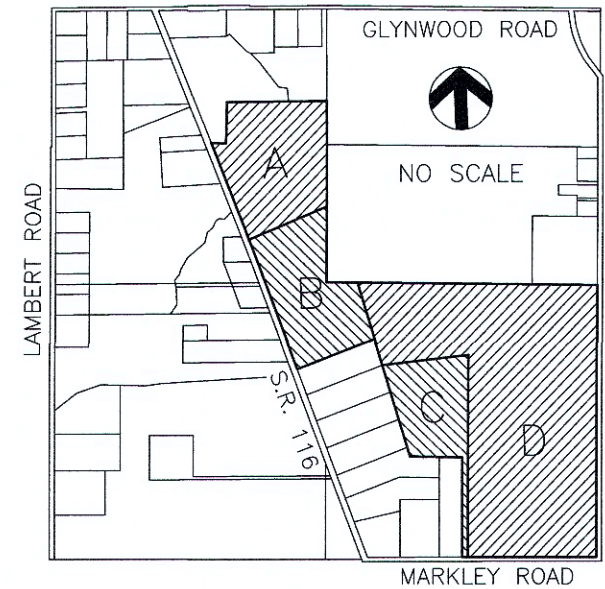

Section 28 - Noble Township

#### DETAIL-1

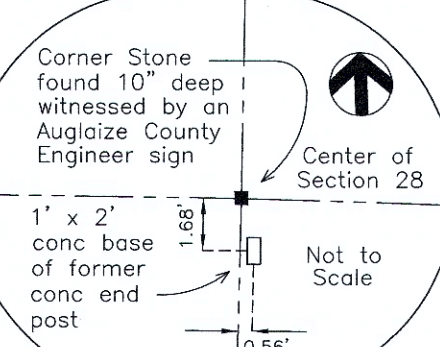

#### NOTE

See County Engineer and Commissioner's records of Ditch Petitions for the Dabbelt Ditch and Imwalle-Lhamon Ditch

#### PARCEL D

93.833 Acres

2.088 Acres in R/W

(farmland)

#### SURVEY REFERENCES

Survey Plat by Mike Weadock  
See Survey NOB-28-2  
Auglaize County Map Office  
June, 1976

Survey Plat by James Geeslin  
See Survey NOB-28-1  
Auglaize County Map Office  
November 8, 1995

Centerline Plat (ODOT Div 7)  
See Centerline Plat Volume 1, Page 74  
Auglaize County Recorder's Office  
February, 1996

Survey Plat by Choice One Engineering  
See Survey NOB-28-7  
Auglaize County Recorder's Office  
January 29, 2021

#### PARCEL C

16.085 Acres

0.023 Acres in R/W

(woods)

(woods)

#### DETAIL-2

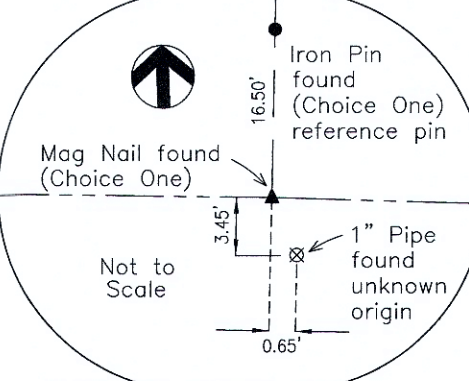

PROPOSED PARCEL SPLITS FROM PARCEL H23-028-004-00

Ted K. Schnell P. E. P. S.

913 Fieldstone Court Wapakoneta, Ohio 45895  
Voice: (419) 738-4758 Cell: (419) 230-7896  
e-mail: kschnell7216@gmail.com

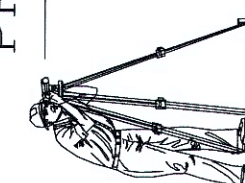

No.	Revision/Issue	Date

Project Name

PROPOSED PARCEL SPLITS  
TO PERMANENT PARCEL  
H23-028-004-00  
BY THE CITY OF ST MARYS

Project Location

LOCATED IN THE NORTHWEST,  
SOUTHWEST, AND SOUTHEAST  
QUARTERS OF SECTION 28  
NOBLE TOWNSHIP  
T-5-S, R-4-E

Project

CITY ST MARYS

Date

03/23/22

Scale

SHOWN

Sheet

1

9

SEE 8 PAGES OF  
ATTACHED LEGALS

NOB-28-9



Ted K. Schnell PE, PS  
913 Fieldstone Court  
Wapakoneta, Ohio 45895  
Phone (419) 230-7896  
e-mail: kschnell7216@gmail.com



**SURVEYOR'S DESCRIPTION**  
**PARCEL A – 26.776 Acres**

The following described parcel of land is situated in the Northwest Quarter of Section 28, Noble Township, Town-5-South, Range-4-East, Auglaize County, Ohio, and is more particularly described as follows:

Commencing for reference at an Iron Bar in a Monument Box (found) situated on the centerline of State Route 116 at P.I. Station 110+40.99 as referenced by a centerline survey plat of the Ohio Department of Transportation (referenced as Aug-116-1.27) as recorded in Centerline Plat Volume 1, Page 74, Auglaize County Recorder's Office;

Thence with an assumed bearing of N. 19°-35'-49" W. along the centerline of said State Route 116 for a distance of 3,021.98 feet to a Mag Nail (found) at the P.C. of a curve;

Thence continuing along the centerline of said State Route 116 with a curve to the left for an Arc Length of 100.53 feet to a Mag Nail (found) at the P.T. of the curve, said curve to the left having the following curve data: Delta = 01°-00'-19", Radius = 5,729.58 feet, Tangent = 50.27 feet, Chord Bearing = N. 20°-05'-58" W. and Chord Distance = 100.52 feet;

Thence continuing along the centerline of said State Route 116 with a bearing of N. 20°-36'-08" W. for a distance of 164.99 feet to a Mag Nail (set) and the PLACE OF BEGINNING;

Thence continuing along the centerline of said State Route 116 with a bearing of N. 20°-36'-08" W. for a distance of 1,004.04 feet to a Mag Nail (found), said Mag Nail also being the Southwest corner of a tract of land currently owned by Ruth E. Langsdon as referenced by permanent parcel #H23-028-007-00 as described in Deed Volume OR 82, Page 460;

Thence with a bearing of S. 88°-17'-01" E. and along the Southerly line of a tract of land currently owned by said Ruth E. Langsdon for a distance of 175.57 feet to a 2" o.d. Iron Pipe (found) and passing thru a 5/8" Iron Pin (found) for reference at a distance of 32.45 feet;

Thence with a bearing of N. 02°-16'-35" E. and along the Easterly line of a tract of land currently owned by said Ruth E. Langsdon for a distance of 399.07 feet to a 2" o.d. Iron Pipe (found);

Thence with a bearing of S. 89°-19'-51" E. and along the Southerly line of a tract of land currently owned by said Ruth E. Langsdon and it's extension thereof, for a distance of 971.53 feet to a 2" o.d. Iron Pipe (found) at the Southeasterly corner of a tract of land currently owned by Donald and Elizabeth Hinckley as referenced by permanent parcel #H23-028-007-01 as described in Deed Volume OR 716, Page 3152;

Thence with a bearing of S. 01°-03'-15" W. along the East line of the Northwest Quarter of said Section 28, Noble Township, and along the Westerly line of a tract of land currently owned by Melvin McDermit (1/3 interest) and Larry M. and Cornelia A. Rable (2/3 interest) as referenced by permanent parcel #H23-028-006-00 as described in Deed Volume OR 660, Page 480, and also along the Westerly line of a tract of land currently owned by Paul E. Whetstone, Dale E. Whetstone, and Dianne M. Uhlenhake (trustees) as referenced by permanent parcel #H23-028-005-05 as described in Deed Volume OR 455, Page 1485, for a distance of 1,006.90 feet to a 5/8" Iron Pin (set);

Thence with a bearing of S. 68°-16'-12" W. for a distance of 851.49 feet to a Mag Nail (set), and passing thru an 5/8" Iron Pin (set) for reference at a distance of 821.49 feet, said Mag Nail (set) being the original PLACE OF BEGINNING.

The above described Parcel of land is being referred to as Parcel A of a survey plat as recorded with the Auglaize County Engineer's Map Office (See Survey NOB-28-9) and contains in all 26.776 Acres, of which, 0.687 Acre being previously dedicated for highway purposes. The above described parcel of land is also subject to any or all legal easements, reservations, right-of-ways, or deed restrictions, if any, upon said premises.

Prior Deed References: Deed Volume: OR 444, Page 192.

This parcel is being split out of permanent parcel #H23-028-004-00.

The basis of bearings used for this description assumed the centerline of State Route 116 to bear N. 19°-35'-49" W. from centerline station 110+40.99 (P.I) to centerline station 141+13.16 (P.I.), said centerline stations being referenced to a centerline survey plat Ohio Department of Transportation (referenced as Aug-116-1.27) as filed in Centerline Plat Volume 1, Page 74, Auglaize County Recorder's Office.

This legal description was prepared from an actual field survey performed by Ted K. Schnell, Professional Land Surveyor #7216, during the month of March, 2022. A survey plat of this field survey is recorded with the Auglaize County Engineer's Map Office. See Survey NOB-28-9.

Prepared By:

*Ted K. Schnell*

Ted K. Schnell  
Professional Engineer 51963 (Ohio)  
Professional Surveyor 7216 (Ohio)

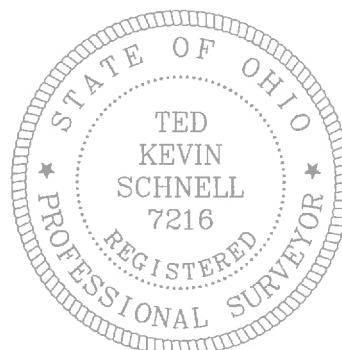
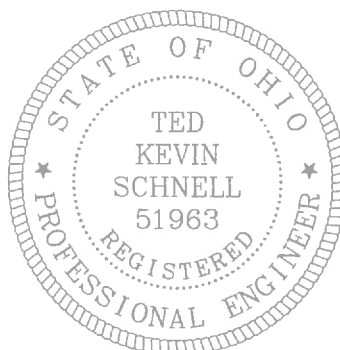

Ted K. Schnell PE, PS  
913 Fieldstone Court  
Wapakoneta, Ohio 45895  
Phone (419) 230-7896  
e-mail: kschnell7216@gmail.com



## SURVEYOR'S DESCRIPTION PARCEL B – 23.995 Acres

The following described parcel of land is situated in the Northwest, Southwest, and Southeast Quarters of Section 28, Noble Township, Town-5-South, Range-4-East, Auglaize County, Ohio, and is more particularly described as follows:

Commencing for reference at an Iron Bar in a Monument Box (found) situated on the centerline of State Route 116 at P.I. Station 110+40.99 as referenced by a centerline survey plat of the Ohio Department of Transportation (referenced as Aug-116-1.27) as recorded in Centerline Plat Volume 1, Page 74, Auglaize County Recorder's Office;

Thence with an assumed bearing of N.  $19^{\circ}-35'-49''$  W. along the centerline of said State Route 116. for a distance of 1,947.24 feet to a Mag Nail (found), said Mag Nail also being the Northwest corner of a tract of land currently owned by James L. and Amy J. Freewalt as referenced by permanent parcel #H23-028-003-01 as described in Deed Volume OR 675, Page 342, said Mag Nail (found) being the PLACE OF BEGINNING;

Thence continuing along the centerline of said State Route 116 with an assumed bearing of N.  $19^{\circ}-35'-49''$  W. for a distance of 1,074.74 feet to a Mag Nail (found) at the P.C. of a curve;

Thence continuing along the centerline of said State Route 116 with a curve to the left for an Arc Length of 100.53 feet to a Mag Nail (found) at the P.T. of the curve, said curve to the left having the following curve data: Delta =  $01^{\circ}-00'-19''$ , Radius = 5,729.58 feet, Tangent = 50.27 feet, Chord Bearing = N.  $20^{\circ}-05'-58''$  W. and Chord Distance = 100.52 feet;

Thence continuing along the centerline of said State Route 116 with a bearing of N.  $20^{\circ}-36'-08''$  W. for a distance of 164.99 feet to a Mag Nail (set);

Thence with a bearing of N.  $68^{\circ}-16'-12''$  E. for a distance of 851.49 feet to a  $5/8''$  Iron Pin (set), and passing thru a  $5/8''$  Iron Pin (set) for reference at a distance of 30.00 feet;

Thence with a bearing of S.  $01^{\circ}-03'-15''$  W. along the East line of the Northwest Quarter of said Section 28, Noble Township, and along the Westerly line of a tract of land currently owned by owned by Paul E. Whetstone, Dale E. Whetstone, and Dianne M. Uhlenhake (trustees) as referenced by permanent parcel #H23-028-005-05 as described in Deed Volume OR 455, Page 1485, for a distance of 735.66 feet to a corner stone (found) at the center of said Section 28, Noble Township, said corner stone being witnessed by an Auglaize County Engineer's sign & post (found);

Thence with a bearing of S. 88°-15'-52" E. along the North line of the Southeast Quarter of said Section 28, Noble Township, and along the Southerly line of a tract of land currently owned by said Paul E. Whetstone, Dale E. Whetstone, and Dianne M. Uhlenhake (trustees), for a distance of 299.23 feet to a 5/8" Iron Pin (set);

Thence with a bearing of S. 16°-03'-41" E. for a distance of 569.65 feet to a 5/8" Iron Pin (found) situated at the Northeast corner of a tract of land currently owned by James L. and Amy J. Freewalt as referenced by permanent parcel #H23-028-003-01 as described in Deed Volume OR 675, Page 342;

Thence with a bearing of S. 69°-58'-55" W. along the Northerly line of a tract of land currently owned by said James L. and Amy J. Freewalt tract, for a distance of 831.29 feet to a Mag Nail (found), and passing thru a 5/8" Iron Pin (found) for reference at a distance of 801.32 feet, said Mag Nail (found) being the original PLACE OF BEGINNING.

The above described Parcel of land is being referred to as Parcel B of a survey plat as recorded with the Auglaize County Engineer's Map Office (See Survey NOB-28-9) and contains in all 23.995 Acres of land, of which, 0.923 Acre being previously dedicated for highway purposes. The above described parcel of land contains 9.571 Acres in the Northwest Quarter, 8.647 Acres in the Southwest Quarter, and 5.777 Acres in the Southeast Quarter, all in Section 28, Noble Township.

The above described parcel of land is also subject to any or all legal easements, reservations, right-of-ways, or deed restrictions, if any, upon said premises.

Prior Deed References: Deed Volume: OR 444, Page 192.

This parcel is being split out of permanent parcel #H23-028-004-00.

The basis of bearings used for this description assumed the centerline of State Route 116 to bear N. 19°-35'-49" W. from centerline station 110+40.99 (P.I) to centerline station 141+13.16 (P.I.), said centerline stations being referenced to a centerline survey plat Ohio Department of Transportation (referenced as Aug-116-1.27) as filed in Centerline Plat Volume 1, Page 74, Auglaize County Recorder's Office.

This legal description was prepared from an actual field survey performed by Ted K. Schnell, Professional Land Surveyor #7216, during the month of March, 2022. A survey plat of this field survey is recorded with the Auglaize County Engineer's Map Office. See Survey NOB-28-9.

Prepared By:

*Ted K. Schnell*

Ted K. Schnell  
Professional Engineer 51963 (Ohio)  
Professional Surveyor 7216 (Ohio)

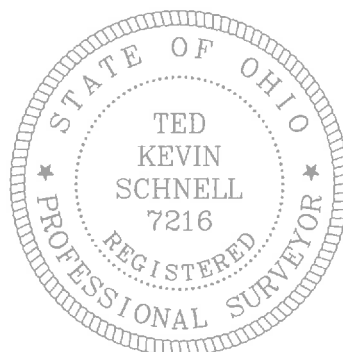
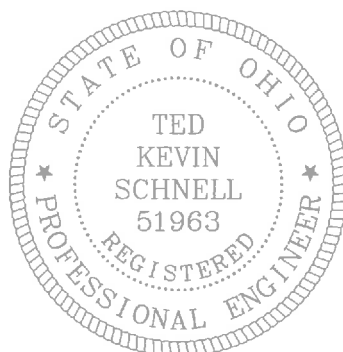

Ted K. Schnell PE, PS  
913 Fieldstone Court  
Wapakoneta, Ohio 45895  
Phone (419) 230-7896  
e-mail: kschnell7216@gmail.com



**SURVEYOR'S DESCRIPTION**  
**PARCEL C – 16.085 Acres**

The following described parcel of land is situated in the Southeast Quarter of Section 28, Noble Township, Town-5-South, Range-4-East, Auglaize County, Ohio, and is more particularly described as follows:

Commencing for reference at an Iron Bar in a Monument Box (found) situated at the Southeast corner of the Southeast Quarter of said Section 28, Noble Township, same being the intersection of the legal centerlines of St. Marys River Road (C.R. 41A) and Markley Road (T.R. 150);

Thence with a bearing of N. 88°-51'-56" W. along the South line of the Southeast Quarter of said Section 28, Noble Township, and the legal centerline of Markley Road (T.R. 150), for a distance of 1,276.59 feet to a Mag Nail (set) and the PLACE OF BEGINNING;

Thence continuing with a bearing of N. 88°-51'-56" W. along the South line of the Southeast Quarter of said Section 28, Noble Township, and the legal centerline of Markley Road (T.R. 150), for a distance of 50.00 feet to a Mag Nail (found), said Mag Nail also being the Southeast corner of a tract of land currently owned by James and Lisa Davenport as referenced by permanent parcel #H23-028-003-05 as described in Deed Volume OR 309, Page 445;

Thence with a bearing of N. 01°-09'-35" E. along the Easterly line of a tract of land currently owned by said James and Lisa Davenport, for a distance of 976.75 feet to a 5/8" Iron Pin (found), and passing thru a 5/8" Iron Pin (found) for reference at a distance of 16.50 feet;

Thence with a bearing of N. 87°-38'-00" W. along the Northerly line of a tract of land currently owned by said James and Lisa Davenport, and also along the Northerly line of a tract of land currently owned by Christopher L. and Sarah A. Howe as referenced by permanent parcel #H23-028-003-03 as described in Deed Volume OR 558, Page 438, for a distance of 507.82 feet to a 5/8" Iron Pin (found);

Thence with a bearing of N. 16°-03'-41" W. along the Easterly line of a tract of land currently owned by said Christopher L. and Sarah A. Howe and it's extension thereof, for a distance of 917.58 feet to a 5/8" Iron Pin (found) at the Southeasterly corner of a tract of land currently owned by James L. and Amy J. Freewalt as referenced by permanent parcel #H23-028-003-01 as described in Deed Volume OR 675, Page 342;

Thence with a bearing of N. 84°-24'-39" E. for a distance of 835.16 feet to a 5/8" Iron Pin (set);

Thence with a bearing of S. 01°-09'-35" W. for a distance of 1,962.02 feet to a Mag Nail (set), and passing thru a 5/8" Iron Pin (set) for reference at a distance of 1,945.52 feet, said Mag Nail (set) being the original PLACE OF BEGINNING.

The above described Parcel of land is being referred to as Parcel C of a survey plat as recorded with the Auglaize County Engineer's Map Office (See Survey NOB-28-9) and contains in all 16.085 Acres of land, of which, 0.023 Acre being previously dedicated for highway purposes. The above described parcel of land is also subject to any or all legal easements, reservations, right-of-ways, or deed restrictions, if any, upon said premises.

Prior Deed References: Deed Volume: OR 444, Page 192.

This parcel is being split out of permanent parcel #H23-028-004-00.

The basis of bearings used for this description assumed the centerline of State Route 116 to bear N. 19°-35'-49" W. from centerline station 110+40.99 (P.I) to centerline station 141+13.16 (P.I.), said centerline stations being referenced to a centerline survey plat Ohio Department of Transportation (referenced as Aug-116-1.27) as filed in Centerline Plat Volume 1, Page 74, Auglaize County Recorder's Office.

This legal description was prepared from an actual field survey performed by Ted K. Schnell, Professional Land Surveyor #7216, during the month of March, 2022. A survey plat of this field survey is recorded with the Auglaize County Engineer's Map Office. See Survey NOB-28-9.

Prepared By:



---

Ted K. Schnell  
Professional Engineer 51963 (Ohio)  
Professional Surveyor 7216 (Ohio)

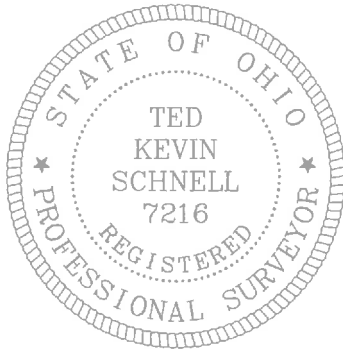
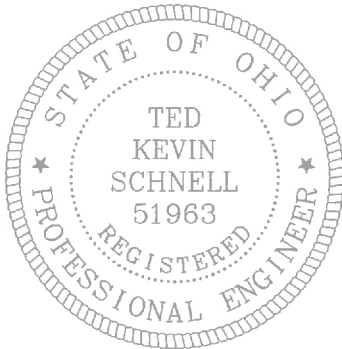

Ted K. Schnell PE, PS  
913 Fieldstone Court  
Wapakoneta, Ohio 45895  
Phone (419) 230-7896  
e-mail: kschnell7216@gmail.com



**SURVEYOR'S DESCRIPTION**  
**PARCEL D – 93.833 Acres**

The following described parcel of land is situated in the Southeast Quarter of Section 28, Noble Township, Town-5-South, Range-4-East, Auglaize County, Ohio, and is more particularly described as follows:

Commencing at an Iron Bar in a Monument Box (found) situated at the Southeast corner of the Southeast Quarter of said Section 28, Noble Township, same being the intersection of the legal centerlines of St. Marys River Road (C.R. 41A) and Markley Road (T.R. 150) and the PLACE OF BEGINNING;

Thence with a bearing of N. 88°-51'-56" W. along the South line of the Southeast Quarter of said Section 28, Noble Township, and the legal centerline of Markley Road (T.R. 150), for a distance of 1,276.59 feet to a Mag Nail (set);

Thence with a bearing of N. 01°-09'-35" E. for a distance of 1,962.02 feet to a 5/8" Iron Pin (set), and passing thru a 5/8" Iron Pin (set) for reference at a distance of 16.50 feet;

Thence with a bearing of S. 84°-24'-39" W. for a distance of 835.16 feet to a 5/8" Iron Pin (found) at the Southeasterly corner of a tract of land currently owned by James L. and Amy J. Freewalt as referenced by permanent parcel #H23-028-003-01 as described in Deed Volume OR 675, Page 342;

Thence with a bearing of N. 16°-03'-41" W. along the Easterly line of a tract of land currently owned by said James L. and Amy J. Freewalt, and passing thru an Iron Pin (found) at the Northeasterly corner of said Freewalt tract at a distance of 265.23 feet, for a total distance of 834.88 feet to a 5/8" Iron Pin (set);

Thence with a bearing of S. 88°-15'-52" E. along the North line of the Southeast Quarter of said Section 28, Noble Township, and along the Southerly line of a tract of land currently owned by Paul E. Whetstone, Dale E. Whetstone, and Dianne M. Uhlenhake (trustees) as referenced by permanent parcel #H23-028-005-05 as described in Deed Volume OR 455, Page 1485, and also along the Southerly line of a tract of land currently owned by Kurt D. Deitsch as referenced by permanent parcel #H23-028-005-01 as described in Deed Volume OR 397, Page 482, for a distance of 2,352.42 feet to an Iron Bar in a Monument Box (found) situated at the Northeast corner of the Southeast Quarter of said Section 28, Noble Township, and passing thru a 5/8" Iron Pin (found) for reference at a distance of 2,327.42 feet;



Thence with a bearing of S. 01°-08'-29" W. along the East line of the Southeast Quarter of said Section 28, Noble Township, and the legal centerline of St. Marys River Road (C.R. 41A) for a distance of 2,637.11 feet to an Iron Bar in a Monument Box (found) and the original PLACE OF BEGINNING.

The above described Parcel of land is being referred to as Parcel D of a survey plat as recorded with the Auglaize County Engineer's Map Office (See Survey NOB-28-9) and contains in all 93.833 Acres of land, of which, 2.088 Acres being previously dedicated for highway purposes. The above described parcel of land is also subject to any or all legal easements, reservations, right-of-ways, or deed restrictions, if any, upon said premises.

Prior Deed References: Deed Volume: OR 444, Page 192.

This parcel is being split out of permanent parcel #H23-028-004-00.

The basis of bearings used for this description assumed the centerline of State Route 116 to bear N. 19°-35'-49" W. from centerline station 110+40.99 (P.I) to centerline station 141+13.16 (P.I.), said centerline stations being referenced to a centerline survey plat Ohio Department of Transportation (referenced as Aug-116-1.27) as filed in Centerline Plat Volume 1, Page 74, Auglaize County Recorder's Office.

This legal description was prepared from an actual field survey performed by Ted K. Schnell, Professional Land Surveyor #7216, during the month of March, 2022. A survey plat of this field survey is recorded with the Auglaize County Engineer's Map Office. See Survey NOB-28-9.

Prepared By:

*Ted K. Schnell*

Ted K. Schnell  
Professional Engineer 51963 (Ohio)  
Professional Surveyor 7216 (Ohio)

