

Thomas J. & Tammy S.
BROWN
O.R. Volume 176, Page 662

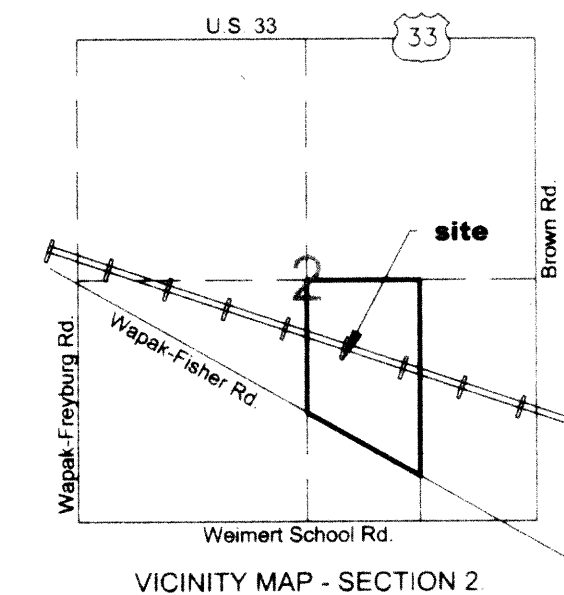
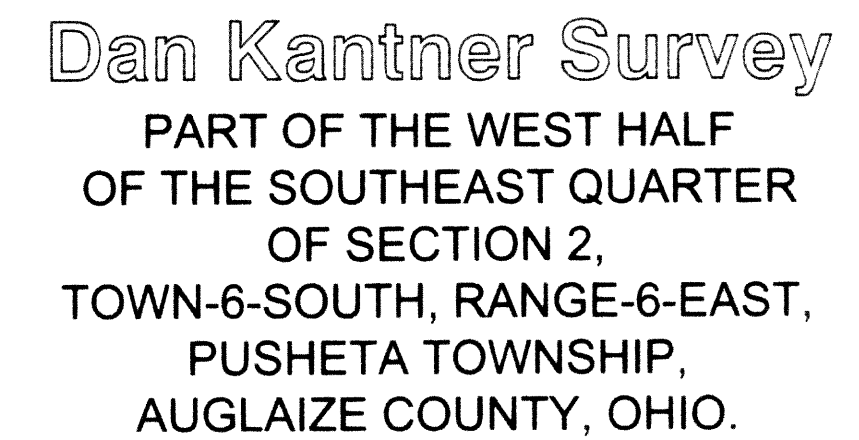

legend

- ☐ Monument Box (found)
- ☐ Cotton Gin Spindle (set)
- ☒ 5/8" re-rod w/cap (set)
- ☐ 8" Wooden fence post (found)
- ☒ 5/8" re-rod w/cap (found)

I hereby certify that this plat is an accurate representation
of a field survey, performed under my direct supervision.

James M. Kent, PS 6792

kent surveying, inc.
acad - kantner, dan
drawing #4196
October 1, 2003

pus-2-2

**DESCRIPTION
TRACT ONE**

Being a part of the west half of the southeast quarter of Section 2, Town-6-South, Range-6-East, Pusheta Township, Auglaize County, Ohio as evidenced by Official Record Volume 409, Page 639, and Official Record Volume 160, Page 154, and more particularly described as follows:

Commencing for reference at a monument box (found) at the southeast corner of the southeast quarter of Section 2, (also being the centerline intersection of Brown Road and Weimert School Road; thence, N 89 degrees 34' 43" W along the legal centerline of Weimert School Road and the south line of the southeast quarter of Section 2, for a distance of 471.05 feet to a monument box (found) at the intersection of Weimert School Road and Wapak-Fisher Road; thence, N 56 degrees 34' 23" W along the legal centerline of Wapak-Fisher Road, for a distance of 1010.98 feet to a cotton gin spindle (set) on the east line of the west half of the southeast quarter of Section 2, said spindle being the **POINT OF BEGINNING** for the tract herein described;

thence, continuing N 56 degrees 34' 23" W along the aforesaid legal centerline, for a distance of 59.10 feet to a cotton gin spindle (set);

thence, N 01 degree 12' 48" E for a distance of 1147.47 feet to a 5/8" re-rod w/cap (set);

thence, N 67 degrees 53' 58" W for a distance of 701.67 feet to a 5/8" re-rod w/cap (set);

thence, S 01 degree 17' 41" W for a distance of 16.05 feet to the former southerly right-of-way of the New York Central Railroad;

thence, N 67 degrees 53' 58" W along the aforesaid former southerly right-of-way, for a distance of 127.98 feet to a 5/8" re-rod w/cap (set);

thence, S 01 degree 17' 41" W for a distance of 614.38 feet to a 5/8" re-rod w/cap (set);

thence, S 89 degrees 07' 51" E for a distance of 153.47 feet to a 5/8" re-rod w/cap (set);

thence, S 04 degrees 23' 35" W (passing through a 5/8" re-rod w/cap set on the northerly right-of-way line of Wapak-Fisher Road at a distance of 379.29 feet) for a total distance of 407.88 feet to a cotton gin spindle (set) on the legal centerline of Wapak-Fisher Road;

thence, N 56 degrees 34' 23" W along the aforesaid legal centerline, for a distance of 701.64 feet to a cotton gin spindle (set);

thence, N 01 degree 17' 41" E for a distance of 29.52 feet to a 5/8" re-rod w/cap set on the northerly right-of-way line of Wapak-Fisher Road;

thence, S 89 degrees 07' 51" E for a distance of 437.76 feet to a 5/8" re-rod w/cap (set);

thence, N 01 degree 17' 41" E for a distance of 677.55 feet to a 5/8" re-rod w/cap (set) on the former northerly right-of-way line of the New York Central Railroad;

thence, S 67 degrees 53' 58" E along the aforesaid former northerly right-of-way line (passing through a 5/8" re-rod w/cap set for reference at a distance of 75.00 feet) for a total distance of 101.75 feet to the centerline of a ditch;

thence, with the centerline of said ditch the following courses;
N 01 degree 46' 31" E for a distance of 27.36 feet;

thence, N 23 degrees 09' 18" W for a distance of 169.34 feet;

thence, N 18 degrees 37' 20" W for a distance of 328.48 feet;

thence, N 09 degrees 36' 44" W for a distance of 113.36 feet to the north line of the west half of the southeast quarter of Section 2;

thence, leaving the aforesaid ditch S 89 degrees 53' 32" E (passing through a 5/8" re-rod w/cap set for reference at a distance of 50.00 feet) for a total distance of 957.54 feet to a 5/8" re-rod w/cap set at the northeast corner of the west half of the southeast quarter of Section 2;

thence, S 01 degree 12' 48" W along the east line of the west half of the southeast quarter of Section 2 (passing through a 5/8" re-rod w/cap set on the northerly right-of-way line of Wapak-Fisher Road at a distance of 2076.35 feet) for a total distance of 2105.90 feet to the **POINT OF BEGINNING**, containing therein 20.180 acres, of which 0.437 acres is road right-of-way. Subject to all easements and right-of-way of record at the time of the recording of this instrument. Prepared by James M. Kent, PS 6792 with reference hereby made to a plat of survey; Kent Surveying, Inc., drawing #4196 dated October 1, 2003. Basis of bearings is per Kieffer Survey; dwg #2666, Kent Surveying - February, 1997.

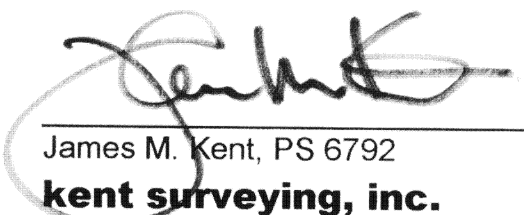
James M. Kent, PS 6792

kent surveying, inc.

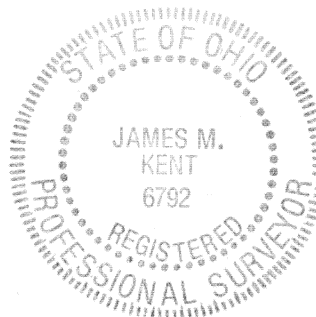

**DESCRIPTION
TRACT TWO**

Being a part of the west half of the southeast quarter of Section 2, Town-6-South, Range-6-East, Pusheta Township, Auglaize County, Ohio as evidenced by Official Record Volume 409, Page 639, and Official Record Volume 160, Page 154, and more particularly described as follows:

Commencing for reference at a monument box (found) at the southeast corner of the southeast quarter of Section 2, (also being the centerline intersection of Brown Road and Weimert School Road; thence, N 89 degrees 34' 43" W along the legal centerline of Weimert School Road and the south line of the southeast quarter of Section 2, for a distance of 471.05 feet to a monument box (found) at the intersection of Weimert School Road and Wapak-Fisher Road; thence, N 56 degrees 34' 23" W along the legal centerline of Wapak-Fisher Road, for a distance of 2534.29 feet to a cotton gin spindle (set), said spindle being the **POINT OF BEGINNING** for the tract herein described;

thence, continuing N 56 degrees 34' 23" W along the aforesaid legal centerline, for a distance of 42.47 feet to a monument box (found) on the west line of the west half of the southeast quarter of Section 2;

thence, N 01 degree 17' 41" E along the aforesaid west line, for a distance of 1245.69 feet to an 8" fence post (found) at the northwest corner of the west half of the southeast quarter of Section 2;

thence, S 89 degrees 53' 32" E along the north line of the west half of the southeast quarter of Section 2, for a distance of 365.69 feet to the centerline of a ditch;

thence, with the following courses along the centerline of the aforesaid ditch;
S 09 degrees 36' 44" E for a distance of 113.36 feet;
S 18 degrees 37' 20" E for a distance of 328.48 feet;
S 23 degrees 09' 18" E for a distance of 169.34 feet;
S 01 degree 46' 31" W for a distance of 27.36 feet to a point on the former northerly right-of-way line of the New York Central Railroad;

thence, leaving the centerline of said ditch N 67 degrees 53' 58" W (passing through a 5/8" re-rod w/cap set for reference at a distance of 26.75 feet) for a total distance of 101.75 feet to a 5/8" re-rod w/cap (set);

thence, S 01 degree 17' 41" W for a distance of 677.55 feet to a 5/8" re-rod w/cap (set);

thence, N 89 degrees 07' 51" W for a distance of 437.76 feet to a 5/8" re-rod w/cap (set) on the northerly right-of-way line of Wapak-Fisher Road;

thence, S 01 degree 17' 41" W for a distance of 29.52 feet to the **POINT OF BEGINNING**, containing therein 13.288 acres, of which 0.024 acres is road right-of-way. Subject to all easements and right-of-way of record at the time of the recording of this instrument. Prepared by James M. Kent, PS 6792 with reference hereby made to a plat of survey; Kent Surveying, Inc., drawing #4196 dated October 1, 2003. Basis of bearings is per Kieffer Survey; dwg #2666, Kent Surveying - February, 1997.

James M. Kent, PS 6792
kent surveying, inc.

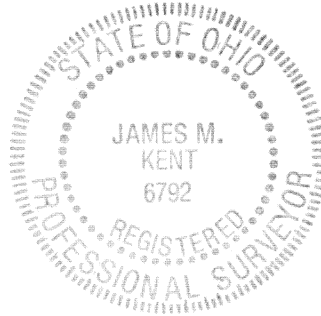

**DESCRIPTION
TRACT THREE**

Being a part of the west half of the southeast quarter of Section 2, Town-6-South, Range-6-East, Pusheta Township, Auglaize County, Ohio as evidenced by Official Record Volume 409, Page 639, and Official Record Volume 160, Page 154, and more particularly described as follows:

Commencing for reference at a monument box (found) at the southeast corner of the southeast quarter of Section 2, (also being the centerline intersection of Brown Road and Weimert School Road; thence, N 89 degrees 34' 43" W along the legal centerline of Weimert School Road and the south line of the southeast quarter of Section 2, for a distance of 471.05 feet to a monument box (found) at the intersection of Weimert School Road and Wapak-Fisher Road; thence, N 56 degrees 34' 23" W along the legal centerline of Wapak-Fisher Road, for a distance of 1070.08 feet to a cotton gin spindle (set), said spindle being the **POINT OF BEGINNING** for the tract herein described;

thence, continuing N 56 degrees 34' 23" W along the aforesaid legal centerline, for a distance of 762.57 feet to a cotton gin spindle (set);

thence, N 04 degrees 23' 35" E (passing through a 5/8" re-rod w/cap set on the northerly right-of-way line of Wapak-Fisher Road at a distance of 28.59 feet) for a total distance of 407.88 feet to a 5/8" re-rod w/cap (set);

thence, N 89 degrees 07' 51" W for a distance of 153.47 feet to a 5/8" re-rod w/cap (set);

thence, N 01 degree 17' 41" E for a distance of 614.38 feet to a 5/8" re-rod w/cap (set) on the former southerly right-of-way line of the New York Central Railroad;

thence, S 67 degrees 53' 58" E along the aforesaid former southerly right-of-way line, for a distance of 127.98 feet to a 5/8" re-rod w/cap (set);

thence, N 01 degree 17' 41" E for a distance of 16.05 feet to a 5/8" re-rod w/cap (set);

thence, S 67 degrees 53' 58" E for a distance of 701.67 feet to a 5/8" re-rod w/cap (set);

thence, S 01 degree 12' 48" W (passing through a 5/8" re-rod w/cap set on the northerly right-of-way line of Wapak-Fisher Road at a distance of 1117.92 feet) for a total distance of 1147.47 feet to the **POINT OF BEGINNING**, containing therein 17.471 acres, of which 0.437 acres is road right-of-way. Subject to all easements and right-of-way of record at the time of the recording of this instrument. Prepared by James M. Kent, PS 6792 with reference hereby made to a plat of survey; Kent Surveying, Inc., drawing #4196 dated October 1, 2003. Basis of bearings is per Kieffer Survey; dwg #2666, Kent Surveying - February, 1997.

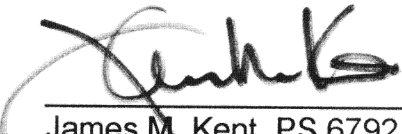
James M. Kent, PS 6792

kent surveying, inc.

