

JEROME & JOAN FISHER SURVEY
Part of the SE 1/4 of Section 12,
Town-6-South, Range-6-East, Pusheta Township,
Auglaize County, State of Ohio.

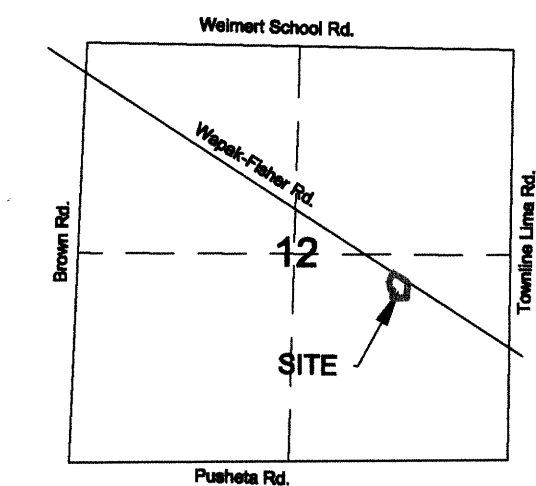

VICINITY MAP ~ SECTION 12
PUSHETA TOWNSHIP

15' ingress/egress
 easement reserved
 to Grantor
 (3,366 s.f. - 0.077 acres)

1.206 Acres
 (0.130 acres road right-of-way)

Jerome and Joan Fisher
 OR Volume 279, Page 597

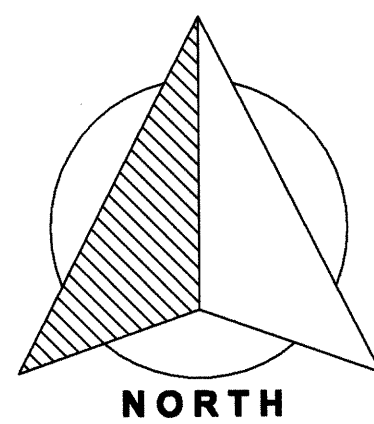

NORTH

GRAPHIC SCALE



(IN FEET)
 1 inch = 40 ft.

LEGEND

- ☛ mag-nail (set)
- ☐ monument box (found)
- ⬡ wood end post (found)
- ⊙ 5/8" re-rod w/cap (set)

Basis of bearings is per Auglaize County
 GPS depicting the centerline of
 Wapak-Fisher Road as bearing N 55° 46'
 54" W

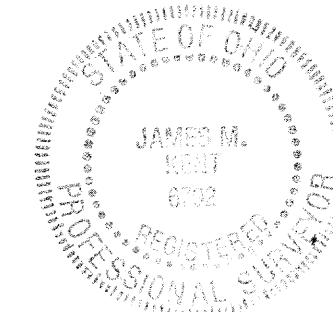

I hereby certify that this plat is an accurate
 representation of a field survey performed
 under my direct supervision.

James M. Kent, Professional Surveyor No 6792

kent surveying, inc.
 acad - Fisher, Jerome
 drawing #5442
 May 28, 2013

PUS-12-1

SURVEYOR'S DESCRIPTION

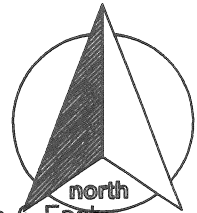

Being a part of the southeast quarter of Section 12, Town-6-South, Range-6-East, Pusheta Township, Auglaize County, Ohio as evidenced by Official Record Volume 279, Page 597 and more particularly described as follows;

Commencing for reference at a monument box (found) on the east line of the southeast quarter of Section 12 and the centerline intersection of Townline Lima Road and Wapak-Fisher Road; thence, N 55° 46' 54" W along the legal centerline of Wapak-Fisher Road for a distance of 1586.70 feet to a mag-nail (set), said nail being the **POINT OF BEGINNING** for the tract herein described;

thence, S 01° 17' 37" W (passing through a wood enc post found on the south right-of-way line of Wapak-Fisher Road at a distance of 29.78 feet) for a total distance of 196.95 feet to a 5/8" re-rod w/cap (set);

thence, N 88° 42' 23" W for a distance of 178.10 feet to a 5/8" re-rod w/cap (set);

thence, N 01° 43' 11" E for a distance of 100.70 feet to a 5/8" re-rod w/cap (set);

thence, N 88° 17' 51" W for a distance of 22.39 feet to a 5/8" re-rod w/cap (set);

thence, N 17° 07' 57" W for a distance of 103.82 feet to a 5/8" re-rod w/cap (set);

thence, N 22° 11' 17" E (passing through a 5/8" re-rod w/cap set on the south right-of-way line of Wapak-Fisher Road at a distance of 99.34 feet) for a total distance of 124.79 feet to a mag-nail (set) on the legal centerline of Wapak-Fisher Road;

thence, along the aforesaid legal centerline, S 56° 58' 42" E for a distance of 111.94 feet to a monument box (found);

thence, continuing along the aforesaid legal centerline, S 55° 46' 54" E for a distance of 110.61 feet to the **POINT OF BEGINNING**, containing therein **1.206 acres**, of which 0.130 acres is road right-of-way.

ALSO: An ingress/egress easement is hereby reserved by the Grantor, said easement described as follows:

BEGINNING at the northwest corner of the above described property;

thence, S 55° 46' 54" E along the legal centerline of Wapak-Fisher Road for a distance of 15.27 feet to a point;

thence, S 22° 11' 17" W for a distance of 116.56 feet to a point;

thence, S 17° 07' 57" E for a distance of 103.58 feet to a point;

thence, N 88° 17' 51" W for a distance of 15.85 feet to a point;

thence, N 17° 07' 57" W for a distance of 103.82 feet to a point;

thence, N 22° 11' 17" E for a distance of 124.79 feet to the **POINT OF BEGINNING**, containing therein 3,366 square feet or 0.077 acres.

All of the above subject to any easements or right-of-way of record at the time of the recording of this instrument.

Prepared by James M. Kent, Professional Surveyor No. 6792 with reference herein made to a plat of survey; Kent Surveying, Inc. drawing #5442 dated May 28, 2013. Basis of bearings is per Auglaize County GPS depicting the legal centerline of Wapak-Fisher Road from the east line of Section 12 as N 55° 46' 54" W.

James M. Kent, PS 6792

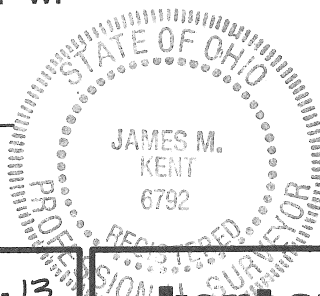

CLIENT JEROME FISHER DATE 5-29-13
COUNTY AUGLAIZE TOWNSHIP PUSHETA
SECTION 12 T-6-S; R-6-E DRAWN BY JMK
SHEET 1 OF 1 DWG. # 5442

 **kent surveying, inc.**
P.O. Box 96 - 1750 Bellefontaine Street
Wapakoneta, OH 45895
419-738-5677 fax 419-738-7894

PUS-12-1a