

Detail of 12' wide "wagon" right-of-way

Anne & Mary HENKENER & Barbara MALSOM
OR Volume 526, Page 2597

KOHLER ROAD

Three B Farms
OR 386, Pg 492

Matthew & Michelle
NEUMAN
OR 477, Pg 870

S88°34'59"E
1316.02'

**TRACT TWO
40.330 ACRES**

GRAPHIC SCALE



(IN FEET)
1 inch = 200 ft.

Basis of bearings is per Auglaize County
GPS depicting the line between the
center of Section 18 and the center of
Section 13 as S 89° 11' 40" E.

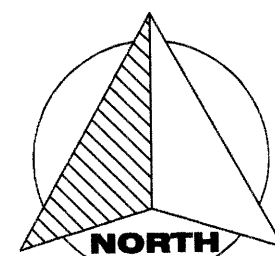

Harold Jr. and Julie
HARROD
OR Vol. 109, Pg 373

757.00'

point on line

Robert & Patricia
Harold Jr. and Julie
HARROD
OR Vol. 64, Pg 379

1266.08'

proportionate measure

1291.60'

wooded

wooded

**TRACT ONE
39.857 ACRES**

point on line
(mid way)

wooded

wooded

N89°01'52"W
1298.54'

5.6'

4.5'

Robert & Patricia
Harold Jr. and Julie
HARROD
OR Vol. 519, Pg 1768

Lowel & Gloria
HEADAPOHL (Trustee)
OR Vol. 188, Pg 132

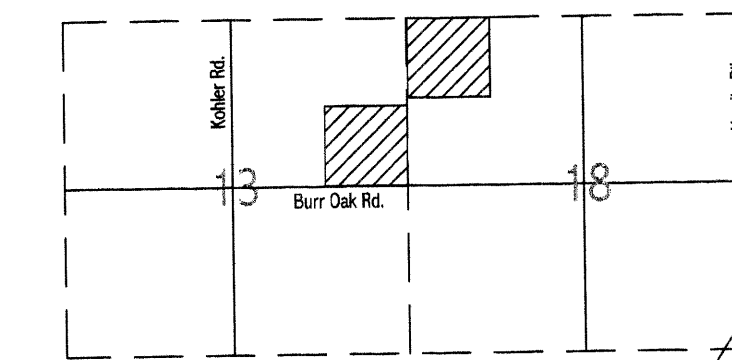

VICINITY MAP
SECTION 13, WASHINGTON TOWNSHIP ~ SECTION 18, PUSHETA TOWNSHIP

LEGEND

- Monument Box (found)
- △ Stone (found)
- 5/8" re-rod w/cap (found)
- Corner Post (found)
- ✂ Railroad rail (found)
- ✂ Mag Nail (set)
- 5/8" re-rod w/cap (set)
- ✂ Railroad Spike (found)

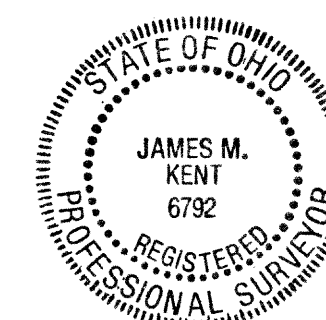

I hereby certify that this plat is representative of a
field survey, performed under my direct supervision.

James M. Kent

James M. Kent, Professional Surveyor No. 6792

BURR OAK ROAD

18

kent surveying, inc.

AutoCAD ~ Klosterman, Tom
drawing #4973
November 9, 2007

PUS-18-2

**SURVEYOR'S DESCRIPTION
TRACT ONE**

The northwest quarter of the northwest quarter of Section 18, Town-6-South, Range-6-East, Pusheta Township, Auglaize County, Ohio as evidenced by Official Record Volume 557, Page 954 and more particularly described as follows:

Commencing for reference at a monument box (found) at the center of Section 18 and the legal centerline of Burr Oak Road; thence, N 89° 02' 12" W along the south line of the northwest quarter of Section 18 and the aforesaid legal centerline, for a distance of 2614.90 feet to a mag nail (set) at the southwest corner of the northwest quarter of Section 18; thence, N 01° 02' 09" E along the aforesaid west line, for a distance of 1340.67 feet to a 5/8" re-rod w/cap (set) at the southwest corner of the northwest quarter of the northwest quarter of Section 18, and the **POINT OF BEGINNING** for the tract herein described;

thence, continuing N 01° 02' 09" E along the west line of the northwest quarter of the northwest quarter for a distance of 1340.66 feet to a stone (found) at the northwest corner of the northwest quarter of Section 18;

thence, S 89° 01' 32" E (passing through a 5/8" re-rod w/cap set on line for reference at a distance of 757.00 feet) for a total distance of 1291.60 feet to a 5/8" re-rod w/cap (set);

thence, S 00° 44' 22" W (passing through a 5/8" re-rod w/cap set for reference set at a distance of 670.27 feet) for a total distance of 1340.54 feet to a 5/8" re-rod w/cap (set);

thence, N 89° 01' 52" W along the south line of the northwest quarter of the northwest quarter for a distance of 1298.54 feet to the **POINT OF BEGINNING**, containing therein **39.857 acres**.

TRACT TWO

The southeast quarter of the northeast quarter of Section 13, Town-6-South, Range-5-East, Washington Township, Auglaize County, Ohio as evidenced by Official Record Volume 557, Page 954 and more particularly described as follows:

Commencing for reference at a monument box (found) at the center of Section 18 and the legal centerline of Burr Oak Road; thence, N 89° 02' 12" W along the south line of the northwest quarter of Section 18 and the aforesaid legal centerline, for a distance of 2614.90 feet to mag nail (set) on the east line of the southeast quarter of the northeast quarter of Section 13, said nail being the **POINT OF BEGINNING** for the tract herein described;

thence, S 01° 02' 09" W along the aforesaid east line for a distance of 35.28 feet to a railroad rail (found) at the southeast corner of the southeast quarter of the northeast quarter of Section 13;

thence, N 88° 34' 59" W along the south line of the aforesaid northeast quarter (and running south of the centerline of pavement of Burr Oak Road) for a distance of 1316.03 feet to a 5/8" re-rod w/cap (found) at the southwest corner of the southeast quarter of the northeast quarter of Section 13;

thence, N 01° 03' 16" E along the west line of the southeast quarter of the northeast quarter of Section 13 (passing the centerline of pavement of Burr Oak Road at approximately 11 feet) for a total distance of 1336.90 feet to a 5/8" re-rod w/cap (set) at the northwest corner of the southeast quarter of the northeast quarter of Section 13;

thence, S 88° 26' 12" E along the north line of the southeast quarter of the northeast quarter of Section 13, (passing through a railroad rail at a distance of 1315.29 feet) for a total distance of 1315.62 feet to the northeast corner of the southeast quarter of the northeast quarter of Section 13;

thence, S 01° 02' 09" W along the east line of the southeast quarter of the northeast quarter of Section 13 for a distance of 1298.27 feet to the **POINT OF BEGINNING**, containing therein **40.330 acres** and subject to public road right-of-way.

ALSO: a right-of-way in favor of the owner of the above tracts which allows ingress/egress to and from said tracts, and more particularly described as follows:

Being a 12 foot wide right-of-way, situate in the southwest quarter of the northwest quarter of Section 18, Town-6-South, Range-6-East, Pusheta Township, Auglaize County, Ohio as evidenced by Official Record Volume 188, Page 132 and more particularly described as follows:

Commencing for reference at a monument box (found) at the center of Section 18 and the legal centerline of Burr Oak Road; thence, N 89° 02' 12" W along the south line of the northwest quarter of Section 18 and the aforesaid legal centerline, for a distance of 2614.90 feet to a mag nail (set) at the southwest corner of the northwest quarter of Section 18; thence, N 01° 02' 09" E along the aforesaid west line, for a distance of 1281.68 feet to a 5/8" re-rod w/cap (set), said re-rod being the **POINT OF BEGINNING** for the right-of-way herein described;

thence, continuing N 01° 02' 09" E along the aforesaid west line for a distance of 58.99 feet to a 5/8" re-rod w/cap (set) at the northwest corner of the southwest quarter of the northwest quarter of Section 18;

thence, S 89° 01' 52" W along the north line of the southwest quarter of the northwest quarter for a distance of 12.00 feet to a 5/8" re-rod w/cap (set);

thence, S 01° 02' 09" W for a distance of 47.00 feet to a 5/8" re-rod w/cap (set);

thence, S 46° 03' 03" W for a distance of 16.97 feet to the **POINT OF BEGINNING**, containing therein 636 square feet. The above tracts are subject to all easements and right-of-way of record at the time of the recording of this instrument. Prepared by James M. Kent, Professional Surveyor No. 6792 with reference herein made to a plat of survey; Kent Surveying, Inc., drawing #4973 dated November 9, 2007. Basis of bearings is per Auglaize County GPS depicting the line between the center of Section 13 and the center of Section 18 as S 89° 11' 40" W.

bearing rotation~northeast quarter - 11/14/07

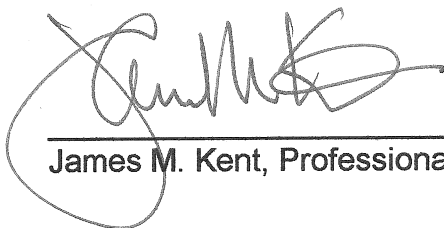

James M. Kent, Professional Surveyor No. 6792



PDS-18-2B