

Sandkuhl Survey 47.944 Acre Parcel

8.756 Acres in Easement to the Ohio Department of Transportation
and 0.627 Acre in all other Deep Cut Road Right-of-Way
Being a part of the Northeast Quarter of Section 23, Salem Township,
Town-4-South, Range-4-East, Auglaize County, State of Ohio

S. 89°-04'-13" E.

1,788.78'

ATTEST

Ted K. Schnell
Ted K. Schnell
Professional Engineer
Professional Surveyor

8-24-04

TRAVERSE TABLE

| | | | |
|---|-------------------|---|---------|
| A | N. 84°-37'-14" W. | - | 475.55' |
| B | N. 60°-22'-14" W. | - | 63.00' |
| C | N. 00°-00'-59" W. | - | 187.65' |
| D | N. 24°-35'-47" E. | - | 170.40' |

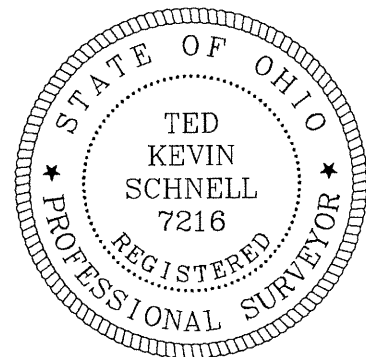
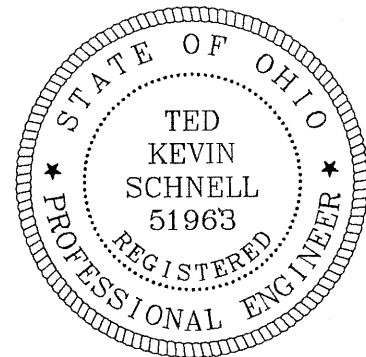

PREVIOUS DEED REFERENCES

DEED VOLUME: OR 70
PAGE 25, 27, 29

Northeast Corner,
Northeast Quarter,
Section 23, Salem Twp.

LEGEND

- Iron Pin (found)
- Iron Pin (set)
- ⊗ Railroad Spike (found)
- ▲ P.K. Nail (found)
- ▲ P.K. Nail/Shiner (set)
- Monument Box (found)
- ⊙ Conc Monument (found)
- Stone (found)

DETAIL #2 (not to scale)

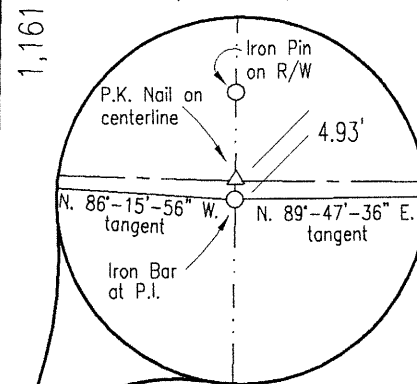

CURVE DATA DEEP CUT ROAD

| | CURVE #1 | CURVE #2 | CURVE #3 |
|-------------|-------------|-------------|-------------|
| Delta (Δ) | 18°-37'-20" | 20°-00'-00" | 03°-53'-40" |
| Radius (R) | 1,418.96' | 1,295.72' | 8,529.78' |
| Tangent (T) | 232.65' | 228.47' | 290.00' |

CURVE #1-A
Arc = 259.46'
Chord = 259.10'
Brng = N. 83°-35'-27" W.

CURVE #3
Arc = 289.95'
Chord = 289.94'
Brng = S. 89°-14'-08" E.

CURVE #1-B
Arc = 201.74'
Chord = 201.57'
Brng = N. 74°-16'-46" W.

CURVE #4
Arc = 116.14'
Chord = 115.18'
Brng = N. 11°-49'-15" E.

CURVE #2
Arc = 452.29'
Chord = 450.00'
Brng = N. 80°-12'-24" W.

ALLEN
AUGLAIZE

CURVE DATA S.R. 66

| | |
|-------------|-------------|
| Delta (Δ) | 20°-16'-15" |
| Radius (R) | 5,729.58' |
| Tangent (T) | 1,024.25' |

Former Route 66 (CURVE #4)

| | |
|-------------|-------------|
| Delta (Δ) | 25°-33'-00" |
| Radius (R) | 260.44' |
| Tangent (T) | 59.05' |

SCALE

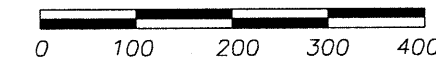

SANDKUHL SURVEY

H & S Civil Engineers and Land Surveyors
913 Fieldstone Court Wapakoneta, Ohio 45895
Voice: (419) 738-4758 Fax: (419) 739-7631
E-Mail: hscivil@bright.net

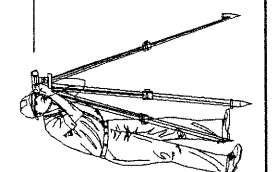

| No. | Revision/Issue | Date |
|-----|----------------|------|
|-----|----------------|------|

Project Name
47.944 ACRE
PARCEL
SECTION 23
SALEM TOWNSHIP

Project Location
BEING A PART
OF THE NORTHEAST
QUARTER OF SECTION 23,
SALEM TOWNSHIP

| | |
|---------------------|------------|
| Project SANDKUHL | Sheet 1 |
| Date 07/14/04 | |
| Scale SHOWN | |

SURVEYOR'S DESCRIPTION OF LAND

The following described parcel of land is a part of the Northeast Quarter of Section 23, Salem Township, Town-4-South, Range-4-East, Auglaize County, Ohio, and is more particularly described as follows:
Commencing at an Iron Bar (found) situated at the P.I. point of the centerline of Deep Cut Road, County Road #228, and also being on the East Line of the Northeast Quarter of said Section 23, Salem Township, and the PLACE OF BEGINNING;
Thence with a bearing of N. 86°-15'-56" W. along the tangent to the centerline of a curve to the Right of Deep Cut Road for a distance of 290.00 feet to a P.K. Nail/Shiner (found), said curve to the Right having the following Curve Data: (Δ)=3°-53'-40", (R)=8,529.78', (T)=290.00'
Thence continuing with a bearing of N. 86°-15'-56" W. along the centerline of Deep Cut Road for a distance of 1,036.84 feet to a Mag Nail/Shiner (set), said Mag Nail/Shiner being situated at Station 22+15.60 of a centerline survey of Deep Cut Road by the Ohio Department of Transportation for the relocation of State Route 66, as referenced by a set of plans issued September 5, 1974, project No. AUG-66-20.57 and ALL-66-0.00-1.61;
Thence with a bearing of N. 84°-37'-14" W. along the former centerline of Deep Cut Road for a distance of 475.55 feet to a point, said point being situated at Station 17+40 of the aforementioned centerline survey of Deep Cut Road by the Ohio Department of Transportation;
Thence with a bearing of N. 60°-22'-14" W. along the former centerline of Deep Cut Road for a distance of 63.00 feet to a point, said point being situated at Sta 16+77 of the aforementioned centerline survey of Deep Cut Road, and Sta 0+00 of a former connecting Road;
Thence with a bearing of N. 00°-00'-59" W. along the centerline of a former connecting Road for a distance of 187.65 feet to a point, said point being a former intersection situated at Sta 1+87.65 of said connecting Road with Sta 1284+63 of the former Route 66, both roads being a part of the aforementioned centerline survey performed by the Ohio Department of Transportation;
Thence with a bearing of N. 00°-57'-14" W along the former centerline of Route 66 for a distance of 577.95 feet to a point, said point being the P.C. of a curve to the Right situated at Station 1290+40.95 of the aforementioned centerline survey of the former Route 66 by the Ohio Department of Transportation;
Thence continuing along the former centerline of Route 66 with said curve to the Right for an Arc Length of 116.14 feet to a point, said point being situated at Station 1291+57.09 of the aforementioned centerline survey of the former Route 66 by the Ohio Department of Transportation, Curve Data: (Δ)=25°-33', (R)=260.44', (T)=59.05', and P.I. Station 1291+00;
Thence with a bearing of N. 24°-35'-47" E. along the former centerline of Route 66 for a distance of 170.40 feet to a point, said point being situated on the Allen - Auglaize County Line, and the North Line of the Northeast Quarter of said Section 23, Salem Township;
Thence with a bearing of S. 89°-04'-13" E. along the Allen - Auglaize County Line and the North Line of the Northeast Quarter of Section 23, Salem Township, for a distance of 1,788.78 feet to an Iron Pin (found) at the Northeast Corner of the Northeast Quarter of said Section 23, Salem Township;
Thence with a bearing of S. 01°-02'-19" W. along the East Line of the Northeast Quarter of said Section 23, Salem Township, for a distance of 1,166.52 feet to an Iron Bar (found), and passing thru an Iron Pin (found) for reference on the Northerly right-of-way line of Deep Cut Road Road at a distance of 1131.59 feet, said Iron Bar (found) being the original PLACE OF BEGINNING.

Containing in all, 47.944 Acres of land. The above described parcel contains approximately 8.756 Acres of land subject to an easement benefitting the Ohio Department of Transportation, as recorded in Volume 198, Page 297, Auglaize County Recorder's Office, and an additional 0.627 Acres subject to all other road right-of-ways of record. This parcel is also subject to all other easements, reservations, or restrictions, if any, upon said premises.

BASIS OF BEARINGS

The basis of bearings were determined from, and consistent with the Auglaize County Engineer's Global Positioning Survey

NOTES

- Most ODOT R/W Monuments as called for in the State Route 66 R/W Plans have been obliterated due to farming activities, however, in all cases, there are some remnants of the concrete monuments still present below the existing ground surface.
- The previous centerline of the former Route 66, West of the current State Route 66 and East of the Miami and Erie Canal has been established, for the purpose of this survey, by using the State Route 66 centerline survey plans by ODOT as per project AUG-66-20.57, and ALL-66-0.00-1.61, sheet 231 of 237, and sheet 13 of 19. Said plans are stamped September 5, 1974.

SURVEY REFERENCES

Survey by Auglaize County Engineer
Deep Cut Road, reverse curve and re-alignment centerline survey
Filed in Survey Book "D", Page 165
Revised Drawing October 20, 1978

Survey by Auglaize County Engineer
Survey of the Southwest Quarter of Section 24, Salem Twp.
Survey Dated February 2, 1985

Klaus Survey
Survey of a 1.73 Acre Parcel
Filed in Survey Book "I", Page 673
Surveyed By John W. Jauert
June 5, 1993

Schwartz Survey
Survey of a 40.50 Acre Parcel and a 40.44 Acre Parcel
Filed in Survey Book "G", Page 289
Surveyed by Douglas P. Reinhart
June 20, 1984

Lyle Sandkuhl Survey
Survey of 3.216 Acre Parcel Split
Filed in Survey Book "I", Page 524
Surveyed by Ted K. Schnell
July 1, 1992

Sheldon Engineering & Surveying
Survey of a 20.324 Acre Parcel
Allen County, Ohio (ref #SR45-019)
Surveyed by James Sheldon
March 15, 2004

SAL-23-2