

# John Hirschfeld Survey

Part of Section 2, Town-6-South, Range-4-East,  
St. Marys Township, Auglaize County, Ohio

John R. Hirschfeld  
OR Volume 567, Page 2349 & 2354

**6.615 Acres**  
(0.851 acres right-of-way)

New Community Church  
OR Volume 448, Page 2294

St. Marys Missionary Baptist Church  
OR Volume 442, Page 2494

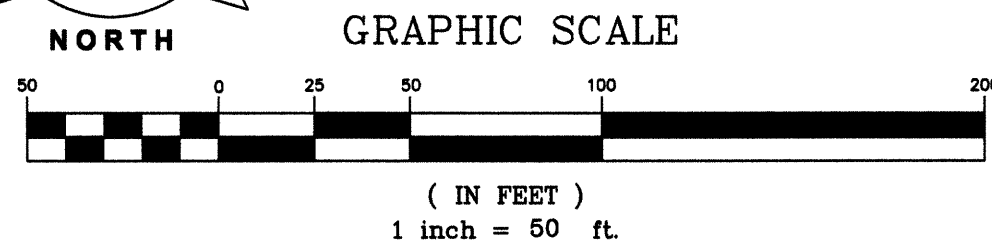
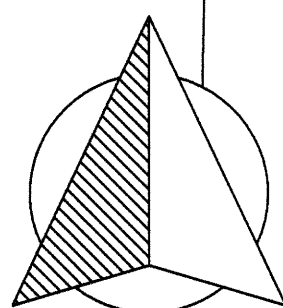

## LEGEND

- Stone (found)
- 5/8" Re-Rod w/cap (set)
- ⌂ Mag-Nail (set)
- △ Railroad Spike (found)
- 5/8" Re-Rod w/cap (found)
- ⌘ P-K Nail (found)

## SURVEY REFERENCES

Boundary Survey by Michael L. Weadock, PS  
6199 (City Engineer's Record H-1012  
STM-2-5

New Community Church Survey by Core  
Consulting, Brad J. Core, PS 8004 dated  
December 12, 2001  
STM-2-18

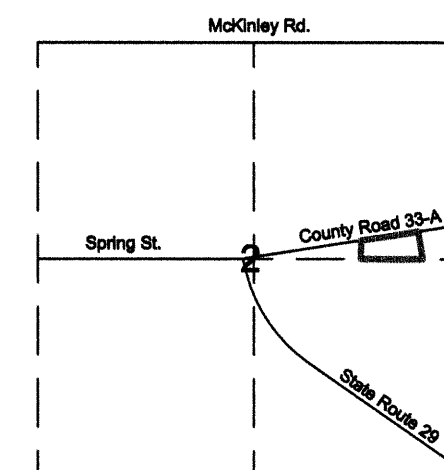

VICINITY MAP ~ SECTION 2

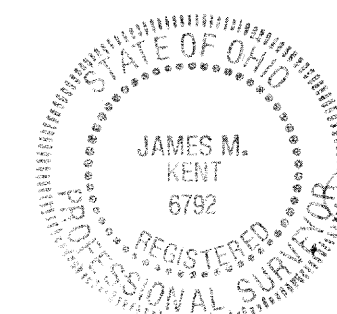

I hereby certify that this survey is representative  
of a field survey conducted under my direct supervision.

*James M. Kent*  
James M. Kent, Professional Surveyor No. 6792

**kent surveying, inc.**

AutoCAD ~ Hirschfeld, John  
Drawing #5235  
March 3, 2011

STM-2-25

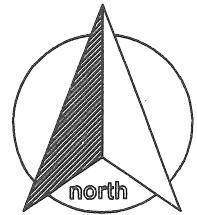

scale:

### SURVEYOR'S DESCRIPTION

Being a part of Section 2, Town-6-South, Range-4-East, St. Marys Township, Auglaize County, Ohio as evidenced by Official Record Volume 567, Page 2349 and 2354 and more particularly described as follows:

Commencing at a stone (found) at the southeast corner of the northeast quarter of Section 2; thence, N 89° 01' 17" W along the south line of the northeast quarter of Section 2 for a distance of 519.14 feet to a 5/8" re-rod w/cap (set), said re-rod being the **POINT OF BEGINNING** for the tract herein described;

Thence, continuing along the aforesaid south line N 89° 01' 17" W for a distance of 802.86 feet to a 5/8" re-rod w/cap (found);

Thence, N 01° 01' 53" E (passing through a 5/8" re-rod w/cap found on the south line of County Road 33-A at a distance of 258.38 feet) for a total distance of 308.86 feet to a railroad spike (found) on the legal centerline of County Road 33-A;

Thence, N 81° 01' 53" E along the aforesaid legal centerline for a distance of 741.42 feet to a mag-nail (set);

Thence, S 08° 25' 02" E (passing through a 5/8" re-rod w/cap set on the south right-of-way line of County Road 33-A at a distance of 49.71 feet) for a total distance of 442.87 feet to the **POINT OF BEGINNING**, containing therein **6.615 acres**, of which 0.851 acres is road right-of-way. Subject to all easements and right-of-way of record at the time of the recording of this instrument. Basis of bearings is per Annexation Plat STM-2-5. Prepared by James M. Kent, Professional Surveyor No. 6792 with reference herein made to a plat of survey; Kent Surveying, Inc., drawing #5235 dated March 3, 2011.

  
James M. Kent, PS 6792

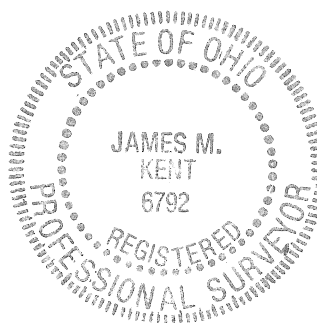

CLIENT JOHN HIRSCHFELD DATE 3-7-2011  
COUNTY AUGLAIZE TOWNSHIP ST. MARYS  
SECTION 2 T-6-S; R-4-E DRAWN BY JMK  
SHEET 1 OF 1 DWG. # 5235

 **kent surveying, inc.**  
P.O. Box 96 - 1750 Bellefontaine Street  
Wapakoneta, OH 45895  
419-738-5677 fax 419-738-7894

STM-2-25a