

Poeppelman Survey

Part of the N.E. 1/4 of Section 33 and
part of the N.W. 1/4 of Section 34, T-6-S, R4-E,
St. Marys Township, Auglaize County, Ohio

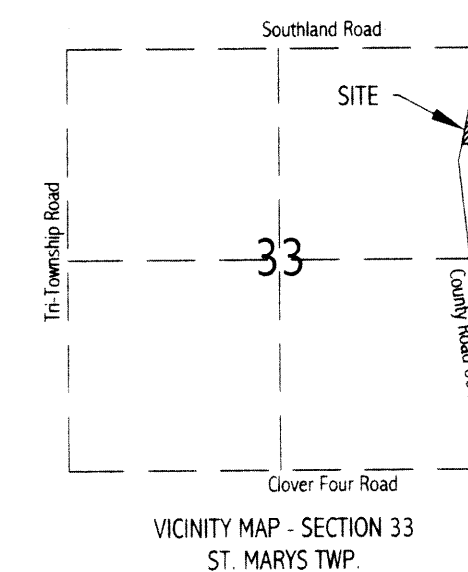

Legend

- Monument Box (found)
- "Mag" Nail (found)
- Iron pin (found)
- ⊙ 5/8" re-rod w/cap (set)
- ☆ Cotton Gin Spindle (set)

I hereby certify that this plat represents an accurate
field survey, performed under my direct supervision
on the date shown hereon.

JAMES M. KENT, PS 6792

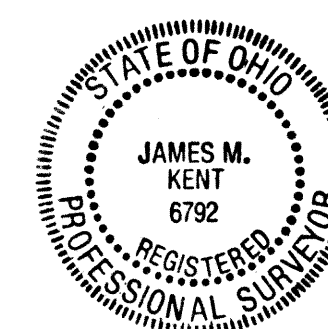

kent surveying

acad - poeppelman (zeig) dwg #3908
April 18, 2002

STM-33-4

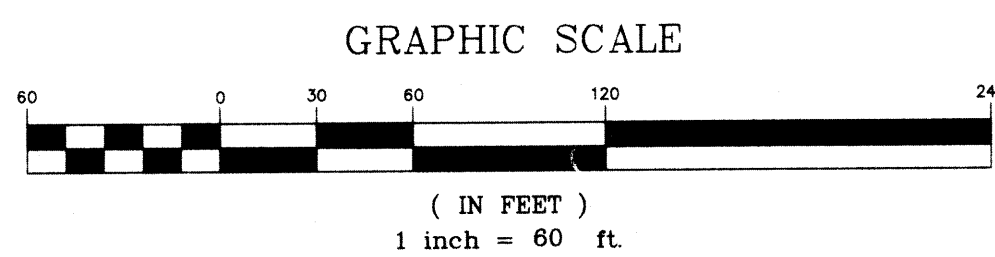

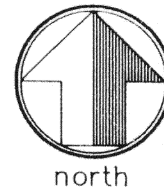

LEGAL DESCRIPTION

scale:

Being a part of the northeast quarter of Section 33 and a part of the northwest quarter of Section 34, Town-6-South, Range-4-East, St. Marys Township, Auglaize County, Ohio as evidenced by Official Record Volume 307, Page 850, and more particularly described as follows:

Commencing for reference at a monument box at the northeast corner of Section 33 and the centerline of Southland Road; thence, N 89 degrees 15' 40" W along the north line of the northeast quarter of Section 33 and the centerline of Southland Road, for a distance of 450.12 feet to a "mag" nail (found) at the intersection of the centerline of Southland Road and the Piqua-St. Marys Road (CR 66-A); thence, S 06 degrees 22' 37" W along the centerline of the Piqua-St. Marys Road, for a distance of 1303.64 feet to a cotton gin spindle (found), said spindle being the **POINT OF BEGINNING** for the tract herein described;

thence, S 89 degrees 18' 25" E (passing through a 5/8" re-rod w/cap found on the easterly right-of-way line of CR 66-A at a distance of 55.27 feet) for a total distance of 589.97 feet to a 5/8" re-rod w/cap (found);

thence, N 06 degrees 22' 37" E for a distance of 298.80 feet to a 5/8" re-rod w/cap (found);

thence, S 89 degrees 18' 25" E for a distance of 217.51 feet to an iron pin (found);

thence, S 03 degrees 17' 28" W for a distance of 596.60 feet to a 5/8" re-rod w/cap (set);

thence, N 83 degrees 37' 26" W (passing through an iron pin found on the easterly right-of-way line of CR 66-A at a distance of 780.61 feet) for a total distance of 835.61 feet to a "mag" nail (found) on the centerline of CR 66-A;

thence, northeasterly along the centerline of CR 66-A with a non-tangent curve which is concave to the east, having a radius of 954.93 feet, a central angle of 00 degrees 19' 16", a chord which bears N 06 degrees 13' 00" E and measures 5.35 feet, for a total arc length of 5.35 feet to a "mag" nail (found);

thence, continuing along the centerline of CR 66-A, N 06 degrees 22' 37" E for a distance of 216.97 feet to the **POINT OF BEGINNING**, containing therein 6.444 acres, of which 3.326 acres is within Section 33 and 3.118 acres is within Section 34 and 0.277 acres is road right-of-way. Subject to all easements and right-of-way of record at the time of the recording of this instrument. Prepared by James M. Kent, PS 6792 OH, with reference hereby made to a plat of survey; Kent Surveying drawing #3908.1 dated May 24, 2002. Basis of bearings is per Auglaize County GPS depicting the north line of the northeast quarter of Section 33 as N 89 degrees 15' 40" W.

James M. Kent, P.S. 6792 OH

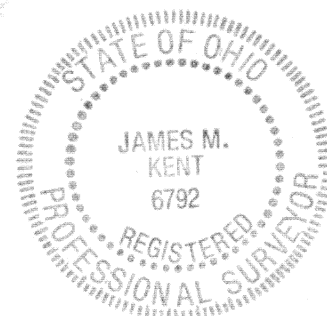

CLIENT POEPELMAN DATE 5-24-02
COUNTY AUGLAIZE TOWNSHIP ST. MARYS
SECTION 33-34 T-6-S; R-4-E
DRAWN BY JMK DRAWING NO. 3908.1
SHEET 1 OF 1

kent
surveying
p.o. box 96 • 419/738-5677
wapakoneta, ohio

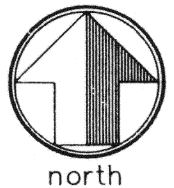

LEGAL DESCRIPTION

scale:

Being a part of the northeast quarter of Section 33 and a part of the northwest quarter of Section 34, Town-6-South, Range-4-East, St. Marys Township, Auglaize County, Ohio as evidenced by Official Record Volume 307, Page 850, and more particularly described as follows:

Commencing for reference at a monument box at the northeast corner of Section 33 and the centerline of Southland Road; thence, N 89 degrees 15' 40" W along the north line of the northeast quarter of Section 33 and the centerline of Southland Road, for a distance of 450.12 feet to a "mag" nail (found) at the intersection of the centerline of Southland Road and the Piqua-St. Marys Road (CR 66-A); thence, S 06 degrees 22' 37" W along the centerline of the Piqua-St. Marys Road, for a distance of 1004.84 feet to a "mag" nail (found), said nail being the **POINT OF BEGINNING** for the tract herein described;

thence, S 89 degrees 18' 25" E (passing through a 5/8" re-rod w/cap found on the easterly right-of-way line of CR 66-A at a distance of 55.27 feet) for a total distance of 589.97 feet to a 5/8" re-rod w/cap (set);

thence, S 06 degrees 22' 37" W for a distance of 298.80 feet to a 5/8" re-rod w/cap (set);

thence, N 89 degrees 18' 25" W (passing through a 5/8" re-rod w/cap set on the easterly right-of-way line of CR 66-A at a distance of 534.70 feet) for a total distance of 589.97 feet to a cotton gin spindle (set) on the centerline of CR 66-A;

thence, N 06 degrees 22' 37" E along the aforesaid centerline, for a distance of 298.80 feet to the **POINT OF BEGINNING**, containing therein 4.027 acres, of which 3.844 acres is within Section 33 and 0.183 acres is within Section 34 and 0.377 acres is road right-of-way. Subject to all easements and right-of-way of record at the time of the recording of this instrument. Prepared by James M. Kent, PS 6792 OH, with reference hereby made to a plat of survey; Kent Surveying drawing #3908 dated April 18, 2002. Basis of bearings is per Auglaize County GPS depicting the north line of the northeast quarter of Section 33 as N 89 degrees 15' 40" W.

James M. Kent, P.S. 6792 OH

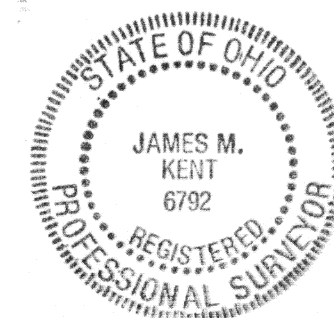

CLIENT POEPELMAN DATE 4-18-02
COUNTY AUGLAIZE TOWNSHIP ST. MARYS
SECTION 33-34 T-6-S; R-4-E
DRAWN BY JMK DRAWING NO. 3908
SHEET 1 OF 1

kent
surveying
p.o. box 96 • 419/738-5677
wapakoneta, ohio