

LEGEND

- ⊙ = 5/8 INCH IRON BAR SET IN BASE OF ROTTED POST.
- △ = R.R. SPIKE FOUND.
- = IRON BAR IN MON. BOX FOUND.
- = FORMER LOCATION OF POST (DETERMINED BY STEINKE SURVEY, 2/28/77).
- = 5/8 INCH IRON BAR FOUND.
- ⊕ = MAG SPIKE SET.
- = 5/8 INCH IRON BAR SET.

LOCATION SKETCH

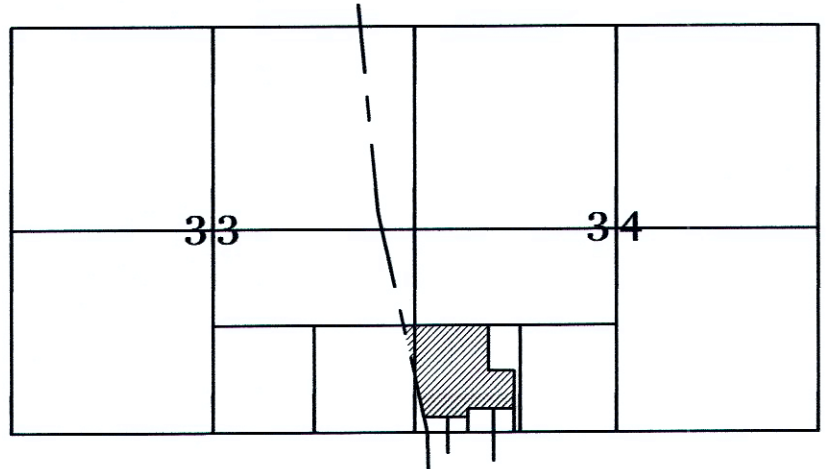

SURVEY REFERENCES:

- 1) WIEHE SURVEY BY T. STEINKE, P.S. 6177, 2-28-77.
- 2) SURVEY BY J. JAUERT, P.S. 6920
- 3) SURVEYS BY G. GEESLIN, P.S. 5372
- 4) CROWN CONTROLS SURVEY BY G. FERNANDEZ, P.S. 4079, 9/88.

BERTKE SURVEY

PART OF THE S.E. 1/4 - S.E. 1/4 - SEC. 33 & PART OF THE S.W. 1/4 - S.W. 1/4 - SEC. 34, TOWN 6 SOUTH, RANGE 4 EAST, (ST. MARYS TOWNSHIP), AUGLAIZE COUNTY, OHIO.

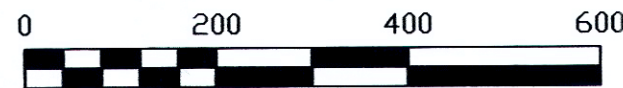

SCALE 1" = 200'

GEESLIN SURVEYING

525 S. SECOND ST.
COLDWATER, OHIO 45828
Phone: (419) 678 - 7233
Phone: (419) 678 - 7232 (cell)
Email: jwgeeslinsurveyor@gmail.com

THIS PLAT REPRESENTS AN ACTUAL FIELD SURVEY PERFORMED UNDER MY SUPERVISION DATED JUNE 10, 2024.

James W. Geeslin

ATTEST: JAMES W. GEESLIN
PROFESSIONAL SURVEYOR 7764

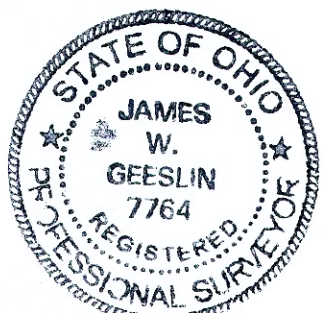

NOTE: THE BEARINGS CONTAINED HEREIN ARE BASED ON GPS OBSERVATIONS USING O.D.O.T. CORS NETWORK STATIONS, CONVERTED TO THE OHIO STATE PLANE NORTH ZONE, HORIZONTAL DATUM NAD83 (2011).

June 10, 2024

BERTKE SURVEY DESCRIPTION

Being all of Parcel Number K2933100200 and Parcel Number K2934100200 (Official Record 623, page 366) in St. Marys Township, Auglaize County, Ohio, in the southeast quarter of the southeast quarter of Section 33 and in the southwest quarter of the southwest quarter of Section 34, Township 6 South, Range 4 East. Being more particularly described as follows:

Commencing for reference at an iron bar in a monument box found at the southwest corner of said Section 34 -

Thence, South 89°08'45" East, along the south line of the southwest quarter of said Section 34 and the centerline of Clover Four Road, a distance of 68.78 feet to an iron bar in a monument box found -

Thence, North 11°54'13" West, along the centerline of County Road 66-A, a distance of 243.40 feet to a railroad spike found. Said point being the place of beginning for the parcel of land to be conveyed by this instrument -

Thence, North 11°54'07" West, continuing along the centerline of County Road 66-A, a distance of 650.96 feet to an iron bar in a monument box found -

Thence, North 08°07'40" West, continuing along the centerline of County Road 66-A, a distance of 461.10 feet to a mag spike set -

Thence, South 89°03'32" East, along the south line of the north half of the southeast quarter of said Section 33, a distance of 215.57 feet to a 5/8 inch iron bar set -

Thence, South 89°06'12" East, along the north line of the south half of the southwest quarter of said Section 34, a distance of 946.83 feet to a 5/8 inch iron bar set -

Thence, South 02°40'21" West, a distance of 555.24 feet to a 5/8 inch iron bar found -

Thence, South 00°49'31" West, a distance of 453.71 feet to a 5/8 inch iron bar found -

Thence, North 89°08'45" West, a distance of 473.15 feet to a 5/8 inch iron bar found -

Thence, South 00°51'15" West, a distance of 80.64 feet to a 5/8 inch iron bar found -

Thence, North 89°08'45" West, a distance of 456.13 feet to the place of beginning.

Containing 25.404 acres of land more or less of which 2.777 acres lie in Section 33.

Subject to all easements and right-of-way of record.

The bearings contained herein are based on GPS observations using O.D.O.T. CORS Network stations, converted to the Ohio State Plane North Zone, Horizontal Datum NAD83 (2011).

This legal description and accompanying plat represent an actual boundary survey completed under the direct supervision of James W. Geeslin, Professional Surveyor 7764 on June 10, 2024.

Surveyed by James W. Geeslin
James W. Geeslin
P.S. 7764

GEESLIN SURVEYING

525 S. SECOND ST.
COLDWATER, OHIO 45828

Phone : (419) 678 - 7233
Phone : (419) 678 - 7232 (cell)
Email : jwgeeslinsurveyor@gmail.com



PERMANENT PARCEL No.				
Part of :	Sec.	T.	R.	Township
Grantor :	Area Retained		Acres	
Grantee :	Area Retained		Acres	
Deed Reference :				
APPROVALS :				
AGENCY :	Board of Health	Township Zoning Officer	Mercer County Engineer	
DATE :				