

SURVEYORS INC.
1867 WENDELL AVE.
LIMA, OHIO 45805
224-2752

Client Lonnie Jenkins
County Auglaize Twp. Union Sec. 12
Drawn by J. Rex Scale 1"=80' Drwg#
Checked by R. Tschanz Date 3/30/89
Sheet of

LEGAL DESCRIPTION

Parcel #1

Being a parcel of land in the Southwest Quarter of
Section 12, T-5-S, R-7-E, Union Township, Auglaize County,
Ohio and more particularly described as follows:

Commencing at a monument box at the northwest corner
of said Quarter Section, said point being on the centerline
of Township Road # 241 (Graham Road); thence, Due South
along the west line of said Quarter Section and said centerline,
1181.13 feet to a P-K nail set and the PLACE OF BEGINNING;
thence, N 89°58'15" E, 310.79 feet to a $\frac{1}{2}$ " rerod set;
thence, Due South, 139.61 feet to a $\frac{1}{2}$ " rerod set; thence,
S 89°52'10" W, 310.79 feet to a P-K nail set, said point
being on the west line of said Quarter Section and said
centerline; thence, Due North along said west line and said
centerline, 140.16 feet to the PLACE OF BEGINNING.

Containing 1.00 acres more or less subject to all
highways and other legal easements of record.

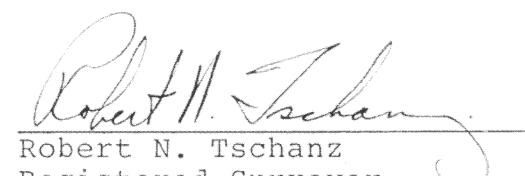
Robert N. Tschanz
Registered Surveyor
Ohio # 4738

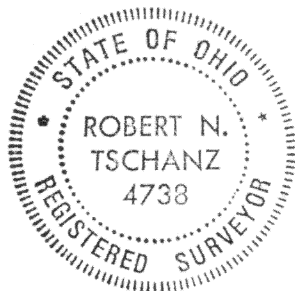

SURVEYORS INC.
1867 WENDELL AVE.
LIMA, OHIO 45805
224-2752

Client Lonnie Jenkins
County Auglaize Twp. Union Sec. 12
Drawn by J. Rex Scale 1"=80' Drwg#
Checked by R. Tschanz Date 3/10/89
Sheet of

LEGAL DESCRIPTION

Parcel #2

Being a parcel of land in the Southwest Quarter of
Section 12, T-5-S, R-7-E, Union Township, Auglaize County,
Ohio and more particularly described as follows:

Commencing at a monument box at the northwest corner
of said Quarter Section, said point being on the centerline
of Township Road # 241 (Graham Road); thence, Due South
along the west line of said Quarter Section and said centerline,
1040.97 feet to a P-K nail set and the PLACE OF BEGINNING;
thence, N 89°58'15" E, 310.79 feet to a $\frac{1}{2}$ " rerod set; thence,
Due South, 140.16 feet to a $\frac{1}{2}$ " rerod set; thence,
S 89°58'15" W, 310.79 feet to a P-K nail set, said point being
on the west line of said Quarter Section and said centerline;
thence, Due North along said west line and said centerline,
140.16 feet to the PLACE OF BEGINNING.

Containing 1.00 acres more or less subject to all
highways and other legal easements of record.

Robert N. Tschanz
Registered Surveyor
Ohio # 4738

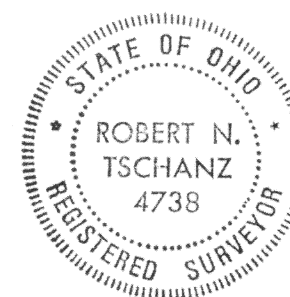

SURVEYORS INC.
1867 WENDELL AVE.
LIMA, OHIO 45805
224-2752

Client Lonnie Jenkins
County Auglaize Twp. Union Sec. 12
Drawn by J. Rex Scale 1"=80' Drwg#
Checked by R. Tschanz Date 3/30/89
Sheet of

LEGAL DESCRIPTION

Parcel # 3

Being a parcel of land in the Southwest Quarter of Section 12, T-5-S, R-7-E, Union Township, Auglaize County, Ohio and more particularly described as follows:

Commencing at a monument box at the northwest corner of said Quarter Section, said point being on the centerline of Township Road # 241 (Graham Road); thence, Due South along the west line of said Quarter Section and said centerline, 990.97 feet to an existing railroad spike and the PLACE OF BEGINNING; thence, N 89°58'15" E, 1324.79 feet to a $\frac{1}{2}$ " rerod set; thence, N 00°03'34" W, 994.84 feet to a $\frac{1}{2}$ " rerod set, said point being on the north line of said Quarter Section; thence, N 89°48'12" E along said north line, 284.00 feet to a $\frac{1}{2}$ " rerod set; thence, S 00°03'34" E, 936.95 feet to a $\frac{1}{2}$ " rerod set; thence, N 89°15'44" W, 274.00 feet to a point; thence, S 00°03'34" E, 72.39 feet to a point; thence, S 89°58'15" W, 1334.79 feet to a point, said point being on the west line of said Quarter Section and said centerline; thence, Due North along said west line and said centerline, 10.00 feet to the PLACE OF BEGINNING.

Containing 6.42 acres more or less subject to all highways and other legal easements of record.

Robert N. Tschanz
Registered Surveyor
Ohio # 4738

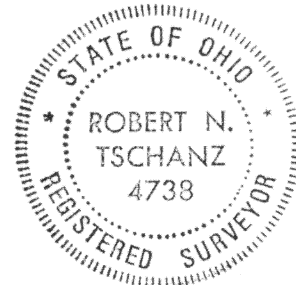

SURVEYORS INC.
1867 WENDELL AVE.
LIMA, OHIO 45805
224-2752

Client Lonnie Jenkins
County Auglaize Twp. Union Sec. 12
Drawn by J. Rex Scale 1"=80' Drwg#
Checked by R. Tschanz Date 3/30/89
Sheet of

LEGAL DESCRIPTION

Parcel #4

Being a parcel of land in the Southwest Quarter of Section 12, T-5-S, R-7-E, Union Township, Auglaize County, Ohio and more particularly described as follows:

Commencing at a monument box at the northwest corner of said Quarter Section, said point being on the centerline of Township Road # 241 (Graham Road); thence, Due South along the west line of said Quarter Section and said centerline, 1000.97 feet to a point and the PLACE OF BEGINNING; thence, N 89°58'15" E, 1334.79 feet to a point; thence, N 00°03'34" W, 72.39 feet to a point; thence, S 89°15'44" E, 274.00 feet to a $\frac{1}{2}$ " rerod set; thence, N 00°03'34" W, 936.95 feet to a $\frac{1}{2}$ " rerod set, said point being on the north line of said Quarter Section; thence, N 89°48'12" E along said north line, 284.00 feet to a $\frac{1}{2}$ " rerod set; thence, S 00°03'34" E, 951.59 feet to a point; thence, N 89°15'44" W, 548.00 feet to a point; thence, S 00°03'34" E, 72.26 feet to a point; thence, S 89°58'15" W, 1344.79 feet to a point, said point being on the west line of said Quarter Section and said centerline; thence, Due North along said west line and said centerline, 10.00 feet to the PLACE OF BEGINNING.

Containing 6.57 acres more or less subject to all highways and other legal easements of record.

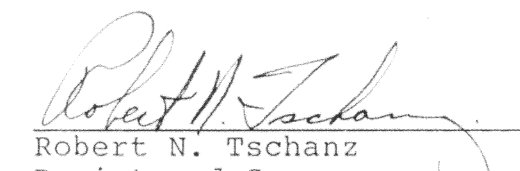
Robert N. Tschanz
Registered Surveyor
Ohio # 4738

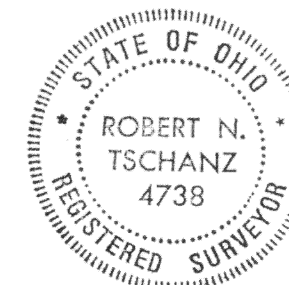

SURVEYORS INC.
1867 WENDELL AVE.
LIMA, OHIO 45805
224-2752

Client Lonnie Jenkins
County Auglaize Twp. Union Sec. 12
Drawn by J. Rex Scale 1"=80' Drwg#
Checked by R. Tschanz Date 3/30/89
Sheet of

LEGAL DESCRIPTION

Parcel # 5

Being a parcel of land in the Southwest Quarter of
Section 12, T-5-S, R-7-E, Union Township, Auglaize County,
Ohio and more particularly described as follows:

Commencing at a monument box at the northwest corner
of said Quarter Section, said point being on the centerline
of Township Road #241 (Graham Road); thence, Due South
along the west line of said Quarter Section and said centerline,
1010.97 feet to a point and the PLACE OF BEGINNING; thence,
N 89°58'15" E, 1344.79 feet to a point; thence,
N 00°03'34" W, 72.26 feet to a point; thence, S 89°15'44" E,
548.00 feet to a point; thence, N 00°03'34" W, 951.59 feet
to a ½" rerod set, said point being on the north line of said
Quarter Section; thence, N 89°48'12" along said north line,
755.78 feet to a ½" rerod set, said point being the northeast
corner of said Quarter Section; thence, S 00°02'49" W along
the east line of said Quarter Section, 973.90 feet to a point;
thence, N 89°15'44" W, 1292.11 feet to a point; thence,
S 00°03'34" E, 72.13 feet to a point; thence, S 89°58'15" W,
1354.79 feet to a point, said point being on the west line
of said Quarter Section and said centerline; thence, Due
North along said west line and said centerline, 10.00 feet
to the PLACE OF BEGINNING.

Containing 17.22 acres more or less subject to all
highways and other easements of record.

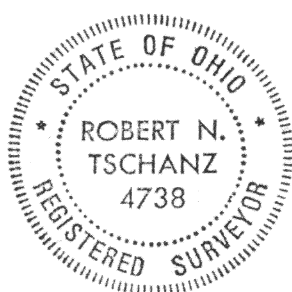

Robert N. Tschanz
Robert N. Tschanz
Registered Surveyor
Ohio # 4738

SURVEYORS INC.
1867 WENDELL AVE.
LIMA, OHIO 45805
224-2752

Client Lonnie Jenkins
County Auglaize Twp. Union Sec. 12
Drawn by J. Rex Scale 1"=80' Drwg#
Checked by R. Tschanz Date 3/30/89
Sheet of

LEGAL DESCRIPTION

Parcel #6

Being a parcel of land in the Southwest Quarter of
Section 12, T-5-S, R-7-E, Union Township, Auglaize County,
Ohio and more particularly described as follows:

Commencing at a monument box at the northwest corner
of said Quarter Section, said point being on the centerline
of Township Road # 241 (Graham Road); thence, Due South
along the west line of said Quarter Section and said centerline,
1020.97 feet to a point and the PLACE OF BEGINNING; thence,
N 89°58'15" E, 1354.79 feet to a point; thence,
N 00°03'34" W, 72.13 feet to a point; thence,
S 89°15'44" E, 1292.11 feet to a point, said point being on
the east line of said Quarter Section; thence,
S 00°02'49" W along said east line, 350.45 feet to a point;
thence, S 89°52'10" W, 1107.67 feet to a point; thence,
N 00°06'15" E, 357.25 feet to a point; thence,
N 89°15'44" W, 174.69 feet to a ½" rerod set; thence,
S 00°03'34" E, 72.00 feet to a ½" rerod set; thence,
S 89°58'15" W, 1364.79 feet to a point, said point being on
the west line of said Quarter Section and said centerline;
thence, Due North along said west line and said centerline,
10.00 feet to the PLACE OF BEGINNING.

Containing 9.49 acres more or less subject to all
highways and other legal easements of record.

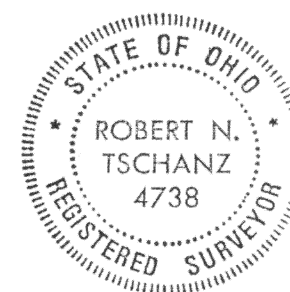

Robert N. Tschanz
Robert N. Tschanz
Registered Surveyor
Ohio # 4738

SURVEYORS INC.
1867 WENDELL AVE.
LIMA, OHIO 45805
224-2752

Client Lonnie Jenkins
County Auglaize Twp. Union Sec. 12
Drawn by J. Rex Scale 1"=80' Drwg#
Checked by R. Tschanz Date 3/30/89
Sheet of

LEGAL DESCRIPTION
(Driveway Easement)

Being a driveway easement in the Southwest Quarter of Section 12, T-5-S, R-7-E, Union Township, Auglaize County, Ohio and more particularly described as follows:

Commencing at a monument box at the northwest corner of said Quarter Section, said point being on the centerline of Township Road # 241 (Graham Road); thence, Due South along the west line of said Quarter Section and said centerline, 990.97 feet to an existing railroad spike and the PLACE OF BEGINNING; thence, N 89°58'15" E, 1324.79 feet to a ½" rerod set; thence, N 00°03'34" W, 62.52 feet to a ½" rerod set; thence, S 89°15'44" E, 568.00 feet to a ½" rerod set; thence, S 00°03'34" E, 20.00 feet to a point; thence, N 89°15'44" W, 354.24 feet to a ½" rerod set; thence, S 00°06'15" W, 10.00 feet to a point; thence, N 89°15'44" W, 174.69 feet to a ½" rerod set; thence, S 00°03'34" E, 72.00 feet to a ½" rerod set; thence, S 89°58'15" W, 1054.00 feet to a point; thence, Due South, 10.00 feet to a ½" rerod set; thence, S 89°58'15" W, 310.79 feet to a P-K nail set, said point being on the west line of said Quarter Section and said centerline; thence, Due North along said west line and said centerline, 50.00 feet to the PLACE OF BEGINNING.

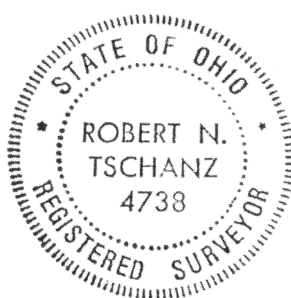

Robert N. Tschanz
Robert N. Tschanz
Registered Surveyor
Ohio # 4738

SURVEYORS INC.
1867 WENDELL AVE.
LIMA, OHIO 45805
224-2752

Client Lonnie Jenkins
County Auglaize Twp. Union Sec. 12
Drawn by J. Rex Scale 1"=80' Drwg#
Checked by R. Tschanz Date 3/30/89
Sheet of

LEGAL DESCRIPTION
Parcel #7

Being a parcel of land in the Southwest Quarter of Section 12, T-5-S, R-7-E, Union Township, Auglaize County, Ohio and more particularly described as follows:

Commencing at a monument box at the northwest corner of said Quarter Section, said point being on the centerline of Township Road # 241 (Graham Road); thence, Due South along the west line of said Quarter Section and said centerline, 1030.79 feet to a point and the PLACE OF BEGINNING; thence, N 89°58'15" E, 1364.79 feet to a ½" rerod set; thence, N 00°03'34" W, 72.00 feet to a ½" rerod set; thence, S 89°15'44" E, 174.69 feet to a point; thence, S 00°06'15" W, 357.25 feet to a point; thence, S 89°52'10" W, 1228.00 feet to a ½" rerod set; thence, Due North, 279.77 feet to a ½" rerod set; thence, S 89°58'15" W, 310.79 feet to a P-K nail set, said point being on the west line of said Quarter Section and said centerline; thence, Due North along said west line and said centerline, 10.00 feet to the PLACE OF BEGINNING.

Containing 8.46 acres more or less subject to all highways and other legal easements of record.

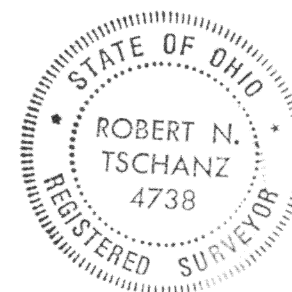

Robert N. Tschanz
Robert N. Tschanz
Registered Surveyor
Ohio # 4738