

Thomas & Joyce Wellmeier
OR Vol. 407, Pg. 491

MIKESELL SURVEY
Part of the north half of the
S.W. 1/4 of Section 23, T-5-S, R-7-E,
Union Township, Auglaize County, Ohio
as evidenced by
OR Vol. 249, Pg. 381

Being a part of the north half of the southwest quarter of Section 23, T-5-S, R-7-E, Union Township, Auglaize County, Ohio as evidenced by OR Volume 249, Page 361 and more particularly described as follows:

Commencing at a monument box (found) at the southwest corner of the southwest quarter of Section 23 and the centerline intersection of Wrestle Creek Road and Blank Pike;
thence, N 00 degrees 43' 59" E along the west line of the southwest quarter of Section 23 and the centerline of Wrestle Creek Road, for a distance of 1322.23 feet to a cotton gin spindle (set) at the southwest corner of the north half of the southwest quarter of Section 23, said spindle being the POINT OF BEGINNING for the tract herein described;

thence, continuing N 00 degrees 43' 59" E along the aforesaid west line and centerline of Wrestle Creek Road, for a distance of 283.80 feet to a cotton gin spindle (set);

thence, S 89 degrees 17' 48" E (passing through a 5/8" re-rod w/cap set on the east right-of-way line of Wrestle Creek Road at a distance of 25.00 feet) for a total distance of 1031.46 feet to a 5/8" re-rod w/cap (set);

thence, N 00 degrees 42' 12" E (passing through a 5/8" re-rod w/cap set for reference at a distance of 30.00 feet) for a total distance of 97.30 feet to a point;

thence, S 89 degrees 17' 48" E for a distance of 375.10 feet to a 5/8" re-rod w/cap (set);

thence, S 00 degrees 42' 12" W for a distance of 381.10 feet to a 5/8" re-rod w/cap (set) on the south line of the north half of the southwest quarter of Section 23;

thence, N 89 degrees 17' 48" W along the south line of the north half of the southwest quarter of Section 23 (passing through a 5/8" re-rod w/cap set on the east right-of-way line of Wrestle Creek Road at a distance of 1381.70 feet) for a total distance of 1406.70 feet to the POINT OF BEGINNING, containing therein 10.002 acres, of which 0.162 acres is road right-of-way. Prepared by James M. Kent, PS 6792 OH with reference hereby made to a plat of survey; Kent Surveying drawing #3190-B dated September 8, 2000. Basis of bearings is per Auglaize County GPS of the west line of the southwest quarter of Section 23 @ N 00 degrees 43' 59" E.

JAMES M. KENT, PS 6792 OH

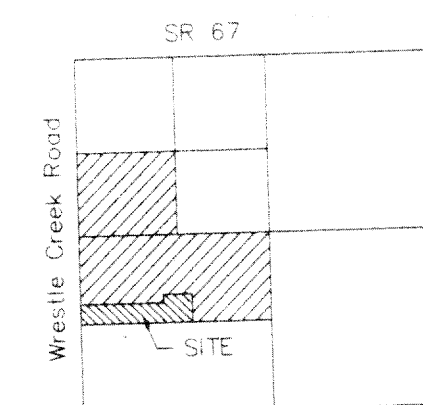

VICINITY MAP
SECTION 23

LEGEND

- ☆ Cotton Gin Spindle (set)
- 5/8" re-rod w/cap (set)
- Monument Box (found)

Reference is hereby made to a plat of survey prepared by James Geeslin, PS 7764 dated May 17, 1996 conducted in the southeast quarter of Section 23. Basis of bearings is per Auglaize County GPS of the west line of the southwest quarter of Section 23 @ N 00°43'59"E

kent
surveying

acad - alan mikesell dwg #3190-B
September 8, 2000

Elaine L. Mikesell
OR Vol. 249, Pg. 381

Timothy & Tracy Harpster
OR Vol. 191, Pg. 447

GRAPHIC SCALE

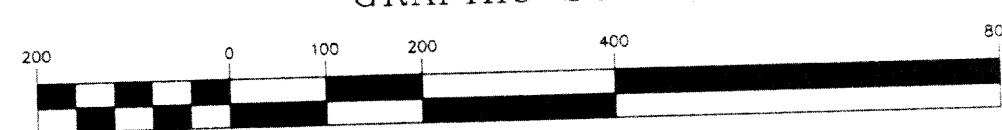

(IN FEET)
1 inch = 200 ft.

BLANK PIKE

S89°18'17"E
2656.00'

1248.13'
S89°17'48"E

Post (found) @
Center of Section 23
per Geeslin Survey

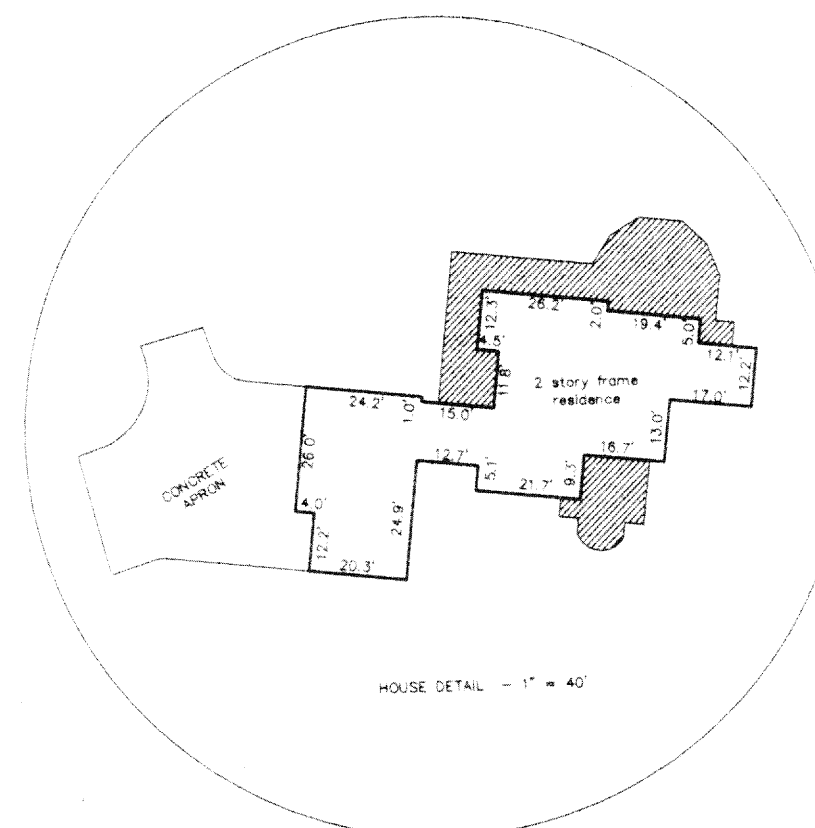

HOUSE DETAIL - 1" = 40'

West 1/4 Corner
Section 23

WRESTLE CREEK ROAD N00°44'01"E
1038.43'

N00°43'51"E
283.80'

S89°17'48"E
1031.46'
10.002 acres
(0.162 acres right-of-way)

1406.70'
N89°17'48"W

S89°17'48"E
375.10'
S00°42'12"W
381.10'
58.7'

2643.73'

N00°40'55"E

South 1/4 Corner
Section 23

Auglaize County GPS

SECTION 22 SECTION 23
SECTION 27 SECTION 26