

KARL MARSHALL SURVEY
The SE 1/4 of the NW 1/4 of Section 24,
Town-5-South, Range-7-East, Union Township,
Auglaize County, Ohio as evidenced by
Deed Volume OR 50, Page 775.

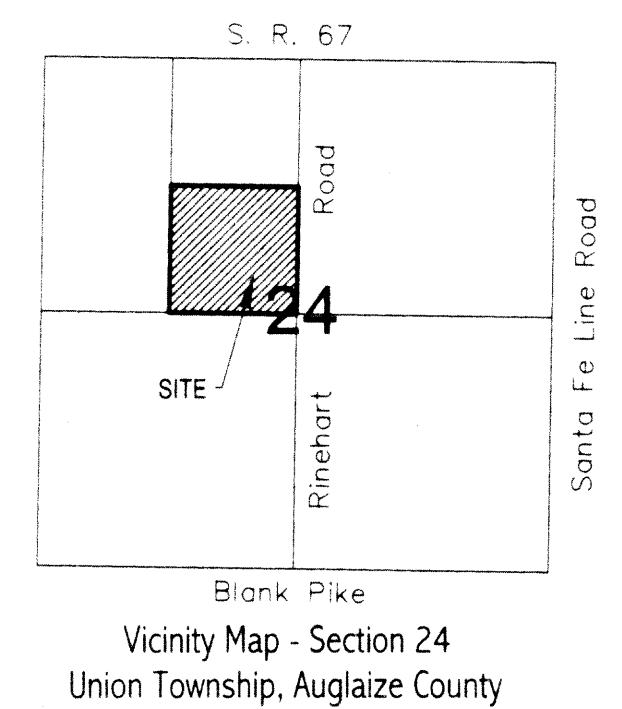

LEGEND

- Monument Box (found)
- 5/8" re-rod w/cap (set)
- ☆ Cotton Gin Spindle (set)

I hereby certify that this plat represents a field survey,
performed under my direct supervision on the date
shown hereon.

JAMES M. KENT, PS 6792

kent surveying

acad - marshall, karl dwg #3730-2
May 25, 2001
revision to r/w 6/01/01

GRAPHIC SCALE

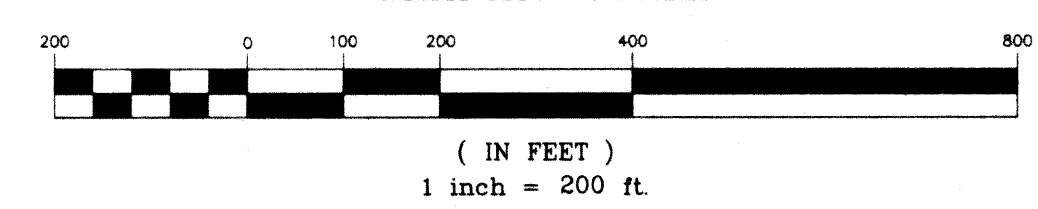

UNI-24-1

Blank to Marshall
Section 24



scale:

LEGAL DESCRIPTION

Being the southeast quarter of the northwest quarter of Section 24, Town-5-South, Range-7-East, Union Township, Auglaize County, Ohio and more particularly described as follows:

Commencing for reference at a monument box (found) at the south quarter corner of said Section 24, said box also being the southerly projection of the west right-of-way line of Rinehart Road intersecting the centerline of Blank Pike; thence, N 00 degrees 40' 32" E along the east line of the southwest quarter of Section 24 and the west right-of-way line of Rinehart Road (southerly portion), for a distance of 2644.15 feet to a monument box (found) at the southeast corner of the northwest corner, said box being the **POINT OF BEGINNING** for the tract herein described;

thence, N 89 degrees 09' 06" W (passing through a 5/8" re-rod w/cap set on the west right-of-way line of Rinehart Road (northerly portion) at a distance of 16.50 feet) for a total distance of 1324.85 feet to a 5/8" re-rod w/cap (set) at the southwest corner of the southeast quarter of the northwest quarter of Section 24;

thence, N 00 degrees 52' 42" E along the west line of the aforesaid southeast quarter of the northwest quarter, for a distance of 1324.12 feet to a 5/8" re-rod w/cap (set) at the northwest corner of the southeast quarter of the northwest quarter of Section 24;

thence, S 89 degrees 10' 28" E along the north line of the southeast quarter of the northwest quarter of Section 24 (passing through a 5/8" re-rod w/cap set on the west right-of-way line of Rinehart Road (northerly portion) at a distance of 1308.92 feet) for a total distance of 1325.42 feet to a cotton gin spindle (set) at the northeast corner of the southeast quarter of the northwest quarter of Section 24 and the legal centerline of Rinehart Road;

thence, S 00 degrees 54' 11" W along the east line of the southeast quarter of the northwest quarter of Section 24 and the legal centerline of Rinehart Road (northerly portion), for a distance of 1324.65 feet to the **POINT OF BEGINNING**, containing therein 40.289 acres, of which 0.501 acres is road right-of-way. Subject to all easements and right-of-way of record at the time of the recording of this instrument. Basis of bearings is the east line of the northeast quarter of the northwest quarter of Section 24 being N 00 degrees 54' 11" E as determined by utilizing GPS data provided by Auglaize County. Prepared by James M. Kent, PS 6792 OH with reference hereby made to a plat of survey; Kent Surveying drawing #3730-2 dated May 25, 2001

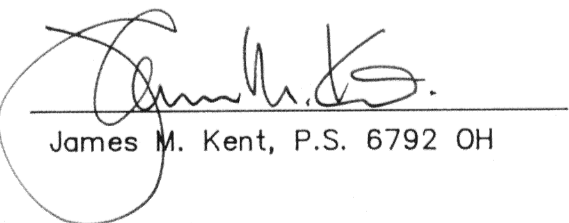
James M. Kent, P.S. 6792 OH

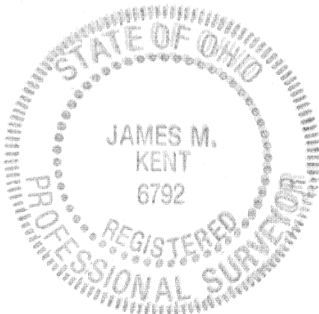

CLIENT Blank/Marshall DATE 6-1-01
COUNTY AUGLAIZE TOWNSHIP UNION
SECTION 24 T-5-S; R-7-E
DRAWN BY JMK DRAWING NO. 3730-2
SHEET 1 OF 1

kent
s u r v e y i n g
p.o. box 96 • 419/738-5677
wapakoneta, ohio