

RINEHART ROAD

Center of Section 24

S89°11'42"E
2661.21'

East 1/4 Corner,
Section 24

S00°55'40"W
(12 rods) 198.00'

S89°11'42"E
642.43'

N00°55'40"E
443.19'

7.619 acres
(0.330 acres right-of-way)

237.47'
N89°06'59"W

163.88'
N35°40'56"W

1-1/2" iron pipe
centered in 12"
steel post

307.24'
N89°06'59"W

575.69'
S00°55'40"W

SANTA FE LINE ROAD (no record R/W)

Union Township
Wayne Township

S00°55'40"W
1873.26'

SE Corner,
SE 1/4, Section 24

BLANK PIKE

Miller Survey

Part of the S.E. 1/4 of Section 24,
Town-5-South, Range-7-East,
Union Township, Auglaize County,
Ohio as evidenced by
Official Record Volume 478, Page 2545.

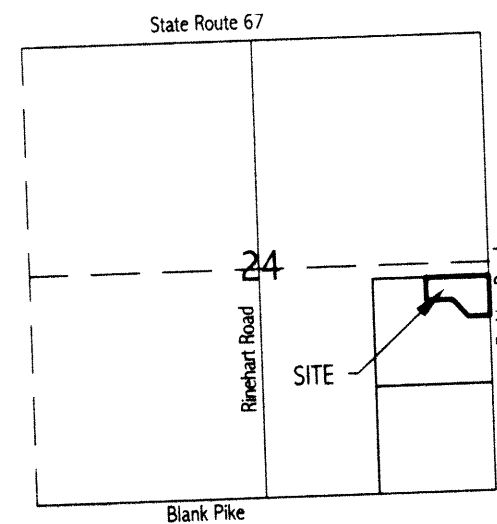

VICINITY MAP - SECTION 24

Legend

- Monument Box (found)
- 5/8" re-rod w/cap (set)

Basis of bearings per Auglaize County GPS
depicting the east line of the SE 1/4 of Section
24, Union Township as S 00°55' 40" W.

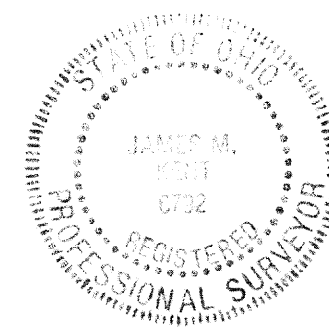

I hereby certify that this plat represents an accurate
field survey, performed under my direct supervision

JAMES M. KENT, PS 6792

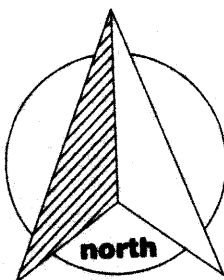

GRAPHIC SCALE

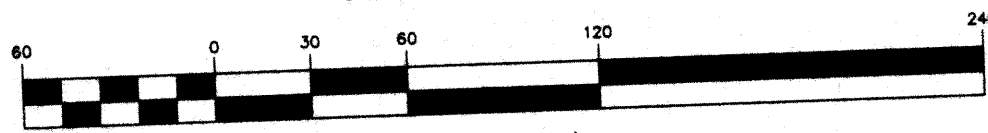

(IN FEET)
1 inch = 80 ft.

kent surveying, inc.

acad - Dan Miller
drawing #4126
June 3, 2003

UNI-24-2

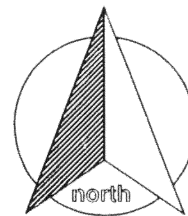

LEGAL DESCRIPTION

scale:

Being a part of the southeast quarter of Section 24, Town-5-South, Range-7-East, Union Township, Auglaize County, Ohio as evidenced by Official Record 478, Page 2545 and more particularly described as follows:

Commencing for reference at a monument box (found) at the northeast corner of the southeast quarter of Section 24 and the legal centerline of Santa Fe Line Road; thence, S 00 degrees 55' 40" W along the east line of the southeast quarter of Section 24 and the legal centerline of Santa Fe Line Road, for a distance of 198.00 feet to a cotton gin spindle (set), said spindle being the **POINT OF BEGINNING** for the tract herein described;

thence, continuing along the aforesaid east line and legal centerline, S 00 degrees 35' 40" W for a distance of 575.69 feet to a cotton gin spindle (set);

thence, N 89 degrees 06' 59" W (passing through a 5/8" re-rod w/cap set at a distance of 25.00 feet) for a total distance of 307.24 feet to a 1-1/2" iron pipe centered in a 12" steel post (found);

thence, N 35 degrees 40' 56" W for a distance of 163.88 feet to a 5/8" re-rod w/cap (set);

thence, N 89 degrees 06' 59" W for a distance of 237.47 feet to a 5/8" re-rod w/cap (set);

thence, N 00 degrees 55' 40" E for a distance of 443.19 feet to a 5/8" re-rod w/cap (set);

thence, S 89 degrees 11' 42" E (passing through a 5/8" re-rod w/cap set at a distance of 617.43 feet) for a total distance of 642.43 feet to the **POINT OF BEGINNING**, containing therein 7.619 acres, of which 0.330 acres is road right-of-way as determined by occupation. Prepared by James M. Kent, PS 6792 with reference hereby made to a plat of survey; Kent Surveying, Inc., drawing #4126 dated June 3, 2003. Basis of bearings per Auglaize County GPS depicting the east line of the southeast quarter of Section 24 as S 00 degrees 55' 40" W.

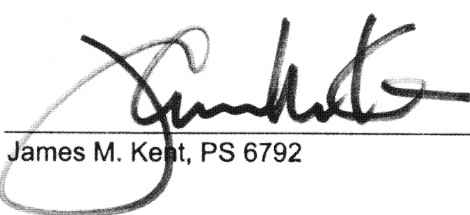
James M. Kent, PS 6792

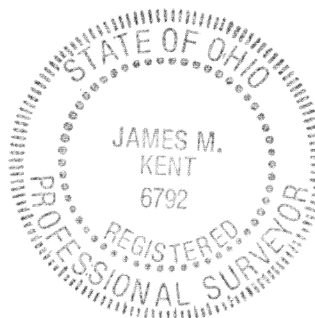

CLIENT DAN MILLER DATE 6-3-03
COUNTY AUGLAIZE TOWNSHIP UNION
SECTION 24 T-5-S; R-7-E DRAWN BY JMK
SHEET 1 OF 1 DWG. # 4126

 **kent surveying, inc.**
P.O. Box 96 - 1750 Bellefontaine Street
Wapakoneta, OH 45895
419-738-5677 fax 419-738-7894