

NORTHWEST CORNER,
NORTHEAST QUARTER
SECTION 22
WAYNE TWP.

NORTHEAST CORNER,
NORTHEAST QUARTER,
SECTION 22
WAYNE TWP.

Surveyor's Description

The following described tract is part of the Southwest Quarter of the Northeast Quarter of Section 22, Town Five (5) South, Range Eight (8) East, Wayne Township, Auglaize County, Ohio, and is more particularly described as follows:

Commencing at a Railroad Spike located at the Northeast Corner of the Northeast Quarter of Section 22, Town Five (5) South, Range Eight (8) East, Wayne Township, Auglaize County, Ohio;

thence with a bearing of N. 87°-11'-36" W. along the North line of the Northeast Quarter of said Section, and the centerline of State Route No. 67, for a distance of 1,321.95 feet to a P.K. Nail located at the Northwest Corner of the Northeast Quarter of the Northeast Quarter of said Section;

thence with a bearing of S. 03°-12'-12" W. along the East line of the West half of the Northeast Quarter of said Section for a distance of 1,986.06 feet to a P.K. Nail, said P.K. Nail being the PLACE OF BEGINNING;

thence continuing with a bearing of S. 03°-12'-12" W. along the East line of the West half of the Northeast Quarter of said Section for a distance of 239.25 feet to a P.K. Nail;

thence with a bearing of N. 87°-16'-56" W. for a distance of 1,084.53 feet to an iron pin located in the centerline of the Wallace Fork Ditch, and also passing thru an iron pin set for reference at a distance of 25.00 feet;

thence with a bearing of S. 28°-40'-05" W. along the centerline of the Wallace Fork Ditch for a distance of 470.90 feet to a point on the South line of the Northeast Quarter of said Section;

thence with a bearing of N. 87°-18'-40" W. along the South line of the Northeast Quarter of said Section for a distance of 24.50 feet to an Auglaize County Reference Point located at the Center of said Section 22;

thence with a bearing of N. 02°-58'-38" E. along the West line of the Northeast Quarter of said Section for a distance of 662.68 feet to an iron pin;

thence with a bearing of S. 87°-16'-56" E. for a distance of 1,314.13 feet to a P.K. Nail, and also passing thru an iron pin set for reference at a distance of 1,289.13 feet, said P.K. Nail being the true PLACE OF BEGINNING. Containing in all, 8.446 Acres of land subject to all legal easements, reservations, or restrictions, if any, upon said premises.

Notes

1. Previous Deed References: Volume 227, Page 683, Auglaize County Recorder's Office.
2. All bearings for this survey were based upon a survey performed by the Auglaize County Engineering Department when establishing the Center of Section 22, Wayne Township.
3. Refer to the Permanent Records of the Auglaize County Engineer for easement width and description of the Wallace Fork Single County Permanent Maintenance Ditch.

FOCHT SURVEY

Part Of The
North West Quarter Of Section 22
Wayne Twp, Auglaize County,
Town Five South, Range Eight East,
Ohio

LOCATION PLAN

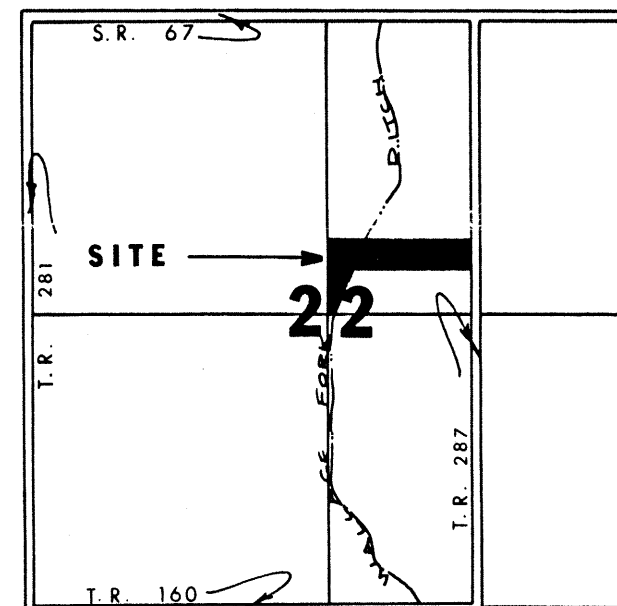

Section 22
Wayne Township

SCALE

1" = 200'

LEGEND

- P.K. Nail Set
- ▲ Railroad Spike Found
- Iron Pin Set
- Point Established by County

ATTEST:

John W. Jauert
Professional Surveyor
No. 6920

TOLERANCES (EXCEPT AS NOTED)	REVISIONS			FRED FOCHT	
	NO.	DATE	BY	JAUERT SURVEYING	
DECIMAL	1				
±	2				
FRACTIONAL	3			DRAWN BY Kevin Schnell	SCALE 1" = 200'
±	4			CHK'D John Jauert	DATE JAN 15, 1988
ANGULAR	5			TRACED	APP'D
±					DRAWING NO.

WAY-22-1