

SURVEYORS DESCRIPTION

The following described tract of land is part of the Northwest Quarter of Section 14, Town 6 South, Range 6 East, Pusheta Township, Auglaize County, Ohio, and is more particularly described as follows.

Commencing at the corner stone at the Southwest corner of the Northwest Quarter of Section 14, Pusheta Township; (Stone being in the center of County Road No. 171, formerly the Wapakoneta-Freyburg Road.)

Thence North along the center of County Road No. 171, formerly the Wapakoneta-Freyburg Road, 23.00 feet to a railroad spike, this being the PLACE OF BEGINNING.

Thence continuing North along the center of County Road No. 171, formerly the Wapakoneta-Freyburg Road, 253.00 feet to a railroad spike.

Thence N 89° 17' E (passing through an iron pipe set at 25.00 feet) 516.54 feet to an iron pipe.

Thence South 253.00 feet to an iron pipe.

Thence S 89° 17' W (passing through an iron pipe set at 491.54 feet) 516.54 feet to the railroad spike in the center of County Road No. 171, formerly the Wapakoneta-Freyburg Road, which was the PLACE OF BEGINNING.

The above described tract of land contains 3.00 acres more or less subject to 0.145 acres dedicated to the public for highway purposes and to all legal easements of record.

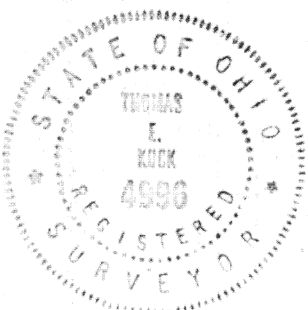

R.R.S.: Railroad Spike
Bearings Determined by assuming the
of CR#171 as being North and South.

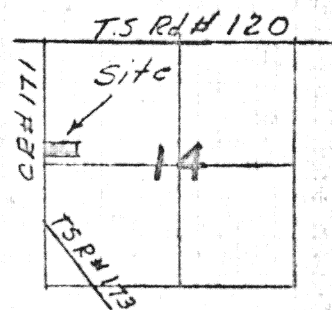

Signature by a representative of the County Engineer's Dept.
denotes that this plat meets tax map plat requirements.

Signed: _____ Date: _____

Signature by a (representative of the) County Commissioner(s)
denotes approval of this plat.

Signed: _____ Date: _____

Signature by a representative of the County Health Dept.
denotes compliance with Health Regulations.

Signed: _____ Date: _____

Signature by a representative of the Auglaize County Regional
Planning Commission denotes approval of this plat.

Signed: _____ Date: _____

Thomas E. Kuck
232 Surveyor # 4996

Client Norman Kantner to Robert Kantner
County Auglaize Twp. Pusheta Sec. 14
Drawn by dimtrick Scale 1"=80' Drwg. No. 232
Checked by _____ Date 5-3-2022
Sheet 1 of 1 (T 6 S; R 6 E)

PERMANENT RIGHT-OF-WAY
from
W. & J. Miller



Scale: _____

Situate in the southwest quarter of Section 14, Noble Township, Town 5 South, Range 4 East, with respect to the First Principal Meridian, Auglaize County, Ohio and more particularly described as follows:

Commencing at the southeast corner of the southwest quarter of Section 14;
thence N00°45'00"E a distance of 601.26 feet along TR 55 to an iron pin;
thence N59°32'20"W a distance of 446.26 feet to an iron pin;
thence N30°22'55"E a distance of 398.25 feet along TR 55 to the

PLACE OF BEGINNING;

thence N45°08'05"W a distance of 36.15 feet;
thence N30°22'55"E a distance of 30.99 feet;
thence S44°37'05"E a distance of 72.46 feet;
thence S30°22'55"W a distance of 20.00 feet;
thence N44°37'05"W a distance of 36.23 feet;
thence S30°22'55"W a distance of 10.65 feet to the PLACE OF BEGINNING.

The above tract of land contains 0.041 acres.

Next previous recording Vol. 196, Page 522

Surveyed by the Auglaize County Engineering Department, 1014 S. Blackhoof Street, Wapakoneta, Ohio.

Signature by a representative of the County Engineer's Dept.
denotes that this plat meets tax map plat requirements.
Signed: _____ Date _____

Signature by a (representative of the) County Commissioner(s)
denotes approval of this plat.
Signed: _____ Date _____

Signature by a representative of the County Health Dept.
denotes compliance with Health Regulations.
Signed: _____ Date _____

Signature by a representative of the Auglaize County Regional
Planning Commission denotes approval of this plat.
Signed: _____ Date _____

Auglaize County
Engineering Dept.
Wapakoneta, Ohio

Client Culvert No. NOB-55-1422
County Auglaize Twp. Noble Sec. 14
Drawn by _____ Scale _____ Drwg. No. _____
Checked by _____ Date 1976-04-29
Sheet 2 of 2 (T 5 S 14 E)

233

233