

DEED BOOK 232
PAGE 361

DEED BOOK
189
PAGE 312

SURVEYED
BY
LESLIE
GEESLIN

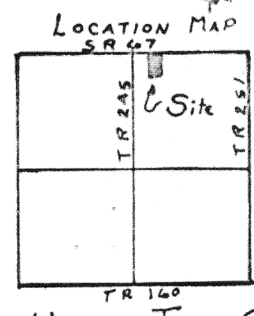

UNION Twp. SEC. 24 N/E 1/4
T-5-S-R-7-E
AUGLAIZE COUNTY OHIO

LEGEND

- ✱ R.R. SPIKE FOUND
- R.R. SPIKE SET
- ✱ IRON PIN FOUND
- IRON PIN SET

Being 5.000 Acres located in the North East quarter of Section 24, T-5-S, R-7-E, Union Township, Auglaize County, Ohio and being further described as follows:

Commencing at a railroad spike at the North East corner of the North East quarter of Section 24, also being the intersection of S.R.# 67 and T.R.# 245(Rinehart Road). Thence South 89° 58' 30" East with the center of S.R.# 67 and the north line of Section 24, a distance of 423.34 feet to a railroad spike and PLACE OF BEGINNING. Thence South 89° 58' 30" East with said center line, a distance of 375.00 feet to a railroad spike. Thence South 00° 00' 30" West, a distance of 580.80 feet to an iron pin. Thence North 89° 58' 30" West, a distance of 375.00 feet to an iron pin. Thence North 00° 00' 30" East, a distance of 580.80 feet to a railroad spike in the center of S.R.# 67 and the PLACE OF BEGINNING. Containing in all 5.000 Acres and being subject to 0.26 Ac. in road right-of-way. Survey recorded in Survey Book B Page 256 of the Auglaize County Survey Records.

Survey and Description prepared by Thomas W. Steinke.

Thomas W Steinke

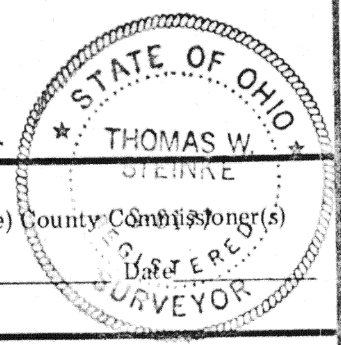

Signature by a representative of the County Engineer's Dept. denotes that this plat meets tax map plat requirements.
Signed: _____ Date _____

Signature by a (representative of the) County Commissioner(s) denotes approval of this plat.
Signed: _____ Date _____

Signature by a representative of the County Health Dept. denotes compliance with Health Regulations.
Signed: _____ Date _____

Signature by a representative of the Auglaize County Regional Planning Commission denotes approval of this plat.
Signed: _____ Date _____

<p>256</p>	<p>Client <u>DON REAM</u></p>	<p>Twp. <u>UNION</u></p>	<p>Sec. <u>24</u></p>	
	<p>County <u>AUGLAIZE</u></p>	<p>Scale <u>1"=200'</u></p>	<p>Drwg. No. <u>76-248</u></p>	
	<p>Drawn by <u>G.E.M.</u></p>	<p>Date <u>MAY 31 1976</u></p>		
	<p>Checked by _____</p>			
	<p>Sheet _____ of _____</p>			