

LOCATION SKETCH

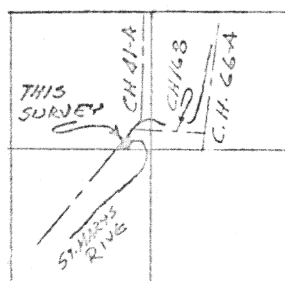

Scale: 1"=100'

SEC. 22

The following described real estate situated in the State of Ohio, County of Auglaize, Township of Noble and being part of the northwest  $\frac{1}{4}$  of Section 22, T. 5 S., R. 4 E. and being more particularly described as follows:

Beginning at a railroad spike in the east-west  $\frac{1}{2}$  section line of Section 22 and the centerline of County Highway 41-A; thence with said centerline N.  $42^{\circ} 56' 50''$  E. 745.48 feet to a railroad spike; thence S.  $47^{\circ} 03' 10''$  E. 76.00 feet to a point in the St. Marys River, passing an iron bar at 46.10 feet; thence with said river S.  $3^{\circ} 00' W.$  102.44 feet to a point; thence with the old channel of the St. Marys River S.  $46^{\circ} 55' 47'' W.$  572.45 feet to an iron bar in the east-west  $\frac{1}{2}$  section line, passing an iron bar at 34.15 feet; thence with said  $\frac{1}{2}$  section line S.  $89^{\circ} 43' 26'' W.$  140.00 feet to the place of beginning.

Containing 1.91 acres more or less.

NOTE

D.B. VOL. 61 PG. 428 places this parcel in the southwest  $\frac{1}{4}$  of Section 22, however this surveyor feels that the only possible location is in the northwest  $\frac{1}{4}$  of Section.

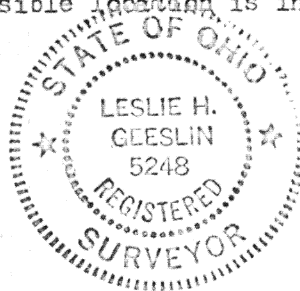

Signature by a representative of the County Engineer's Dept. denotes that this plat meets tax map plat requirements.  
Signed: \_\_\_\_\_ Date \_\_\_\_\_

Signature by a (representative of the) County Commissioner(s) denotes approval of this plat.  
Signed: \_\_\_\_\_ Date \_\_\_\_\_

Signature by a representative of the County Health Dept. denotes compliance with Health Regulations.  
Signed: \_\_\_\_\_ Date \_\_\_\_\_

Signature by a representative of the Auglaize County Regional Planning Commission denotes approval of this plat.  
Signed: \_\_\_\_\_ Date \_\_\_\_\_

LESLIE H. GEESLIN  
REG. SURVEYOR 5248  
ROCKSVILLE, OHIO

Client LOUISE STROH  
County AUGLAIZE Twp. NOBLE Sec. 22  
Drawn by L. H. G. Scale 1"=100' Drwg. No. \_\_\_\_\_  
Checked by \_\_\_\_\_ Date 2-28-78  
Sheet 1 of 1 (T. 5 S. R. 4 E.)