

LEGEND
A = RAILROAD SPIKE FD. FROM PREVIOUS SURVEY
B = RAILROAD SPIKE SET
C = IRON BAR OR PIPE FD FROM PREVIOUS SURVEY
D = 5/8" IRON BAR SET

ROGER KOENIG ET AL
VOL. 233
Pg. 477

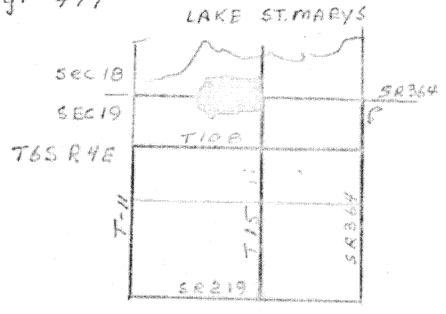

Signature by a representative of the County Health Dept.
denotes compliance with Health Regulations.
Signed: _____ Date: _____

Signature by a representative of City with 3 mile limit jurisdiction or Twp, Trustees or Village with zoning jurisdiction denotes approval of this plat. Signed: _____ Date: _____
for political S. D. of: _____

Signature by a representative of the Auglaize County Regional Planning Commission denotes approval of this plat.
Signed: _____ Date: _____

Signature by a representative of the County Engineer's Dept. denotes that this plat meets tax map plat requirements.
Signed: _____ Date: _____

Client CURTIS LIBBEE
County Auglaize Twp. ST. MARYS Sec. 18 & 19
Drawn by JWS Scale 1" = 200' Drwg. No. _____
Checked by DWC
Sheet 1 of 3 **235** DECEMBER, 1998 (T'6 S; R 4 E)

REDRAWN FROM A SURVEY BY
Gordon L. Geeslin
REGISTERED SURVEYOR #5392
233 MARKET ST. CELINA, OHIO

December 22, 1978



LIBBEE SURVEY DESCRIPTION (TRACT "A")

Being a parcel of land situated in St. Marys Township, Auglaize County, Ohio, in the southwest quarter or fractional Section 18 and the north half of the northwest quarter of Section 19, Town 6 South, Range 4 East. Being more particularly described as follows:

Scale: _____

Beginning at a railroad spike at the northeast corner of said northwest quarter of Section 19-

Thence, south $01^{\circ}08'37''$ west, along the east line of said northwest quarter of Section 19 and the centerline of Schroeder Road, a distance of two hundred ninety-one and $67/100$ (291.67) feet to a railroad spike at the northeast corner of a 34.604 acre tract of land conveyed to Roger, Jame, Edward and Diana Koenig by deed recorded in deed volume 233, page 477.

Thence, north $88^{\circ}58'17''$ west along a line of said Koenig's ground, a distance of six hundred eighty-four and $64/100$ (684.64) feet to a 5/8 inch iron bar-

Thence, continuing along said Koenig's line, south $00^{\circ}58'01''$ west, a distance of forty-four and $86/100$ (44.86) feet to a 5/8 inch iron bar-

Thence, continuing along said Koenig's line, south $87^{\circ}38'26''$ west, a distance of two hundred forty-six and $77/100$ (246.77) feet to a 5/8 inch iron bar-

Thence, continuing along said Koenig's line and the extension thereof, south $88^{\circ}02'29''$ west, a distance of six hundred four and $28/100$ (604.28) feet to a 5/8 inch iron bar-

Thence, south $03^{\circ}35'04''$ west, a distance of one hundred twelve and $10/100$ (112.10) feet to a 5/8 inch iron bar-

Thence, north $68^{\circ}48'38''$ west, a distance of one hundred seventy-eight and $85/100$ (178.85) feet to a 5/8 inch iron bar-

Thence, north $39^{\circ}38'04''$ west, a distance of sixty-nine and $30/100$ (69.30) feet to a 5/8 inch iron bar-

Thence, north $35^{\circ}32'16''$ east, a distance of two hundred twenty-three and $36/100$ (223.36) feet to a 5/8 inch iron bar-

Thence, north $23^{\circ}18'56''$ east, a distance of one hundred eleven and $99/100$ (111.99) feet to a 5/8 inch iron bar-

Thence, north $07^{\circ}07'27''$ east, a distance of four hundred thirty-three and $86/100$ (433.86) feet to a 5/8 inch iron bar-

Thence, north $84^{\circ}32'48''$ east, a distance of one hundred forty and $69/100$ (140.69) feet to a 5/8 inch iron bar-

Thence, south $80^{\circ}57'08''$ east, a distance of twenty-four and $95/100$ (24.95) feet to a 5/8 inch iron bar-

Thence, north $89^{\circ}50'54''$ east, a distance of three hundred forty-three and $73/100$ (343.73) feet to a 5/8 inch iron bar-

Signature by a representative of the County Health Dept. denotes compliance with Health Regulations.
Signed: _____ Date _____

Signature by a representative of the Auglaize County Regional Planning Commission denotes approval of this plat.
Signed: _____ Date _____

Signature by a representative of City with 3 mile limit jurisdiction or Twp. Trustees or Village with zoning jurisdiction denotes approval of this plat. Signed: _____ Date _____
for political S. D. of: _____

Signature by a representative of the County Engineer's Dept. denotes that this plat meets tax map plat requirements.
Signed: _____ Date _____

Gordon L. Geeslin
Registered Surveyor #5372
540 East Market Street
Cella, Ohio 44222
D 236 **236**

Client Curtis H. Libbee
County Auglaize Twp. St. Marys Sec. 18 & 19
Drawn by _____ Scale _____ Drwg. No. _____
Checked by _____ Date 12/23/78
Sheet 2 of 3 **236** (T 6 S 4 E)

LIBBEE SURVEY DESCRIPTION (TRACT "A")
page two



Scale: _____

Thence, south $69^{\circ}21'52''$ east, a distance of ninety-nine and $02/100$ (99.02) feet to a one inch iron bar at the southwest corner of 0.332 acre tract of land conveyed to William and Ethel Riddle by deed recorded in deed volume 156, page 567-

Thence, north $84^{\circ}48'54''$ east, along said Riddle's south line, the south line of 0.283 acre tract transferred to Walter Schwartz by deed recorded in deed volume 180, page 278, and the south line of a 0.298 acre tract conveyed to C.H. Libbee by deed recorded in deed volume 177, page 102, a distance of three hundred thirty-four and $78/100$ (334.78) feet to a one inch iron bar at said Libbee's southeast corner-

Thence, north $05^{\circ}04'54''$ west, along said Libbee's east line, a distance of eight and $33/100$ (8.33) feet to a $5/8$ inch iron bar-

Thence, north $89^{\circ}09'54''$ east, a distance of six hundred five and $75/100$ (605.75) feet to a railroad spike in the north-south half section line of Section 18-

Thence, south $01^{\circ}09'13''$ west, along said north-south half section line of Section 18 and the centerline of Schroeder Road, a distance of three hundred eight-nine and $19/100$ (389.19) feet to the place of beginning.

Containing 25.747 acres of land more or less of which 12.877 acres are in Section 19.

Subject to all easements and right-of-way of record.

Reference is made to a survey by Gordon L. Geeslin, Registered Surveyor 5372, dated December, 1978.

Surveyed By

Gordon L. Geeslin
Gordon L. Geeslin
Registered Surveyor #5372



Signature by a representative of the County Health Dept.
denotes compliance with Health Regulations.
Signed: _____ Date: _____

Signature by a representative of the Auglaize County Regional
Planning Commission denotes approval of this plat.
Signed: _____ Date: _____

Signature by a representative of City with 3 mile limit juris-
diction or Twp. Trustees or Village with zoning jurisdiction
denotes approval of this plat. Signed: _____
for political S. D. of: _____ Date: _____

Signature by a representative of the County Engineer's Dept.
denotes that this plat meets tax map plat requirements.
Signed: _____ Date: _____

Gordon L. Geeslin
Registered Surveyor #5372
540 East Market Street
Collins, Ohio 45822

Client Curtis H. Libbee
County Auglaize Twp. St. Marys Sec. 18 & 19
Drawn by _____ Scale _____ Drwg. No. _____
Checked by _____ Date 12/22/78
Sheet 3 of 3 (P. 6 S. R. 4 E)

D237

237

237