

PLAT RECORDED IN SURVEY BOOK D, PAGE 311, AUGLAIZE CO. ENG. OFFICE

IRON STAKE
FOUND @ STA.
6566 ON M.F.E.
CANAL PLANS

STA. 6569.90 ON
M.F.E. CANAL SURVEY

IRON PIPE FOUND
@ STA. 6569.70
ON M.F.E. CANAL
SURVEY PLANS

CANAL SURVEY
LINE

5.84°18'E.
70.00'

15.82'

1 FIRST ST.

1831.52' S.87°43'30"E.
SOUTH CORPORATION LINE
1/2 SECTION LINE

N.E. CORNER OF
SE 1/4, SEC. 34,
JACKSON TWP.

34' ROADWAY
DEED:
VOL. 140
Pg. 81

10.681 ACRES

LEGEND

- IRON PIN
- ✕ SPIKE
- ⊙ CONC. MON.
- ✱ P.K. NAIL

S.88°35'30"E.
550.65'

DEED:
VOL. 230
Pg. 457

DEED:
VOL. 131
Pg. 470

427.38'
N.87°38'30"W.

SITE PLAN SECTION 34

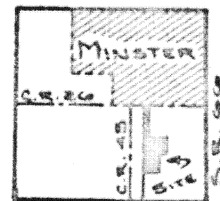

JACKSON TWP.
T-7-S-R-4-E

WOODEN LUG
FOUND @ STA.
6582+57 OF
CANAL SURVEY

CANAL RIGHT-
OF-WAY LINE

306°33'W.
1266.70'

MAMA L'ERIE CANAL

1.02°18'W.
329.49'

N.02°18'W.
329.49'

1/4 SECTION LINE

363.51'
S.03°08'W.

500.00'
502°56'30"W.

ATTEST: Doug Reinhart
DOUG REINHART
REG. SURVEYOR #6307

REVISED MARCH 26, 1979

Signature by a representative of the County Health Dept.
denotes compliance with Health Regulations.
Signed: _____ Date _____

Signature by a representative of the Auglaize County Regional
Planning Commission denotes approval of this plat.
Signed: _____ Date _____

Signature by a representative of City with 3 mile limit juris-
diction or Twp. Trustees or Village with zoning jurisdiction
denotes approval of this plat. Signed: _____
for political S. D. of: _____ Date _____

Signature by a representative of the County Engineer's Dept.
denotes that this plat meets tax map plat requirements.
Signed: _____ Date _____

DOUG REINHART
LAND SURVEYING

Client MINSTER BOARD OF PUBLIC AFFAIRS
County AUGLAIZE Twp. JACKSON Sec. 34
Drawn by JOHN JAUERT Scale 1"=200' Drwg. No. 78-136
Checked by D. REINHART Date DEC. 15th, 1978
Sheet 1 of 2

D-311 311

311

(T 7 S; R 4 E)

MINSTER BOARD OF PUBLIC AFFAIRS
SURVEY FOR THREE PARCELS NEAR TREATMENT PLANT



Scale: _____

SURVEYORS DESCRIPTION

The following described tract of ground is part of the Southeast Quarter of Section 34, Jackson Township, Town 7 South, Range 4, East, Auglaize County, Ohio and is more particularly described as follows:

Commencing at a nail at the Northeast corner of the Southeast Quarter of Section 34, Jackson Township;

Thence N.87°43'30"W. along the half-section line and the South corporation line of the Village of Minster a distance of 1831.52 feet to an iron pin in the East line of a 34 foot road owned by the Village of Minster and described in Deed Vol. 140, Page 81, said iron pin being the PLACE OF BEGINNING;

Thence S.06°25'30"W. along the East right-of-way line of said road a distance of 739.51 feet to an iron pin;

Thence S.88°35'30"E. a distance of 550.65 feet to an iron pin in the North-South Quarter Section line;

Thence S.03°08'W. along said Quarter Section line a distance of 363.51 feet to an iron pin;

Thence N.87°38'30"W. a distance of 158.04 feet to an iron pin;

Thence S.02°56'30"W. a distance of 500.00 feet to an iron pin;

Thence N.87°38'30"W. a distance of 427.38 feet to an iron pin in the East right-of-way line of the Miami and Erie Canal;

Thence N.02°18'W. along the said canal right-of-way a distance of 329.49 feet to an iron pin;

Thence N.06°25'30"E. along said canal right-of-way a distance of 1266.70 feet to a spike set in the South Corporation line of Minster and the East-West half-section line of Section 34, Jackson Township;

Thence S.87°43'30"E. along the said half-section line a distance of 34.09 feet to an iron pin which was the PLACE OF BEGINNING.

The above described tract of ground contains 10.598 acres and is subject to all easements of record. All bearings were based upon the Miami and Erie Canal Plans.

The above description and plat is recorded in Survey Book D, Page 311, in the Auglaize County Engineers Office and describes the three previously purchased parcels of ground obtained by the Village of Minster, Ohio and is recorded in the Auglaize County Recorders Office as Deeds: Volume 140, Page 81

Volume 230, Page 457

Volume 131, Page 470

ATTEST: Doug Reinhart
Doug Reinhart
Reg. Surveyor # 6507

Signature by a representative of the County Health Dept.
denotes compliance with Health Regulations.
Signed: _____ Date _____

Signature by a representative of the Auglaize County Regional
Planning Commission denotes approval of this plat.
Signed: _____ Date _____

Signature by a representative of City with 3 mile limit juris-
diction or Twp. Trustees or Village with zoning jurisdiction
denotes approval of this plat. Signed: _____
for political S. D. of: _____ Date _____

Signature by a representative of the County Engineer's Dept.
denotes that this plat meets tax map plat requirements.
Signed: _____ Date _____

DOUG REINHART
LAND SURVEYING

Client Minster board of Public Affairs
County Auglaize Twp. Jackson Sec. 24
Drawn by John Jawert Scale _____ Drwg. No. 78-136
Checked by D.P.R. Date 3-26-79
Sheet 2 of 2 (T 7 S R 4 E)

312

312