

N.E. CORNER,
N.W. 1/4, SECTION
33, GOSHEN TWP.

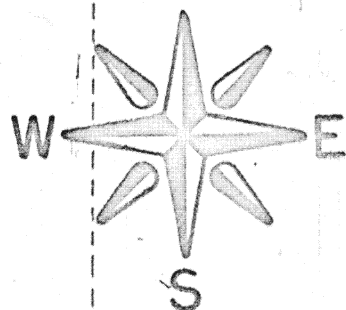

LOCATION PLAN
SECTION 33

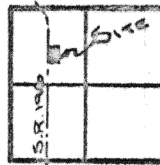

GOSHEN TWP.
AUGLAIZE CO., OHIO

LEGEND

- IRON PIN SET
- ⊙ IRON PIPE FOUND
- ▲ R.R. SPIKE FOUND
- △ R.R. SPIKE SET
- P.K. NAIL FOUND

ATTEST: Doug Reinhart
DOUG REINHART
REG. SURVEYOR N86507

THIS PLAT IS RECORDED IN SURVEY BOOK E, PAGE 307,
IN THE AUGLAIZE COUNTY ENGINEERS OFFICE.

Signature by a representative of the County Health Dept.
denotes compliance with Health Regulations.
Signed: _____ Date _____

Signature by a representative of the Auglaize County Regional
Planning Commission denotes approval of this plat.
Signed: _____ Date _____

Signature by a representative of City with 3 mile limit juris-
diction or Twp. Trustees or Village with zoning jurisdiction
denotes approval of this plat. Signed: _____ Date _____
for political S. D. of: _____

Signature by a representative of the County Engineer's Dept.
denotes that this plat meets tax map plat requirements.
Signed: _____ Date _____

DOUG REINHART
LAND SURVEYING

Client BILL HUTCHISON
County AUGLAIZE Twp. GOSHEN Sec. 33
Drawn by J. JAUERT Scale 1"=100' Drwg. No. 80-199
Checked by D.P.R. Date 7-22-00
Sheet 1 of 2

Scale:

SURVEYORS DESCRIPTION

The following described tract of ground is part of the Northwest Quarter of Section 33, Goshen Township, Township Five (5) South, Range Eight (8) East, Auglaize County, Ohio and is more particularly described as follows:

Commencing at a P.K. Nail at the Northeast corner of the Northwest Quarter of Section 33, Goshen Township;

Thence West on the North line of Section 33 and the centerline of Goshen Township Road # 150 (T.R. # 150 formerly known as Middle Pike) a distance of 1193.19 feet to a P.K. Nail on the centerline tangent of State Route # 196;

Thence in a southerly direction with the centerline of State Route # 196 with a deflection angle to the left from the North line of Section 33 of 81°-01'-30" and a distance of 1063.66 feet to a spike and the PLACE OF BEGINNING;

Thence continuing along the centerline of State Route # 196 a distance of 318.00 feet to a spike;

Thence with a deflection angle to the left of 100°-03'-20" through an iron pipe in the east right-of-way line of S.R. # 196 at 30.45 feet for a total distance of 208.71 feet to an iron pipe;

Thence with a deflection angle to the left of 79°-51'-40" a distance of 318.00 feet to an iron pin;

Thence with a deflection angle to the left of 100°-03'-20" through an iron pin in the east right-of-way line of S.R. # 196 at 178.23 feet for a total distance of 208.71 feet to a spike in the centerline of S.R. # 196 and the PLACE OF BEGINNING.

The above described tract of ground contains 1.50 Acres of which 0.22 Acres has been dedicated for highway purposes. The above described tract of ground is subject to all easements of record. The distance and centerline data based upon a survey by Tom Steinke and recorded in Survey Book C, Page 250.

Previous deed reference: Volume 231, Page 46, Auglaize County Records Office. Survey recorded in Plat Book E, Page 307, Auglaize County Engineers Office.

Attest: Doug Reinhardt
Doug Reinhardt
Professional Surveyor # 6507



Signature by a representative of the County Health Dept. denotes compliance with Health Regulations.
Signed: _____ Date: _____

Signature by a representative of the Auglaize County Regional Planning Commission denotes approval of this plat.
Signed: _____ Date: _____

Signature by a representative of City with 3 mile limit jurisdiction or Twp. Trustees or Village with zoning jurisdiction denotes approval of this plat. Signed: _____
for political S. D. of: _____ Date: _____

Signature by a representative of the County Engineer's Dept. denotes that this plat meets tax map plat requirements.
Signed: _____ Date: _____

Client Bill Hutchison
County Auglaize Twp. Goshen Sec. 33
Drawn by _____ Scale _____ Drwg. No. 40-109
Checked by _____ Date 7-22-50
Sheet 2 of 2 (T 5 S; R 8 E)

308

308