

LOCATION PLAN

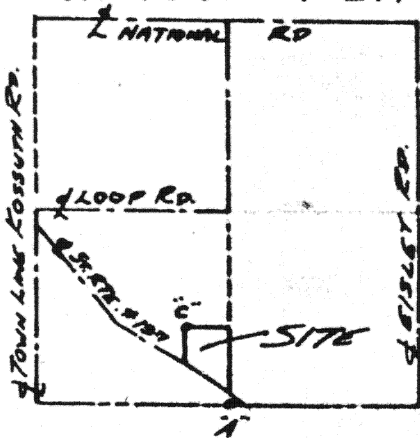

SECTION 31
T4S R5E
LOGAN TOWNSHIP
AUGLAIZE COUNTY
OHIO

WILLIAM A. & GLENN M. MECKSTROTH
PREV. DEED V. 232 PG. 80 & 81
(MORTGAGE)

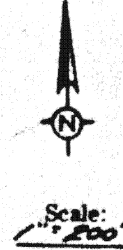

- A" 2" IR. PIPE FOUND
- B" R.R. SPIKE FOUND
- C" 3/4" IR. PIPE FOUND
- D" R.R. SPIKE SET
- E" 1/2" IR. PIN SET
- F" 6" ST. HWY. DEPT. CONC. MONU. FOUND

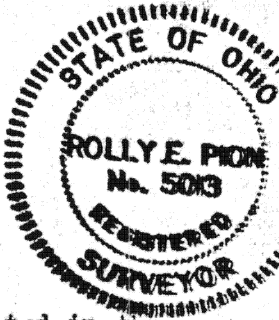

DESCRIPTION:

Being a parcel of land situated in the southwest quarter of Section 31, T 4 S, R 5 E, Logan Township, Auglaize County, Ohio, and more fully described as follows:

Beginning at a point (said point lies on the tangent line for a curve in the centerline of State Route No. 197 located north a distance of 0.10' from a R.R. Spike set at the point of intersection of the centerline of State Route No. 197 with the east line of the southwest quarter of Section 31, this said R.R. Spike being N 00° 31' E a distance of 117.60' from the iron pipe found marking the southeast corner of the southwest quarter of Section 31); thence northwesterly with an interior angle of 52° 18' bearing N 51° 47' W along the tangent line of the centerline curve for State Route No. 197 (Curve Data: D - 2°, Delta - 7° 21', Tangent - 184.00', Radius - 2864.789' and L - 367.50') for a distance of 159.80' to the P.I. of the curve marked by a iron nail set; thence continuing northwesterly with an interior angle of 187° 21' bearing N 59° 08' W for a distance of 411.20' to a R. R. Spike set and passing through a R.R. Spike set at 184.00' marking the P.C. of the curve (Arc Length of the centerline equals 343.80'); thence northerly with an interior angle of 120° 10' bearing N 00° 42' E for a distance of 485.30' to a point marked by a iron pipe found and passing through a iron pin set at 34.70' to mark the northerly right of way line for State Route No. 197; thence easterly with an interior angle of 89° 50' bearing S 89° 08' E for a distance of 477.73' to a point marked by a iron pin set; thence southerly with an interior angle of 90° 21' bearing S 00° 31' W for a distance of 787.88' to the R.R. Spike at the point of beginning, and passing through a iron pin set at 751.86' to mark the northerly right of way line for State Route No. 197. Said parcel of land contains 6.944 acres and is subject to all legal highways consisting of 0.391 acre and all easements of record.

REVISION MAY 1, 1982, INCORRECTLY (DEED) ROLLY E. PION, Surveyor No. 5013

TRANSCRIBED (789.88 changed to 787.88)

Signature by a representative of the County Health Dept. denotes compliance with Health Regulations.
Signed: _____ Date: _____

Signature by a representative of the Auglaize County Regional Planning Commission denotes approval of this plat.
Signed: _____ Date: _____

Signature by a representative of City with 3 mile limit jurisdiction or Twp. Trustees or Village with zoning jurisdiction denotes approval of this plat for political purposes.
Signed: _____ Date: _____

Signature by a representative of the County Engineer's Dept. denotes that this plat meets tax map plat requirements.
Signed: _____ Date: _____

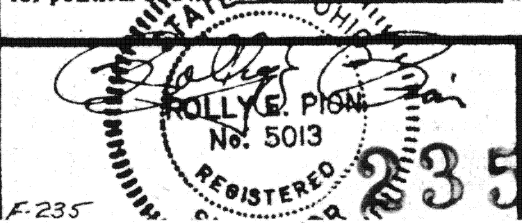

Client "RED" KUCK REAL ESTATE
County AUGLAIZE Twp. LOGAN Sec. 31
Drawn by REP Scale 1"=200' Drwg. No. 82027-1
Checked by REP Date MARCH 1982
Sheet 1 of 1 (T 4 S; R 5 E)