

SURVEYORS DESCRIPTIONS



The following described parcels of ground are part of Outlot # 42 in the Village of New Bremen, Ohio, Section 15, German Township, Auglaize County, Ohio and are more particularly described as follows: Scale: _____

PARCEL "A" 0.347 ACRES

Commencing at a P.K. Nail at the intersection of the North line of Outlot # 42 and the West right of way line of Park Street in the Village of New Bremen; Thence S83°-47'W along the North line of Outlot # 42 and the south right-of-way line of Front Street a distance of 180.00 feet to an iron pin and the PLACE OF BEGINNING;

Thence continuing S83°-47'W along said outlot line a distance of 85.30 feet to an iron pipe;

Thence S06°-13'E a distance of 177.00 feet to an iron pin;

Thence N83°-47'E a distance of 85.30 feet to an iron pin;

Thence N06°-13'W a distance of 177.00 feet to an iron pin and the PLACE OF BEGINNING.

The above described parcel of ground contains 0.347 Acres and is subject to all easements of record. All bearings are based upon the East line of Outlot # 42 being N00°-00'E. Previous deed reference: Volume 128, Page 554, Auglaize County Recorders Office. Survey filed in Plat Book F, Page 359, Auglaize County Engineers Office.

PARCEL "B" 0.139 ACRES

Commencing at a P.K. Nail at the intersection of the North line of Outlot # 42 and the West right-of-way line of Park Street in the Village of New Bremen, Ohio; Thence S83°-47'W along the North line of Outlot # 42 and the South line of Front Street a distance of 180.00 feet to an iron pin; Thence S06°-13'E a distance of 90.00' to an iron pin and the PLACE OF BEGINNING; Thence continuing S06°-13'E a distance of 87.00 feet to an iron pin;

Thence N83°-45'E a distance of 69.68 feet to an iron pin;

Thence N06°-13'W a distance of 87.00 feet to an iron pin;

Thence S83°-45'W a distance of 69.68 feet to an iron pin and the PLACE OF BEGINNING.

The above described parcel of ground contains 0.139 ACRES and is subject to all easements of record. All bearings are based upon the East line of Outlot # 42 being N00°-00'E. Previous deed reference: Volume 128, Page 554, Auglaize County Recorders Office. Survey filed in Plat Book F, Page 359, Auglaize County Engineers Office.

ATTEST: *Doug Reinhart*
Doug Reinhart
Professional Surveyor # 6507

Signature by a representative of the County Health Dept. denotes compliance with Health Regulations.

Signed: _____ Date: _____

Signature by a representative of the Auglaize County Regional Planning Commission denotes approval of this plat.

Signed: _____ Date: _____

Signature by a representative of City with 3 mile limit jurisdiction or Township with zoning jurisdiction denotes approval of this plat.

Signed: _____ Date: _____

Signature by a representative of the County Engineer's Dept. denotes that this plat meets tax map plat requirements.

Signed: _____ Date: _____

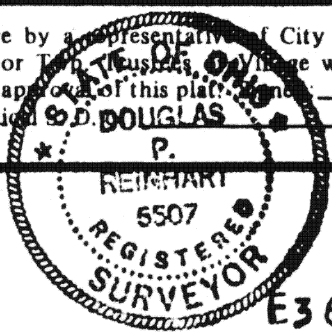

E360

Client Edna Mohrman
County Auglaize Twp. German Sec. 15
Drawn by _____ Scale _____ Drwg. No. 83-313
Checked by _____ Date 3-10-83
Sheet 2 of 3 **F350** (T ✓ S ✓ R ✓ E)

SURVEYORS DESCRIPTIONS (CONT.)



PARCEL "C"
0.354 ACRES

Scale: _____

Commencing at a P.K. Nail at the intersection of the North line of Outlot # 42 and the West right-of-way line of Park Street in the Village of New Bremen, Ohio; Thence S83°-47'W along the North line of Outlot # 42 and the South right-of-way line of Front street a distance of 265.30 feet to an iron pipe; Thence S06°-13'E a distance of 177.00 feet to an iron pin and the PLACE OF BEGINNING:

Thence continuing S06°-13'E a distance of 69.00 feet to an iron pin; Thence S83°-47'W a distance of 107.25 feet to an iron pin in the East line of an 16.50' alley;

Thence S06°-13'E along said alley a distance of 18.12 feet to an iron pin in the South Line of Outlot # 42;

Thence N83°-45'E along said outlot line a distance of 262.24 feet to an iron pin;

Thence N06°-13'W a distance of 87.00 feet to an iron pin;

Thence S83°-45'W a distance of 69.68 feet to an iron pin;

Thence S83°-47'W a distance of 85.30 feet to an iron pin and the PLACE OF BEGINNING.

The above described parcel of ground contains 0.354 Acres and is subject to all easements of record. All bearings are based upon the East line of Outlot # 42 being N00°-00'E. Previous deed reference: Volume 128, Page 554, Auglaize County Recorders Office. Survey filed in Plat Book F, Page 359, Auglaize County Engineers Office.

PARCEL "D"
0.180 ACRES

Commencing at a P.K. Nail at the intersection of the North line of Outlot # 42 and the West right-of-way line of Park Street in the Village of New Bremen, Ohio; Thence S00°-00'W parallel to the East line of Outlot # 42 a distance of 177.95 feet to an iron pin and the PLACE OF BEGINNING:

Thence S83°-45'W a distance of 91.04 feet to an iron pin;

Thence S06°-13'E a distance of 87.00 feet to an iron pin in the South line of Outlot # 42;

Thence N83°-45'E along the south line of Outlot # 42 through an iron pipe at 81.56 feet for a total distance of 85.58 feet to the East right-of-way line of Park Street;

Thence N00°-00'E along the East line of Park Street parallel to the East line of Outlot # 42 a distance of 87.52 feet;

Thence S83°-45'W a distance of 4.02 feet to an iron pin and the PLACE OF BEGINNING.

The above described parcel of ground contains 0.180 Acres of ground and is subject to all easements of record. Previous deed reference: Volume 128, Page 554, Auglaize County Recorders Office. Survey filed in Plat Book F, Page 359, Auglaize County Engineers Office.

ATTEST:

Doug Reinhart

Doug Reinhart, Professional Surveyor # 6507

Signature by a representative of the County Health Dept. denotes compliance with Health Regulations.
Signed: _____ Date: _____

Signature by a representative of the Auglaize County Regional Planning Commission denotes approval of this plat.
Signed: _____ Date: _____

Signature by a representative of City with 3 mile limit jurisdiction or Twp. Trustees of Village with zoning jurisdiction denotes approval of this plat. Signed: _____ Date: _____

Signature by a representative of the County Engineer's Dept. denotes that this plat meets tax map plat requirements.
Signed: _____ Date: _____

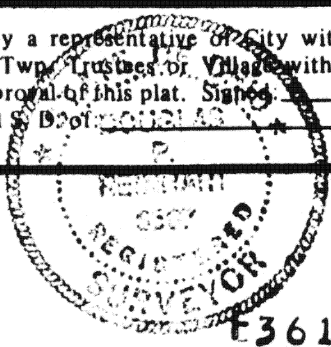

Client Edna Mohrman
County Auglaize Twp. German Sec. 15
Drawn by _____ Scale _____ Drwg. No. 83-313
Checked by _____ Date 3-10-83
Sheet 3 of 3 **F361** (T 7 S; R 4 E)