

LOCATION PLAN
SECTION 35

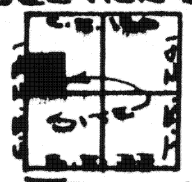

UNION TOWNSHIP
T. 5 S. R. 7 E. AUGLAIZE
COUNTY, OHIO

PREVIOUS DEED
REFERENCE,
VOL. 182
Pg. 266

LEGEND

IRON PIN SET
R.R. SPIKE SET
MOUNTAIN BOX

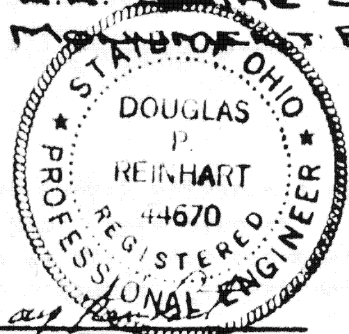

ATTY. DOUG REINHART
REG. SURVEYOR NO. 6507
REG. ENGINEER NO. 44670

THIS PLAT IS RECORDED IN SURVEY BOOK 2, PAGE 79, AT
THE AUGLAIZE COUNTY ENGINEER'S OFFICE

Signature by a representative of the County Health Dept.
denotes compliance with Health Regulations.
Signed: _____ Date: _____

Signature by a representative of the Auglaize County Regional
Planning Commission denotes approval of this plat.
Signed: _____ Date: _____

Signature by a representative of City with 3 mile limit juris-
diction or Twp. Trustees or Village with zoning jurisdiction
denotes approval of this plat. Signed: _____
for political S. D. of: _____ Date: _____

Signature by a representative of the County Engineer's Dept.
denotes that this plat meets tax map plat requirements.
Signed: _____ Date: _____

DOUGLAS P. REINHART
6507
REG. SURVEYOR 679

Client DON MARSHALL
County AUGLAIZE Twp. UNION Sec. 35
Drawn by D. MARSHALL Scale 3"=300' Drwg. No. 83-332
Checked by _____ Date JUNE 1983
Sheet 1 of 2 679 (T. 5 S. R. 7 E.)



Scale: _____

The following described tract of land is part of the Northwest Quarter of Section 35, Union Township, Town 5 South, Range 7 East, Auglaize County, Ohio, and is more particularly described as follows:

The PLACE OF BEGINNING is a monument box at the Southwest corner of the Northwest Quarter of Section 35, Union Township;

Thence with an assumed bearing of N.00°00'E., along the centerline of County Road 231 and the west line of Section 35, Union Township a distance of 1290.00 feet to a spike;

Thence N.89°37'30"E. a distance of 1350.75 feet to a spike;

Thence S.00°00'W. a distance of 1290.00 feet to an iron pin;

Thence S.89°37'30"W. a distance of 1350.75 feet along the south line of the Northwest Quarter of Section 35, Union Township, to the monument box which was the true PLACE OF BEGINNING.

Containing 40.00 Acres of which 0.74 Acre has been dedicated for highway purposes. The above described tract of land is subject to all legal easements of record. Previous deed references: Volume 182, Page 266. This plat is recorded in Survey Book G, Page 79, at the Auglaize County Engineer's Office.

ATTEST:

Doug Reinhart
 Doug Reinhart
 Reg. Surveyor # 6507
 Reg. Engineer # 44670

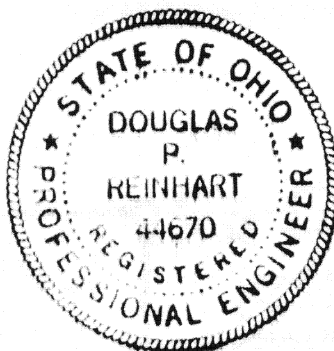

Signature by a representative of the County Health Dept.
 denotes compliance with Health Regulations.
 Signed: _____ Date: _____

Signature by a representative of the Auglaize County Regional
 Planning Commission denotes approval of this plat.
 Signed: _____ Date: _____

Signature by a representative of City with 3 mile limit jurisdiction
 or Twp. Trustees or Village with zoning jurisdiction
 denotes approval of this plat. Signed: _____
 for political S. D. of: _____ Date: _____

Signature by a representative of the County Engineer's Dept.
 denotes that this plat meets tax map plat requirements.
 Signed: _____ Date: _____

DOUGLAS P. REINHART
 6507
 REG. SURVEYOR

Client Don Marshall
 County Auglaize Twp. Union Sec. 35
 Drawn by J. Janart Scale _____ Drwg. No. 83-332
 Checked by _____ Date June 1983
 Sheet 2 of 2 (T 5 S; R 7 E)