

THIS PLAT IS RECORDED IN SURVEY BOOK G, PAGE 150,
AT THE AUGLAIZE COUNTY ENGINEER'S OFFICE.

Note:

NORTHWEST PROPERTY LINES WERE
ESTABLISHED BASED UPON A 1890 SURVEY
BY D. F. CRAW. SURVEY FOUND IN PLAT
BOOK 1125, PAGE 1270 OF THE AUGLAIZE
COUNTY ENGINEER'S OFFICE.

1/2 Sec. Line
STONE FOUND AT
S.W. CORNER, S.E. 1/4,
SECTION 2

N 87° 25' 15" E
24.42'

N 00° 11' 55" E
1014.69'

1027.13'

N 86° 15' 55" E

1041.37'

LOCATION PLAN

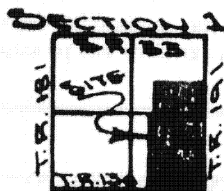

PUSHETA TWP.,
T-6-S, R-6-E,
AUGLAIZE COUNTY,
OHIO

WEST HALF
87.14 ACRES

EAST HALF
87.14 ACRES

N 00° 02' 30" W
2608.46'

LEGEND

8" DIAGONAL SET
R.R. SPIKE SET
STONE FOUND
MONUMENT BOX

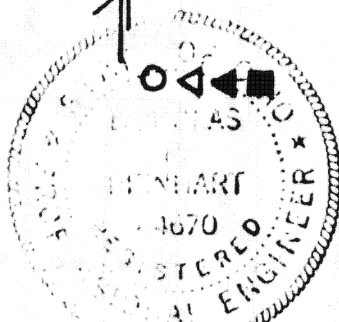

N 00° 00' 00" E
3643.43'

Doug Reinhart
DOUG REINHART
REGISTERED PROFESSIONAL
ENGINEER 14670

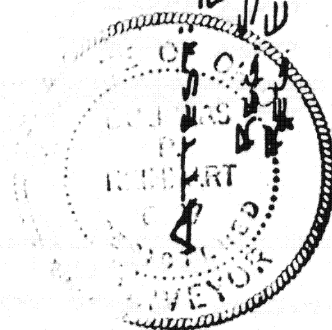

I.P. 60' N
13.00'

1020.17'

2643.92'

ASSUMED BRG. N 00° 00' 00" E

MONUMENT BOX
S.E. CORNER OF
THE S.E. 1/4, SEC. 1

MONUMENT BOX @
S.E. CORNER, SEC. 1

Signature by a representative of the County Health Dept.
denotes compliance with Health Regulations.

Signed: _____ Date: _____

Signature by a representative of the Auglaize County Regional
Planning Commission denotes approval of this plat.

Signed: _____ Date: _____

Signature by a representative of City with 3 mile limit juris-
diction or Twp. Trustees or Village with zoning jurisdiction
denotes approval of this plat. Signed: _____
for political S. D. of: _____ Date: _____

Signature by a representative of the County Engineer's Dept.
denotes that this plat meets tax map plat requirements.

Signed: _____ Date: _____

DOUGLAS P. REINHART
REG. SURVEYOR

Client FISHER SURVEY
County AUGLAIZE Twp. PUSHETA Sec. 1
Drawn by S. SAWERT Scale 1"=400' Drwg. No. 63-345
Checked by _____ Date NOV. 14TH, 1983
Sheet 1 of _____
(T 6 S; R 6 E)

SURVEYORS DESCRIPTION

The following described parcels of ground are part of the East-half of the Section 1, Pusheta Township, Township Six (6) South, Range Six (6) East, Auglaize County, Ohio and are more particularly described as follows:

EAST HALF
87.14 ACRES

Scale: _____

The PLACE OF BEGINNING is a monument box at the Southeast corner of Section 1, Pusheta Township, said box being in the centerline of Township Road # 191 and Township Road # 130; Thence S87°-24'W along the south line of Section 1 and the centerline of Township Road # 130 a distance of 1039.93 feet to a spike;

Thence N00°-00'E through an iron pin at 15.00 feet for a total distance of 3643.43 feet to an iron pin;

Thence N86°-15'-55"E a distance of 1041.37 feet to a P.K. Nail over a stone in the East line of Section 1 and the centerline of T.R. # 191;

Thence S00°-01'W along the east line of Section 1 and the centerline of T.R. # 191 a distance of 1020.17 feet to a monument box at the northeast corner of the Southeast quarter of Section 1;

Thence S00°-00'W along said section line and centerline a distance of 2643.92 feet to a monument box and the PLACE OF BEGINNING.

The above described parcel of ground contains 87.14 Acres and is subject to 2.99 Acres of road right-of-ways. The above described parcel is subject to all easements of record. Survey filed in Plat Book G, Page _____, Auglaize County Engineers Office.

WEST HALF
87.14 ACRES

Commencing at a monument box at the Southeast corner of Section 1, Pusheta Township; said box being in the centerline of Township Road # 130 (Weimert Road); Thence S87°-24'W along the south line of Section 1 and the centerline of T.R. # 130 a distance of 1039.93 feet to a spike and the PLACE OF BEGINNING;

Thence continuing S87°-24'W along said centerline a distance of 1052.07 feet to a spike;

Thence N00°-02'-30"W a distance of 2608.46 feet;

Thence N87°-25'-15"E a distance of 24.42 feet to a 6" steel endpost;

Thence N00°-11'-55"E a distance of 1014.69 feet to a stone found;

Thence N86°-15'-55"E a distance of 1027.13 feet to an iron pin;

Thence S00°-00'W a distance of 3643.43 feet to a spike in the south line of Section 1 and the centerline of T.R. # 130 and the PLACE OF BEGINNING.

The above described parcel contains 87.14 acres and is subject to 0.48 Acres of road right-of-ways. The above described parcel is subject to all easements of record. Survey is filed in Plat Book G, Page _____, Auglaize County Engineers Office.

ATTEST: Doug Reinhart
Doug Reinhart
Professional Surveyor # 6507



Signature by a representative of the County Health Dept. denotes compliance with health regulations. Signed: _____ Date: _____

Signature by a representative of the Auglaize County Regional Planning Commission denotes approval of this plat. Signed: _____ Date: _____

Signature by a representative of City with 3 mile limit jurisdiction or Twp. Trustees or Village with zoning jurisdiction denotes approval of this plat. Signed: _____ Date: _____
for political S. D. of: _____

Signature by a representative of the County Engineer's Dept. denotes that this plat meets tax map plat requirements. Signed: _____ Date: _____

Client Fisher
County Auglaize Twp. Pusheta Sec. 1
Drawn by _____ Scale _____ Drwg. No. 83-345
Checked by _____ Date 11-11-83
Sheet 2 of 2 (T 6 S 1 R 6 E)