

8" Wood Post

SURVEYORS DESCRIPTION

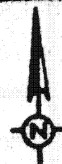

The following described tract of land is part of the southwest quarter of the south east quarter of section 9, T5S, R6E Duchouquet Township, Auglaize County, Ohio, and is more particularly described as follows. Scale: 1"=60'

THE PLACE OF BEGINNING being a monument box over the stone at the southwest corner of the southeast quarter of section 9, Duchouquet Township (monument box and stone being in the center of the Wapakoneta-Buckland Road #180)

Thence N 0° 00' 00"E along the west line of the east half of section 9, Duchouquet Township and (passing through an iron pin set at 20.00 feet) 291.00 feet to an iron pin.

Thence S 89° 09' 42"E 195.00 feet to an iron pin.

Thence S 0° 00' 00"W (passing through an iron pin set at 271.00 feet) 291.00 feet to a railroad spike in the center of the Wapakoneta-Buckland Road #180.

Thence N 89° 09' 42"W along the center of the Wapakoneta-Buckland Road #180 195.00 feet to the monument box over the stone at the southwest corner of the southeast quarter of section 9, Duchouquet Township, which was the PLACE OF BEGINNING.

The above described tract of land contains 1.302 acres more or less subject to all legal easements of record.

N 2366.85

R. Bauer owner

IP S 89° 09' 42"E 195.00' IP

1.302 Acres

N 00° 00' 00"E  
291.00'

291.00'  
S 00° 00' 00"W  
R. Bauer owner

Mon. Box over stone being the SW cor. of the SE 1/4 Sec. 9 Duch.

IP Twp. The P/B.

N 89° 09' 42"W  
195.00'

IP  
200'  
RR5

Bearings determined by Assuming The N.E.S. Half Section Line as being N 00° 00' 00"E.

I.P. - Iron pin

RR5 - Railroad Spike

Deed Ref.

Vol. 238 Pa. 61 Sec. 9, Duch.

Recorded Width of Rd # 180 - 33'

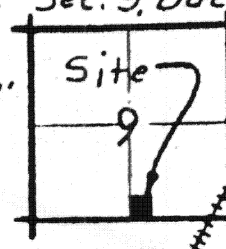

Wapakoneta-Buckland Rd # 180 2457.92'

Signature by a representative of the County Health Dept. notes compliance with Health Regulations. Signed: \_\_\_\_\_ Date: \_\_\_\_\_

Signature by a representative of the Auglaize County Regional Planning Commission denotes approval of this plat. Signed: \_\_\_\_\_ Date: \_\_\_\_\_

Signature by a representative of City with 3 mile limit jurisdiction or Twp. Trustees or Village with zoning jurisdiction notes approval of this plat. Signed: \_\_\_\_\_ Date: \_\_\_\_\_ political S. D. of: \_\_\_\_\_

Signature by a representative of the County Engineer's Dept. denotes that this plat meets tax map plat requirements. Signed: \_\_\_\_\_ Date: \_\_\_\_\_

Botkins Ohio

Richard D. D.

Monier

LS 6470

G-156

By Ron Bauer To Steve Bauer 606 W. State St.

County Auglaize Twp. Duchouquet Sec. 9

Drawn by Jim Emrick Scale 1"=60' Dwg. No. \_\_\_\_\_

Checked by \_\_\_\_\_ Date 11-11-83

Sheet 1 of 1 (T 5 S; R 6 E)