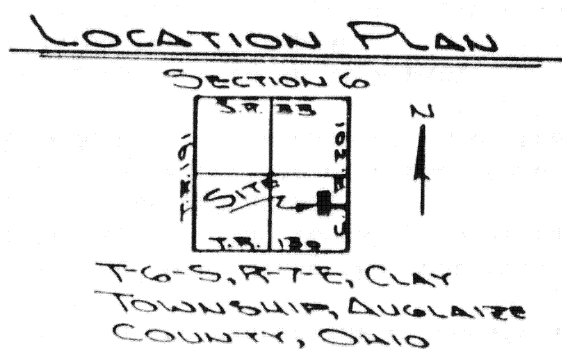
[illegible]

ATTEST: Jack L. McDonald
JACK L. McDONALD
PROFESSIONAL SURVEYOR NO. 6826

N.E. CORNER, S.E. $\frac{1}{4}$
SECTION 6, CLAY
TOWNSHIP

(ASHBURN RD.)
50' B/W

§ COUNTY RD. N° 201 1214.86'
ASSUMED BRG. S. 00° 30' W

Signed: _____ Date _____

Signed: _____ Date _____

for political S. D. of: _____ Date _____

Signed: _____ Date _____

Client WARREN BAILEY
County DUALIZEE Twp. CLAY Sec. 6
Drawn by J. J. Scale 1"=60' Drwg. No. 85-107
Checked by _____ Date FEB 23 1985
Sheet 2 of 2
6431 (T 6 S; R 7 E)

Client WARREN BAILEY
County AUGLAIZE Twp. CLAY Sec. 6
Drawn by J. J. Scale 1"=60' Drwg. No. 85-107
Checked by _____ Date FEB 25 1985
Sheet 2 of 2
6431 (T 6 S; R 7 E)

SURVEYORS DESCRIPTION



Scale: _____

The following described tract of land is part of the Southeast Quarter of Section 6, Clay Township, Town 6 South, Range 7 East, Auglaize County, Ohio and is more particularly described as follows:

Commencing at a monument box at the Northeast corner of the Southeast Quarter of Section 6, Clay Township, and in the centerline of County Road 201 (Ashburn Road);

thence with an assumed bearing of S.00°30'W. along the centerline of County Road 201 and the East line of Section 6, Clay Township, a distance of 1,214.86 feet to a P.K. nail and the PLACE OF BEGINNING;

thence continuing S.00°30'W. along said centerline and the East line of Section 6, Clay Township, a distance of 25.00 feet to a P.K. nail;

thence N.89°52'W. a distance of 822.23 feet to an iron pin;

thence S.00°30'W. a distance of 78.84 feet to an iron pin;

thence N.89°52'W. a distance of 149.80 feet to an iron pin;

thence N.00°30'E. a distance of 295.19 feet to an iron pin;

thence S.89°52'E. a distance of 149.80 feet to an iron pin;

thence S.00°30'W. a distance of 191.35 feet to an iron pin;

thence S.89°52'E. a distance of 822.23 feet to a P.K. nail which was the true PLACE OF BEGINNING.

Containing in all 1.49 acres of which 0.01 acre has been dedicated for highway purposes. The above described tract of land is subject to all legal easements and restrictions, if any, of record or in use on said premises. Previous deed reference: Volume 229, Page 335. This plat is recorded in Survey Book G, Page 431, in the Auglaize County Engineers Office.

DESCRIPTION OF EASEMENT

The following described tract of land is part of the Southeast Quarter of Section 6, Clay Township, Town 6 South, Range 7 East, Auglaize County, Ohio and is more particularly described as follows:

Commencing at a monument box at the Northeast Corner of the Southeast Quarter of Section 6, Clay Township, and in the centerline of County Road 201 (Ashburn Road);

thence with an assumed bearing of S.00°30'W. along the centerline of County Road 201 and the East line of Section 6, Clay Township, a distance of 1,189.86 feet to a point, and the PLACE OF BEGINNING;

thence continuing S.00°30'W. along the centerline of County Road 201 and the East line of Section 6, Clay Township, a distance of 25.00 feet to a P.K. nail;

thence N.89°52'W. a distance of 822.23 feet to an iron pin;

thence N.00°30'E. a distance of 25.00 feet to a point;

thence S.89°52'E. a distance of 822.23 feet to a point, said point being the true PLACE OF BEGINNING.

Containing in all 0.47 acre of which 0.01 acre has been dedicated for highway purposes. The above described tract of land is subject to all legal easements and restrictions, if any, of record or in use on said premises. Previous deed reference: Volume 229, Page 335. This plat is recorded in Survey Book G, Page 431, in the Auglaize County Engineers Office.

ATTEST:

Jack L. McDonald
Jack L. McDonald

Professional Surveyor No. 6826

Signature by a representative of the County Health Dept. denotes compliance with Health Regulations.

Signed: _____ Date: _____

Signature by a representative of the Auglaize County Regional Planning Commission denotes approval of this plat.

Signed: _____ Date: _____

Signature by a representative of City with 3 mile limit jurisdiction or Twp. Trustees or Village with zoning jurisdiction denotes approval of this plat. Signed: _____

for political S. D. of _____ Date: _____

Signature by a representative of the County Engineer's Dept. denotes that this plat meets tax map plat requirements.

Signed: _____ Date: _____

Client Warren Bailey

County Auglaize

Twp Clay

Sec. 6

Drawn by _____

Scale _____

Dwg. No. 25-107

Checked by _____

Date 2/25/85

Sheet 2 of 2

6432

(T 6 S 7 E)

6432