

THIS PLAT IS RECORDED IN SURVEY BOOK G,
PAGE 626, IN THE AUGLAIZE COUNTY ENGINEER'S OFFICE.

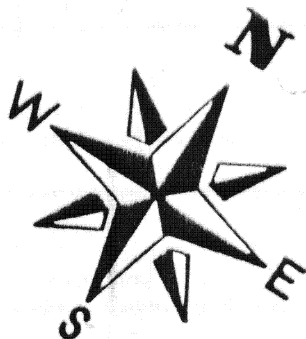

LOCATION PLAN
SECTION 23

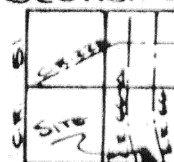

SALEM TOWNSHIP
T-4-S, R-4-E, AUGLAIZE
COUNTY, OHIO

5.00 ACRES
0.17 ACRE 1/2

THE BEARINGS FOR THIS
SURVEY ARE TAKEN FROM
THE MIAMI/ERIE CANAL
PLANS. SEE SHEET 101.

- LEGEND
- --- 5" DIA IRON PIN SET
 - ▲ --- R.R. SPIKE SET
 - --- CANAL MON. FOUND
 - --- IRON PIN FOUND

STATE ROUTE 66
MONUMENT BOX AT
THE S.E. CORNER,
SECTION 23.

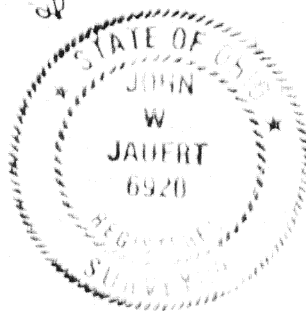

ATTEST: *[Signature]*
JOHN W. JAUBERT
PROFESSIONAL SURVEYOR NO. 6920

Signature by a representative of the County Health Dept.
denotes compliance with Health Regulations.

Signed _____ Date _____

Signature by a representative of the Auglaize County Regional
Planning Commission denotes approval of this plat.

Signed _____ Date _____

Signature by a representative of City with 3 mile limit juris-
diction or Twp. Trustees or Village with zoning jurisdiction
denotes approval of this plat. Signed _____
for political S. D. of _____ Date _____

Signature by a representative of the County Engineer's Dept.
denotes that this plat meets tax map plat requirements.

Signed _____ Date _____

JAUBERT
SURVEYING

Client NEO WUKSTER
County AUGLAIZE Twp. SALEM Sec. 23
Drawn by J. JAUBERT Scale 1"=100' Drwg No. 85-155
Checked by _____ Date Nov. 18th 1985
Sheet 1 of 2 (T A S, R A E)

G-626



SURVEYOR'S DESCRIPTION

Scale: _____

The following described tract of land is part of the Southeast Quarter of the Southeast Quarter of Section 23, Town 4 South, Range 4 East, Salem Township, Auglaize County, Ohio and is more particularly described as follows:

Commencing at a monument box at the Southeast corner of the Southeast Quarter of Section 23, Salem Township;

thence S.87°22'30"W. along the centerline of Township Road 220 (IOOF Road) and the South line of the Southeast Quarter of Section 23, Salem Township a distance of 561.56 feet to a R.R. spike, which is the PLACE OF BEGINNING;

thence continuing S.87°22'30"W. along the centerline of Township Road 220 and the South line of the Southeast Quarter of Section 23, Salem Township a distance of 460.00 feet to a R.R. spike;

thence N.47°42'06"W. along the East property line of the Miami and Erie Canal a distance of 85.88 feet to an iron pin;

thence N.31°45'23"W. along the East property line of the Miami and Erie Canal a distance of 444.80 feet to an iron pin;

thence N.87°22'30"E. a distance of 487.00 feet to an iron pin;

thence S.31°45'23"E. a distance of 514.30 feet to a R.R. spike which was the true PLACE OF BEGINNING.

Containing in all 5.00 acres of which 0.17 acre has been dedicated for highway purposes. The above described tract of land is subject to all legal easements and restrictions, if any, of record or in use on said premises. Previous deed reference: Volume 236, page 3. The above described survey is recorded in Survey Book G, page 626, in the Auglaize County Engineer's Office.



ATTEST:

John W. Jauert
John W. Jauert
Professional Surveyor No. 6920

NOTE:

Bearings for the above survey were taken from the Miami and Erie Canal plans on the State property lines, see sheet 101.

Signature by a representative of the County Health Dept. denotes compliance with Health Regulations.
Signed: _____ Date _____

Signature by a representative of the Auglaize County Regional Planning Commission denotes approval of this plat.
Signed: _____ Date _____

Signature by a representative of City with 3 mile limit jurisdiction or Twp. Trustees or Village with zoning jurisdiction denotes approval of this plat. Signed: _____
for political S. D. of: _____ Date _____

Signature by a representative of the County Engineer's Dept. denotes that this plat meets tax map plat requirements.
Signed: _____ Date _____

Client Ned Wurster
County Auglaize Twp. Salem Sec. 23
Drawn by _____ Scale _____ Drwg. No. 85-155
Checked by _____ Date 11/20/85
Sheet 2 of 2
(T 4 S 4 R 4 E)