

Scale:

1"=100'

10" Wood post

RR Spike @  
NE Cor 1/2 1/2  
SE 1/4 / NE 1/4  
Sec. 34, Moulton  
Twp.

Sec. 34 Moulton  
Twp.

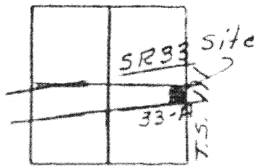

Steven & Tonya Burden  
OR. 38/556

P/B for parcel #2

N 90°00'00"E, 448.30'

Parcel 2  
0.648 Ac.

5/8" Re Rod Set

S 90°00'00"W, 448.19'  
N E

Capped Nail found.

P/B for Parcel #1

Capped Nail Set

existing fence.

Parcel 1  
2.508 Ac

Charles & Sandra  
Comer  
OR 2,686

Capped Nail Set.

Ketterville Road #111  
S 00°00'00"E



R/W Line 7  
400'  
S 80°24'00"W, 202.78'  
Capped Nail Set  
E of County Road 33-A

Parcel 1 & 2 Taken from  
Deed Vol. 137, p. 508,

Signature by a representative of the County Health Dept.  
denotes compliance with Health Regulations.  
Signed: \_\_\_\_\_ Date: \_\_\_\_\_

Signature by a representative of the Auglaize County Regional  
Planning Commission denotes approval of this plat.  
Signed: \_\_\_\_\_ Date: \_\_\_\_\_

Signature by a representative of City with 3 mile limit juris-  
diction or Twp. Trustees or Village with zoning jurisdiction  
denotes approval of this plat. Signed: \_\_\_\_\_  
for political S. D. of: \_\_\_\_\_ Date: \_\_\_\_\_

Signature by a representative of the County Engineer's Dept.  
denotes that this plat meets tax map plat requirements.  
Signed: \_\_\_\_\_ Date: \_\_\_\_\_

*Richard D. Morrissey*  
LS 6470

Client Frank & Althea Goodwin  
County Auglaize Twp. Moulton Sec. 34  
Drawn by 4WE Scale 1"=100' Drwg. No. \_\_\_\_\_  
Checked by \_\_\_\_\_ Date 11-14-86  
Sheet 1 of 2 H-39 (T 5 S; R 5 E)

DESCRIPTION  
PARCEL NO. 1

Being a parcel of land situate in the east half of Section 34, T-5-S, R-5-E, Moulton Township, Auglaize County, Ohio and more particularly described as follows:

Commencing at the northeast corner of the south half of the southeast quarter of the Northeast quarter of said Section 34, T-5-S, R-5-E; thence S 00°00'00" E with the centerline of Kettlersville Road (C.R. #111), 570.93 feet to a PK nail set and the PLACE OF BEGINNING thence continuing S 00°00'00" E with said centerline, 67.00 feet to a PK nail set; thence S 80°24'00" W parallel with the centerline of County Road 33-A, 251.00 feet to a 5/8" rebar set; thence S 00°00'00" E, 311.00 feet to a PK nail set on the centerline of said County Road 33-A; thence S 80°24'00" W with said centerline of said County Road 33-A, 202.78 feet to a PK nail set; thence N 00°05'50" W, 453.68 feet to a 5/8" rebar set; thence N 90°00'00" E (passing through a 5/8" rebar set at 428.19 feet), 448.19 feet to the PLACE OF BEGINNING containing 2.508 acres more or less and subject to all highways and other legal easements of record.

DESCRIPTION  
PARCEL NO. 2

Being a parcel of land situate in the east half of Section 34, T-5-S, R-5-E, Moulton Township, Auglaize County, Ohio and more particularly described as follows:

Commencing at the northeast corner of the south half of the southeast quarter of the Northeast quarter of said Section 34, T-5-S, R-5-E; thence S 00°00'00" E with the centerline of Kettlersville Road (C.R. #111), 508.00 feet to a PK nail set and the PLACE OF BEGINNING thence continuing S 00°00'00" E with said centerline, 62.93 feet to a PK nail set; thence S 90°00'00" W (passing through a 5/8" rebar set at 20.00 feet), 448.19 feet to a 5/8" rebar set; thence N 00°05'50" W, 62.93 feet to the southwest corner of a parcel of land described in O.R. Vol. 38, Page 556 in the Auglaize County Recorder's Office; thence N 90°00'00" E with the south line of said parcel, 448.30 feet to the PLACE OF BEGINNING containing 0.648 acre more or less and subject to all highways and other legal easements of record.

Signature by a representative of the County Health Dept.  
denotes compliance with Health Regulations.  
Signed: \_\_\_\_\_ Date: \_\_\_\_\_

Signature by a representative of the Auglaize County Regional  
Planning Commission denotes approval of this plat.  
Signed: \_\_\_\_\_ Date: \_\_\_\_\_

Signature by a representative of City with 3 mile limit juris-  
diction or Twp. Trustees or Village with zoning jurisdiction  
denotes approval of this plat. Signed: \_\_\_\_\_  
for political S. D. of: \_\_\_\_\_ Date: \_\_\_\_\_

Signature by a representative of the County Engineer's Dept.  
denotes that this plat meets tax map plat requirements.  
Signed: \_\_\_\_\_ Date: \_\_\_\_\_

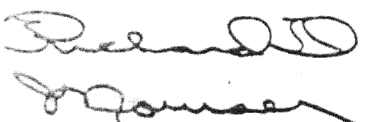
  
LS 6470

Client Frank & Althea Goodwin  
County Auglaize Twp. Moulton Sec. 34  
Drawn by AWE Scale 1"=100' Drwg. No. \_\_\_\_\_  
Checked by \_\_\_\_\_ Date 11-14-86  
Sheet 2 of 2 H-40 (T 5 S; R 5 E)