

The following Surveyor's description contains 12.705 Acres of which 0.753 is designated as right-of-way purposes, and is subject to all legal easements or restrictions of record.

SURVEYOR'S DESCRIPTION

The following described tract of land is part of the Northwest Quarter of the Southwest Quarter of Section 32, Moulton Township, Town 5 South, Range 5 east, Auglaize County, Ohio, and is more particularly described by the following Meets and Bounds description;

Commencing at a Railroad spike located at the Southwest Corner of Section 32, Moulton Township, Town 5 South, Range 5 East, Auglaize County, Ohio;
thence with a bearing of N. 02°-05'-35" E. along the West line of Southwest Quarter of said Section for a distance of 1,321.22 feet to a P.K. Nail and the PLACE OF BEGINNING;
thence continuing with a bearing of N. 02°-05'-35" E. along the West line of the Southwest Quarter of said section for a distance of 333.05 feet to a P.K. Nail;
thence with a bearing of N. 82°-23'-59" E. for a distance of 413.14 feet to a State Reference Point, and passing thru a point on the limited access right-of-way line at 111.59';
thence with a bearing of N. 84°-07'-05" E. for a distance of 500.00 feet to a State Reference Point;
thence with a bearing of N. 84°-58'-39" E. for a distance of 420.64 feet to an iron pin
thence with a bearing of S. 01°-51'-11" W. along the East line of the Northwest Quarter of the Southwest Quarter of said Section for a distance of 491.81 feet to an iron pin;
thence with a bearing of N. 89°-18'-21" W. along the South line of the Northwest Quarter of the Southwest quarter of said Section for a distance of 1,322.26 feet to a P.K. Nail, and passing thru an iron pin set on the R/W Line of T.R. # 81 at 1,247.98 feet, said P.K. Nail being the true PLACE OF BEGINNING.

Signature by a representative of the County Health Dept. denotes compliance with Health Regulations.
Signed: _____ Date _____

Signature by a representative of the Auglaize County Regional Planning Commission denotes approval of this plat.
Signed: _____ Date _____

Signature by a representative of City with 3 mile limit jurisdiction or Township with zoning jurisdiction denotes approval for political purposes.
Signed: _____ Date _____

Signature by a representative of the County Engineer's Dept. denotes that this plat meets tax map plat requirements.
Signed: _____ Date _____

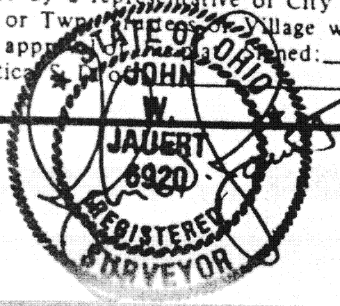

Client BILL LININGER
County AUGLAIZE Twp. MOULTON Sec. 32
Drawn by K. SCHNELL Scale 1"=200' Drwg. No. 87-2A9
Checked by JOHN JAVERT Date JAN. 28th, 1987
Sheet 1 of 1 H-65 (T 5 S; R 5 E)