

S.E. CORNER, N.W. 1/4, SEC. 9, UNION TWP.

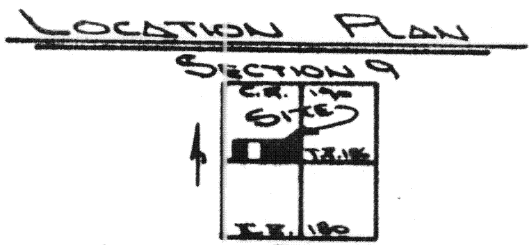
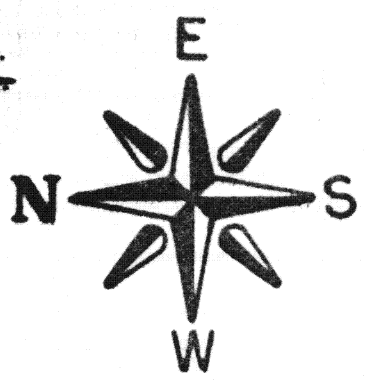

UNION TOWNSHIP, T-5-S, R-7-E, AUGLAIZE COUNTY, OHIO

LEGEND

- IRON PIN SET
- IRON PIN FOUND
- △ R.R. SPIKE SET
- ▲ R.R. SPIKE FOUND
- MONUMENT BOX

THIS PLAT IS RECORDED IN SURVEY BOOK "11", PAGE 84, IN THE AUGLAIZE COUNTY ENGINEER'S OFFICE.

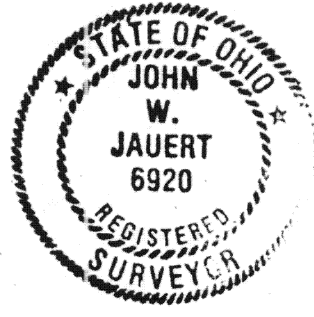

ATTEST: *[Signature]*  
**JOHN W. JAUERT**  
 PROFESSIONAL SURVEYOR N#6920

Signature by a representative of the County Health Dept. denotes compliance with Health Regulations.  
 Signed: \_\_\_\_\_ Date \_\_\_\_\_

Signature by a representative of the Auglaize County Regional Planning Commission denotes approval of this plat.  
 Signed: \_\_\_\_\_ Date \_\_\_\_\_

Signature by a representative of City with 3 mile limit jurisdiction or Twp. Trustees or Village with zoning jurisdiction denotes approval of this plat. Signed: \_\_\_\_\_ Date \_\_\_\_\_  
 for political S. D. of: \_\_\_\_\_

Signature by a representative of the County Engineer's Dept. denotes that this plat meets tax map plat requirements.  
 Signed: \_\_\_\_\_ Date \_\_\_\_\_

**JAUERT SURVEYING**

Client JOHN NIXON  
 County AUGLAIZE Twp. UNION Sec. 9  
 Drawn by J. JAUERT Scale 1"=200' Drwg. No. B7-262  
 Checked by \_\_\_\_\_ Date MARCH, 1987  
 Sheet 1 of 3 H-84 (T 5 S, R 7 E)



SURVEYOR'S DESCRIPTION FOR PARCEL "A"

Scale: \_\_\_\_\_

The following described tract of land is part of the South half of the Northwest Quarter of Section 9, Town 5 South, Range 7 East, Union Township, Auglaize County, Ohio, and is more particularly described as follows:

The PLACE OF BEGINNING is at a monument box at the Southeast corner of the Northwest Quarter of Section 9, Union Township and in the centerline of Township Road 186 (Miller Road);

thence S.89°30'43"W. along the centerline of Township Road 186 and the South line of the Northwest Quarter of Section 9, Union Township, a distance of 1,363.09 feet to a R.R. spike found;

thence N.00°21'29"W. along the existing Newport property line, a distance of 509.84 feet to an iron pin;

thence N.89°25'03"E. a distance of 1,366.53 feet to an iron pin in the East line of the Northwest Quarter of Section 9, Union Township, thru an existing end post at 1,364.1 feet;

thence S.00°01'32"W. along the East line of the Northwest Quarter of Section 9, Union Township, a distance of 512.11 feet to a monument box at the Southeast Corner of the Northwest Quarter of Section 9, Union Township and in the centerline of Township Road 186, said monument box was the true PLACE OF BEGINNING for the above described tract of land.

Containing in all 16.009 acres of which 0.516 acre has been dedicated for highway purposes. The above described tract of land is subject to all legal easements, restrictions and reservations, if any, of record or in use on said premises. Previous deed reference: Volume 231, page 167. This survey is recorded in Survey Book "H", page 84, in the Auglaize County Engineer's Office.



ATTEST:

John W. Jauert  
John W. Jauert  
Professional Surveyor No. 6920

Signature by a representative of the County Health Dept.  
denotes compliance with Health Regulations.  
Signed: \_\_\_\_\_ Date: \_\_\_\_\_

Signature by a representative of the Auglaize County Regional  
Planning Commission denotes approval of this plat.  
Signed: \_\_\_\_\_ Date: \_\_\_\_\_

Signature by a representative of City with 3 mile limit juris-  
diction or Twp. Trustees or Village with zoning jurisdiction  
denotes approval of this plat. Signed: \_\_\_\_\_  
for political S. D. of: \_\_\_\_\_ Date: \_\_\_\_\_

Signature by a representative of the County Engineer's Dept.  
denotes that this plat meets tax map plat requirements.  
Signed: \_\_\_\_\_ Date: \_\_\_\_\_

Client John Nixon  
County Auglaize Twp. Union Sec. 9  
Drawn by \_\_\_\_\_ Scale \_\_\_\_\_ Drwg. No. 87-262  
Checked by \_\_\_\_\_ Date March, 1987  
Sheet 2 of 3 11-85 (T.5 S. R.7 E)



Scale: \_\_\_\_\_

SURVEYOR'S DESCRIPTION FOR PARCEL "B"

The following described tract of land is part of the South half of the Northwest Quarter of Section 9, Town 5 South, Range 7 East, Union Township, Auglaize County, Ohio, and is more particularly described as follows:

Commencing at a monument box at the Southwest corner of the Northwest Quarter of Section 9, Union Township and in the centerline of Township Road 186 (Miller Road);

thence S.89°30'43"W. along the centerline of Township Road 186 and the South line of the Northwest Quarter of Section 9, Union Township, a distance of 264.00 feet to a R.R. spike and the PLACE OF BEGINNING;

thence N.00°06'52"E., parallel to the West line of the Northwest Quarter of Section 9, Union Township, a distance of 508.16 feet to an iron pin;

thence N.89°25'03"E. a distance of 379.57 feet to an iron pin;

thence S.00°25'25"E. along the existing West line of the Newport property a distance of 508.75 feet to a R.R. spike found;

thence S.89°30'43"W. along the centerline of Township Road 186 and the South line of the Northwest Quarter of Section 9, Union Township, a distance of 384.34 feet to a R.R. spike which was the true PLACE OF BEGINNING.

Containing in all 4.458 acres of which 0.145 acre has been dedicated for highway purposes. The above described tract of land is subject to all legal easements, restrictions and reservations, if any, of record or in use on said premises. Previous deed reference: Volume 231, page 167. This survey is recorded in Survey Book "H", page 84, in the Auglaize County Engineer's Office.

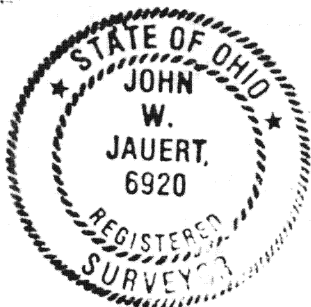

ATTEST:

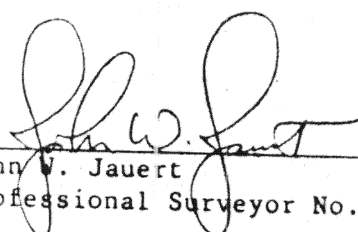
  
John W. Jauert  
Professional Surveyor No. 6920

Signature by a representative of the County Health Dept.  
denotes compliance with Health Regulations.

Signed: \_\_\_\_\_ Date: \_\_\_\_\_

Signature by a representative of the Auglaize County Regional  
Planning Commission denotes approval of this plat.

Signed: \_\_\_\_\_ Date: \_\_\_\_\_

Signature by a representative of City with 3 mile limit juris-  
diction or Twp. Trustees or Village with zoning jurisdiction  
denotes approval of this plat. Signed: \_\_\_\_\_

Date: \_\_\_\_\_

Signature by a representative of the County Engineer's Dept.  
denotes that this plat meets tax map plat requirements.

Signed: \_\_\_\_\_ Date: \_\_\_\_\_

Client John Nixon

County Auglaize Twp. Union Sec. 9

Drawn by \_\_\_\_\_ Scale \_\_\_\_\_ Drwg. No. 87-262

Checked by \_\_\_\_\_ Date March, 1987

Sheet 3 of 3

H-86 (T 6 S; R 7 E)