

PART OF SOUTHEAST QUARTER  
OF SECTION 4  
GOSHEN TOWNSHIP

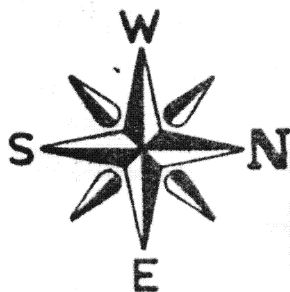

S.W. CORNER,  
S.E. QUARTER,  
SECTION 4  
GOSHEN TWP.

WEST LINE  
OF THE  
S.E. QUARTER

LOCATION PLAN

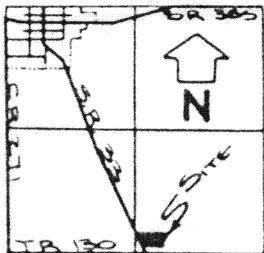

SECTION 4  
GOSHEN TWP.

LEGEND

- IRON PIN SET
- IRON PIN FOUND
- △ P.K. NAIL SET
- MONUMENT BOX
- R/W MONUMENT FD
- WOOD HUB FD.

CURVE DATA

Δ : 5°44'  
D : 2°00'  
R : 2864.93'  
T : 143.46'  
L : 286.66'

5.216 ACRES  
(0.325 AC. R/W)

ATTEST:

JOHN W. JAUERT  
REG. SURVEYOR  
NO. 6920

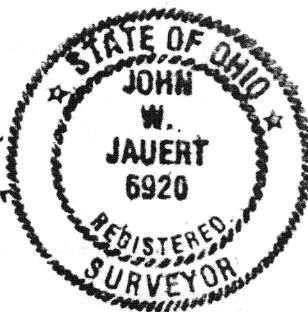

S 01° 03' 49" E  
477.33'

NOTE: BEARINGS BASED UPON A SURVEY  
ADJACENT TO THIS TRACT PERFORMED  
BY LES GEESUN, REG SURVEYOR #5248

THIS SURVEY IS RECORDED IN SURVEY BOOK "H", PAGE 128, IN THE  
AUGLAIZE COUNTY ENGINEER'S OFFICE.

Signature by a representative of the County Health Dept.  
denotes compliance with Health Regulations.  
Signed: \_\_\_\_\_ Date: \_\_\_\_\_

Signature by a representative of the Auglaize County Regional  
Planning Commission denotes approval of this plat.  
Signed: \_\_\_\_\_ Date: \_\_\_\_\_

Signature by a representative of City with 3 mile limit juris-  
diction or Twp. Trustees or Village with zoning jurisdiction  
denotes approval of this plat. Signed: \_\_\_\_\_  
for political S. D. or: \_\_\_\_\_ Date: \_\_\_\_\_

Signature by a representative of the County Engineer's Dept.  
denotes that this plat meets tax map plat requirements.  
Signed: \_\_\_\_\_ Date: \_\_\_\_\_

Jauert



Surveying  
AND LAND CONSULTING

RT. 3 BOX 449 WAPAKONETA, OHIO 45895  
Ph. 419.738.8962

Client: FRANK WILSON  
County: AUGLAIZE Twp. GOSHEN Sec. 4  
Drawn by: K. SCHNELL Scale: AS SHOWN Drwg. No. 87-286  
Checked by: JOHN JAUERT Date: 7-10-87  
Sheet 1 of 2 H-128 (T. 6 S; R. 8 E)



SURVEYOR'S DESCRIPTION

Scale: \_\_\_\_\_

The following described tract of land is situate in the Southeast Quarter of Section Four (4) Goshen Township, Town Five South, Range Eight East, Auglaize County, Ohio, and is more particularly described as follows;

Commencing at an Auglaize County Monument Box located at the Southwest corner of the Southeast Quarter of Section Four (4) Goshen Township, Town Five South, Range Eight East, Auglaize County, Ohio;

thence with a bearing of N. 88°-00'-00" E. along the South line of the Southeast Quarter of said Section, and along the centerline of Goshen Road, Township Road Number 130, for a distance of 272.00 feet to a point located at the intersection of the centerline of said Goshen Road and the centerline of State Route Number Thirty-three (S.R. 33);

thence with a bearing of N. 21°-31'-16" W. along the centerline of S.R. 33 for a distance of 246.07 feet to a P.K. Nail and the PLACE OF BEGINNING;

thence continuing with a bearing of N. 21°-31'-06" W. along the centerline of S.R. 33 for a distance of 116.97 feet to a point, said point being the P.C. of a curve to the left;

thence with a bearing of N. 24°-23'-06" W. along the Chord of a curve for a distance of 286.56 feet to a point, said point being the P.T. of the curve. Curve Data:  $\Delta = 5^{\circ}-44'-00''$ ;  $D = 2^{\circ}-00'-00''$ ;  $R = 2864.93$  feet;  $T = 143.46$  feet; and  $L = 286.66$  feet;

thence with a bearing of N. 27°-15'-06" W. along the centerline of S.R. 33 for a distance of 66.90 feet to a P.K. Nail;

thence with a bearing of N. 88°-03'-44" E. for a distance of 599.19 feet to an iron pin, and passing thru an iron pin on the East right-of-way line of S.R. 33 at a distance of 33.19 feet;

thence with a bearing of S. 01°-03'-49" E. for a distance of 477.33 feet to an iron pin located in a ditch;

thence with a bearing of N. 86°-11'-18" W. following the course of said ditch for a distance of 416.78 feet to a P.K. Nail, and passing thru a tacked hub on the East right-of-way line of S.R. 33 at a distance of 383.59 feet, said P.K. Nail being the true PLACE OF BEGINNING.

The above described tract of land contains in all 5.216 Acres, of which, 0.325 Acre being previously dedicated for highway purposes. This tract of land is subject to all legal easements, reservations, and/or restrictions, if any, upon said premises. Previous Deed References for this tract of land are as follows: Deed Volume 259, Page 720, located in the Auglaize County Recorder's Office. This description is recorded in survey Book "4", Page 128, in the Auglaize County Engineer's Office. This description was prepared by John W. Jauert, Professional Surveyor Number 6920.

ATTEST:

*John W. Jauert*  
John W. Jauert  
Reg. Surveyor # 6920

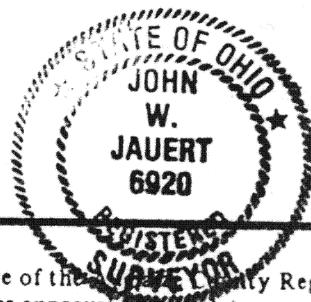

Signature by a representative of the County Health Dept. denotes compliance with Health Regulations.

Signed: \_\_\_\_\_ Date: \_\_\_\_\_

Signature by a representative of the \_\_\_\_\_ County Regional Planning Commission denotes approval of this plat.

Signed: \_\_\_\_\_ Date: \_\_\_\_\_

Signature by a representative of City with 3 mile limit jurisdiction or Twp. Trustees or Village with zoning jurisdiction denotes approval of this plat. Signed: \_\_\_\_\_

for political S. D. of: \_\_\_\_\_ Date: \_\_\_\_\_

Signature by a representative of the County Engineer's Dept. denotes that this plat meets tax map plat requirements.

Signed: \_\_\_\_\_ Date: \_\_\_\_\_

**JAUERT  
SURVEYING**

Client FRANK ULREY  
County Auglaize Twp. Goshen Sec. 4  
Drawn by Kevin Schnell Scale \_\_\_\_\_ Drwg. No. 87-286  
Checked by John W. Jauert Date 7/11/87  
Sheet 2 of 2 H-129 (T 5 S; R 8 E)