

EASEMENT FOR WAPAKONETA TELEPHONE SERVICE

Part of the Northwest Quarter of Section 34,  
Duchouquet Township, T-5-S, R-6-E, Auglaize County, Ohio

Charles L. Kantner  
Deed Volume 248, Page 380

N. 89°-10'-40" W. 960.00'

10.00'

LEGEND

- Auglaize County Monument Box located at the Southwest corner of the Northwest Quarter of Section 34, Duchouquet Twp.

LOCATION PLAN

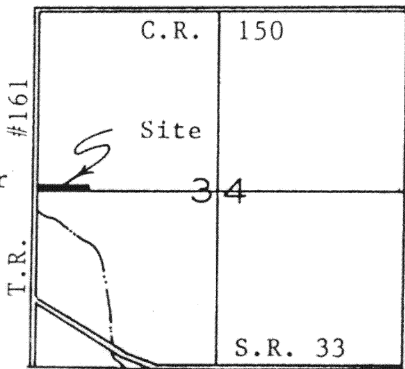

SECTION 34, DUCHOUQUET TWP.  
AUGLAIZE COUNTY, OHIO

SURVEYOR'S DESCRIPTION

Being a permanent easement which will occupy a strip of land, ten (10) feet in width, lying North of and adjacent to the following described line;

Commencing at an Auglaize County Monument Box located at the Southwest corner of the Northwest Quarter of Section 34, Town Five (5) South, Range Six (6) East, Duchouquet Township, Auglaize County, Ohio;

thence with a bearing of N. 89°-10'-40" W. along the South line of the tract of land as described in Auglaize County Deed Volume 248, Page 380, for a distance of 960.00 feet to a Point and there to terminate.



ATTEST: *[Signature]*  
John W. Jauert  
Professional Surveyor  
No. 6920

This Plat and Description is Recorded in Survey Book "H", Page 161, Auglaize County Eng. Office

Signature by a representative of the County Health Dept. denotes compliance with Health Regulations. Signed: _____ Date _____	Signature by a representative of the Auglaize County Regional Planning Commission denotes approval of this plat. Signed: _____ Date _____
Signature by a representative of City with 3 mile limit jurisdiction or Twp. Trustees or Village with zoning jurisdiction denotes approval of this plat. Signed: _____ for political S. D. of: _____ Date _____	Signature by a representative of the County Engineer's Dept. denotes that this plat meets tax map plat requirements. Signed: _____ Date _____

JAUERT  
SURVEYING

Client Wapakoneta Telephone Service  
County Auglaize Twp. Duchouquet Sec. 34  
Drawn by Kevin Schnell Scale None Drwg. No. 87-311  
Checked by John Jauert Date Oct-9-87  
Sheet 1 of 1 H-161 (T 5 S: R 6 E)