

SCHWIETERMAN SURVEY

Part of the West 1/3rd of "LOGAN'S SECTION", LOGAN TOWNSHIP
Township 4 South, Range 5 East, Auglaize County, Ohio



Wood end post found at the
Northeast corner of the
West 1/3 of Logan's Section

S. 00°-35'-54" W.
1,683.25'

S. 00°-35'-54" W.
292.64'

S. 00°-35'-54" W.
1,997.49'

Iron pin fd.
3.27' from
true property
line

Iron pin fd.
1.71' from
true property
line

N. 80°-30'-48" E.
S. 432.63'

TRACT 2

TRACT 1

N. 52°-45'-55" E.
S. 99.85'

N. 68°-27'-55" E.
S. 381.86'

N. 49°-30'-15" W.
S. 32.98'

S. 29°-31'-05" E.
N. 115.61'

N. 69°-30'-15" W.
S. 760.95'

N. 64°-14'-33" E.
S. 54.63'

N. 22°-58'-07" W.
S. 169.21'

S. 82°-16'-51" E.
N. 141.86'

Curve Data
 $\Delta = 26^{\circ}-32'-00''$
 $R = 954.93'$
 $L = 442.26'$
 $D_c = 6^{\circ}-00'$
Chord = N. 35°-14'-10" W.
Chord length = 43d.32'

Curve Data
 $\Delta = 59^{\circ}-18'-44''$
 $R = 266.49'$
 $L = 275.87'$
 $D_c = 21^{\circ}-30'$
Chord = N. 52°-37'-29" W.
Chord length = 263.72

Curve Data
 $\Delta = 27^{\circ}-23'-32''$
 $R = 572.96'$
 $L = 273.92'$
 $D_c = 10^{\circ}-00'$
Chord = N. 35°-48'-30" W.
Chord length = 271.32'

LEGEND

- Iron Pin Found
- Concrete Monument
- Wood End Post

SCALE

1" = 200'



ATTEST:
John W. Jauert
Professional Surveyor
No. 6920

NOTE: Bearings were based upon the centerline survey
as performed by the Ohio Department of
Transportation for State Route #198,
project #Aug-198-8.19, Sept. 1966,
Carl E. Keyser Reg. Surveyor #3783

North Line of "LOGAN'S SECTION"

Centerline of existing State Route #198

Right-of-way Line

Place Road

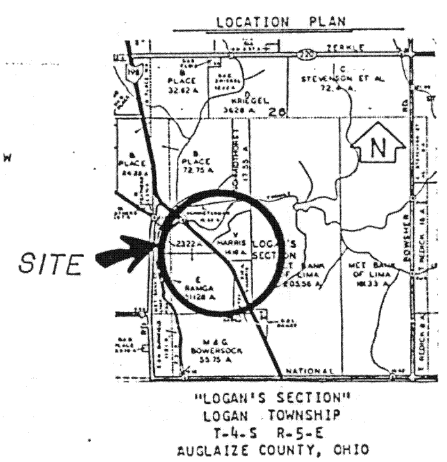

TRACT 1	15.223 Ac.	0.712 Ac. R/W
TRACT 2	20.592 Ac.	1.589 Ac. R/W
TOTAL:	35.815 Ac.	2.301 Ac. R/W

TOLERANCES		REVISIONS		SCHWIETERMAN SURVEY	
EXCEPT AS NOTED	NO.	DATE	BY	LOGAN'S SECTION	
DECIMAL	1				
FRACTIONAL	2				
ANGULAR	3			DRAWN BY K. Schnell	SCALE 1"=200'
	4			J.W. Jauert	DATE May 1988
	5			TRACED	DRAWING NO. # 268

952 H 256



SCHWIETERMEN SURVEY

TRACT NO. 1

The following described tract of land is part of the West 1/3rd of the "Logan's Section", Section 26, Town 4 South, Range 5 East, Logan Township, Auglaize County, Ohio and is more particularly described as follows:

Commencing at a wooden corner post found at the Northeast corner of the West 1/3rd of the Logan's Section;

thence S.00°35'54"W. a distance of 1,683.25 feet to a point being referenced by an iron pin found at S.80°42'47"W., a distance of 3.27 feet, said point is the PLACE OF BEGINNING for the tract of land herein described;

thence continuing S.00°35'54"W. a distance of 292.64 feet to a point being referenced by an iron pin found at S.80°30'48"W., a distance of 1.71 feet;

thence S.80°30'48"W. a distance of 432.63 feet to an iron pin found as called for on a survey plat (No. 74-5813) by Stimmel & Associates, passing thru an iron pin found at 1.71 feet;

thence S.38°32'42"W. a distance of 281.62 feet to an iron pin found;

thence S.52°45'55"W. a distance of 99.85 feet to an iron pin found;

thence S.29°31'05"E. a distance of 115.61 feet to an iron pin found;

thence S.68°27'55"W. a distance of 381.86 feet to a State Highway Right-of-way monument;

thence S.64°14'33"W. a distance of 54.63 feet to a point in the old centerline of State Route 198;

thence N.49°30'15"W., along the old centerline of State Route 198, a distance of 32.98 feet to the P.C. of a curve having the following data: $\Delta = 26^\circ 32' 08''$ rt.; $R = 954.93$ feet; $l = 442.26$ feet; $Dc = 6^\circ$;

thence along a curve to the right, with a radius of 954.93 feet, whose chord bears N.36°14'10"W. a chord distance of 438.32 feet, to the P.T.;

thence N.22°58'07"W., along the old centerline of State Route 198, a distance of 169.21 feet to the P.C. of a curve having the following data: $\Delta = 59^\circ 18' 44''$ lt.; $R = 266.49$ feet; $l = 275.87$ feet; $Dc = 21^\circ 30'$;

thence along a curve to the left, with a radius of 266.49 feet, whose chord bears N.52°37'29"W. a chord distance of 263.72 feet to a point;

thence S.82°16'51"E. a distance of 141.86 feet to an iron pin found;

thence N.80°42'47"E. a distance of 1,470.67 feet to a point, passing thru an iron pin found at 1,467.40 feet, said point was the true PLACE OF BEGINNING for this tract of land;

Containing in all 15.223 acre of which 0.712 acre has been dedicated for highway purposes. The above described tract of land is subject to all legal easements, restrictions and reservations, if any, of record or in use on said premises. Previous deed reference: Volume O.R. 10, page 721. This plat is recorded in Survey Book "H", page 256, in the Auglaize County Engineer's Office. Bearings for this survey were based on the centerline survey as performed by the Ohio Department of Transportation for State Route 198, project No. AUG - 198 - 8.19, Sept. 1966.

ATTEST:

John W. Jauert
John W. Jauert

Professional Surveyor No. 6920

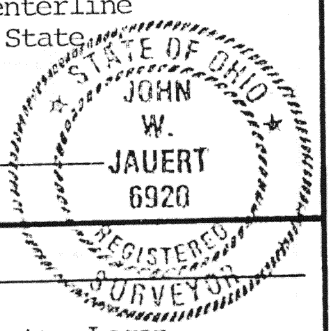

Jauert
ASSOCIATES

Surveying

AND LAND CONSULTING

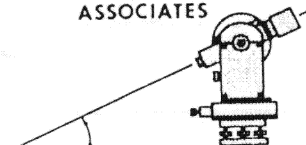

RT.3 BOX 449 WAPAKONETA, OHIO 45895
PH. (419) 738-8962

Client Schwieterman

County Auglaize Township Logan

Section 26 T. 4 S., R. 5 E. Drwg. No. 88-368

Drawn By _____ Date June, 88

Scale _____ Sheet 2 of 3

4-257



SCHWIETERMAN SURVEY

TRACT NO. 2

The following described tract of land is part of the West 1/3rd of the "Logan's Section", Section 26, Town 4 South, Range 5 East, Logan Township, Auglaize County, Ohio and is more particularly described as follows:

Commencing at a wooden corner post found at the Northeast corner of the West 1/3 of the Logan's Section;

thence S.00°35'54"W. a distance of 1,975.89 feet to a point being referenced by an iron pin found at S.80°30'48"W., a distance of 1.71 feet, said point is the PLACE OF BEGINNING for the tract of land herein described;

thence continuing S.00°35'54"W. a distance of 1,997.49 feet to a point in the old centerline of State Route 198;

thence N.22°06'43"W., along the old centerline of State Route 198, a distance of 719.62 feet to the P.C. of a curve having the following data: $\Delta = 27^{\circ}23'32''$ lt.; $R = 572.96'$; $l = 273.92'$ & $Dc = 10^{\circ}$;

thence along a curve to the left, with a radius of 572.96 feet, whose chord bears N.35°48'30"W. a chord distance of 271.32 feet, to the P.T.;

thence N.49°30'15"W., along the old centerline of State Route 198, a distance of 760.95 feet to a point;

thence N.64°14'43"E. a distance of 54.63 feet to a State Highway Right-of-way monument;

thence N.68°27'55"E. a distance of 381.86 feet to an iron pin found as called for on a survey plat (No. 74-5813) by Stimmel & Associates;

thence N.29°31'05"W. a distance of 115.61 feet to an iron pin found;

thence N.52°45'55"E. a distance of 99.85 feet to an iron pin found;

thence N.38°32'42"E. a distance of 281.62 feet to an iron pin found;

thence N.80°30'48"E. a distance of 432.63 feet to a point, passing thru an iron pin found at 430.92 feet, said point was the true PLACE OF BEGINNING.

Containing in all 20.592 Acre of which 1.589 acre has been dedicated for highway purposes. The above described tract of land is subject to all legal easements, restrictions and reservations, if any, of record or in use on said premises. Previous deed reference: Volume 171, page 140. This plat is recorded in Survey Book "H", page 256, in the Auglaize County Engineer's Office. Bearings for this survey were based on the centerline survey as performed by the Ohio Department of Transportation for State Route 198, project No. AUG - 198 - 8.19, Sept. 1966.

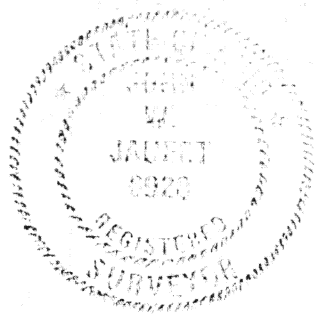

ATTEST:

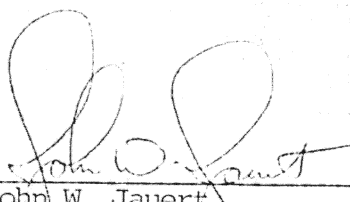
John W. Jauert
Professional Surveyor No. 6920

Janert
ASSOCIATES

 **Surveying**
AND LAND CONSULTING

RT.3 BOX 449 WAPAKONETA, OHIO 45895
PH. (419) 738-8962

#258

Client Schwieterman

County Auglaize Township Logan

Section 26 T. 4 S., R. 5 E. Drwg. No. 88-368

Drawn By _____ Date June, 1988

Scale _____ Sheet 3 of 3