

GERMAN TOWNSHIP
T-7-S, R-4-E, AUGLAIZE
COUNTY, OHIO.

LEGEND

- IRON PIN SET
- △ R.R. SPIKE SET
- WOOD CORNER POST
- MONUMENT BOX

The following described tract of land is part of the Southeast Quarter of Section 4, Town 7 South, Range 4 East, German Township, Auglaize County, Ohio and is more particularly described as follows:

The PLACE OF BEGINNING is at a monument box at the Southwest corner of the Southeast Quarter of Section 4, German Township and in the centerline of County Road 70 (Lock Two Road);
thence N.01°06'55"W. along the West line of the Southeast Quarter of Section 4, German Township, a distance of 1,334.68 feet to a point;
thence N.89°27'26"E. a distance of 1,330.92 feet to a point;
thence S.00°58'16"E. a distance of 6.23 feet to a wood corner post;
thence S.89°17'27"W. a distance of 1,310.46 feet to a wood corner post;
thence S.42°20'40"W. a distance of 11.37 feet to a wood corner post;
thence S.01°05'55"E. a distance of 1,316.32 feet to a R.R. spike set in the the centerline of County Road 70 and the South line of the Southeast Quarter of Section 4, German Township;
thence S.89°27'30"W. along the centerline of County Road 70 and the South line of the Southeast Quarter of Section 4, German Township, a distance of 12.00 feet to a monument box at the Southwest corner of the Southeast Quarter of Section 4, German Township, said monument box was the true PLACE OF BEGINNING.

Containing in all 0.639 acre of which 0.006 acre has been dedicated for highway purposes. The above described tract of land is subject to all legal easements, restrictions and reservations, if any, of record or in use on said premises. Previous Deed reference: Volume 238, page 428. This plat is recorded in Survey Book "H", page 262, in the Auglaize County Engineer's Office.



ATTEST:
John W. Jauert
Professional Surveyor No. 6920

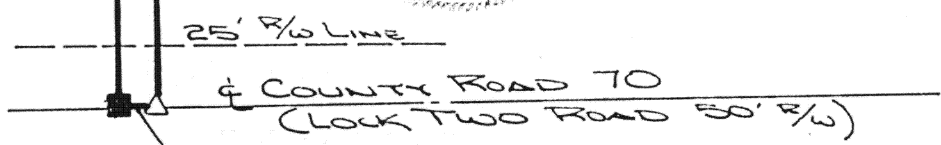

12.00'
S. 89° 27' 30" W.
S.W. CORNER,
S.E. 1/4, SECTION
4, GERMAN TWP.

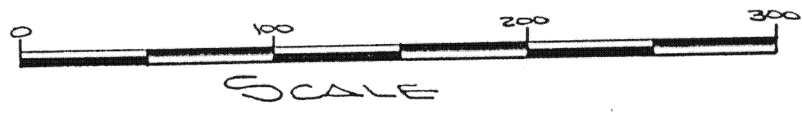

Jauert
ASSOCIATES

Surveying
AND LAND CONSULTING

RT.3 BOX 449 WAPAKONETA, OHIO 45895
PH. (419) 738-8962

H-262

Client	JERRY KOEGER		
County	AUGLAIZE	Township	GERMAN
Section	4	T. 7 S., R. 4 E.	Drwg. No. 88-3654
Drawn By	J. JAUERT Date June, 1989		
Scale	SHOWN Sheet 1 of 1		