

LOCATION PLAN

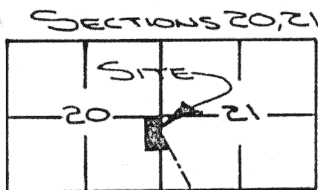

NOBLE TOWNSHIP,
T-5-S, R-4-E, AUGLAIZE
COUNTY, OHIO.

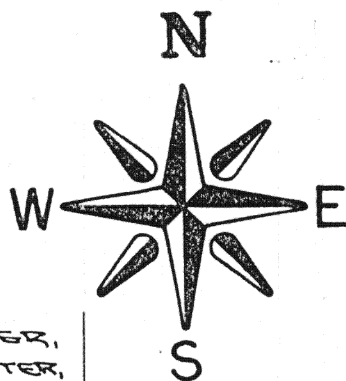

N.E. CORNER,
S.E. QUARTER,
SECTION 20
NOBLE TWP.

N. LINE, S.E. QUARTER, SEC. 20
S. 89° 58' 48" E.
341.14'

PARCEL "A"

1.096 ACRE

0.09 AC. R/W

1.00 ACRE NET

N. 00° 12' 40" E.
140.00'

N. 00° 12' 40" E.
136.26'

341.14'
N. 89° 58' 48" W.

PARCEL "B"

1.098 ACRE

0.09 AC. R/W

1.00 ACRE NET

(1.06 AC. IN SEC. 20, 0.03 ACRE IN SEC. 21)

374.01' TOTAL LINE
N. 89° 58' 48" W.

30' R/W LINE

140.00'

S. 00° 12' 40" W.

STATE ROUTE 116

SECTION 21

54.34'

S. 89° 12' 40" E.

(32.22')

SECTION 20

SECTION LINE

STATE ROUTE 116

THIS PLAT IS RECORDED IN SURVEY
BOOK "12", PAGE 381, IN THE AUGLAIZE
COUNTY ENGINEER'S OFFICE.

LEGEND

- IRON PIN FOUND
- IRON PIN SET
- △ P.K. & SWINNER SET
- ▲ R.R. SPIKE FOUND
- MONUMENT BOX

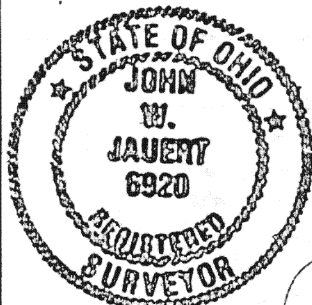

ATTEST:

John W. Janert
JOHN W. JANERT
PROFESSIONAL SURVEYOR
OHIO NO. 6920

STATE ROUTE 116

Janert
ASSOCIATES

Surveying
AND LAND CONSULTING

RT. 3 BOX 449 WAPAKONETA, OHIO 45895
PH. (419) 738-8962

Client BRAD FELVER
County AUGLAIZE Township NOBLE
Section 20 T. 5 S., R. 4 E. Drwg. No. 89-438
Drawn By J. JANERT Date 2-20-89
Scale 1" = 60' Sheet 1 of 2

PARCEL "A"



The following described tract of land is part of the Northeast Quarter of the Southeast Quarter of Section 20, Town 5 South, Range 4 East, Noble Township, Auglaize County, Ohio and is more particularly described as follows:

The PLACE OF BEGINNING is at an iron pin over the section stone found at the Northeast corner of the Southeast Quarter of Section 20, Noble Township and in the centerline of State Route 116;

thence S.00°12'40"W. along the East line of the Southeast Quarter of Section 20 and the tangent line of a curve to the left on State Route 116, a distance of 140.00 feet to a P.K. nail set;

thence N.89°58'48"W. a distance of 341.14 feet to an iron pin set, passing thru an iron pin set for reference at 30.00 feet;

thence N.00°12'40"E. parallel to the East line of the Southeast Quarter of Section 20, a distance of 140.00 feet to an iron pin set;

thence S.89°58'48"E. along the North line of the Southeast Quarter of Section 20, Noble Township, a distance of 341.14 feet to an iron pin, passing thru an iron pin set for reference at 311.14 feet in the West right-of-way line of State Route 116, said iron pin was the true PLACE OF BEGINNING.

Containing in all 1.09 acre of which 0.09 acre has been dedicated for highway purposes. The above described tract of land is subject to all legal easements, restrictions and reservations, if any, of record or in use on said premises. Previous deed reference: Volume 238, page 182. This plat is recorded in Survey Book "H", page 381, in the Auglaize County Engineer's Office.

PARCEL "B"

The following described tract of land is part of the Northeast Quarter of the Southeast Quarter of Section 20, and part of the Northwest Quarter of the Southwest Quarter of Section 21, Town 5 South, Range 4 East, Noble Township, Auglaize County, Ohio and is more particularly described as follows:

Commencing at an iron pin over the section stone found at the Northeast corner of the Southeast Quarter of Section 20, Noble Township and in the centerline of State Route 116;

thence S.00°12'40"W. along the East line of the Southeast Quarter of Section 20 and the tangent line of a curve to the left on State Route 116, a distance of 140.00 feet to a P.K. nail set, which is the PLACE OF BEGINNING;

thence continuing S.00°12'40"W. along the above described line, a distance of 54.34 feet to an iron pin set which is the point of intersection of two tangents to a curve to the left on State Route 116;

thence S.21°40'40"E. along the tangent line of a curve to the left on State Route 116, a distance of 88.17 feet to a P.K. nail;

thence N.89°58'48"W. a distance of 374.01 feet to an iron pin set, passing thru an iron pin set for reference at 32.29 feet;

thence N.00°12'40"E., parallel to the East line of the Southeast Quarter of Section 20, a distance of 136.26 feet to an iron pin set;

thence S.89°58'48"E., parallel to the North line of the Southeast Quarter of Section 20, Noble Township, a distance of 341.14 feet to a P.K. nail, passing thru an iron pin set for reference at 311.14 feet, said P.K. nail was the true PLACE OF BEGINNING.

Containing in all 1.09 acre of which 0.09 acre has been dedicated for Highway purposes (1.06 acre in Section 20 and 0.03 acre in Section 21). The above described tract of land is subject to all legal easements, restrictions and reservations if any, of record or in use on said premises. Previous deed reference: Volume 238, page 182. This plat is recorded in Survey Book "H", page 381, in the Auglaize County Engineer's Office.

ATTEST:

John W. Jauert
Professional Surveyor No. 6920

Jauert
ASSOCIATES

Surveying
AND LAND CONSULTING

RT.3 BOX 449 WAPAKONETA, OHIO 45895
PH. (419) 738-8962

Client Brad Felver
County Auglaize Township Noble
Section 20 T. 5 S., R. 4 E. Drwg. No. 89-438
Drawn By _____ Date 2/20/89
Scale _____ Sheet 2 of 2