

ATTEST: *[Signature]*
JOHN W. JAUERT
PROFESSIONAL SURVEYOR
NO. 6920

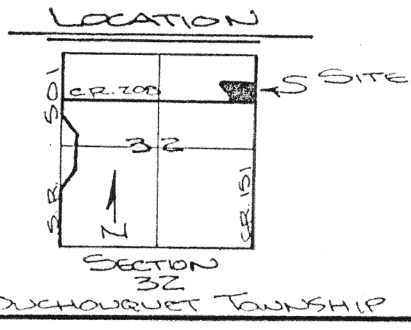

Jauert
ASSOCIATES

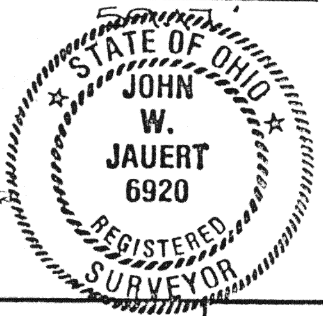
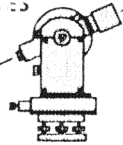

Surveying
AND LAND CONSULTING

RT. 3 BOX 449 WAPAKONETA, OHIO 45895
PH. (419) 738-8962

Client RICHARD CRUMRING
County ADAMS Township DUCHOUQUET
Section 32 T. 4 S., R. 6 E. Drwg. No. BA-457
Drawn By K. SCHMIDT Date 5/29/89
Scale AS SHOWN Sheet 1 of 3

SURVEYOR'S DESCRIPTION FOR TRACTS #1 and #2

TRACT #1

The following described tract of land is situated in the Northeast Quarter of Section 32, Duchouquet Township, Town 4 South, Range 6 East, Auglaize County, Ohio, and is more particularly described as follows:

Commencing at a Railroad Spike located at the Southeast Corner of the Northeast Quarter of the Northeast Quarter of Section 32, Duchouquet Township, Town 4 South, Range 6 East, Auglaize County, and is the PLACE OF BEGINNING for this tract of land herein described;

thence S. 89°-40'-20" W. along the South line of the Northeast Quarter of the Northeast Quarter of said Section for a distance of 200.00 feet to a Railroad Spike;

thence N. 00°-01'-25" E. for a distance of 279.90 feet to an iron pin, and passing thru an iron pin on the North right-of-way line of County Road #208, National Road, at a distance of 24.79 feet;

thence N. 89°-40'20" E. for a distance of 200.00 feet to a Railroad Spike located on the East line of the Northeast Quarter of Section 32, and the centerline of Township Road #151, and also passing thru an iron pin located on the West right-of-way line of Township Road # 151 at a distance of 170.00 feet;

thence S. 00°-01'-25" W. along the East line of the Northeast quarter of Section 32 and the centerline of Township Road #151 for a distance of 279.90 feet to a Railroad Spike, the same being the true PLACE OF BEGINNING.

Containing in all 1.285 Acres of land of which 0.285 Acre has been previously dedicated for highway purposes. The above described tract of land is also subject to all other legal easements, reservations, or restrictions, if any, upon said premises. All bearings were based on previous surveys as Recorded in Survey Book "F", Page 71, and Survey Book "G", Page 506, Auglaize County Engineer's Office. This Plat and Description is hereby Recorded in Survey Book " 12 ", Page 434. Previous Deed References: VOLUME " 199 ", PAGE 5, Auglaize County Recorder's Office.

TRACT #2

The following described tract of land is situated in the Northeast Quarter of Section 32, Duchouquet Township, Town 4 South, Range 6 East, Auglaize County, Ohio, and is more particularly described as follows:

Commencing at a Railroad Spike located at the Southeast Corner of the Northeast Quarter of the Northeast Quarter of Section 32, Duchouquet Township, Town 4 South, Range 6 East, Auglaize County;

thence S. 89°-40'-20" W. along the South line of the Northeast Quarter of the Northeast Quarter of said Section for a distance of 200.00 feet to a Railroad Spike being the PLACE OF BEGINNING for this tract of land herein described;

thence continuing S. 89°-40'-20" W. along the South line of the Northeast Quarter of the Northeast Quarter of said Section for a distance of 115.30 feet to a Railroad Spike;

thence N. 15°-07'-56" W. following the centerline of an open ditch for a distance of 53.77 feet to a point, and passing thru a point on the North right-of-way line of County Road #208, National Road, at a distance of 27.34 feet;

thence N. 47°-36'-20" W. following the centerline of an open ditch for a distance of 97.37 feet to a point;

(continued on next page)

Jauert
ASSOCIATES

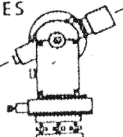

Surveying
AND LAND CONSULTING

RT.3 BOX 449 WAPAKONETA, OHIO 45895
PH. (419) 738-8962

Client Richard Crumrine
County Auglaize Township Duchouquet
Section 32 T. 4 S., R. 6 E. Drwg. No. 89-451
Drawn By Kevin Schnell Date 5/29/89
Scale As Shown Sheet 2 of 3

thence N. 73°-54'-30" W. following the centerline of an open ditch for a distance of 40.00 feet to a point;

thence N. 54°-45'-43" W. following the centerline of an open ditch for a distance of 71.01 feet to a point;

thence N. 47°-49'-51" W. following the centerline of an open ditch for a distance of 74.13 feet to a point;

thence N. 00°-40'-57" E. following the centerline of an open ditch for a distance of 59.17 feet to a point;

thence N. 89°-40'-20" E. for a distance of 352.03 feet to an iron pin, and passing thru an iron pin for reference at a distance of 24.49 feet;

thence S. 00°-01'-25" W. for a distance of 279.90 feet to a Railroad Spike, and passing thru an iron pin on the North right-of-way line of County Road #208, National Road, at a distance of 255.11 feet, said Railroad Spike being the true PLACE OF BEGINNING.

Containing in all 1.561 Acres of land of which 0.070 Acre has been previously dedicated for highway purposes. The above described tract of land is also subject to all other legal easements, reservations, or restrictions, if any, upon said premises. All bearings were based on previous surveys as Recorded in Survey Book "F", Page 71, and Survey Book "G", Page 506, Auglaize County Engineer's Office. This Plat and Description is hereby Recorded in Survey Book " H ", Page 434 . Previous Deed References: VOLUME " 199 ", PAGE 5 , Auglaize County Recorder's Office.

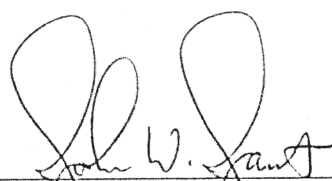

PREPARED BY:

John W. Jauert
Professional Surveyor
License No. 6920

Jauert
ASSOCIATES

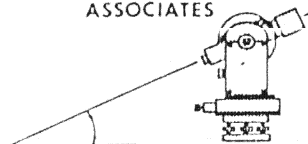

Surveying
AND LAND CONSULTING

RT.3 BOX 449 WAPAKONETA, OHIO 45895
PH. (419) 738-8962

Client Richard Crumrine
County Auglaize Township Duchouquet
Section 32 T. 4 S. R. 6 E. Drwg. No. 89-457
Drawn By Kevin Schnell Date 5/29/89
Scale As Shown Sheet 3 of 3